

UNITED STATES  
DEPARTMENT OF THE INTERIOR  
GEOLOGICAL SURVEY

30-039-21289

## APPLICATION FOR PERMIT TO DRILL, DEEPEN, OR PLUG BACK

## 1. TYPE OF WORK

DRILL ☒DEEPEN ☐PLUG BACK ☐

## 2. TYPE OF WELL

OIL  
WELL ☐GAS  
WELL ☒OTHER ☐SINGLE  
ZONE ☒MULTIPLE  
ZONE ☐

## 3. NAME OF OPERATOR

Aztec Oil &amp; Gas Company

## 4. ADDRESS OF OPERATOR

P. O. Drawer 570, Farmington, New Mexico

## 5. LOCATION OF WELL (Report location clearly and in accordance with any State requirements)

At surface

1650' FSL & 990' FEL  
Section 1, T26N, R4W

At proposed prod. zone

## 6. DISTANCE IN MILES AND DIRECTION FROM NEAREST TOWN OR POST OFFICE

SEP 17 1976

7. DISTANCE FROM PROPOSED  
LOCATION TO NEAREST  
PROPERTY OR LEASE LINE, FT.

(Also to nearest dir. unit line, if any)

8. DISTANCE FROM PROPOSED LOCATION  
TO NEAREST WELL, DRILLING, COMPLETED,  
OR APPLIED FOR, ON THIS LEASE, FT.

## 9. ELEVATIONS (Show whether DF, RT, GR, etc.)

7146'

## 10. PROPOSED CASING AND CEMENTING PROGRAM

SIZE OF HOLE	SIZE OF CASING	WEIGHT PER FOOT	SETTING DEPTH	QUANTITY OF CEMENT
12-1/4"	8-5/8"	24#	120'	106 cu. ft. w/ 3/4# gel-flake
6-3/4"	2-7/8"	6.4#	4050'	3# calcium chloride
				210 cu. ft. of 65/35 Class B cement w/ 12# gel followed by 100 cu. ft. of Class B neat cement.

Surface formation is San Jose.

Top of Ojo Alamo water sand is at 3280'.

Top of Pictured Cliffs sand is at 3890'.

A fresh water mud system will be used for drilling.

It is anticipated that IES and Density logs will be run at total depth.

No abnormal pressures or poisonous gases are anticipated in this well.

It is expected that this well will be drilled before the end of 1976. This depends on time required for approvals, rig availability and the weather. We will follow the surface restoration plan set out by the appropriate surface agency and the U.S.G.S.

*Gas is dedicated*

IN ABOVE SPACE DESCRIBE PROPOSED PROGRAM: If proposal is to deepen or plug back, give data on present productive zone and proposed new zone. If proposal is to drill or deepen directionally, give pertinent data on subsurface locations and measured and true vertical depths. Give preventer program, if any.

24.

SIGNED

(This space for Federal or State office use)

TITLE District Production Manager DATE September

PERMIT NO.

APPROVAL DATE

APPROVED BY  
CONDITIONS OF APPROVAL, IF ANY:

TITLE

DATE

\*See Instructions On Reverse Side

NEW MEXICO OIL CONSERVATION COMMISSION  
WELL LOCATION AND ACREAGE DEDICATION PLAT

Supersedes C-128  
Effective 1-4-65

All distances must be from the outer boundaries of the Section.

Operator <b>Astec Oil &amp; Gas Company</b>			Lease <b>Jicarilla 101</b>		Well No. <b>5</b>
Unit Letter <b>I</b>	Section <b>1</b>	Township <b>26N</b>	Range <b>4W</b>	County <b>Rio Arriba</b>	
Actual Footage Location of Well: <b>1650</b> feet from the <b>South</b> line and <b>990</b> feet from the <b>East</b> line					
Ground Level Elev. <b>7146</b>	Producing Formation <b>Pictured Cliffs</b>		Pool <b>Tapacito</b>		Dedicated Acreage: <b>160</b> Acres

1. Outline the acreage dedicated to the subject well by colored pencil or hachure marks on the plat below.
2. If more than one lease is dedicated to the well, outline each and identify the ownership thereof (both as to working interest and royalty).
3. If more than one lease of different ownership is dedicated to the well, have the interests of all owners been consolidated by communitization, unitization, force-pooling, etc?

☐ Yes ☐ No If answer is "yes," type of consolidation \_\_\_\_\_

If answer is "no," list the owners and tract descriptions which have actually been consolidated. (Use reverse side of this form if necessary.) \_\_\_\_\_

No allowable will be assigned to the well until all interests have been consolidated (by communitization, unitization, forced-pooling, or otherwise) or until a non-standard unit, eliminating such interests, has been approved by the Commission.

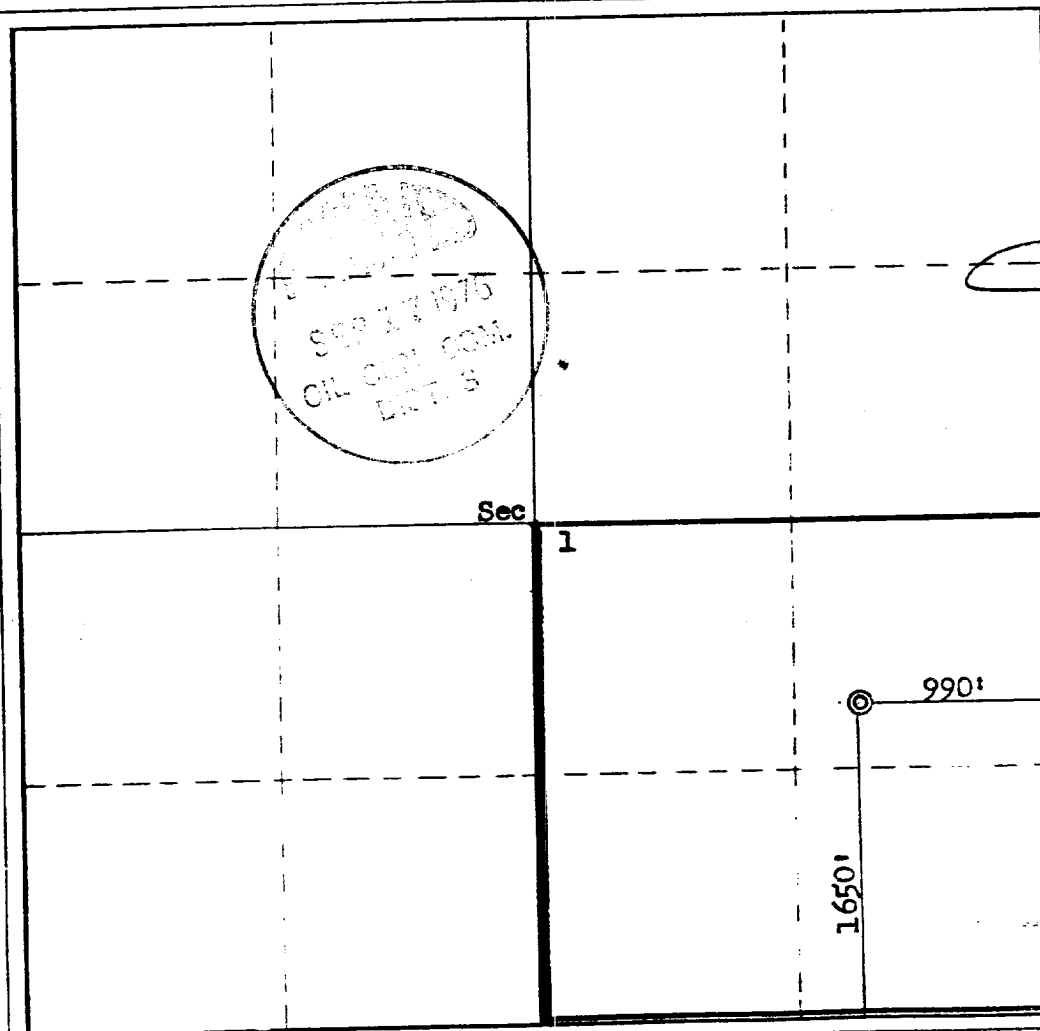

CERTIFICATION

I hereby certify that the information contained herein is true and complete to the best of my knowledge and belief.

*[Signature]*

Position  
District Production Manager

Company  
Astec Oil & Gas Company

Date  
September 8, 1976

I hereby certify that the well location shown on this plat was plotted from field notes of actual surveys made by me or under my supervision, and that the same is true and correct to the best of my knowledge and belief.

Date Surveyed  
September 7, 1976

Registered Professional Engineer  
and/or Land Surveyor

*[Signature]*  
Fred B. Kerr

Certificate No.  
3950

0 330 660 990 1320 1650 1980 2310 2640 2000 1500 1000 500 0

# AZTEC OIL & GAS COMPANY

P. O. DRAWER 570  
FARMINGTON, NEW MEXICO 87401

September 8, 1976

United States Geological Survey  
P. O. Box 1809  
Durango, Colorado

Attention: Mr. Jerry Long

Dear Sir:

Enclosed please find map showing existing roads and planned access roads to Aztec Oil & Gas Company's Jicarilla #101-5 well. The locations of tank batteries and flow lines will be on location with well. A burn pit will be provided for disposal of trash. Cuttings, drilling fluid and produced fluids will be put into the reserve pit and properly disposed of depending on amount and type of fluids.

There will be no camps or air strips.

Also enclosed is location layout showing approximate location of rig, pits and pipe racks.

Water supply will be Carrizo Wash.

The location will be restored according to Bureau of Land Management standards. This work will begin when all related construction is finished.

Mr. Jim Brown will be Aztec Oil & Gas Company's field representative supervising these operations.

Yours truly,

AZTEC OIL & GAS COMPANY

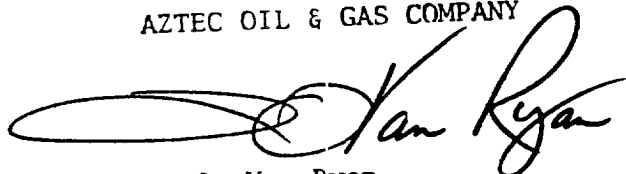

L. O. Van Ryan  
District Superintendent

LOVR/dg

# AZTEC OIL & GAS COMPANY

P. O. DRAWER 570  
FARMINGTON, NEW MEXICO 87401

September 8, 1976

United States Geological Survey  
P. O. Box 1809  
Durango, Colorado

Attention: Mr. Jerry Long

RE: Blowout Preventer Plan

Dear Sir:

All drilling and completion wells will be equipped with 8" double hydraulic blowout preventers and a hydraulic closing unit with steel line.

The preventer is 3000# working pressure and 6000# test.

All crews will be thoroughly trained in the operation of this preventer. The preventer will be tested at the beginning of every tower change to insure proper operation.

Yours truly,

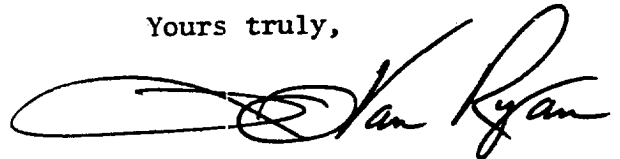
A handwritten signature in dark ink, appearing to read "L. O. Van Ryan". The signature is stylized with a large, looping initial "L" and a cursive "O".

L. O. Van Ryan  
District Production Manager

LOVR/dg

# LOCATION LAYOUT

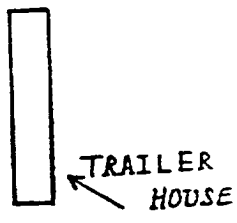
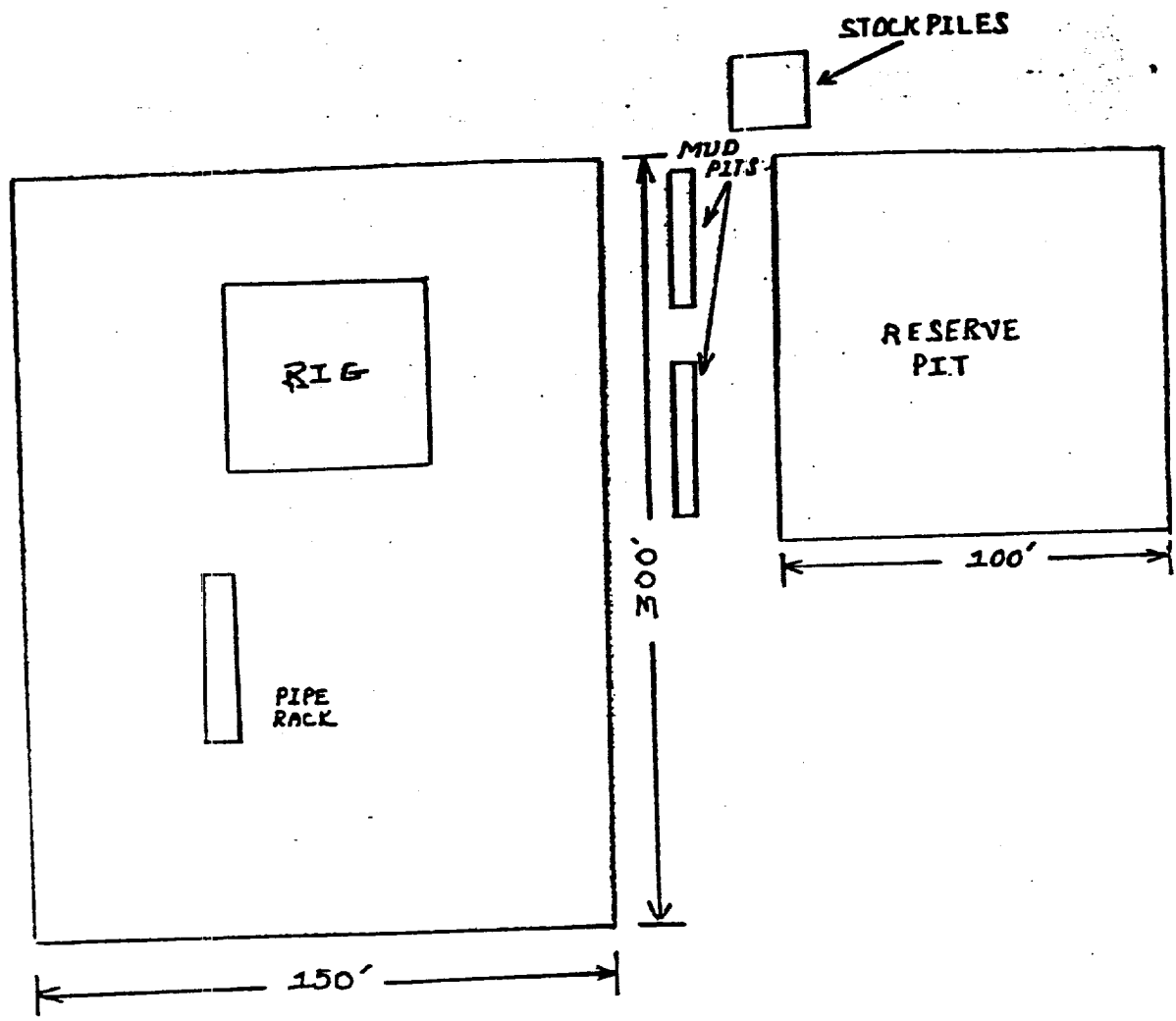

PARKING AREA

CUT REQUIRED FOR ABOVE LOCATION: 4 foot

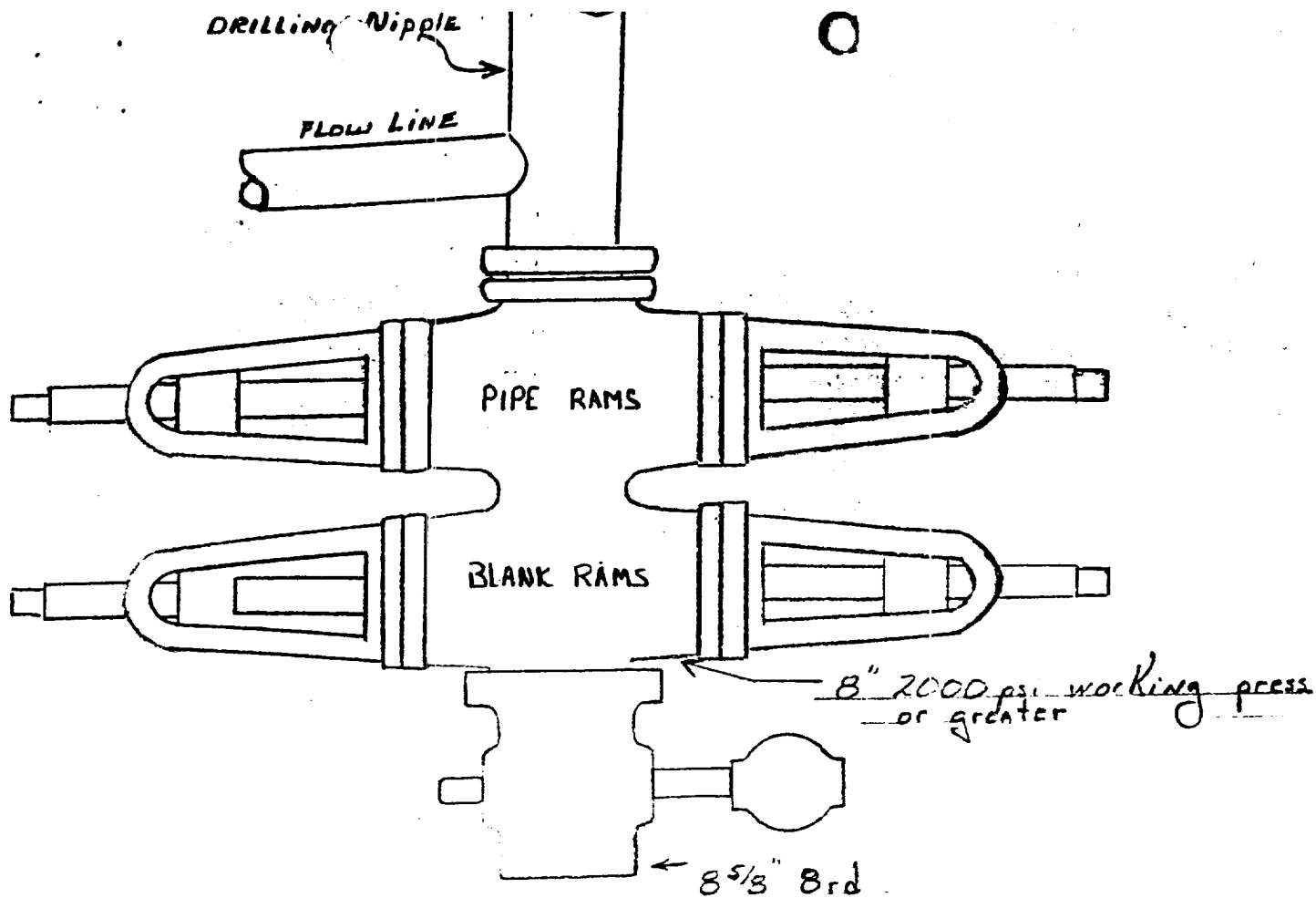

Preventers and spools are to have  
through bore of 8" - 2000# or larger.

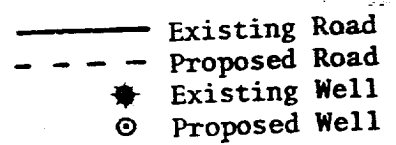

# AZTEC OIL & GAS COMPANY

P.O. DRAWER 570  
FARMINGTON, NEW MEXICO 87401

September 8, 1976

United States Geological Survey  
P. O. Box 1809  
Durango, Colorado

Attention: Mr. Jerry Long

Dear Sir:

I hereby certify that I, or persons under my direct supervision, have inspected the proposed drillsite and access route; that I am familiar with the conditions which presently exist; that the statements made in this plan are, to the best of my knowledge, true and correct; and, that the work associated with the operations proposed herein be performed by Aztec Oil & Gas Company and its contractors and subcontractors in conformity with this plan and the terms and conditions under which it is approved.

Date: September 8, 1976

Name: Jim Brown  
Title: Drilling Foreman