

UNITED STATES  
DEPARTMENT OF THE INTERIOR  
GEOLOGICAL SURVEY30-039-21352  
5. LEASE DESIGNATION AND SERIAL NO.

14 03551

6. IF INDIAN, ALLOTTEE OR TRIBE NAME

7. UNIT AGREEMENT NAME

8. FARM OR LEASE NAME

Preach "B"

9. WELL NO.

558

10. FIELD AND POOL, OR WILDCAT

South Blanco P.C.

11. SEC., T., R., M., OR BLK.  
AND SUBVEY OR AREA

Section 3, 24N 6W

12. COUNTY OR PARISH 13. STATE

Rio Arriba New Mexico

17. NO. OF ACRES ASSIGNED  
TO THIS WELL

160.75

20. ROTARY OR CABLE TOOLS

Rotary

22. APPROX. DATE WORK WILL START\*

April 25, 1977

## APPLICATION FOR PERMIT TO DRILL, DEEPEN, OR PLUG BACK

1. TYPE OF WORK

DRILL ☒DEEPEN ☐PLUG BACK ☐

b. TYPE OF WELL

OIL  
WELL ☐GAS  
WELL ☒

OTHER

SINGLE  
ZONE ☒MULTIPLE  
ZONE ☐

2. NAME OF OPERATOR

Cochise Oil Company

3. ADDRESS OF OPERATOR

P.O. Box 710, Farmington, New Mexico 87401

4. LOCATION OF WELL (Report location clearly and in accordance with any State requirements.)

At surface

1180 from the North and 720 from the East

At proposed prod. zone

Same

14. DISTANCE IN MILES AND DIRECTION FROM NEAREST TOWN OR POST OFFICE\*

35 Miles Southeast of El Paso, New Mexico

15. DISTANCE FROM PROPOSED\*

LOCATION TO NEAREST  
PROPERTY OR LEASE LINE, FT.  
(Also to nearest drlg. unit line, if any)

170

16. NO. OF ACRES IN LEASE

2240

18. DISTANCE FROM PROPOSED LOCATION\*

TO NEAREST WELL, DRILLING COMPLETED,  
OR APPLIED FOR, ON THIS LEASE, FT.

100'

19. PROPOSED DEPTH

3160

21. ELEVATIONS (Show whether DF, RT, GR, etc.)

5560 ft.

23.

## PROPOSED CASING AND CEMENTING PROGRAM

SIZE OF HOLE	SIZE OF CASING	WEIGHT PER FOOT	SETTING DEPTH	QUANTITY OF CEMENT
12 3/4"	5 1/2"	24	100	Sufficient to circulate
7 7/8"	3 1/2"	10.5	3160	125 sacks

Surface formation is sand. No abnormal pressure or temperature anticipated.

It is proposed to drill well to 3160' using gel based mud. Drill pipe fl at will be used. 2 1/2" bit installed as bit. An induction log will be run providing hole conditions permit. A neutron log, if not neutron log will be run in pipe.

A 12 3/4" N-40, 17.4 lb/cu ft. will be cemented at TD with 325 sacks 50-50 pas containing 100 lbs per sack, followed by 125 sacks West cement.

Casing will have rotating washers and centralizers through Pictured Cliffs Zone.

A 12 3/4" N-40, 17.4 lb/cu ft. will be run to top of Pictured Cliffs perforation.

A 3 1/2" Model 11P, 6000 psi Blowout Preventer will be in use at all times while drilling below 100'. Blowout Preventer will be tested at least once during each 24 hour day.

IN ABOVE SPACE DESCRIBE PROPOSED PROGRAM: If proposal is to deepen or plug back, give data on present productive zone and proposed new productive zone. If proposal is to drill or deepen directionally, give pertinent data on subsurface locations and measured and true vertical depths. Give blowout preventer program, if any.

24.

SIGNED

TITLE

Superintendent

DATE

March 17, 1977

(This space for Federal or State office use)

PERMIT NO.

APPROVAL DATE

APPROVED BY

TITLE

DATE

CONDITIONS OF APPROVAL, IF ANY:

\*See Instructions On Reverse Side

NEW MEXICO OIL CONSERVATION COMMISSION  
WELL LOCATION AND ACREAGE DEDICATION PLAT

Form C-101  
Supersedes C-178  
Effective 1-1-81

All distances must be from the outer boundaries of the Section.

Owner <b>Caulkins Oil Company</b>			Lease <b>NM 03551</b>		Well No. <b>558</b>
Section <b>A</b>	Section <b>3</b>	Township <b>26 North</b>	Range <b>6 West</b>	County <b>Rio Arriba</b>	
Location of Well:					
<b>1180</b> feet from the <b>North</b> line and		<b>820</b> feet from the <b>East</b> line			
Elevation Elev. <b>6560</b>	Producing formation <b>Pictured Cliffs</b>		Pool <b>South Blanco</b>	Dedicated Acreage <b>160 160.75</b>	

1. Outline the acreage dedicated to the subject well by colored pencil or hatchure marks on the plat below.
2. If more than one lease is dedicated to the well, outline each and identify the ownership thereof (both as to working interest and royalty).
3. If more than one lease of different ownership is dedicated to the well, have the interests of all owners been consolidated by communitization, unitization, force-pooling, etc?

☐ Yes ☐ No If answer is "yes," type of consolidation \_\_\_\_\_

If answer is "no," list the owners and tract descriptions which have actually been consolidated. (Use reverse side of this form if necessary.) \_\_\_\_\_

No allowable will be assigned to the well until all interests have been consolidated (by communitization, unitization, forced-pooling, or otherwise) or until a non-standard unit, eliminating such interests, has been approved by the Commission.

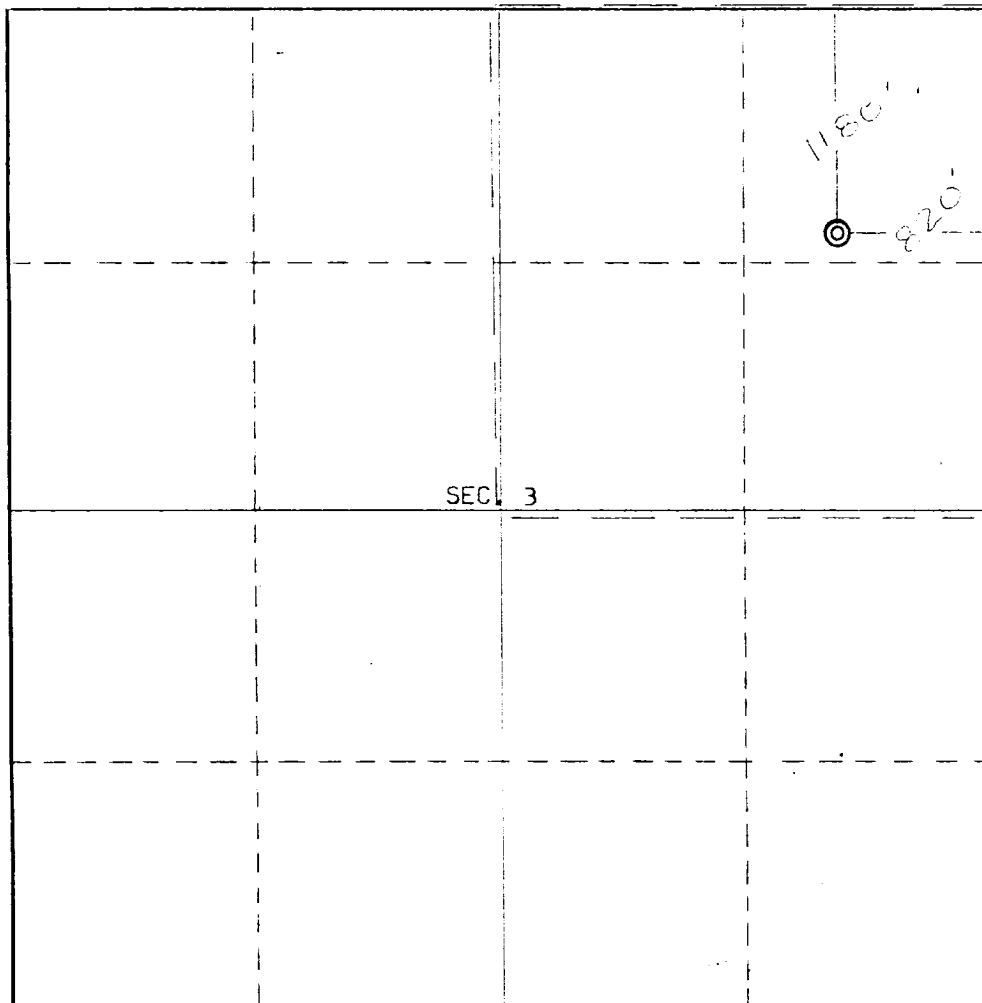

CERTIFICATION

I hereby certify that the information contained herein is true and complete to the best of my knowledge and belief.

Name  
*Charles Vargier*  
Position  
**Superintendent**  
Company  
**Caulkins Oil Co.**  
Date  
**March 17, 1977**

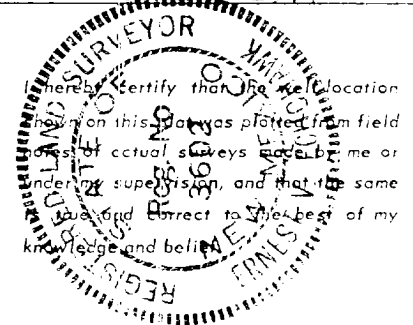

Date Surveyed  
**March 5, 1977**  
Registered Professional Engineer and/or Land Surveyor

*E.V. Echshaw*  
Certificate No. **3602**

**E.V. Echshaw LS**

# CAULKINS OIL CO.

Post Office Box 780  
Farmington, New Mexico 87401

March 17, 1977

United States Dept. of the Interior  
Geological Survey  
Post Office Box 1809  
Durango, Colorado 81301

Gentlemen:

Following is our multi-point development plan for surface use and restoration for our well No. 558, located in Northeast Quarter of Section 3 26N 6W, Rio Arriba County, New Mexico.

- (1) Location to be built on existing location. Existing roads will be used. Copy of topo map showing proposed location and existing roads in area.
- (2) No new roads required. Access roads from Brean Camp to location marked on topo map.
- (3) Location of existing wells shown on topo map.
- (4) No tank battery or production facilities required. Note: Gas Company of New Mexico as purchaser of gas will apply for permit for pipelines and production equipment.
- (5) Water will be hauled from Caulkins Oil Company well number 130, located in Northwest Quarter of Section 9 26N 6W, Rio Arriba County, New Mex. Water Well identified with red circle on topo map. Roads on Federal lands used to haul water from water well to location also shown on topo map.
- (6) No construction materials needed for roads or location.
- (7) All cuttings, trash, garbage and etc, will be confined to reserve pit and small fenced pit on location. After rig is moved out, area will be cleaned up, small pit covered and reserve pit fenced until fluid in pit evaporates. Reserve pit will be covered as soon as it dries sufficiently to proceed without damage to outside surface.
- (8) No camp required.
- (9) Layout plat for location and reserve pit attached. No new area will be disturbed. Reserve pit will be built where original reserve pit was located while drilling MD 58. Pit will be built from earth material with banks packed by tractor. Reserve pit will not be lined.
- (10) Reserve pit will be covered and cleaned up then reseeded with BLM recommended seeding program with 2 $\frac{1}{2}$ # Crested Wheatgrass, 2 $\frac{1}{2}$ # Smooth Brome, 1 $\frac{1}{2}$ # Fourwing Saltbrush (dewinged) and 1# Nomad Alfalfa per acre. Reseeded area will include all location and reserve pit area to within 5' of all facilities. Seeding shall be done between July 15 and October 15. All facilities maintained by Caulkins Oil Company shall be painted Grey, Number 36357.

(11) New drillsite on existing location. Sparsely covered with Crested Wheatgrass.

(12) Operator's Representative:

Charles E. Verquer, Supt.  
Post Office Box 780  
Farmington, New Mexico 87401

Phone: 325 0481

(13) Certification:

I hereby certify that I, or persons under my direct supervision, have inspected the proposed drillsite and access route; that I am familiar with the conditions which presently exist; that the statements made in this plan are to the best of knowledge, true and correct; and; that the work associated with the operations proposed herein will be performed by CAULKINS OIL COMPANY and its contractors and sub contractors in conformity with this plan and the terms and conditions under which it is approved.

March 17, 1977

Date

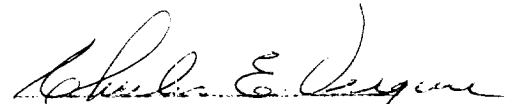
  
Charles E. Verquer, Supt.

