

BY
CHKD. BY
DATE

SUBJECT

SHEET NO. OF
JOB NO.

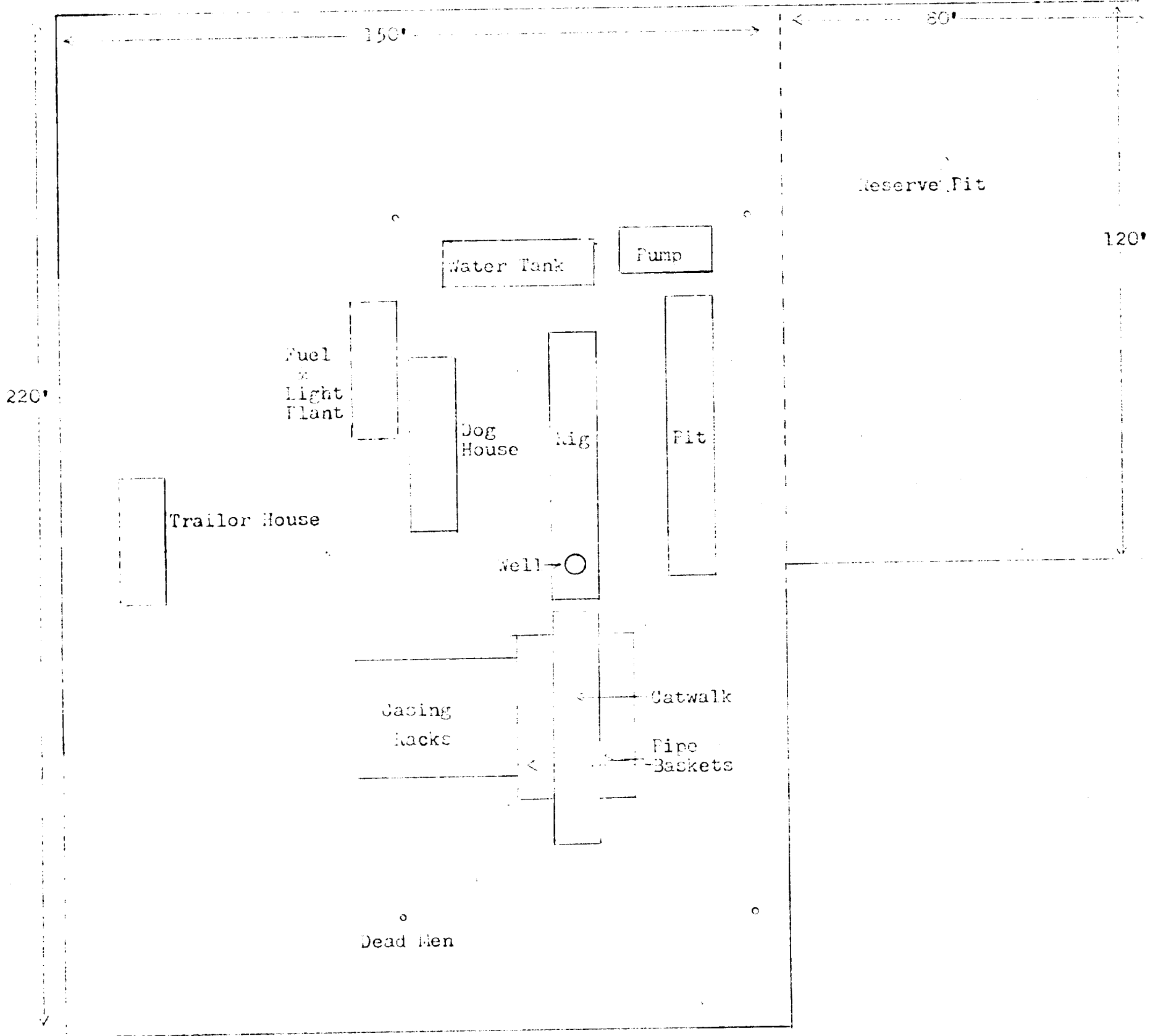
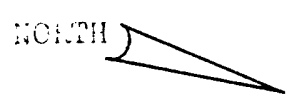

Scale - 1 inch = 25'

Well Number 264
SE NE Section 17 26N 6W
Rio Arriba County, New Mexico

UNITED STATES
DEPARTMENT OF THE INTERIOR
GEOLOGICAL SURVEYSUBMIT IN TRIPLICATE*
(Other instructions on re-
verse side)Form approved.
Budget Bureau No. 42-R1424.

5. LEASE DESIGNATION AND SERIAL NO.

SF 079035-4

6. IF INDIAN, ALLOTTEE OR TRIBE NAME

7. UNIT AGREEMENT NAME

8. FARM OR LEASE NAME

Breech A

9. WELL NO.

264

10. FIELD AND POOL, OR WILDCAT

South Blanco-Otero Chacra

11. SEC., T., R., M., OR BLK. AND
SURVEY OR AREA

Section 17 26N 6W

12. COUNTY OR PARISH

Rio Arriba

13. STATE

New Mex.

SUNDRY NOTICES AND REPORTS ON WELLS
(Do not use this form for proposals to drill or to deepen or plug back to a different reservoir.
Use "APPLICATION FOR PERMIT—" for such proposals.)1. ☐ OIL
WELL ☐ GAS
WELL ☒ OTHER

2. NAME OF OPERATOR

Caulkins Oil Co mpany

3. ADDRESS OF OPERATOR

Post Office Box 780, Farmington, New Mexico

4. LOCATION OF WELL (Report location clearly and in accordance with any State requirements.*
See also space 17 below.)
At surface

1450 from the North and 790 from the East

14. PERMIT NO.

15. ELEVATIONS (Show whether DF, RT, GR, etc.)

6781 Gr.

16. Check Appropriate Box To Indicate Nature of Notice, Report, or Other Data

NOTICE OF INTENTION TO:

TEST WATER SHUT-OFF

FRACTURE TREAT

SHOOT OR ACIDIZE

REPAIR WELL

(Other)

PULL OR ALTER CASING

MULTIPLE COMPLETE

ABANDON*

CHANGE PLANS

SUBSEQUENT REPORT OF:

WATER SHUT-OFF

FRACTURE TREATMENT

SHOOTING OR ACIDIZING

(Other)

REPAIRING WELL

ALTERING CASING

ABANDONMENT*

(Note: Report results of multiple completion on Well
Completion or Recompletion Report and Log form.)17. DESCRIBE PROPOSED OR COMPLETED OPERATIONS (Clearly state all pertinent details, and give pertinent dates, including estimated date of starting any
proposed work. If well is directionally drilled, give subsurface locations and measured and true vertical depths for all markers and zones perti-
nent to this work.)*

Spud 7:30 PM 6-4-77.

Drilled 12 1/4" hole to 145' and cemented New 8 5/8" 24# J-55 Casing
at 145' with 150 sacks Class B cement containing 2% CaCl. Plug down
1:00 AM 6-5-77. Cement did circulate to surface.Tested surface casing 6-6-77 with 600#. No decrease in pressure after 30
minutes.

18. I hereby certify that the foregoing is true and correct

SIGNED

TITLE

Superintendent

DATE

6-7-77

(This space for Federal or State office use)

APPROVED BY

TITLE

DATE

CONDITIONS OF APPROVAL, IF ANY:

*See Instructions on Reverse Side