

UNITED STATES
DEPARTMENT OF THE INTERIOR
GEOLOGICAL SURVEY

APPLICATION FOR PERMIT TO DRILL, DEEPEN, OR PLUG BACK

1a. TYPE OF WORK

DRILL ☒DEEPEN ☐PLUG BACK ☐

b. TYPE OF WELL

OIL
WELL ☐GAS
WELL ☒OTHER ☐SINGLE
ZONE ☒MULTIPLE
ZONE ☐

2. NAME OF OPERATOR

Supron Energy Corporation

3. ADDRESS OF OPERATOR

P. O. Box 808, Farmington, New Mexico 87401

4. LOCATION OF WELL (Report location clearly and in accordance with any State requirements.)*

At surface

850 feet from the North line and 990 feet from the East line.

At proposed prod. zone Same as above

14. DISTANCE IN MILES AND DIRECTION FROM NEAREST TOWN OR POST OFFICE*

10 miles North of Ojito, New Mexico

15. DISTANCE FROM PROPOSED* LOCATION TO NEAREST PROPERTY OR LEASE LINE, FT. (Also to nearest drlg. unit line, if any)

990' / Lease Line
990' / Drlg. Unit line

18. DISTANCE FROM PROPOSED LOCATION* TO NEAREST WELL, DRILLING, COMPLETED, OR APPLIED FOR, ON THIS LEASE, FT.

2,640 ft.

16. NO. OF ACRES IN LEASE

2560

19. PROPOSED DEPTH

3800

17. NO. OF ACRES ASSIGNED TO THIS WELL

160

20. ROTARY OR CABLE TOOLS

Rotary

21. ELEVATIONS (Show whether DF, RT, GR, etc.)

7037 GR

22. APPROX. DATE WORK WILL START*

23.

PROPOSED CASING AND CEMENTING PROGRAM

SIZE OF HOLE	SIZE OF CASING	WEIGHT PER FOOT	SETTING DEPTH	QUANTITY OF CEMENT
12-1/4"	8-5/8"	24.0#	250 ft.	200 cu. ft.
7-7/8"	4-1/2"	9.5#	3800 ft.	1500 cu. ft.

This well will be drilled and completed in the Pictured Cliff formation. After pipe is set and cemented, it will be perforated and sand-water fraced to stimulate production. 1-1/2" tubing will be set at approximately 3650 feet.

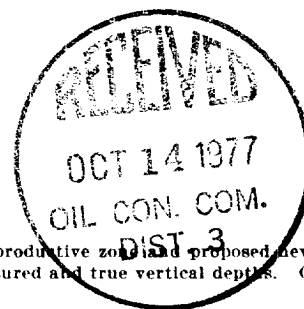

IN ABOVE SPACE DESCRIBE PROPOSED PROGRAM: If proposal is to deepen or plug back, give data on present productive zone and proposed new productive zone. If proposal is to drill or deepen directionally, give pertinent data on subsurface locations and measured and true vertical depths. Give blowout preventer program, if any.

24. Original Signed By
SIGNED Rudy D. Motto TITLE Area Superintendent DATE October 5, 1977
(This space for Federal or State office use)

PERMIT NO.

APPROVAL DATE

APPROVED BY

TITLE

DATE

CONDITIONS OF APPROVAL, IF ANY:

Okaf

*See Instructions On Reverse Side

**NEW MEXICO OIL CONSERVATION COMMISSION
WELL LOCATION AND ACERAGE DEDICATION PLAT**

All distances must be from the outer boundaries of the Section

Operator SUPRON ENERGY CORPORATION			Lease JICARILLA "B"		Well No. 10
Unit Letter A	Section 36	Township 26 NORTH	Range 4 WEST	County RIO ARriba	
Actual Footage Location of Well: <div style="display: flex; justify-content: space-between;"> 850 feet from the NORTH line and 990 feet from the EAST line </div>					
Ground Level Elev. 7037	Producing Formation PICTURED CLIFFS	Pool TAPACITO EXTENSION		Dedicated Acreage 160	Acre

1. Outline the acreage dedicated to the subject well by colored pencil or hatchure marks on the plat below.
2. If more than one lease is dedicated to the well, outline each and identify the ownership thereof (both as to working interest and royalty),
3. If more than one lease of different ownership is dedicated to the well, have the interests of all owners been consolidated by communitization, unitization, force-pooling, etc?

() Yes () No If answer is "yes," type of consolidation

If answer is "no," list the owners and tract descriptions which have actually consolidated. (Use reverse side of this form if necessary.)

No allowable will be assigned to the well until all interests have been consolidated (by communitization, unitization, forced-pooling, or otherwise) or until a non standard unit, eliminating such interests, has been approved by the Commission.

CERTIFICATION

I hereby certify that the information contained herein is true and complete to the best of my knowledge and belief.

Rudy D. Motto
Name

Rudy D. Motto

Position

Area Superintendent

Company

SUPRON ENERGY CORPORATION

Date

October 5, 1977

I hereby certify that the well location shown on this plat was plotted from field notes of surveys made by me under my supervision, and that the same is true and correct to the best of my knowledge and belief.

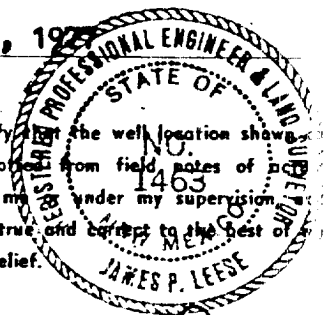

15 September, 1977

Date Surveyed

James P. Leese
Registered Professional Engineer
and/or Land Surveyor
James P. Leese

1463

Certificate No.

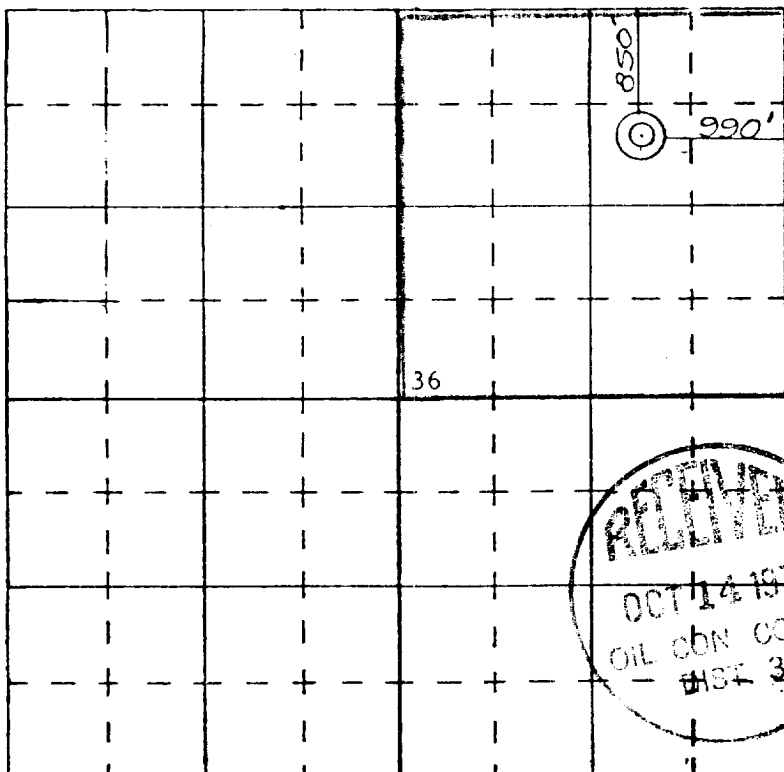

SCALE—4 INCHES EQUALS 1 MILE

SAN JUAN ENGINEERING COMPANY, FARMINGTON, N. M.

JICARILLA "B" NO. 10

1. The Geologic name of the surface formation is, "Wasatch".
2. The estimated tops of important Geologic markers are:
 - A. Base of Ojo Alamo - 3299 D.F.
 - B. Fruitland - 3561 D.F.
 - C. Pictured Cliff - 3589 D.F.
3. The estimated depths at which anticipated water, oil, gas or other mineral bearing formations are expected to be encountered are:
 - A. Base of Ojo Alamo - 3299 D.F.
 - B. Fruitland - 3561 D.F.
 - C. Pictured Cliff - 3589 D.F.
4. The casing program is shown on Form 9-3310 and all casing is new.
5. The lessee's pressure control equipment schematics are attached along with minimum specifications, testing procedures and frequencies.
6. The type, estimated volumes and characteristics of the circulating medium are as follows:
 - A. From 0 feet to 200 feet - Natural mud.
 - B. From 200 feet to 3800 - Pernaloid non dispersed mud containing 167 sx gel, 67 sx permaloid, 10 sx, C.M.C., 5 sx Soda Ash, and 12 sx of Caustic. Mud weight will be maintained between 8.2# and 8/8#.
7. The Auxiliary equipment to be used will be floats at the bit and a sub on the floor with a full opening valve to be stabbed into the drill pipe when the Kelly is not in the string.
8. This well is in an Area which is almost completely developed; therefore, we will not have a testing and coring program. The logging program will be as follows:
 - A. E.S. Induction.
 - B. Gamma Ray Density
 - C. Gamma Ray Correlation
 - D. Cement Bond or Temperature
9. There are no anticipated abnormal pressures, temperatures or hydrogen sulfide problems expected in this highly developed area.
10. The anticipated starting date for this well is November 10, 1977.

JICARILLA "B" #10

Blowout Preventer will be tested daily and prior to drilling out with the results to be logged on the drillers report. The B.O.P. and all valve and fittings are rated at 3000 PSI working pressure.

THIS PORTION, OR ANY PART THEREOF, MAY BE PLACED OUTSIDE OF SUB-STRUCTURE IF DESIRED. USE LONG RADIUS BENDS. PIPE USED FOR EXTENSION SHOULD BE SHOP MADE WITH NO SCREWED CONNECTIONS AND PRESSURE TESTED INITIALLY TO SAME TEST PRESSURE AS THE CHOKE MANIFOLD

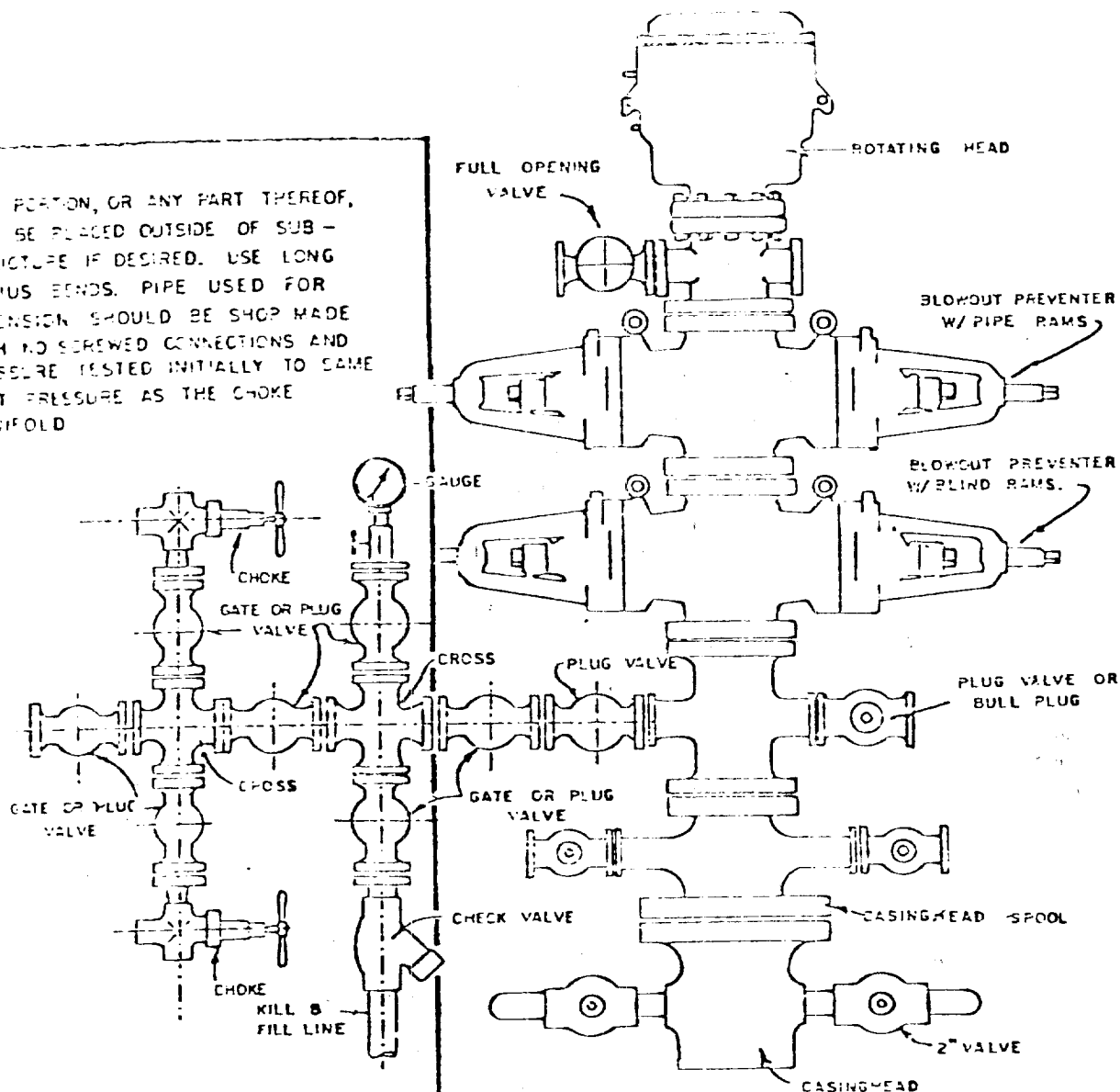

BLOWOUT PREVENTER HOOKUP

RECEIVED

OCT 12 1977

U. S. GEOLOGICAL SURVEY
WASHINGTON, D.C.

SUPRON ENERGY CORPORATION

JICARILLA "B" NO. 10

850 Feet from the North line and 990 feet from the East line of
Section 36, Township 26 North, Range 4 West, Rio Arriba County,
New Mexico.

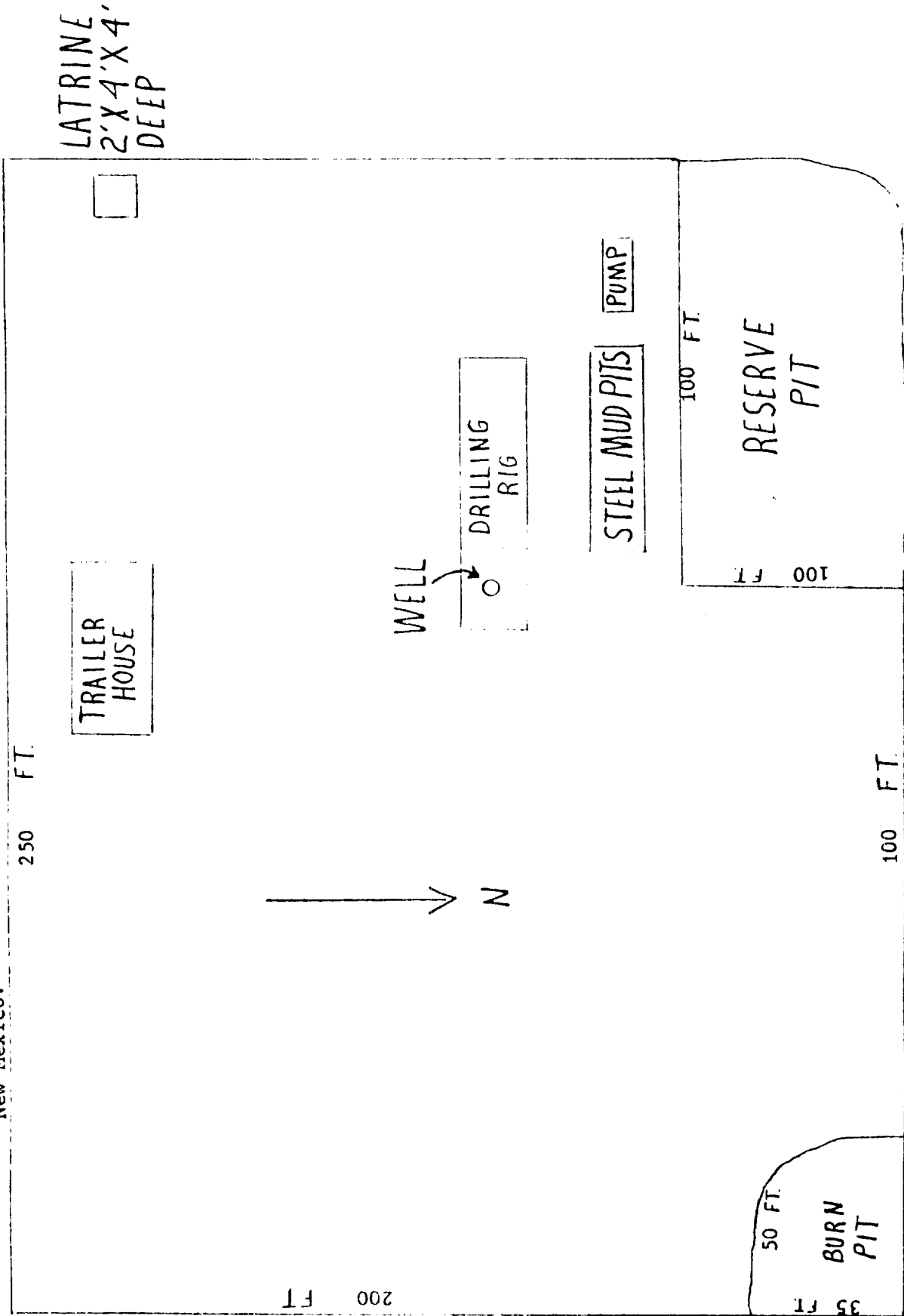

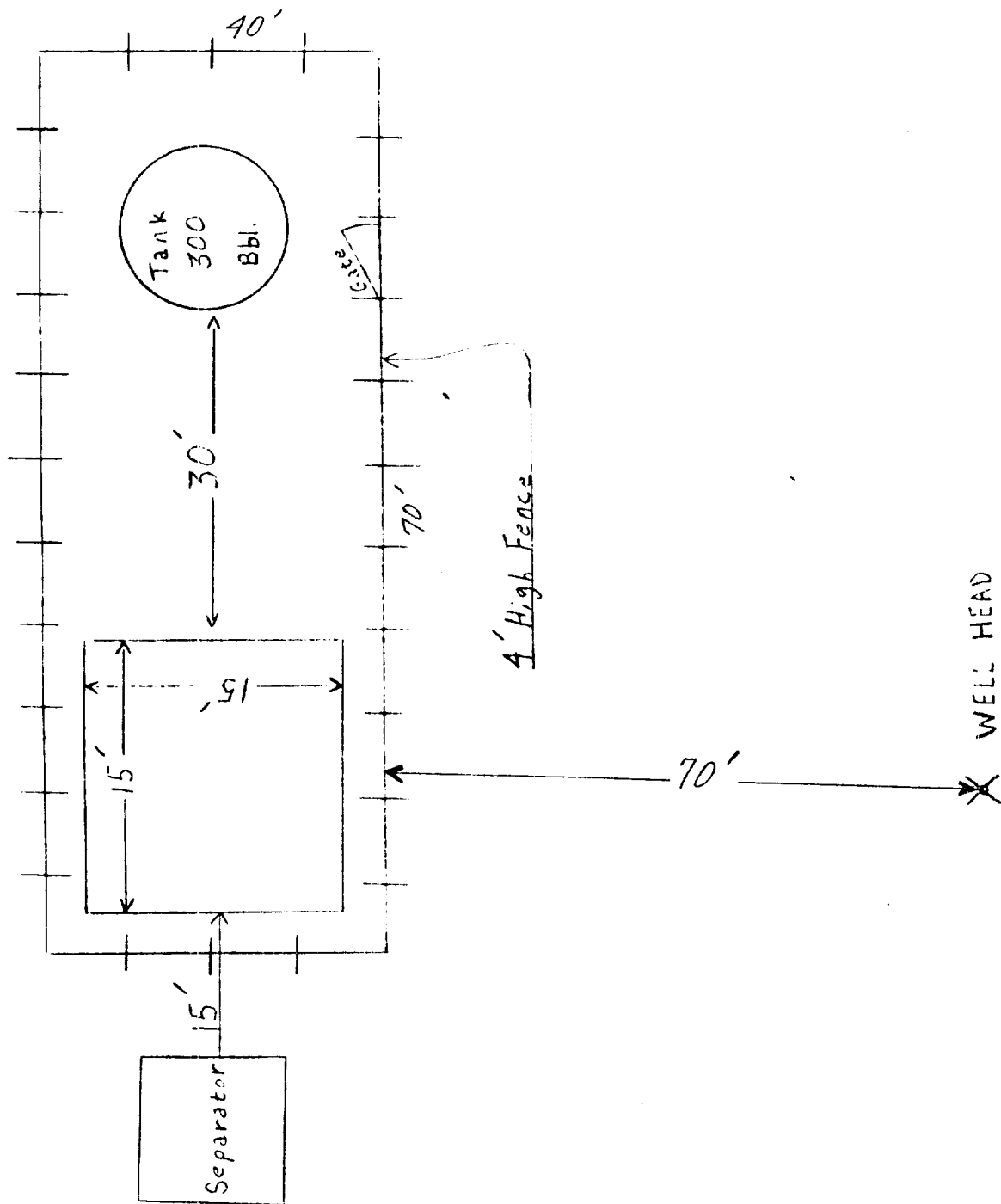

SUPRON ENERGY CORPORATION

POST OFFICE BOX 808

FARMINGTON, NEW MEXICO 87401

October 5, 1977

United States Geological Survey
P. O. Box 1809
Durango, Colorado

Attention: Mr. Jerry Long

Dear Sir:

Supron Energy Corporation proposes to drill the Jicarilla "B" No. 10 well located 850 feet from the North line and 990 feet from the East line of Section 36, Township 26 North, Range 4 West, N.M.P.M., Rio Arriba County, New Mexico.

The following attachments are included with this application:

1. Map of existing roads.
2. No access road is required.
3. Location of existing wells.
4. Lateral roads to well locations.
5. Location of surface equipment, if required.
6. Drilling and completion water will be obtained from the Supron Energy Corporation's Water well located SW/4, Section 23, Township 26 North, Range 4 West, N.M.P.M., Rio Arriba County New Mexico.
7. Waste will be disposed of by being placed in the reserve pit and buried, upon completion of the well.
8. There will be no camp at or near the well site.
9. There will be no air strip.
10. A plat is attached showing the location of the rig, mud tanks, reserve pit, ect.
11. A letter of Certification is attached.
12. After the well is completed the location will be cleaned up and bladed. The reserve pit will be fenced until it has dried and then the pit will be restored to its natural state. The well does not require an access road.
13. The soil is sandy loam with the principal vegetation being Pinon, Sage Brush and Gamma Grass.

SUPRON ENERGY CORPORATION