

UNITED STATES
DEPARTMENT OF THE INTERIOR
GEOLOGICAL SURVEY

SUBMIT IN TRIPLICATE*
(Other instructions on reverse side)

Form approved.
Budget Bureau No. 42-R1424.

5. LEASE DESIGNATION AND SERIAL NO.

NM 03551

6. IF INDIAN, ALLOTTEE OR TRIBE NAME

SUNDRY NOTICES AND REPORTS ON WELLS

(Do not use this form for proposals to drill or to deepen or plug back to a different reservoir.
Use "APPLICATION FOR PERMIT—" for such proposals.)

7. UNIT AGREEMENT NAME

8. FARM OR LEASE NAME

Breech "E"

9. WELL NO.

70

10. FIELD AND POOL, OR WILDCAT

South Blanco Pictured

11. SEC., T., R., M., OR BLK. AND SURVEY OR AREA

Cliffs

Sec 4 26N 6W

12. COUNTY OR PARISH

Rio Arriba

13. STATE

N Mex.

1. OIL WELL ☐ GAS WELL ☒ OTHER

2. NAME OF OPERATOR

Caulkins Oil Company

3. ADDRESS OF OPERATOR

P.O. Box 780 Farmington, New Mexico

4. LOCATION OF WELL (Report location clearly and in accordance with any State requirements.*
See also space 17 below.)
At surface

1450 from the North and 1090 from the East

14. PERMIT NO.

15. ELEVATIONS (Show whether DF, RT, GR, etc.)

6773 Gr

16. Check Appropriate Box To Indicate Nature of Notice, Report, or Other Data

NOTICE OF INTENTION TO:

TEST WATER SHUT-OFF

☐
☐
☐
☐
☐

PULL OR ALTER CASING

☐
☐
☐
☐
☐

FRACTURE TREAT

MULTIPLE COMPLETE

SHOOT OR ACIDIZE

ABANDON*

REPAIR WELL

CHANGE PLANS

(Other)

SUBSEQUENT REPORT OF:

WATER SHUT-OFF

☒
☐
☐
☐

REPAIRING WELL

☐
☐
☐
☐

FRACTURE TREATMENT

ALTERING CASING

SHOOTING OR ACIDIZING

ABANDONMENT*

(Other)

(NOTE: Report results of multiple completion on Well Completion or Recompletion Report and Log form.)

17. DESCRIBE PROPOSED OR COMPLETED OPERATIONS (Clearly state all pertinent details, and give pertinent dates, including estimated date of starting any proposed work. If well is directionally drilled, give subsurface locations and measured and true vertical depths for all markers and zones pertinent to this work.)*

Spud at 12:00 Noon 6-15-78

Drilled 12 1/4" hole to 104'.

Cemented 8 5/8" 24# K-55 new casing at 104' with 100 sacks 3% CaCl.

Cement circulated to surface.

Plug down at 5:15 PM 6-15-78.

Tested surface casing 6-16-78 with 500# for 30 Minutes.

No decrease in pressure.

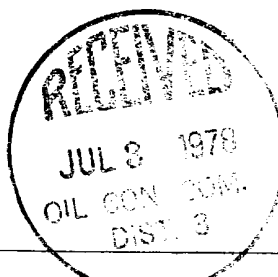

18. I hereby certify that the foregoing is true and correct

SIGNED

Douglas B. Smith

TITLE

Prod. Foreman

DATE

6-17-78

(This space for Federal or State office use)

APPROVED BY

TITLE

DATE

CONDITIONS OF APPROVAL, IF ANY:

*See Instructions on Reverse Side

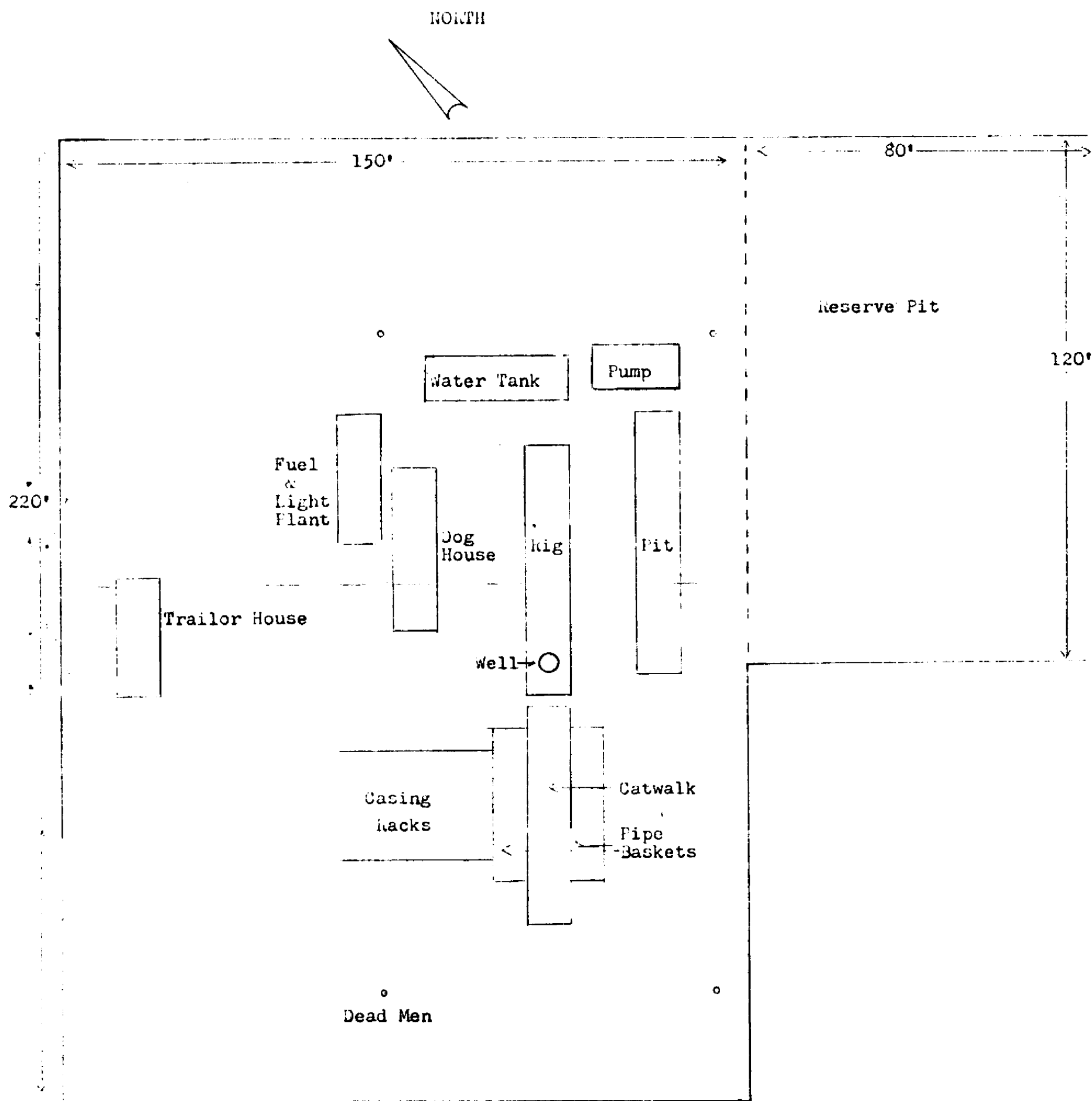

Scale - 1 inch = 25'

Well Number 70

SE NE Section 4 26N 6W

Rio Arriba County, New Mexico