

RECEIVED
JUL 13 1999

JICARILLA APACHE TRIBE
ENVIRONMENTAL PROTECTION OFFICE
P.O. BOX 507
DULCE, NEW MEXICO 87528

85705
Denny E. Felt
NATURAL RESOURCE DEPT
AND OIL & GAS ADMINISTRATION
AUG 13 1999

OIL CON. DIV.
DIST. 3

PIT REMEDIATION AND CLOSURE REPORT

Operator: AMOCO PRODUCTION COMPANY Telephone: (505) 326-9200
Address: 200 Amoco Court, Farmington, NM 87401
Facility or Well Name: JICARILLA A #9
Location: Unit or Qtr/Qtr Sec D Sec 20 T 26N R 5W County RIO ARIZONA
Pit Type: Separator Dehydrator Other PRODUCTION TANK
Land Type: RANGE

Pit Location: (Attach diagram) Pit dimensions: length 15', width 14', depth 8'
Reference: wellhead X, other
Footage from reference: 150'
Direction from reference: 69 Degrees X East of North
 West of South X

Depth To Groundwater: (Vertical distance from contaminants to seasonal high water elevation of groundwater)	Less than 50 feet	(20 points)	<u>0</u>
	50 feet to 99 feet	(10 points)	
	Greater than 100 feet	(0 points)	
Distance to an Ephemeral Stream (Downgradient dry wash greater than ten feet in width)	Less than 100 feet	(10 points)	<u>0</u>
	Greater than 100 feet	(0 points)	
Distance to Nearest Lake, Playa, or Watering Pond (Downgradient lakes, playas and livestock or wildlife watering ponds)	Less than 100 feet	(10 points)	<u>0</u>
	Greater than 100 feet	(0 points)	
Wellhead Protection Area: (Less than 200 feet from a private domestic water source, or: less than 1000 feet from all other water sources)	Yes	(20 points)	<u>0</u>
	No	(0 points)	
Distance To Surface Water: (Horizontal distance to perennial lakes, ponds, rivers, streams, creeks, irrigation canals and ditches)	Less than 100 feet	(20 points)	<u>0</u>
	100 feet to 1000 feet	(10 points)	
	Greater than 1000 feet	(0 points)	

RANKING SCORE (TOTAL POINTS): 0

Date Remediation Started: _____ Date Completed: 12/4/98
Remediation Method: Excavation ☒ Approx. cubic yards 50
(Check all appropriate sections) Landfarmed ☒ Insitu Bioremediation _____
Other _____
Remediation Location: Onsite ☒ Offsite _____
(i.e. landfarmed onsite, name and location of offsite facility)
General Description of Remedial Action: Excavation.
Groundwater Encountered: No ☒ Yes _____ Depth _____

Final Pit: Sample location see Attached Documents
Closure Sampling: _____
(if multiple samples, attach sample results and diagram of sample locations and depths)
Sample depth 8' (PIT Bottom)
Sample date 12/3/98 Sample time 1430

Sample Results

Soil: Benzene	(ppm)	_____	Water: Benzene	(ppb)	_____
Total BTEX	(ppm)	_____	Toluene	(ppb)	_____
Field Headspace	(ppm)	<u>0.0</u>	Ethylbenzene	(ppb)	_____
TPH	(ppm)	<u>ND</u>	Total Xylenes	(ppb)	_____

Groundwater Sample: Yes _____ No ☒ (If yes, attach sample results)

I HEREBY CERTIFY THAT THE INFORMATION ABOVE IS TRUE AND COMPLETE TO THE BEST OF MY KNOWLEDGE AND BELIEF

DATE 12/4/98 PRINTED NAME Buddy D. Shaw
SIGNATURE Buddy D. Shaw AND TITLE Environmental Coordinator

AFTER REVIEW OF THE PIT CLOSURE INFORMATION, PIT CLOSURE IS APPROVED IN ACCORDANCE TO THE JICARILLA APACHE TRIBE PIT CLOSURE ORDINANCE.

APPROVED: YES ☒ NO _____ (REASON) _____

SIGNED: Kurt C. Mammitt DATE: 12-28-98

21643

CLIENT: <u>AMOCO</u>	BLAGG ENGINEERING, INC. P.O. BOX 87, BLOOMFIELD, NM 87413 (505) 632-1199	LOCATION NO: <u>87705</u> C.O.C. NO: <u>6422</u>
----------------------	--	---

FIELD REPORT: CLOSURE VERIFICATION		PAGE No: <u>1</u> of <u>1</u>
LOCATION: NAME: <u>JICA</u> A WELL #: <u>9</u> PIT: <u>PROD. TANK</u>		DATE STARTED: <u>12/3/98</u> DATE FINISHED: _____
QUAD/UNIT: <u>D SEC. 20 TWP. 26N RNG. 5W PM: NM CNTY: RA ST: NM</u>		ENVIRONMENTAL SPECIALIST: <u>NV</u>
QTR/FOOTAGE: <u>980' FNL/835' FWL</u> CONTRACTOR: <u>P+S</u>		

EXCAVATION APPROX. <u>15</u> FT. x <u>14</u> FT. x <u>8</u> FT. DEEP.	CUBIC YARDAGE: <u>50</u>
DISPOSAL FACILITY: <u>ON-SITE</u>	REMEDIATION METHOD: <u>LANDFARM</u>
LAND USE: <u>RANGE</u>	LEASE: <u>JICA</u> FORMATION: <u>MV</u>

FIELD NOTES & REMARKS:	PIT LOCATED APPROXIMATELY <u>150</u> FT. <u>569E</u> FROM WELLHEAD.
DEPTH TO GROUNDWATER: <u>2100'</u>	NEAREST WATER SOURCE: <u>21000'</u> NEAREST SURFACE WATER: <u>21000'</u>
NMOC RANKING SCORE: <u>0</u>	NMOC TPH CLOSURE STD: <u>5000</u> PPM
SOIL AND EXCAVATION DESCRIPTION:	

CHECK ONE:
<input checked="" type="checkbox"/> PIT ABANDONED
<input type="checkbox"/> STEEL TANK INSTALLED
<input type="checkbox"/> FIBERGLASS TANK INSTALLED

MDO. TO OK. YELL. BROWN SAND, NON COHESIVE, SLIGHTLY MOIST, FIRM,
NO APPARENT STAINING OR HC ODOR OBSERVED/DETECTED WITH EXCAVATION,
NO APPARENT HC ODOR IN ANY OF THE OVM SAMPLES.

CLOSED

FIELD 418.1 CALCULATIONS

TIME	SAMPLE I.D.	LAB No.	WEIGHT (g)	mL. FREON	DILUTION	READING	CALC. ppm
1430							

SCALE



0 FT

PIT PERIMETER

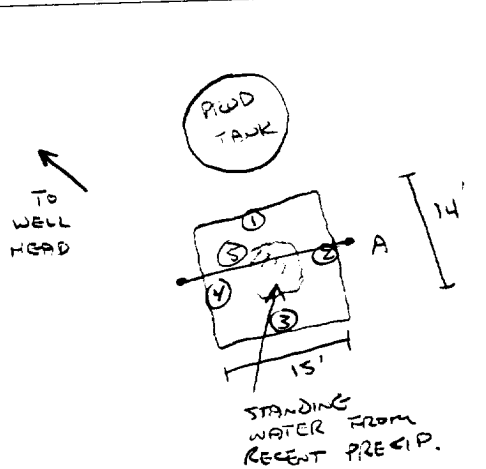

OVM RESULTS

SAMPLE ID	FIELD HEADSPACE PID (ppm)
1 @ 4'	0.0
2 @ 4'	0.0
3 @ 4'	0.0
4 @ 4'	0.0
5 @ 8'	0.0

LAB SAMPLES

SAMPLE ID	ANALYSIS	TIME
5 @ 8'	TPH (418.1)	1430
	PASSED	

PIT PROFILE

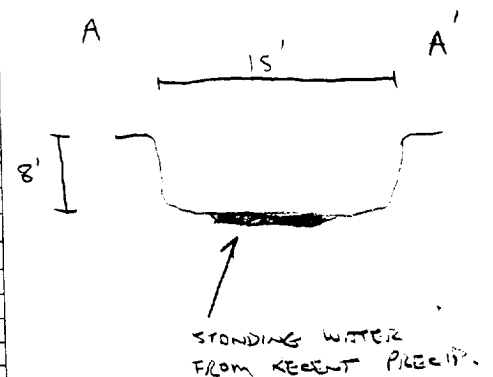

TRAVEL NOTES: CALLOUT: _____ ONSITE: _____

ENVIROTECH LABS

PRACTICAL SOLUTIONS FOR A BETTER TOMORROW

EPA METHOD 418.1 TOTAL PETROLEUM HYDROCARBONS

Client:	Blagg / AMOCO	Project #:	04034-10
Sample ID:	5 @ 8'	Date Reported:	12-04-98
Laboratory Number:	E264	Date Sampled:	12-03-98
Chain of Custody No:	6422	Date Received:	12-04-98
Sample Matrix:	Soil	Date Extracted:	12-04-98
Preservative:	Cool	Date Analyzed:	12-04-98
Condition:	Cool and Intact	Analysis Needed:	TPH-418.1

Parameter	Concentration (mg/kg)	Det. Limit (mg/kg)
Total Petroleum Hydrocarbons	ND	5.0

ND = Parameter not detected at the stated detection limit.

References: Method 418.1, Petroleum Hydrocarbons, Total Recoverable, Chemical Analysis of Water and Waste, USEPA Storet No. 4551, 1978.

Comments: Jicarilla A #9 Production Tank Pit.

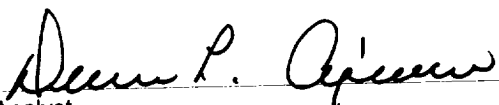
Analyst

Review

BT705

SUBMIT 1 COPY TO
NATURAL RESOURCE DEPT
AND OIL & GAS ADMINISTRATION

**JICARILLA APACHE TRIBE
ENVIRONMENTAL PROTECTION OFFICE
P.O. BOX 507
DULCE, NEW MEXICO 87528**

PIT REMEDIATION AND CLOSURE REPORT

Operator: AMOCO PRODUCTION COMPANY Telephone: (505) 326-9200
Address: 200 Amoco Court, Farmington, NM 87401
Facility or Well Name: JICARILLA A #9
Location: Unit or Qtr/Qtr Sec D Sec 30 T 26N R 5W County Rio Arriba
Pit Type: Separator ☒ Dehydrator ☐ Other ☐
Land Type: RANGE

Pit Location: Pit dimensions: length 15', width 14', depth 13'
(Attach diagram) Reference: wellhead ☒, other ☐
Footage from reference: 93'
Direction from reference: 54 Degrees ☒ East of North ☒
West South ☐

Depth To Groundwater: (Vertical distance from contaminants to seasonal high water elevation of groundwater)	Less than 50 feet	(20 points)	
	50 feet to 99 feet	(10 points)	
	Greater than 100 feet	(0 points)	<u>0</u>
Distance to an Ephemeral Stream (Downgradient dry wash greater than ten feet in width)	Less than 100 feet	(10 points)	
	Greater than 100 feet	(0 points)	<u>0</u>
Distance to Nearest Lake, Playa, or Watering Pond (Downgradient lakes, playas and livestock or wildlife watering ponds)	Less than 100 feet	(10 points)	
	Greater than 100 feet	(0 points)	<u>0</u>
Wellhead Protection Area: (Less than 200 feet from a private domestic water source, or: less than 1000 feet from all other water sources)	Yes	(20 points)	
	No	(0 points)	<u>0</u>
Distance To Surface Water: (Horizontal distance to perennial lakes, ponds, rivers, streams, creeks, irrigation canals and ditches)	Less than 100 feet	(20 points)	
	100 feet to 1000 feet	(10 points)	
	Greater than 1000 feet	(0 points)	<u>0</u>

RANKING SCORE (TOTAL POINTS): 0

Date Remediation Started: _____ Date Completed: 12/4/98

Remediation Method: Excavation ☒ Approx. cubic yards 80
 (Check all appropriate sections) Landfarmed ☒ Insitu Bioremediation _____
 Other _____

Remediation Location: Onsite ☒ Offsite _____
 (i.e. landfarmed onsite, name and location of offsite facility)

General Description of Remedial Action: Excavation, BEDROCK BOTTOM.

Groundwater Encountered: No ☒ Yes _____ Depth _____

Final Pit: Sample location see Attached Documents
 Closure Sampling: _____
 (if multiple samples, attach sample results and diagram of sample locations and depths)

Sample depth 9' (NORTH SIDEWALL)

Sample date 12/3/98 Sample time 1515

Sample Results

Soil: Benzene (ppm) _____	Water: Benzene (ppb) _____
Total BTEX (ppm) _____	Toluene (ppb) _____
Field Headspace (ppm) <u>0.0</u>	Ethylbenzene (ppb) _____
TPH (ppm) <u>65.0</u>	Total Xylenes (ppb) _____

Groundwater Sample: Yes _____ No ☒ (If yes, attach sample results)

I HEREBY CERTIFY THAT THE INFORMATION ABOVE IS TRUE AND COMPLETE TO THE BEST OF MY KNOWLEDGE AND BELIEF

DATE 12/4/98 PRINTED NAME Buddy D. Shaw
 SIGNATURE Buddy D. Shaw AND TITLE Environmental Coordinator

AFTER REVIEW OF THE PIT CLOSURE INFORMATION, PIT CLOSURE IS APPROVED IN ACCORDANCE TO THE JICARILLA APACHE TRIBE PIT CLOSURE ORDINANCE.

APPROVED: YES ☒ NO _____ (REASON) _____

SIGNED: [Signature] DATE: 12-28-98

CLIENT: <u>AMOCO</u>	BLAGG ENGINEERING, INC. P.O. BOX 87, BLOOMFIELD, NM 87413 (505) 632-1199	LOCATION NO: <u>87705</u> C.O.C. NO: <u>6422</u>																																								
FIELD REPORT: CLOSURE VERIFICATION		PAGE No: <u>1</u> of <u>1</u>																																								
LOCATION: NAME: <u>JICA</u> <u>A</u> WELL #: <u>9</u> PIT: <u>SEP</u>		DATE STARTED: <u>12/3/98</u> DATE FINISHED: _____																																								
QUAD/UNIT: <u>D</u> SEC: <u>20</u> TWP: <u>26N</u> RNG: <u>5W</u> PM: <u>NM</u> CNTY: <u>RA</u> ST: <u>NM</u>		ENVIRONMENTAL SPECIALIST: <u>NV</u>																																								
QTR/FOOTAGE: <u>930' FNL/875' FNL</u> CONTRACTOR: <u>P&S</u>																																										
EXCAVATION APPROX. <u>15</u> FT. x <u>14</u> FT. x <u>13</u> FT. DEEP. CUBIC YARDAGE: <u>80</u>																																										
DISPOSAL FACILITY: <u>ON-SITE</u> REMEDIATION METHOD: <u>LANDFARM</u>																																										
LAND USE: <u>RANGE</u> LEASE: <u>JICA</u> FORMATION: <u>MV</u>																																										
FIELD NOTES & REMARKS: PIT LOCATED APPROXIMATELY <u>93</u> FT. <u>NS4E</u> FROM WELLHEAD.																																										
DEPTH TO GROUNDWATER: <u>>100'</u> NEAREST WATER SOURCE: <u>>1000'</u> NEAREST SURFACE WATER: <u>>1000'</u>																																										
NMOCB RANKING SCORE: <u>0</u> NMOCB TPH CLOSURE STD: <u>5000</u> PPM																																										
SOIL AND EXCAVATION DESCRIPTION:																																										
SIDEWALLS - MOD. TO OK. YELL. BROWN SAND, NON COHESIVE SLIGHTLY MOIST, FIRM, NO APPARENT STAINING OR HC ODOR OBSERVED/DETECTED w/in EXCAVATION, NO APPARENT HC ODOR IN ANY OF THE OVM SAMPLES.																																										
BOTTOM - BEDROCK (SANDSTONE) LT. GRAY IN COLOR, VERY HARD, SLIGHT HC ODOR IN OVM SAMPLE.																																										
<div style="display: flex; justify-content: space-between;"> <div style="width: 30%;"> <div style="border: 1px solid black; padding: 5px; margin-bottom: 5px;">BEDROCK BOTTOM</div> <div style="text-align: center;">SCALE</div> <div style="display: flex; align-items: center;"> <div style="width: 20px; height: 10px; background: linear-gradient(to right, black 50%, white 50%); border: 1px solid black; margin: 0 5px;"></div> <div style="margin-left: 5px;">0 FT</div> </div> </div> <div style="width: 30%; text-align: center;"> <div style="border: 1px solid black; border-radius: 50%; padding: 5px; display: inline-block;">CLOSED</div> </div> <div style="width: 35%;"> <div style="text-align: center; font-weight: bold; font-size: small;">FIELD 418.1 CALCULATIONS</div> <table border="1" style="width: 100%; border-collapse: collapse; font-size: x-small;"> <thead> <tr> <th>TIME</th> <th>SAMPLE I.D.</th> <th>LAB No:</th> <th>WEIGHT (g)</th> <th>mL. FREON</th> <th>DILUTION</th> <th>READING</th> <th>CALC. ppm</th> </tr> </thead> <tbody> <tr> <td>1515</td> <td></td> <td></td> <td></td> <td></td> <td></td> <td></td> <td></td> </tr> <tr><td> </td><td></td><td></td><td></td><td></td><td></td><td></td><td></td></tr> <tr><td> </td><td></td><td></td><td></td><td></td><td></td><td></td><td></td></tr> <tr><td> </td><td></td><td></td><td></td><td></td><td></td><td></td><td></td></tr> </tbody> </table> </div> </div>			TIME	SAMPLE I.D.	LAB No:	WEIGHT (g)	mL. FREON	DILUTION	READING	CALC. ppm	1515																															
TIME	SAMPLE I.D.	LAB No:	WEIGHT (g)	mL. FREON	DILUTION	READING	CALC. ppm																																			
1515																																										
<div style="display: flex; justify-content: space-between;"> <div style="width: 45%;"> <div style="text-align: center; font-weight: bold; font-size: small;">PIT PERIMETER</div> </div> <div style="width: 45%;"> <div style="text-align: center; font-weight: bold; font-size: small;">PIT PROFILE</div> </div> </div>																																										
<div style="display: flex; justify-content: space-between;"> <div style="width: 45%;"> <div style="text-align: center; font-weight: bold; font-size: small;">OVM RESULTS</div> <table border="1" style="width: 100%; border-collapse: collapse; font-size: x-small;"> <thead> <tr> <th>SAMPLE ID</th> <th>FIELD HEADSPACE PID (ppm)</th> </tr> </thead> <tbody> <tr><td>1 @ 9'</td><td>0.0</td></tr> <tr><td>2 @ 9'</td><td>0.0</td></tr> <tr><td>3 @ 8'</td><td>0.0</td></tr> <tr><td>4 @ 8'</td><td>0.0</td></tr> <tr><td>5 @ 13'</td><td>48.3</td></tr> <tr><td> </td><td></td></tr> <tr><td> </td><td></td></tr> <tr><td> </td><td></td></tr> <tr><td> </td><td></td></tr> <tr><td> </td><td></td></tr> </tbody> </table> </div> <div style="width: 45%;"> <div style="text-align: center; font-weight: bold; font-size: small;">LAB SAMPLES</div> <table border="1" style="width: 100%; border-collapse: collapse; font-size: x-small;"> <thead> <tr> <th>SAMPLE ID</th> <th>ANALYSIS</th> <th>TIME</th> </tr> </thead> <tbody> <tr> <td>1 @ 9'</td> <td>TAH (418.1)</td> <td>1515</td> </tr> <tr> <td colspan="3" style="text-align: center;"> <div style="border: 1px solid black; border-radius: 50%; padding: 5px; display: inline-block;">PASSED</div> </td> </tr> <tr><td> </td><td></td><td></td></tr> <tr><td> </td><td></td><td></td></tr> <tr><td> </td><td></td><td></td></tr> </tbody> </table> </div> </div>			SAMPLE ID	FIELD HEADSPACE PID (ppm)	1 @ 9'	0.0	2 @ 9'	0.0	3 @ 8'	0.0	4 @ 8'	0.0	5 @ 13'	48.3											SAMPLE ID	ANALYSIS	TIME	1 @ 9'	TAH (418.1)	1515	<div style="border: 1px solid black; border-radius: 50%; padding: 5px; display: inline-block;">PASSED</div>											
SAMPLE ID	FIELD HEADSPACE PID (ppm)																																									
1 @ 9'	0.0																																									
2 @ 9'	0.0																																									
3 @ 8'	0.0																																									
4 @ 8'	0.0																																									
5 @ 13'	48.3																																									
SAMPLE ID	ANALYSIS	TIME																																								
1 @ 9'	TAH (418.1)	1515																																								
<div style="border: 1px solid black; border-radius: 50%; padding: 5px; display: inline-block;">PASSED</div>																																										
TRAVEL NOTES: CALLOUT: _____ ONSITE: _____																																										

Client:	Blagg / AMOCO	Project #:	04034-10
Sample ID:	1 @ 9'	Date Reported:	12-04-98
Laboratory Number:	E265	Date Sampled:	12-03-98
Chain of Custody No:	6422	Date Received:	12-04-98
Sample Matrix:	Soil	Date Extracted:	12-04-98
Preservative:	Cool	Date Analyzed:	12-04-98
Condition:	Cool and Intact	Analysis Needed:	TPH-418.1

Parameter	Concentration (mg/kg)	Det. Limit (mg/kg)
Total Petroleum Hydrocarbons	65.0	5.0

ND = Parameter not detected at the stated detection limit.

References: Method 418.1, Petroleum Hydrocarbons, Total Recoverable, Chemical Analysis of Water and Waste, USEPA Storet No. 4551, 1978.

Comments: Jicarilla A #9 Separator Pit.

Analyst

Review

CHAIN OF CUSTODY RECORD

6422

Client / Project Name			Project Location			ANALYSIS / PARAMETERS											
BARGE / Amoco			TICARUA A #9														
Sampler: NTV			Client No. 0403440														
Sample No./ Identification	Sample Date	Sample Time	Lab Number	Sample Matrix	No. of Containers						Remarks						
⑤ E 8'	12/3/98	1430	E264	SOIL	1	TPH						Production Tank PIT					
① E 9'	12/3/98	1515	E265	SOIL	1	✓						SEPARATOR PIT					
												BOTH SAMPLES					
												PRESERV. - COOL					
Relinquished by: (Signature)			Date			Time			Received by: (Signature)			Date			Time		
Sharon Vot			12/4/98			0732			L. Ojeda			12.4.98			0732		
Relinquished by: (Signature)									Received by: (Signature)								
Relinquished by: (Signature)									Received by: (Signature)								
Sample Receipt																	
Received Intact																	
Cool - Ice/Blue Ice																	

ENVIROTECH INC.

5796 U.S. Highway 64
Farmington, New Mexico 87401
(505) 632-0615

JICARILLA APACHE TRIBE
ENVIRONMENTAL PROTECTION OFFICE
P.O. BOX 507
DULCE, NEW MEXICO 87528

SUBMIT 1 COPY TO
NATURAL RESOURCE DEPT
AND OIL & GAS ADMINISTRATION

ON-SITE SOIL REMEDIATION REPORT

Operator: <u>AMOCO PRODUCTION COMPANY</u>		Telephone: <u>(505) 326-9200</u>
Address: <u>200 Amoco Court, Farmington, NM 87401</u>		
Facility or Well Name: <u>JICARILLA A 9</u>		
Location: Unit or Qtr/Qtr Sec <u>D</u> Sec <u>20</u> T <u>26N</u> R <u>5W</u> County <u>RIO ARriba</u>		
Land Type: _____		
Date Remediation Started: <u>12-3-98</u>		Date Completed: <u>6/2/99</u>
Remediation Method: Landfarmed <input checked="" type="checkbox"/>		Approx. cubic yards <u>130</u>
Composted <input type="checkbox"/>		
Other _____		
Depth To Groundwater: (pts.) <u>0</u>		Final Closure Sampling: Sampling Date: <u>6-1-99</u> Time: <u>1045</u> Sample Results: Field Headspace (ppm) <u>104.9</u> TPH (ppm) <u>296</u> Method <u>8015/8021</u> Other <u>BENZENE 0.745 ppm</u> <u>TOT. BTX 8.160 ppm</u>
Distance to an Ephemeral Stream (pts.) <u>0</u>		
Distance to Nearest Lake, Playa, or Watering Pond (pts.) <u>0</u>		
Wellhead Protection Area: (pts.) <u>0</u>		
Distance To Surface Water: (pts.) <u>0</u>		
RANKING SCORE (TOTAL POINTS): <u>0</u>		
I HEREBY CERTIFY THAT THE INFORMATION ABOVE IS TRUE AND COMPLETE TO THE BEST OF MY KNOWLEDGE AND BELIEF		
DATE <u>6/2/99</u>		PRINTED NAME <u>Buddy D. Shaw</u>
SIGNATURE <u>Buddy D. Shaw</u>		AND TITLE <u>Environmental Coordinator</u>
AFTER REVIEW OF THE SOIL REMEDIATION INFORMATION, ON-SITE REMEDIATION IS APPROVED IN ACCORDANCE TO THE JICARILLA APACHE TRIBE PIT CLOSURE ORDINANCE.		
APPROVED: YES <input checked="" type="checkbox"/> NO <input type="checkbox"/> (REASON) _____		
SIGNED: <u>[Signature]</u>		DATE: <u>6-18-99</u>

CLIENT: <u>AMOCO</u>	BLAGG ENGINEERING, INC. P.O. BOX 87, BLOOMFIELD, NM 87413 (505) 632-1199	LOCATION NO: <u>B5705</u> C.O.C. NO: <u>7054</u>
----------------------	--	---

FIELD REPORT: LANDFARM/COMPOST PILE CLOSURE VERIFICATION

LOCATION: NAME: <u>SICABILLA</u> A WELL #: <u>9</u> PITS: <u>SEP PROD</u>	DATE STARTED: <u>6.99</u> DATE FINISHED: _____
QUAD/UNIT: <u>D SEC: 20 TWP: 26N RNG: 5W PM: NM CNTY: EA ST: NM</u>	ENVIRONMENTAL SPECIALIST: <u>REP</u>
SPT/FOOTAGE: <u>NW/4 NW/4</u> CONTRACTOR: <u>P+S</u>	

SOIL REMEDIATION:

REMEDICATION SYSTEM: LANDFARM

APPROX. CUBIC YARDAGE: 130

LAND USE: RANGE

LIFT DEPTH (ft): 1

FIELD NOTES & REMARKS:

DEPTH TO GROUNDWATER: >100' NEAREST WATER SOURCE: >1000' NEAREST SURFACE WATER: >1000'

NMOCED RANKING SCORE: 0 NMOCED TPH CLOSURE STD: 5000 PPM

DK. YELLOWISH BROWN SAND, NON COHESIVE, SLIGHTLY MOIST, FIRM
NO APPARENT STAINING, H/C ODOR DETECTED IN SAMPLING PTS. ③ + ④
SAMPLING DEPTHS RANGE FROM 6" - 10". COLLECTED A SPT COMPOSITE
SAMPLE FOR LAB ANALYSIS.

FIELD 418.1 CALCULATIONS

SAMP. TIME	SAMPLE I.D.	LAB No:	WEIGHT (g)	mL. FREON	DILUTION	READING	CALC. ppm

SKETCH/SAMPLE LOCATIONS

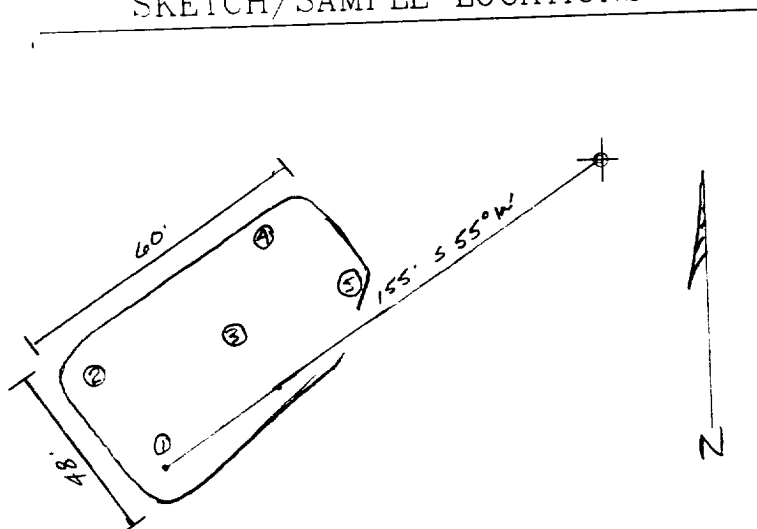

OVM RESULTS

SAMPLE ID	FIELD HEADSPACE PID (ppm)
LF-1	1049

LAB SAMPLES

SAMPLE ID	ANALYSIS	TIME	RESULTS
LF-1	TPH (BOS)	1045	296
"	BENZENE	"	745 ppb
"	TOT. BTEX	"	8,160 ppb

SCALE



TRAVEL NOTES:

CALLOUT: N/A

ONSITE: 6.99

ENVIROTECH LABS

PRACTICAL SOLUTIONS FOR A BETTER TOMORROW

EPA METHOD 8015 Modified Nonhalogenated Volatile Organics Total Petroleum Hydrocarbons

Client: Blagg / AMOCO
Sample ID: LF - 1
Laboratory Number: F444
Chain of Custody No: 7054
Sample Matrix: Soil
Preservative: Cool
Condition: Cool and Intact

Project #: 403410
Date Reported: 06-02-99
Date Sampled: 06-01-99
Date Received: 06-02-99
Date Extracted: 06-02-99
Date Analyzed: 06-02-99
Analysis Requested: 8015 TPH

Parameter	Concentration (mg/Kg)	Det. Limit (mg/Kg)
Gasoline Range (C5 - C10)	85.0	0.2
Diesel Range (C10 - C28)	211	0.1
Total Petroleum Hydrocarbons	296	0.2

ND - Parameter not detected at the stated detection limit.

References: Method 8015B, Nonhalogenated Volatile Organics, Test Methods for Evaluating Solid Waste,
SW-846, USEPA, December 1996.

Comments: Jicarilla A - 9 Landfarm. 5 Pt. Composite.

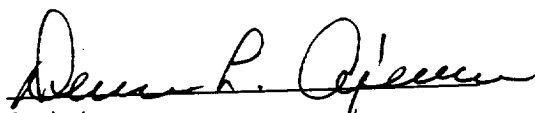
Analyst

Review

ENVIROTECH LABS

PRACTICAL SOLUTIONS FOR A BETTER TOMORROW

EPA METHOD 8021 AROMATIC VOLATILE ORGANICS

Client: Blagg / AMOCO
Sample ID: LF - 1
Laboratory Number: F444
Chain of Custody: 7054
Sample Matrix: Soil
Preservative: Cool
Condition: Cool & Intact

Project #: 403410
Date Reported: 06-02-99
Date Sampled: 06-01-99
Date Received: 06-02-99
Date Analyzed: 06-02-99
Date Extracted: 06-02-99
Analysis Requested: BTEX

Parameter	Concentration (ug/Kg)	Det. Limit (ug/Kg)
Benzene	745	10.4
Toluene	2,860	10.4
Ethylbenzene	761	10.4
p,m-Xylene	3,210	10.4
o-Xylene	580	5.2
Total BTEX	8,160	

ND - Parameter not detected at the stated detection limit.

Surrogate Recoveries:	Parameter	Percent Recovery
	Trifluorotoluene	95 %
	Bromofluorobenzene	95 %

References: Method 5030B, Purge-and-Trap, Test Methods for Evaluating Solid Waste, SW-846, USEPA, December 1996.

Method 8021B, Aromatic Volatile Organics, Test Methods for Evaluating Solid Waste, SW-846, USEPA, December 1996.

Comments: Jicarilla A - 9 Landfarm. 5 Pt. Composite.

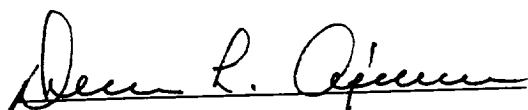
Analyst

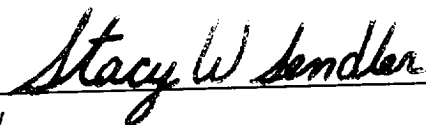
Review

7054

[illegible]