

OIL CONSERVATION COMMISSION
Albuquerque DISTRICT



OIL CONSERVATION COMMISSION
BOX 2088
SANTA FE, NEW MEXICO

Carl Alvord

DATE 1-22-79

RE: Proposed MC ✓
Proposed DHC _____
Proposed NSL _____
Proposed SWD _____
Proposed WFX _____
Proposed PMX _____

Gentlemen:

I have examined the application dated 1-17-79
for the Southland Royalty Co. Jicarilla 101 #7
Operator Lease and Well No. Unit, S-T-R

and my recommendations are as follows:

P-12-26N-4W

Approve

Yours very truly,

AP Kendrick

NEW MEXICO OIL CONSERVATION COMMISSION
SANTA FE, NEW MEXICO
APPLICATION FOR MULTIPLE COMPLETION

Form C-107
5-1-61

| | | | | |
|--|------------------|-------------------------------|------------------------|---------------------------------|
| Operator Southland Royalty Company | | County Rio Arriba | | Date January 17, 1979 |
| Address P. O. Drawer 570 | | Lease Jicarilla 101 | | Well No. #7 |
| Location of Well | Unit P | Section 12 | Township 26N | Range 4W |

1. Has the New Mexico Oil Conservation Commission heretofore authorized the multiple completion of a well in these same pools or in the same zones within one mile of the subject well? YES ☒ NO ☐ **Consolidated Oil & Gas**
2. If answer is yes, identify one such instance: Order No. **1671**; Operator Lease, and Well No.: **Jenny #1**

| 3. The following facts are submitted: | Upper Zone | Intermediate Zone | Lower Zone |
|--|---------------|-------------------|---------------|
| a. Name of Pool and Formation | Mesaverde | | Dakota |
| b. Top and Bottom of Pay Section (Perforations) | 5781' - 5972' | | 7807' - 7997' |
| c. Type of production (Oil or Gas) | Gas | | Gas |
| d. Method of Production (Flowing or Artificial Lift) | Flowing | | Flowing |

4. The following are attached. (Please check YES or NO)

| Yes | No | |
|-------------------------------------|--------------------------|---|
| <input checked="" type="checkbox"/> | <input type="checkbox"/> | a. Diagrammatic Sketch of the Multiple Completion, showing all casing strings, including diameters and setting depths, centralizers and/or turbolizers and location thereof, quantities used and top of cement, perforated intervals, tubing strings, including diameters and setting depth, location and type of packers and side door chokes, and such other information as may be pertinent. |
| <input checked="" type="checkbox"/> | <input type="checkbox"/> | b. Plat showing the location of all wells on applicant's lease, all offset wells on offset leases, and the names and addresses of operators of all leases offsetting applicant's lease. |
| <input checked="" type="checkbox"/> | <input type="checkbox"/> | c. Waivers consenting to such multiple completion from each offset operator, or in lieu thereof, evidence that said offset operators have been furnished copies of the application.* |
| <input checked="" type="checkbox"/> | <input type="checkbox"/> | d. Electrical log of the well or other acceptable log with tops and bottoms of producing zones and intervals of perforation indicated thereon. (If such log is not available at the time application is filed it shall be submitted as provided by Rule 112-A.) |

5. List all offset operators to the lease on which this well is located together with their correct mailing address.

Supron Energy Corporation, P. O. Box 808, Farmington, New Mexico (Mr. Rudy Motto)

Mobil Oil Company, #3 Greenway Plaza East, Ste 800, Houston, Texas 77046 (Mr. E. R. Frazier)

Consolidated Oil & Gas, Inc., Lincoln Tower Bldg., 1860 Lincoln St., Denver, Colorado 80203

J. P. McHugh, c/o Nassau Resources, Inc., Ste. 1225, 600 S. Cherry St., Denver, Co. 80222

6. Were all operators listed in Item 5 above notified and furnished a copy of this application? YES ☒ NO ☐ . If answer is yes, give date of such notification **January 17, 1979**

CERTIFICATE: I, the undersigned, state that I am the **Dist. Production Mgr.** of the **Southland Royalty Company** (company), and that I am authorized by said company to make this report; and that this report was prepared under my supervision and direction and that the facts stated therein are true, correct and complete to the best of my knowledge.

Signature

*Should waivers from all offset operators not accompany an application for administrative approval, the New Mexico Oil Conservation Commission will hold the application for a period of twenty (20) days from date of receipt by the Commission's Santa Fe office. If, after said twenty-day period, no protest nor request for hearing is received by the Santa Fe office, the application will then be processed.

SOUTHLAND ROYALTY COMPANY

DUAL COMPLETION DIAGRAM

Jicarilla 101 #7
1050' FSL & 1180' FEL
Section 12, T26N, R4W
Rio Arriba, New Mexico

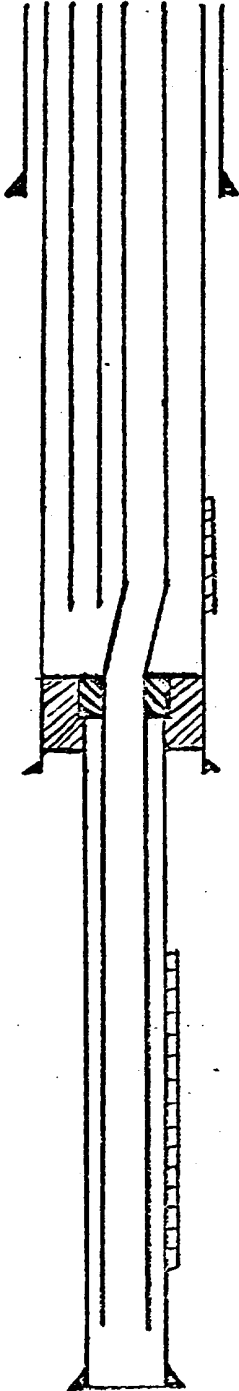

10-3/4", 30#, Genesco casing set at 237'.
Cemented with 140 sxs Class B.

Perforated Pictured Cliffs from 5781'-5972' with
total of 12 holes.

1-1/2", 2.76# & 2.90#, CSR-55, IJ set at 6469'.
5-1/2" liner hanger hung @ 3774'.
Model "F" packer set at 6105'.

7-5/8", 26.40#, N-80 casing set at 3920'.
Cemented with 430 sxs Class B.

Dakota perforated from 7807'-7997' with total of
11 holes.

2-1/16", 3.25#, CSR-55, IJ set at 7978'.

5-1/2", 17# and 15.5#, K-55 liner set from 3774'-
8007'. Cemented with 415 sxs Class B.

**NEW MEXICO OIL CONSERVATION COMMISSION
WELL LOCATION AND ACREAGE DEDICATION PLAT**

Form C-102
Supersedes C-128
Effective 1-1-65

All distances must be from the outer boundaries of the Section.

| | | | | | |
|--|---|------------------------|-------------------------------|-----------------------------|--|
| Operator SOUTHLAND ROYALTY COMPANY | | | Lease JICARILLA 101 | | Well No. 7 |
| Unit Letter P | Section 12 | Township 26N | Range 4W | County Rio Arriba | |
| Actual Footage Location of Well: 1050 feet from the South line and 1180 feet from the East line | | | | | |
| Ground Level Elev. 6914' | Producing Formation Mesaverde | | Pool Blanco | | Dedicated Acreage: 320 Acres |

1. Outline the acreage dedicated to the subject well by colored pencil or hachure marks on the plat below.
2. If more than one lease is dedicated to the well, outline each and identify the ownership thereof (both as to working interest and royalty).
3. If more than one lease of different ownership is dedicated to the well, have the interests of all owners been consolidated by communitization, unitization, force-pooling, etc?

☐ Yes ☐ No If answer is "yes," type of consolidation _____

If answer is "no," list the owners and tract descriptions which have actually been consolidated. (Use reverse side of this form if necessary.) _____

No allowable will be assigned to the well until all interests have been consolidated (by communitization, unitization, forced-pooling, or otherwise) or until a non-standard unit, eliminating such interests, has been approved by the Commission.

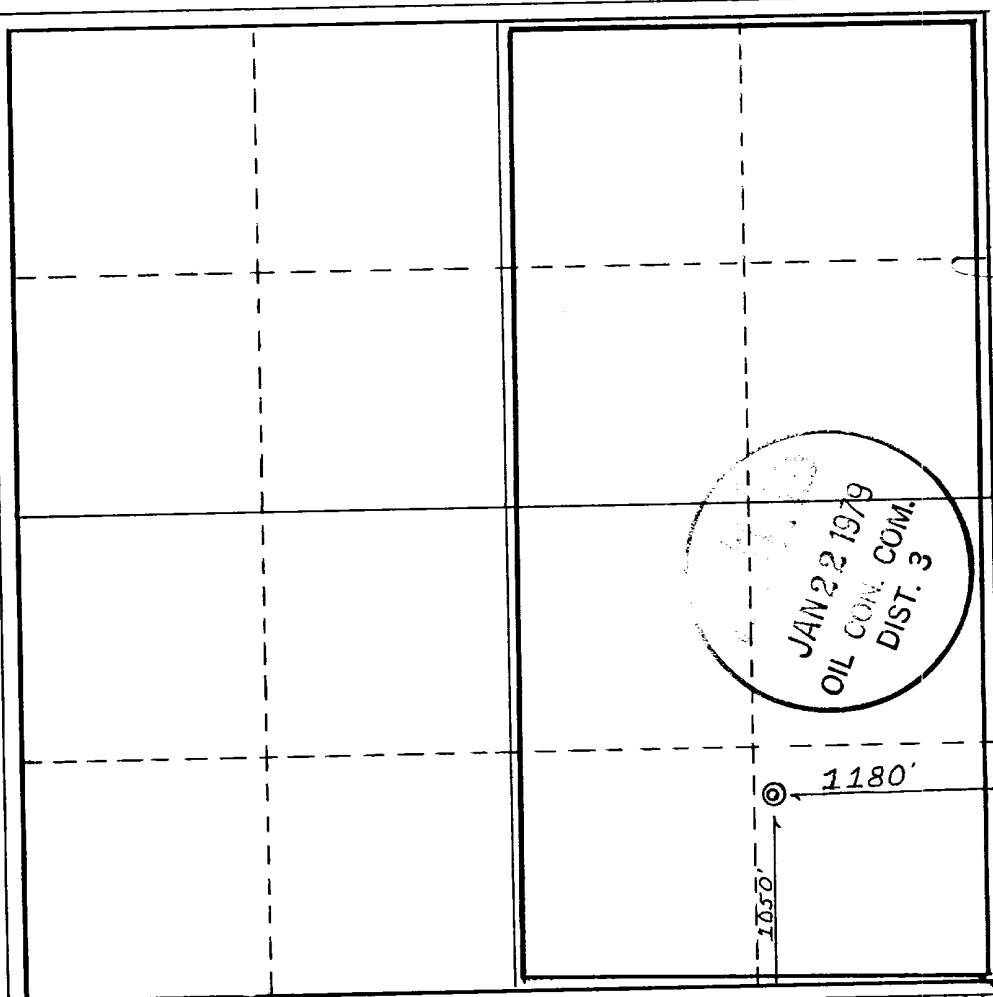

CERTIFICATION

I hereby certify that the information contained herein is true and complete to the best of my knowledge and belief.

Name _____
 Position _____
Dist. Production Manager
 Company _____
Southland Royalty Company
 Date _____
January 17, 1979

I hereby certify that the well location shown on this plat was plotted from field notes of actual surveys made by me or under my supervision, and that the same is true and correct to the best of my knowledge and belief.

July 18, 1978

Date Surveyed

Registered Professional Engineer
and/or Land Surveyor

Certificate No.

R-4-W

R-3-W

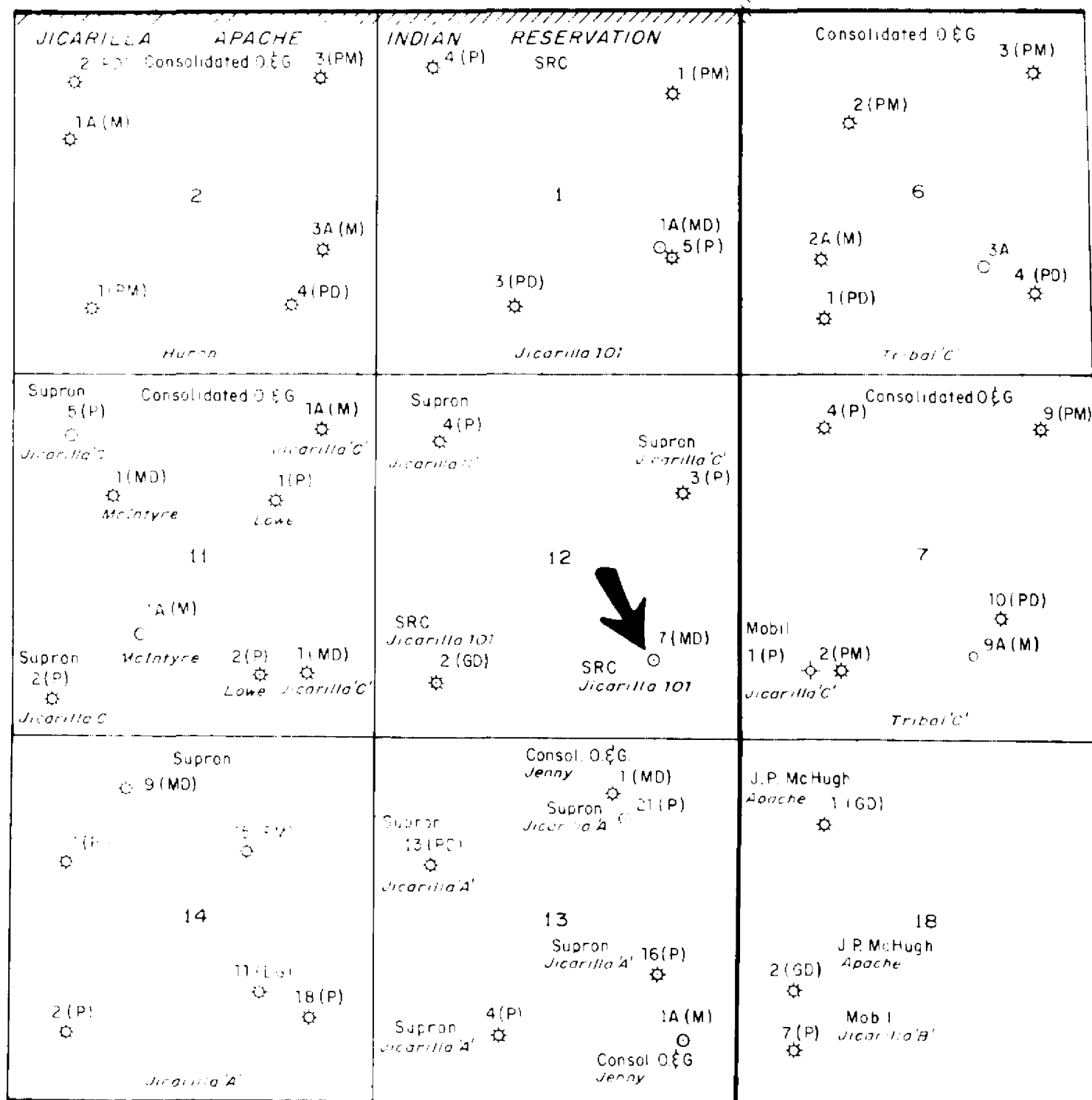
T
26
N

Southland Royalty Company

P.O. Drawer 570
Farmington, New Mexico 87401

8-10-1978

DATE

C. Parsons

PREPARED BY

San Juan Basin

PROJECT AREA

1" = 2000'

SCALE

REVISED DATE

FILE NUMBER

RIO ARRIBA CO., NEW MEXICO

OFFSET OPERATORS'
PERMISSION FOR DUAL COMPLETIONSSRC
Jicarilla 101 #7
SE 1/4 Sec. 12-26N-4W