

UNITED STATES  
DEPARTMENT OF THE INTERIOR  
GEOLOGICAL SURVEY

## APPLICATION FOR PERMIT TO DRILL, DEEPEN, OR PLUG BACK

## 1a. TYPE OF WORK

DRILL ☒DEEPEN ☐PLUG BACK ☐

## b. TYPE OF WELL

OIL  
WELL ☐GAS  
WELL ☒

OTHER

SINGLE  
ZONE ☐MULTIPLE  
ZONE ☐

## 2. NAME OF OPERATOR

Supron Energy Corporation

## 3. ADDRESS OF OPERATOR

P.O. Box 808 Farmington, New Mexico 87401

## 4. LOCATION OF WELL (Report location clearly and in accordance with any State requirements.)\*

At surface

1710 ft. from West line and 1850 ft. from South line.

At proposed prod. zone Same as above.

## 14. DISTANCE IN MILES AND DIRECTION FROM NEAREST TOWN OR POST OFFICE\*

12 miles northwest of Ojito, New Mexico

## 15. DISTANCE FROM PROPOSED\*

LOCATION TO NEAREST  
PROPERTY OR LEASE LINE, FT.  
(Also to nearest drlg. unit line, if any)

1850 ft.

790 ft.

## 16. NO. OF ACRES IN LEASE

2560

18. DISTANCE FROM PROPOSED LOCATION\*  
TO NEAREST WELL, DRILLING, COMPLETED,  
OR APPLIED FOR, ON THIS LEASE, FT.

209 ft.

## 19. PROPOSED DEPTH

8300 ft.

17. NO. OF ACRES ASSIGNED  
TO THIS WELL

5-1/2 - 320 acres

## 20. ROTARY OR CABLE TOOLS

Rotary

## 21. ELEVATIONS (Show whether DF, RT, GR, etc.)

7175 Gr.

## 22. APPROX. DATE WORK WILL START\*

## 23.

## PROPOSED CASING AND CEMENTING PROGRAM

SIZE OF HOLE	SIZE OF CASING	WEIGHT PER FOOT	SETTING DEPTH	QUANTITY OF CEMENT
13-3/4"	10-3/4"	32.75	187	250 cu. ft.
9-7/8"	7-5/8"	26.40	4050	1273 cu. ft.
6-3/4"	5-1/2"	15.50	8300	660 cu. ft.

It is proposed to drill this well to be completed in the Dakota formation. After the well is drilled, pipe will be ran and cemented. The casing will be perforated and sand water fraced. Tubing will then be run and landed at approximately 8000 feet. This well will replace the plugged Jicarilla "A" No. 22 well located 1850 feet from the South line and 1745 feet from the West line of Sec. 24, Twp.-26N, Rge- 4 W, N.M.P.M. of Rio Arriba County, New Mexico. This well was verbally approved by Mr. Jerry Long w/U.S.G.S. and Mr. A.R. Kendrick w/N.M.O.C.C.

NO ADDITIONAL SURFACE DISTURBANCE  
SAME SURFACE DISTURBANCE PLAN AS  
PREVIOUS EIA IS ACCEPTABLE TO E.I.A.

IN ABOVE SPACE DESCRIBE PROPOSED PROGRAM: If proposal is to deepen or plug back, give data on present productive zone and proposed new productive zone. If proposal is to drill or deepen directionally, give pertinent data on subsurface locations and measured and true vertical depths. Give blowout preventer program, if any.

## 24.

SIGNED

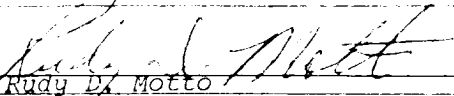

TITLE Area Superintendent

DATE 8-14-78

(This space for Federal or State office use)

PERMIT NO.

APPROVAL DATE

APPROVED

CONDITION OF APPROVAL, IF ANY:

TITLE

DATE

\*See Instructions On Reverse Side

**NEW MEXICO OIL CONSERVATION COMMISSION  
WELL LOCATION AND ACREAGE DEDICATION PLAT**

Form C-102  
Supersedes C-128  
Effective 1-1-65

All distances must be from the outer boundaries of the Section.

Operator <b>SUPRON ENERGY CORPORATION</b>			Lease <b>JICARILLA A</b>		Well No. <b>22-Y</b>
Unit Letter <b>K</b>	Section <b>24</b>	Township <b>26 NORTH</b>	Range <b>4 WEST</b>	County <b>RIO ARriba</b>	
Actual Footage Location of Well: <b>1710</b> feet from the <b>WEST</b> line and <b>1850</b> feet from the <b>SOUTH</b> line					
Ground Level Elev. <b>7175</b>	Producing Formation <b>DAKOTA</b>		Pool <b>BAILE</b>	Dedicated Acreage: <b>1 1/2</b> <b>330</b> Acres	

1. Outline the acreage dedicated to the subject well by colored pencil or hachure marks on the plat below.
2. If more than one lease is dedicated to the well, outline each and identify the ownership thereof (both as to working interest and royalty).
3. If more than one lease of different ownership is dedicated to the well, have the interests of all owners been consolidated by communitization, unitization, force-pooling, etc?

☐ Yes    ☐ No    If answer is "yes," type of consolidation \_\_\_\_\_

If answer is "no," list the owners and tract descriptions which have actually been consolidated. (Use reverse side of this form if necessary.) \_\_\_\_\_

No allowable will be assigned to the well until all interests have been consolidated (by communitization, unitization, forced-pooling, or otherwise) or until a non-standard unit, eliminating such interests, has been approved by the Commission.

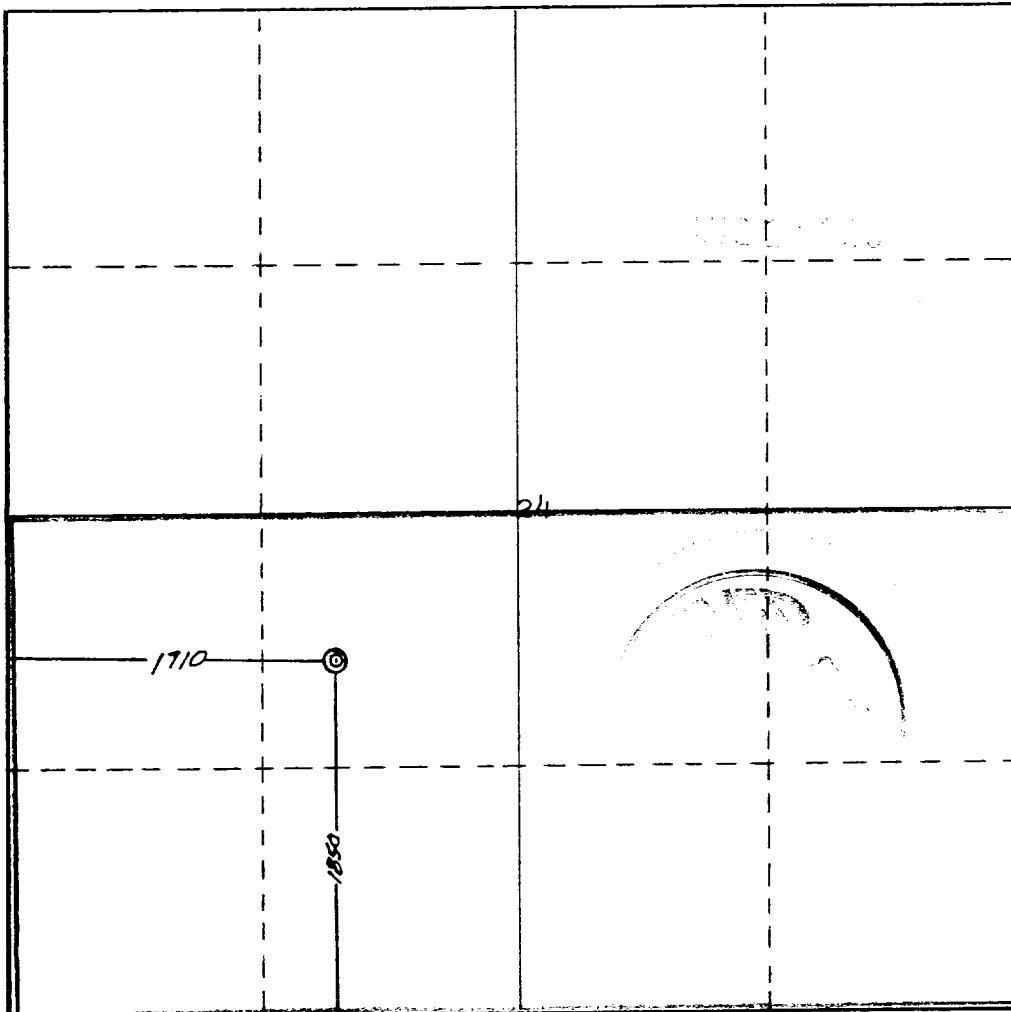

**CERTIFICATION**

I hereby certify that the information contained herein is true and complete to the best of my knowledge and belief.  
Original Signed By

Name **Rudy D. Motto**  
**Rudy D. Motto**  
 Position **Area Superintendent**  
 Company **Supron Energy Corporation**  
 Date **August 14, 1978**

I hereby certify that the well shown on this plat was plotted from field notes of actual surveys made by me under my supervision, and that the same is true and correct to the best of my knowledge and belief.

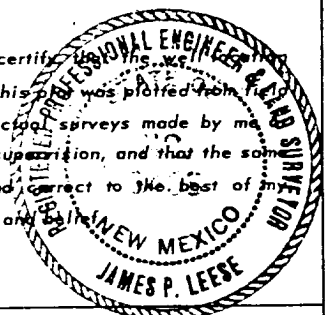

Date Surveyed **11 AUGUST, 1978**  
 Registered Professional Engineer and of Land Surveyor  
*James P. Leese*  
**James P. Leese**  
 Certificate No. **1463**

0 330 660 990 1320 1650 1980 2310 2640 2000 1500 1000 500 0