

NEW MEXICO OIL CONSERVATION COMMISSION
WELL LOCATION AND ACREAGE DEDICATION PLAT

Form C-102
Supercedes C-128
Effective 1-1-65

All distances must be from the outer boundaries of the Section.

Operator SUPRON ENERGY CORPORATION			Lease JICARILLA "A"		Well No. 22-Y
Unit Letter K	Section 24	Township 26 North	Range 4 West	County Rio Arriba	
Actual Footage Location of Well:					
1710 feet from the West line and		1850 feet from the South line			
Ground Level Elev. 7175	Producing Formation Dakota Gallup Mesaverde	Pool Basin Wildhorse Blanco	Dedicated Acreage: S/2 320 SW/4 160 S/2 320 Acres		

1. Outline the acreage dedicated to the subject well by colored pencil or hachure marks on the plat below.
2. If more than one lease is dedicated to the well, outline each and identify the ownership thereof (both as to working interest and royalty).
3. If more than one lease of different ownership is dedicated to the well, have the interests of all owners been consolidated by communitization, unitization, force-pooling, etc?

☐ Yes ☐ No If answer is "yes," type of consolidation _____

If answer is "no," list the owners and tract descriptions which have actually been consolidated. (Use reverse side of this form if necessary.) _____

No allowable will be assigned to the well until all interests have been consolidated (by communitization, unitization, forced-pooling, or otherwise) or until a non-standard unit, eliminating such interests, has been approved by the Commission.

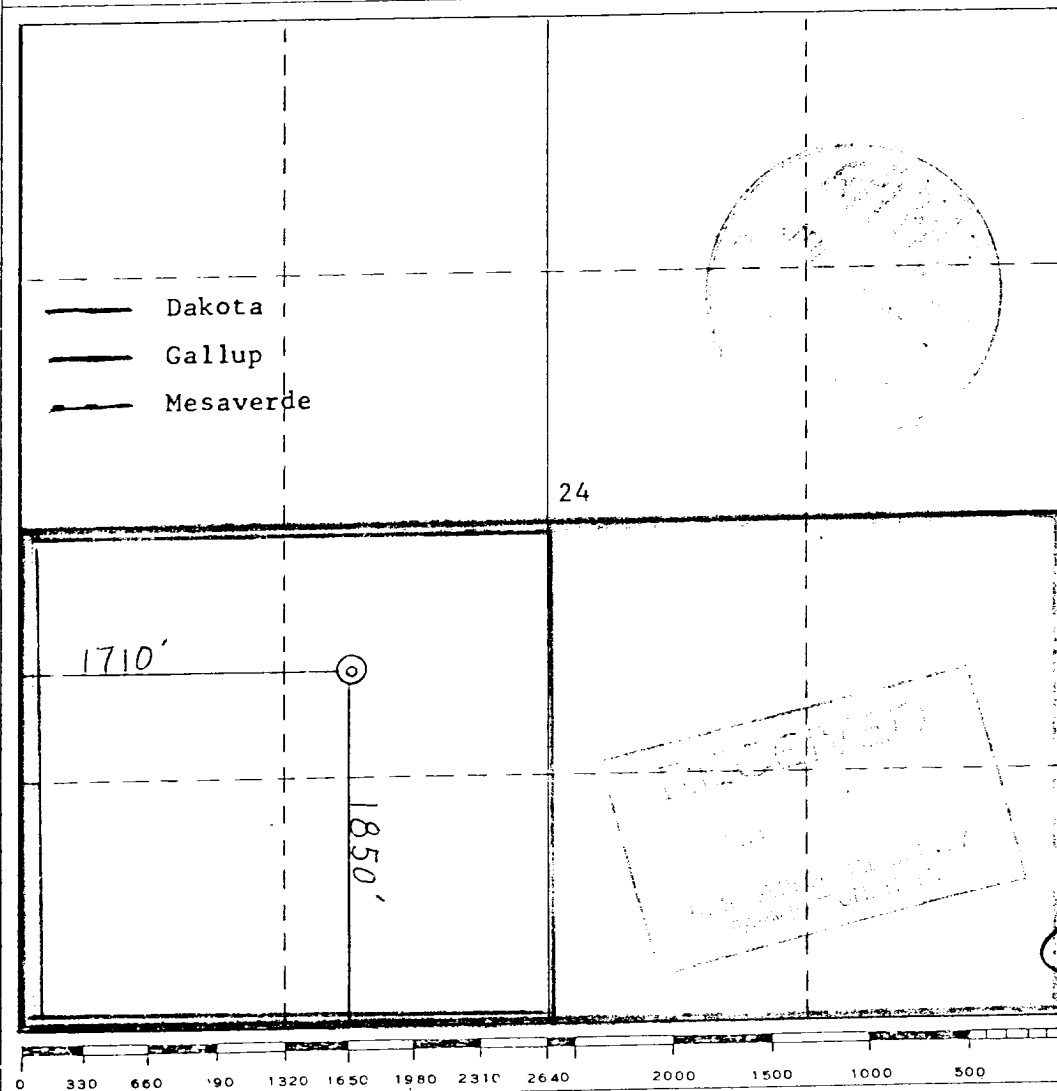

CERTIFICATION

I hereby certify that the information contained herein is true and complete to the best of my knowledge and belief.

Rudy D. Motto
Name

Rudy D. Motto

Position

Area Superintendent

Company

Supron Energy Corporation

Date

May 9, 1980

I hereby certify that the well location shown on this plat was plotted from field notes, actual surveys made by me or under my supervision, and that the same is true and correct to the best of my knowledge and belief.

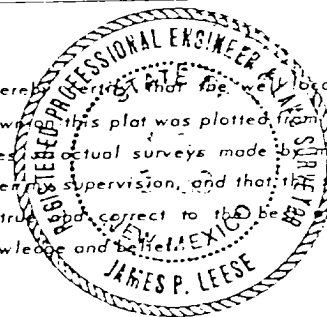

Date Surveyed

11 August 1978

Registered Professional Engineer
and/or Land Surveyor

James P. Leese

Certificate No.