

UNITED STATES
DEPARTMENT OF THE INTERIOR
GEOLOGICAL SURVEY30-038-21998
5. LEASE DESIGNATION AND SERIAL NO.
NM 03381

APPLICATION FOR PERMIT TO DRILL, DEEPEN, OR PLUG BACK

6. IF INDIAN, ALLOTTEE OR TRIBE NAME

7. UNIT AGREEMENT NAME

8. FARM OR LEASE NAME

Breech "B"

9. WELL NO.

220-R

10. FIELD AND POOL, OR WILDCAT

Blanco M. V. S.
Basin Dakota, Otter Creek11. SEC., T., R., M., OR BLK.
AND SURVEY OR AREA

Sec. 14 26N 7W

12. COUNTY OR PARISH

Rio Arriba

13. STATE

New Mexico

1a. TYPE OF WORK

DRILL ☒DEEPEN ☐PLUG BACK ☐

b. TYPE OF WELL

OIL
WELL ☐GAS
WELL ☒

OTHER

SINGLE
ZONE ☐MULTIPLE
ZONE ☒

2. NAME OF OPERATOR

Caulkins Oil Company

3. ADDRESS OF OPERATOR

Post Office Box 780, Farmington, New Mexico 87401

4. LOCATION OF WELL (Report location clearly and in accordance with any State requirements.)*

At surface

1750' from the East Line and 944' from the North Line.

At proposed prod. zone

Same

14. DISTANCE IN MILES AND DIRECTION FROM NEAREST TOWN OR POST OFFICE*

35 miles Southeast of Blanco, New Mexico

15. DISTANCE FROM PROPOSED*
LOCATION TO NEAREST
PROPERTY OR LEASE LINE, FT.
(Also to nearest drig. unit line, if any)16. NO. OF ACRES IN LEASE
112017. NO. OF ACRES ASSIGNED
TO THIS WELL
10/320, 1/320, 160, 16018. DISTANCE FROM PROPOSED LOCATION*
TO NEAREST WELL, DRILLING, COMPLETED,
OR APPLIED FOR, ON THIS LEASE, FT.19. PROPOSED DEPTH
730020. ROTARY OR CABLE TOOLS
Rotary

21. ELEVATIONS (Show whether DF, RT, GR, etc.)

6537 GR.

22. APPROX. DATE WORK WILL START*

April 1, 1979

23.

PROPOSED CASING AND CEMENTING PROGRAM

SIZE OF HOLE	SIZE OF CASING	WEIGHT PER FOOT	SETTING DEPTH	QUANTITY OF CEMENT
13 3/4	9 5/8	36 #	300'	Sufficient to circulate
8 3/4	7"	23 and 26 #	7300'	1250 sacks

Surface formation San Jose. No abnormal pressure or temperature anticipated. It is proposed to drill well to 7300' using 9# Gel based mud. Float will be run in Drill Pipe at Bit. ES Ind., Density and Caliper logs will be run in open hole. New 7" 23# & 26# J-55 Smls Casing will be cemented at TD with sufficient cement to circulate to surface. Pipe will be cemented in 3 stages. Casing will have rotating Scratchers over Pictured Cliffs, Chacra, Mesa Verde and Dakota Zones. Stage tools will be run below base of Point Lookout and below base of Pictured Cliffs sands. Centralizers and cement baskets will also be run on casing thru pay zones.

A Shaffer 10" Model LWP, 6000# test blowout preventor will be in use at all times while drilling and cementing. Blowout preventor will be tested each day.

It is proposed to run New 2 3/8" tubing to Dakota zone with packer set between Mesa Verde zone and Dakota zone. 2 3/8" EUE tubing will be run to Mesa Verde for Mesa Verde, Chacra and Pictured Cliffs Production.
(over)

IN ABOVE SPACE DESCRIBE PROPOSED PROGRAM: If proposal is to deepen or plug back, give data on present productive zone and proposed new productive zone. If proposal is to drill or deepen directionally, give pertinent data on subsurface locations and measured and true vertical depths. Give blowout preventer program, if any.

24.

SIGNED Charles E. Vergue TITLE Superintendent DATE 1-10-79

(This space for Federal or State office use)

PERMIT NO. _____ APPROVAL DATE _____

APPROVED BY _____ TITLE _____ DATE _____

CONDITIONS OF APPROVAL, IF ANY:

ok Frank

JAN-11-1979

*See Instructions On Reverse Side

Instructions

General: This form is designed for submitting proposals to perform certain well operations, as indicated, on all types of lands and leases for appropriate action by either a Federal or a State agency, or both, pursuant to applicable Federal and/or State laws and regulations. Any necessary special instructions concerning the use of this form and the number of copies to be submitted, particularly with regard to local, area, or regional procedures and practices, either are shown below or will be issued by, or may be obtained from, the local Federal and/or State office.

Item 1: If the proposal is to redrill to the same reservoir at a different subsurface location or to a new reservoir, use this form with appropriate notations. Consult applicable State or Federal regulations concerning subsequent work proposals or reports on the well.

Item 4: If there are no applicable State requirements, locations on Federal or Indian land should be described in accordance with Federal requirements. Consult local State or Federal office for specific instructions.

Item 14: Needed only when location of well cannot readily be found by road from the land or lease description. A plat, or plats, separate or on this reverse side, showing the roads to, and the surveyed location of, the well, and any other required information, should be furnished when required by Federal or State agency offices.

Items 15 and 18: If well is to be, or has been directionally drilled, give distances for subsurface location of hole in any present or objective production zone.

Item 22: Consult applicable Federal or State regulations, or appropriate officials, concerning approval of the proposal before operations are started.

Completion of this well as shown above subject to approval by New Mexico Oil Conservation Commission for commingling of Mesa Verde, Chacra and Pictured Cliffs in wellbore. If commingling denied well will be completed as Mesa Verde - Dakota Dual.

All zones to be completed will be fractured to stimulate production.

**NEW MEXICO OIL CONSERVATION COMMISSION
WELL LOCATION AND ACREAGE DEDICATION PLAT**

Form C-102
Supersedes C-128
Effective 1-1-65

All distances must be from the outer boundaries of the Section.

Operator Caulkins Oil Company			Lease NM 03381		Well No. 220 R
Unit Letter B	Section 14	Township 26 North	Range 7 West	County Rio Arriba	
Actual Footage Location of Well: <div style="display: flex; justify-content: space-between; align-items: center;"> 944 feet from the North line and 1750 feet from the West line </div>					
Ground Level Elev. 6537	Producing Formation Dakota	Pool Basin Dakota		Dedicated Acreage: 320 Acres	

1. Outline the acreage dedicated to the subject well by colored pencil or hatchure marks on the plat below.
2. If more than one lease is dedicated to the well, outline each and identify the ownership thereof (both as to working interest and royalty).
3. If more than one lease of different ownership is dedicated to the well, have the interests of all owners been consolidated by communitization, unitization, force-pooling, etc?

☐ Yes ☐ No If answer is "yes," type of consolidation _____

If answer is "no," list the owners and tract descriptions which have actually been consolidated. (Use reverse side of this form if necessary.) _____

No allowable will be assigned to the well until all interests have been consolidated (by communitization, unitization, forced-pooling, or otherwise) or until a non-standard unit, eliminating such interests, has been approved by the Commission.

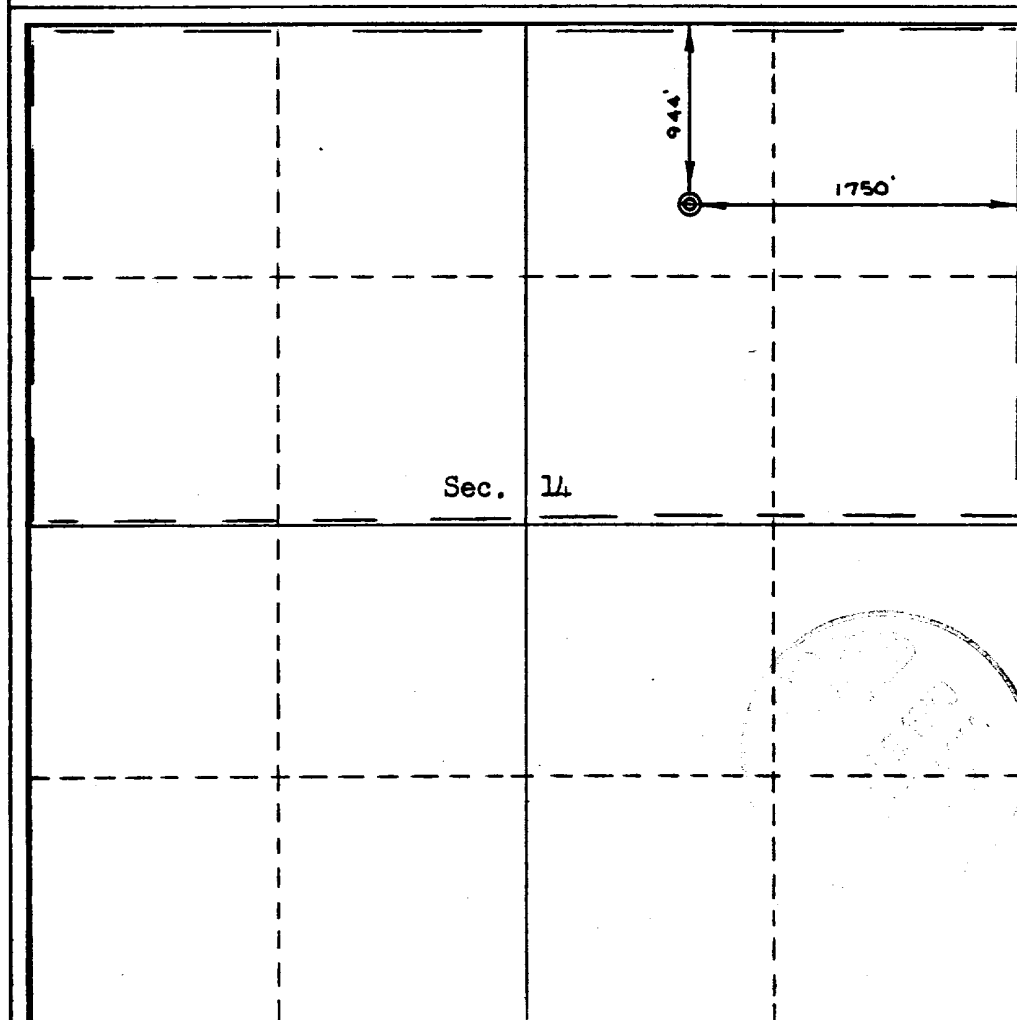

CERTIFICATION

I hereby certify that the information contained herein is true and complete to the best of my knowledge and belief.

Name *Charles E. Viquez*
Position
Superintendent

Company
Caulkins Oil Company

Date
1-10-79

I hereby certify that the location shown on this plat was plotted from field notes of actual survey made by me or under my supervision, and that the same is true and correct to the best of my knowledge and belief.

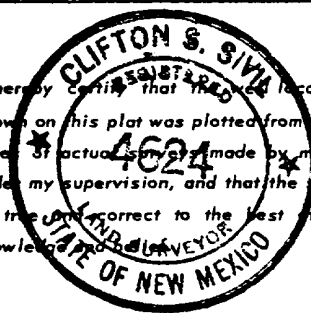

Date Surveyed
December 29, 1978

Registered Professional Engineer
and/or Land Surveyor

Certificate No. **4624**
Clifton S. Sivil LS

**NEW MEXICO OIL CONSERVATION COMMISSION
WELL LOCATION AND ACREAGE DEDICATION PLAT**

Form C-102
Supersedes C-128
Effective 1-1-65

All distances must be from the outer boundaries of the Section.

Operator Caulkins Oil Company			Lease NM 03381		Well No. 220 R
Unit Letter B	Section 14	Township 26 North	Range 7 West	County Rio Arriba	
Actual Footage Location of Well: <div style="display: flex; justify-content: space-between;"> 944 feet from the North line and 1750 feet from the West line </div>					
Ground Level Elev: 6537	Producing Formation Mesa Verde	Pool Blanco Mesa Verde <i>ext</i>	Dedicated Acreage: 320 Acres		

1. Outline the acreage dedicated to the subject well by colored pencil or hachure marks on the plat below.
2. If more than one lease is dedicated to the well, outline each and identify the ownership thereof (both as to working interest and royalty).
3. If more than one lease of different ownership is dedicated to the well, have the interests of all owners been consolidated by communitization, unitization, force-pooling, etc?

☐ Yes ☐ No If answer is "yes," type of consolidation _____

If answer is "no," list the owners and tract descriptions which have actually been consolidated. (Use reverse side of this form if necessary.) _____

No allowable will be assigned to the well until all interests have been consolidated (by communitization, unitization, forced-pooling, or otherwise) or until a non-standard unit, eliminating such interests, has been approved by the Commission.

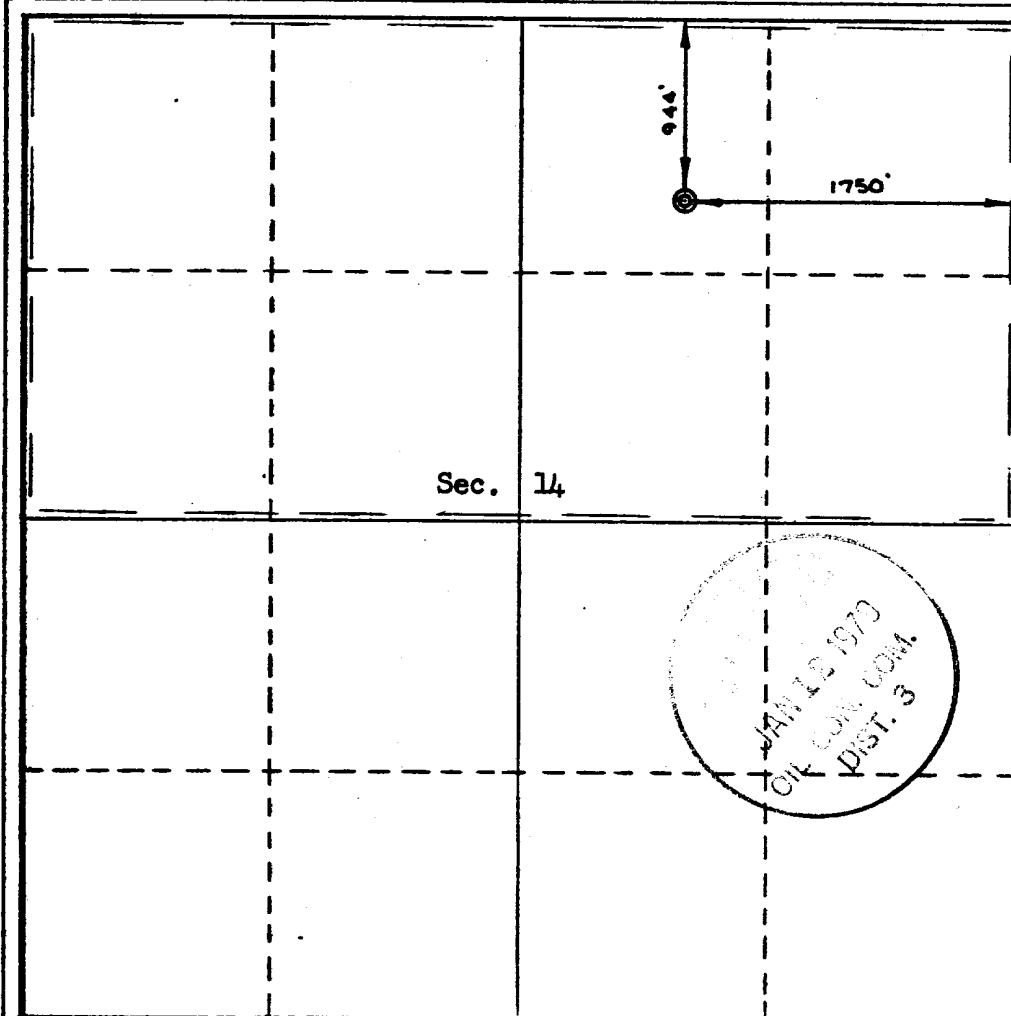

CERTIFICATION

I hereby certify that the information contained herein is true and complete to the best of my knowledge and belief.

Name Charles E. Vergara
Position **Superintendent**

Company **Caulkins Oil Company**

Date **1-10-79**

I hereby certify that the location shown on this plat was plotted from field notes of actual survey made by me or under my supervision, and that the same is true and correct to the best of my knowledge and belief.

Date Surveyed
December 29, 1978

Registered Professional Engineer
and/or Land Surveyor

Certificate No. **4624**
Clifton S. Sivil LS

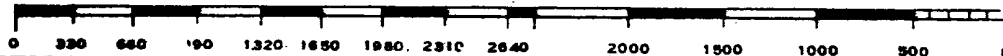

**NEW MEXICO OIL CONSERVATION COMMISSION
WELL LOCATION AND ACREAGE DEDICATION PLAT**

Form C-102
Supersedes C-128
Effective 1-1-65

All distances must be from the outer boundaries of the Section.

Operator Caulkins Oil Company			Lease NM 03381		Well No. 220 R
Unit Letter B	Section 14	Township 26 North	Range 7 West	County Rio Arriba	
Actual Footage Location of Well: 944 feet from the North line and 1750 feet from the West line					
Ground Level Elev. 6537	Producing Formation Chacra	Pool Otero Chacra	Dedicated Acreage: 160 Acres		

1. Outline the acreage dedicated to the subject well by colored pencil or hatchure marks on the plat below.
2. If more than one lease is dedicated to the well, outline each and identify the ownership thereof (both as to working interest and royalty).
3. If more than one lease of different ownership is dedicated to the well, have the interests of all owners been consolidated by communitization, unitization, force-pooling, etc?

☐ Yes ☐ No If answer is "yes," type of consolidation _____

If answer is "no," list the owners and tract descriptions which have actually been consolidated. (Use reverse side of this form if necessary.) _____

No allowable will be assigned to the well until all interests have been consolidated (by communitization, unitization, forced-pooling, or otherwise) or until a non-standard unit, eliminating such interests, has been approved by the Commission.

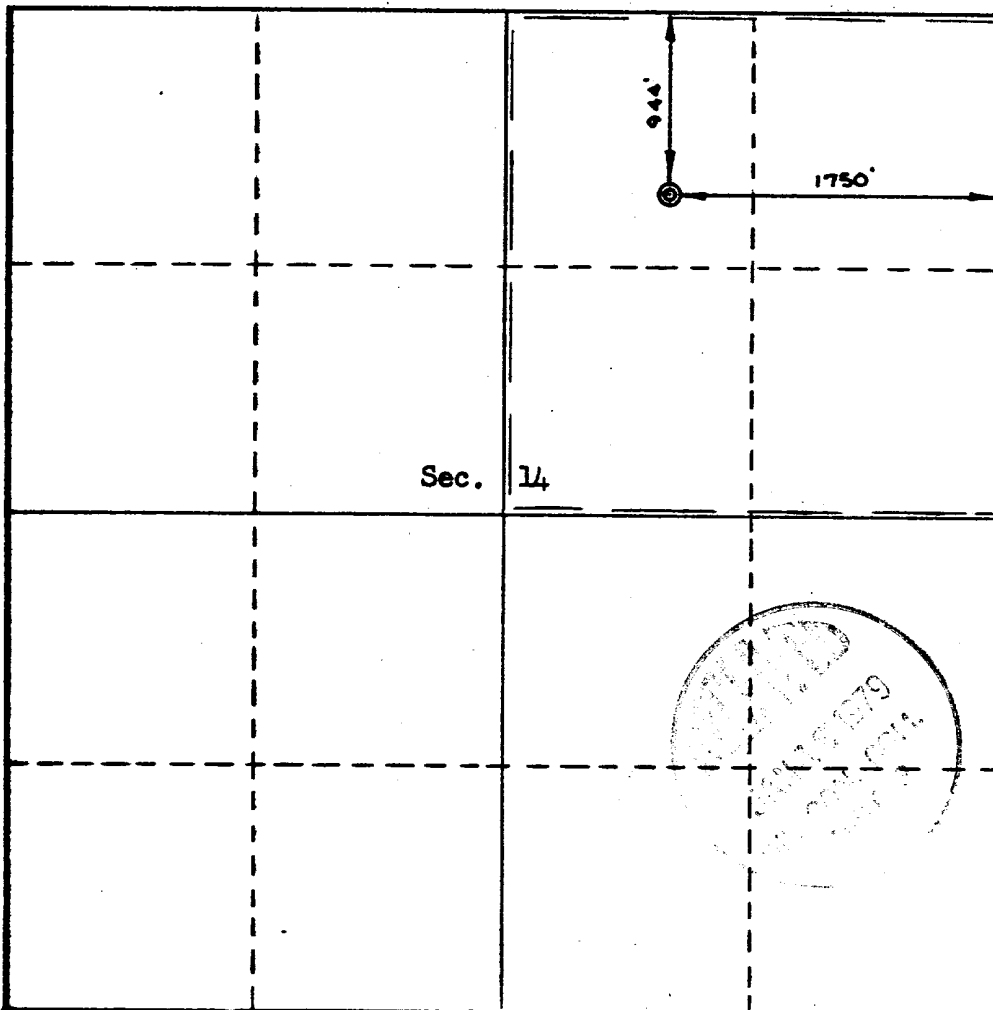

CERTIFICATION

I hereby certify that the information contained herein is true and complete to the best of my knowledge and belief.

Name Charles E. Vergara
Position
Superintendent

Company
Caulkins Oil Company

Date
1-10-79



Date Surveyed
December 29, 1978

Registered Professional Engineer
and/or Land Surveyor

Certificate No. **4624**
Clifton S. Sivil LS



**NEW MEXICO OIL CONSERVATION COMMISSION
WELL LOCATION AND ACREAGE DEDICATION PLAT**

Form C-102
Supersedes C-128
Effective 1-1-65

All distances must be from the outer boundaries of the Section.

Operator Caulkins Oil Company			Lease NM 03881		Well No. 220 R
Unit Letter B	Section 14	Township 26 North	Range 7 West	County Rio Arriba	
Actual Footage Location of Well: 944 feet from the North line and 1750 feet from the West line					
Ground Level Elev. 6537	Producing Formation Pictured Cliffs		Pool South Blanco	Dedicated Acreage: 160 Acres	

1. Outline the acreage dedicated to the subject well by colored pencil or hatchure marks on the plat below.
2. If more than one lease is dedicated to the well, outline each and identify the ownership thereof (both as to working interest and royalty).
3. If more than one lease of different ownership is dedicated to the well, have the interests of all owners been consolidated by communitization, unitization, force-pooling, etc?

☐ Yes ☐ No If answer is "yes," type of consolidation _____

If answer is "no," list the owners and tract descriptions which have actually been consolidated. (Use reverse side of this form if necessary.) _____

No allowable will be assigned to the well until all interests have been consolidated (by communitization, unitization, forced-pooling, or otherwise) or until a non-standard unit, eliminating such interests, has been approved by the Commission.

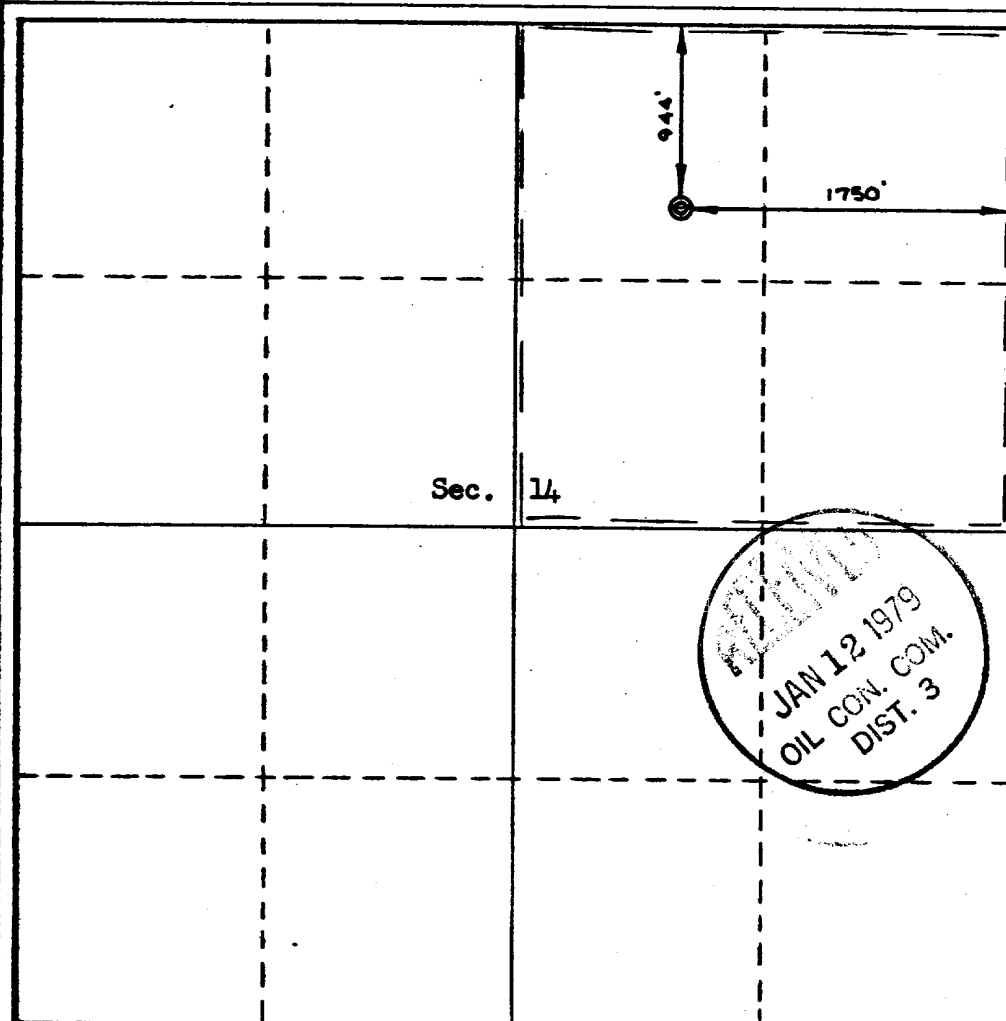

CERTIFICATION

I hereby certify that the information contained herein is true and complete to the best of my knowledge and belief.

Name *Charles E. Vargas*
 Position **Superintendent**
 Company **Caulkins Oil Company**
 Date **1-10-79**

I hereby certify that the location shown on this plat was plotted from field notes of actual survey made by me or under my supervision, and that the same is true and correct to the best of my knowledge and belief.

Date Surveyed
December 29, 1978
 Registered Professional Engineer
 and/or Land Surveyor

Certificate No. **4624**
Clifton S. Sivil LS



CAULKINS OIL CO.

Post Office Box 780
Farmington, New Mexico 87401

Date January 10, 1979

United States Dept. of the Interior
Geological Survey
Post Office Box 1809
Durango, Colorado 81301

Gentlemen:

Following is our multi-point development plan for surface use and restoration for our well No. 220 R, located in NE $\frac{1}{4}$ of Section 14, 26 North, 7 West, Rio Arriba County, New Mexico.

- (1) (3) Existing roads and wells in area shown on Topo Map.
- (2) 1000' of new road required to build this location. Road will be no more than 20' wide and will have water bars installed on all slopes.
- (4) A 210 bbl. stock tank and water, oil and gas separator will be set on location approx. 100' from well. Oil produced will be hauled as needed to pipeline delivery tank located in NW $\frac{1}{4}$ of Section 9, 26 North 6West, Rio Arriba County, New Mexico. Gas Company of New Mexico will purchase gas and furnish all facilities downstream of oil, water and gas separator. A pit 12' X 12' X 4' will be built next to separator and tank, then fire-wall will be built around tank, pit and separator. Fence will be built outside of firewall. Note: Permission for unlined pit will be requested after well completed and daily water production determined.
- (5) Water will be hauled from Caulkins Oil Company water well No. 130, located in NW $\frac{1}{4}$ of Section 9 26N 6W, Rio Arriba County, New Mexico. Water well identified on topo map with red circle. Roads used to transport water also marked in red.
- (6)(8) No camp or construction materials needed for roads or location.
- (9) Layout plat for location and reserve pit attached. Location lays on 34 slope. A 3 cut on West side of location will be required to build location. Reserve pit will be built from earth materials, banks will be packed by tractor. Reserve pit will not be lined.
- (10) All disturbed area will be cleaned up then reseeded with 2 1/2# Crested Wheatgrass, 2 1/2# Smooth Brome, 1/2# Fourwing Saltbrush (dewinged) and 1# Nomad Alfalfa per acre. Reseeded area will include all location and reserve pit area to within 5' of all facilities. Seeding shall be done between July 15 and October 15. All facilities maintained by Caulkins Oil Company shall be painted Green, number 34127.

(11) New location will be 1000' from existing road. Vegetation on area to be disturbed for roads and location is Sage Brush, Blue Gama, Juniper and Cedar.

(12) Operator's representative:

Charles E. Verquer, Supt.
Post Office Box 780
Farmington, New Mexico 87401

Phone: 325 0481

(13) Certification:

I hereby certify that I, or persons under my direct supervision, have inspected the proposed drillsite and access route; that I am familiar with the conditions which presently exist; that the statements made in this plan are, to the best of my knowledge, true and correct; and, that the work associated with the operations proposed will be performed by CAULKINS OIL COMPANY and its contractors and subcontractors in conformity with this plan and the terms and conditions under which it is approved.

January 10, 1979
Date

Charles E. Verquer, Supt.
Caulkins Oil Company

