

District I
P.O. Box 1980, Hobbs, NM

District II
P.O. Drawer DD, Artesia,
NM 88221

District III
1000 Rio Brazos Rd, Aztec,
NM 87410

State of New Mexico
Energy, Minerals and Natural Resources Dept.

SUBMIT 1 COPY TO
APPROPRIATE
DISTRICT OFFICE
AND 1 COPY TO
SANTA FE OFFICE

OIL CONSERVATION DIVISION
2040 S. Pacheco
Santa Fe, New Mexico 87504

PIT REMEDIATION AND CLOSURE REPORT

Operator: Caulkins Oil Company

Telephone: (505) 632-1544

Address: P.O. Box 340, Bloomfield, NM 87413

Facility or Well Name: Breech "B" 220-R

Location: Unit or Qtr/Qtr B Sec 14 T 26N R 7W County Rio Arriba

Pit Type: Separator X Dehydrator Other

Land Type: BLM X, State , Fee , Other

Pit Location: Pit dimensions: length 24', width 18', depth 12'
(Attach diagram)

References: wellhead X, other

Footage from reference: 78'

Direction from reference: 318 Degrees East North X
of
X West South

Depth to Ground Water:
(Vertical distance from
contaminants to seasonal high
water elevation of ground water)

Less than 50 feet	(20 points)	
50 feet to 99 feet	(10 points)	
Greater than 100 feet	(0 points)	<u>0</u>

Wellhead Protection Area:
(Less than 200 feet from a
private domestic water source,
or; less than 1000 feet from all
other water sources)

Yes	(20 points)	
No	(0 points)	<u>0</u>

Distance to Surface Water:
(Horizontal distance to perennial
lakes, ponds, rivers, streams,
creeks, irrigation canals and
ditches)

Less than 200 feet	(20 points)	
200 feet to 1000 feet	(10 points)	
Greater than 1000 feet	(0 points)	<u>0</u>

RANKING SCORE (TOTAL POINTS): 0

SIGNATURE Robert L Verquer PRINTED NAME
AND TITLE ROBERT L. VERQUER, SUPERINTENDENT

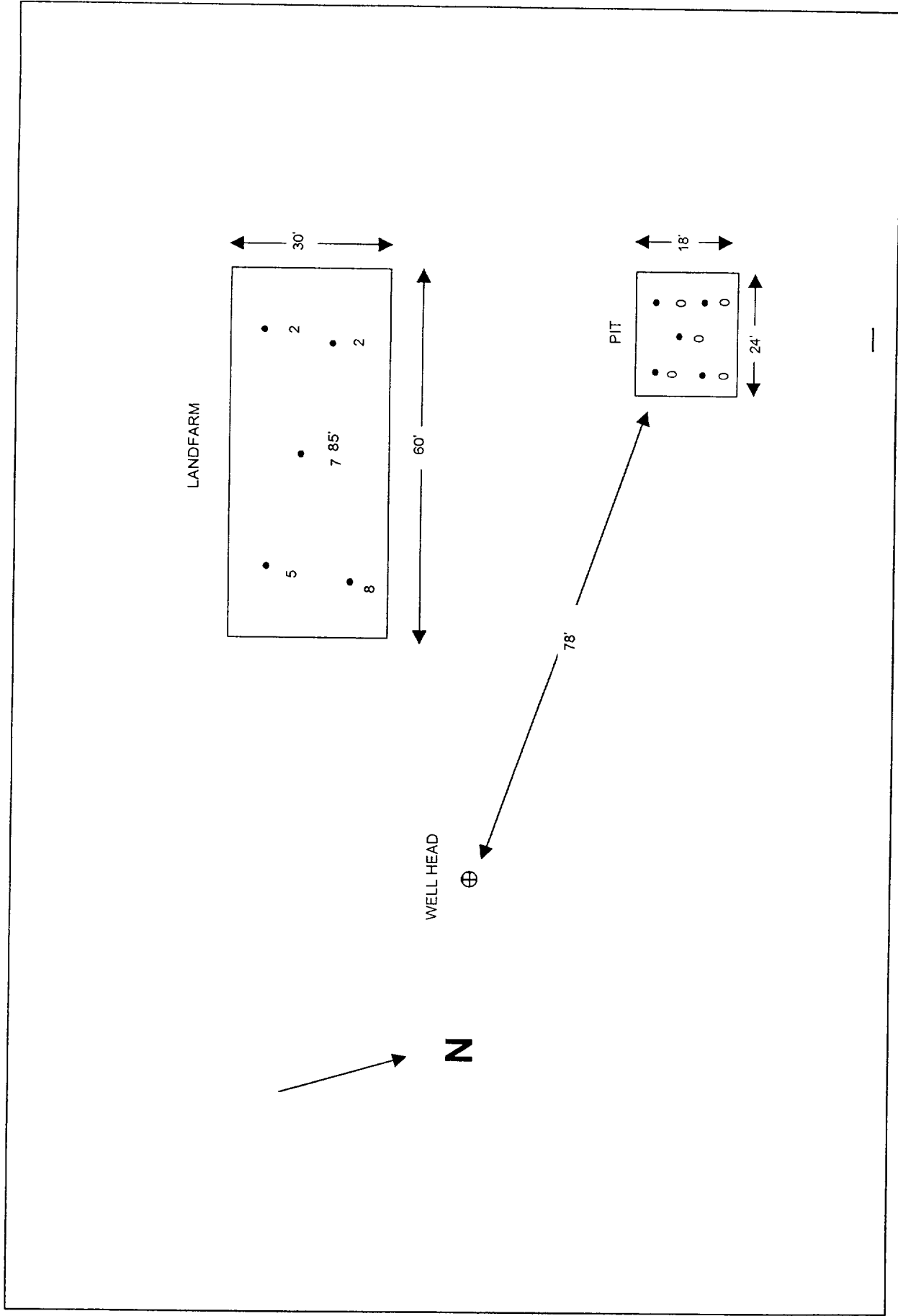



®Certificate of Analysis No. 9709201-05

FARMINGTON LABORATORY

P.O. BOX 1289

FARMINGTON, NEW MEXICO 87499-1289

PHONE (505) 326-2588

Caulkins Oil Co.
1997 E Blanco Blvd
Bloomfield, NM 87413
Attn: Bobby Verquer

Date: 10/27/97

Project:	Landfarm	Project No:	
Site:		Matrix:	Soil
Sampled By:	J. Waggoner	Date Sampled:	09/29/97
Sample ID:	Breech B 220 R	Date Received:	09/29/97

Analytical Data

PARAMETER	RESULTS	DETECTION LIMIT	UNITS
Benzene	ND	1.0	µg/Kg
Toluene	ND	1.0	µg/Kg
Ethylbenzene	ND	1.0	µg/Kg
Total Xylene	ND	1.0	µg/Kg
Total Volatile Aromatic Hydrocarbons	ND		µg/Kg

Surrogate	% Recovery
------------------	-------------------

1,4-Difluorobenzene	100
4-Bromofluorobenzene	170MI

Method 8020

Analyzed by: LJ

Date: 10/15/97

Total Petroleum Hydrocarbons-Diesel	2900	40.0	mg/Kg
-------------------------------------	------	------	-------

Surrogate	% Recovery
------------------	-------------------

n-Pentacosane	1360MI
---------------	--------

Method 8015A*** for Diesel

Analyzed by: RR

Date: 10/09/97

Gasoline Range Organics	ND	0.1	mg/Kg
-------------------------	----	-----	-------

Surrogate	% Recovery
------------------	-------------------

4-Bromofluorobenzene	107
----------------------	-----

1,4-Difluorobenzene	100
---------------------	-----

Method 8015A*** for Gasoline

Analyzed by: RR

Date: 10/09/97

ND- Not detected

MI-Matrix Interference

Notes:

*Ref: Methods for Chemical Analysis of Water and Wastes, 1983, EPA

**Ref: Standard Methods for Examination of Water & Wastewater, 18th ed.

***Ref: Test Methods for Evaluating Solid Waste, EPA SW846, 3rd Ed.

QUALITY ASSURANCE: These analyses are performed in accordance with
EPA guidelines for quality assurance.

Danica Carman, Lab Manager



®Certificate of Analysis No. 9709201-06

FARMINGTON LABORATORY
P.O. BOX 1289
FARMINGTON, NEW MEXICO 87499-1289
PHONE (505) 326-2588

Caulkins Oil Co.
1997 E Blanco Blvd
Bloomfield, NM 87413
Attn: Bobby Verquer

Date: 10/27/97

Project: Bottom of Pit	Project No:
Site:	Matrix: Soil
Sampled By: J. Waggoner	Date Sampled: 09/29/97
Sample ID: Breech B 220 R	Date Received: 09/29/97

Analytical Data

PARAMETER	RESULTS	DETECTION LIMIT	UNITS
Benzene	ND	1.0	µg/Kg
Toluene	ND	1.0	µg/Kg
Ethylbenzene	ND	1.0	µg/Kg
Total Xylene	2.2	1.0	µg/Kg
Total Volatile Aromatic Hydrocarbons	2.2		µg/Kg

Surrogate	% Recovery
1,4-Difluorobenzene	107
4-Bromofluorobenzene	103
Method 8020	
Analyzed by: LJ	
Date: 10/15/97	

Total Petroleum Hydrocarbons-Diesel	130	40.0	mg/Kg
-------------------------------------	-----	------	-------

Surrogate	% Recovery
n-Pentacosane	380MI
Method 8015A*** for Diesel	
Analyzed by: RR	
Date: 10/09/97	

Gasoline Range Organics	ND	0.1	mg/Kg
-------------------------	----	-----	-------

Surrogate	% Recovery
4-Bromofluorobenzene	60
1,4-Difluorobenzene	100
Method 8015A*** for Gasoline	
Analyzed by: RR	
Date: 10/09/97	

ND- Not detected MI-Matrix Interference

Notes: *Ref: Methods for Chemical Analysis of Water and Wastes, 1983, EPA
 **Ref: Standard Methods for Examination of Water & Wastewater, 18th ed.
 ***Ref: Test Methods for Evaluating Solid Waste, EPA SW846, 3rd Ed.

QUALITY ASSURANCE: These analyses are performed in accordance with
EPA guidelines for quality assurance.

Danica Carman, Lab Manager

WELL NAME: Breech B 220-R

CAULKINS OIL
SITE SECURITY DIAGRAM

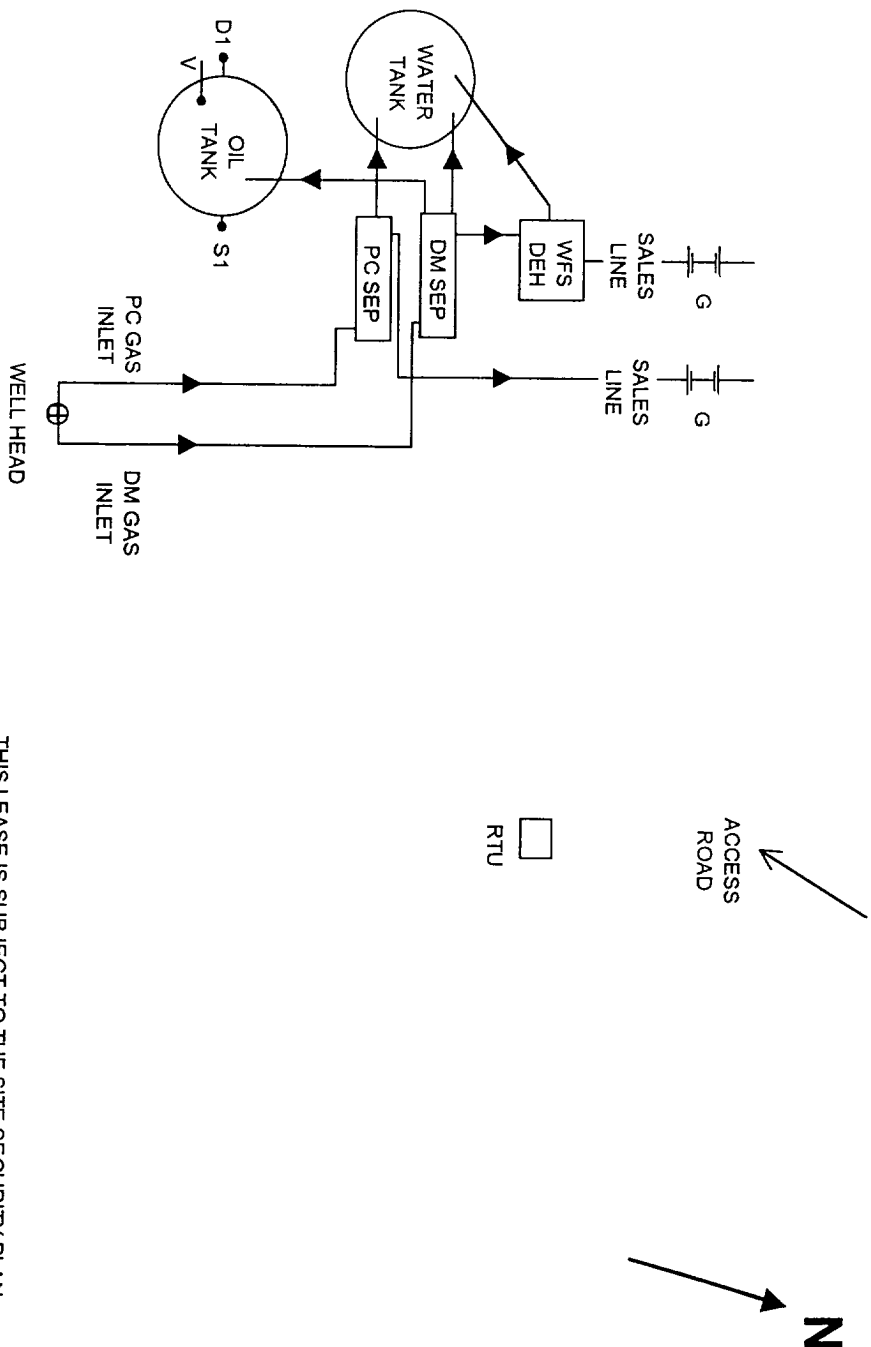

THIS LEASE IS SUBJECT TO THE SITE SECURITY PLAN
FOR NORTHWEST NEW MEXICO OPERATIONS. THE
PLAN IS LOCATED AT:

CAULKINS OIL COMPANY
2001 EAST BLANCO BLVD.
BLOOMFIELD, NEW MEXICO 87413

ALL SALES VALVE ON TANKS AND BS&W DRAW VALVES CLOSED AND
SEALED WHILE WELL PRODUCING AND SHUT-IN.

CAULKINS OIL COMPANY
LEASE NO.: NMNM03381
LOCATION: NW/4 NE/4 SEC. 14,
T. 26N., R. 7W