

UNITED STATES
DEPARTMENT OF THE INTERIOR
GEOLOGICAL SURVEY

APPLICATION FOR PERMIT TO DRILL, DEEPEN, OR PLUG BACK

1a. TYPE OF WORK

DRILL ☒DEEPEN ☐PLUG BACK ☐

b. TYPE OF WELL

OIL
WELL ☐GAS
WELL ☒

OTHER

SINGLE
ZONE ☐MULTIPLE
ZONE ☒

2. NAME OF OPERATOR

Caulkins Oil Company

3. ADDRESS OF OPERATOR

Box 340, Bloomfield, New Mexico

4. LOCATION OF WELL (Report location clearly and in accordance with any State requirements.)*

At surface 1180 from the North and 1120 from the West

At proposed prod. zone

Same

14. DISTANCE IN MILES AND DIRECTION FROM NEAREST TOWN OR POST OFFICE*

30 miles Southeast of Blanco, New Mexico

15. DISTANCE FROM PROPOSED*

LOCATION TO NEAREST
PROPERTY OR LEASE LINE, FT.
(Also to nearest drig. unit line, if any)

1120

16. NO. OF ACRES IN LEASE

2400

17. NO. OF ACRES ASSIGNED
TO THIS WELL

160

18. DISTANCE FROM PROPOSED LOCATION*
TO NEAREST WELL, DRILLING COMPLETED,
OR APPLIED FOR, ON THIS LEASE, FT.

150

19. PROPOSED DEPTH

3750

20. ROTARY OR CABLE TOOLS

Rotary

21. ELEVATIONS (Show whether DF, RT, GR, etc.)

6389 Gr.

22. APPROX. DATE WORK WILL START*

6-24-78

23.

PROPOSED CASING AND CEMENTING PROGRAM

SIZE OF HOLE	SIZE OF CASING	WEIGHT PER FOOT	SETTING DEPTH	QUANTITY OF CEMENT
12 1/4"	8 5/8"	24#	120	Sufficient to circulate
7 7/8"	4 1/2"	10.5	3750	700 sacks

Surface formation San Jose. No abnormal pressure or temperature anticipated.

It is proposed to drill well to 3750' using gel based # mud. Float will be run in drill pipe at bit. ES Ind. and Density logs will be run in open hole.

New 4 1/2" 10.5# H-40 casing will be cemented at TD with 700 sacks 50-50 pos cement containing 12 1/2# gel per sack followed by 100 sacks Neat cement. Casing will have rotating scratchers and centralizers thru Pictured Clif and Chacra.

Baker Model "R" production packer will be run on 1 1/4" IJ 2.3# tubing. Tubing will be set at top of Chacra zone with Packer below Pictured Cliffs perforations.

New 1" NU 10rd thd. V-55 tubing will be run to top of Pictured Cliffs perforation.

Pictured Cliffs and Chacra Zones will be sand water frac'ed to stimulate production.

A Shaffer 8" Model LWP, 6000# test, 3000# WP Blowout preventor will be in use at all times while drilling below 120'. Blowout preventor will be tested at least once during each 24 hour day.

Gas is dedicated

IN ABOVE SPACE DESCRIBE PROPOSED PROGRAM: If proposal is to deepen or plug back, give data on present productive zone and proposed new productive zone. If proposal is to drill or deepen directionally, give pertinent data on subsurface locations and measured and true vertical depths. Give blowout preventer program, if any.

24.

SIGNED

Charles E. Vergun

TITLE

Superintendent

DATE

10-28-77

(This space for Federal or State office use)

PERMIT NO.

APPROVAL DATE

APPROVED BY

TITLE

DATE

CONDITIONS OF APPROVAL, IF ANY:

*OK**ST*

*See Instructions On Reverse Side

NEW MEXICO OIL CONSERVATION COMMISSION
WELL LOCATION AND ACREAGE DEDICATION PLAT

Form C-102
Supersedes C-128
Effective 1-1-65

All distances must be from the outer boundaries of the Section.

Owner Caulkins Oil Company			Lease SF 079035-A		Well No. 729
Unit Letter D	Section 17	Township 26 North	Range 6 West	County Rio Arriba	
Actual Footage Location of Well: 1180 feet from the North line and 1120 feet from the West line					
Ground Level Elev 6389	Picture and Description Pictured Cliffs Chacra		Pool South Blanco Otero Chacra	Dedicated Acreage 160 Acres	

1. Outline the acreage dedicated to the subject well by colored pencil or hatchure marks on the plat below.
2. If more than one lease is dedicated to the well, outline each and identify the ownership thereof (both as to working interest and royalty).
3. If more than one lease of different ownership is dedicated to the well, have the interests of all owners been consolidated by communitization, unitization, force-pooling, etc?

☐ Yes ☐ No If answer is "yes," type of consolidation _____

If answer is "no," list the owners and tract descriptions which have actually been consolidated. (Use reverse side of this form if necessary.) _____

No allowable will be assigned to the well until all interests have been consolidated (by communitization, unitization, forced-pooling, or otherwise) or until a non-standard unit, eliminating such interests, has been approved by the Commission.

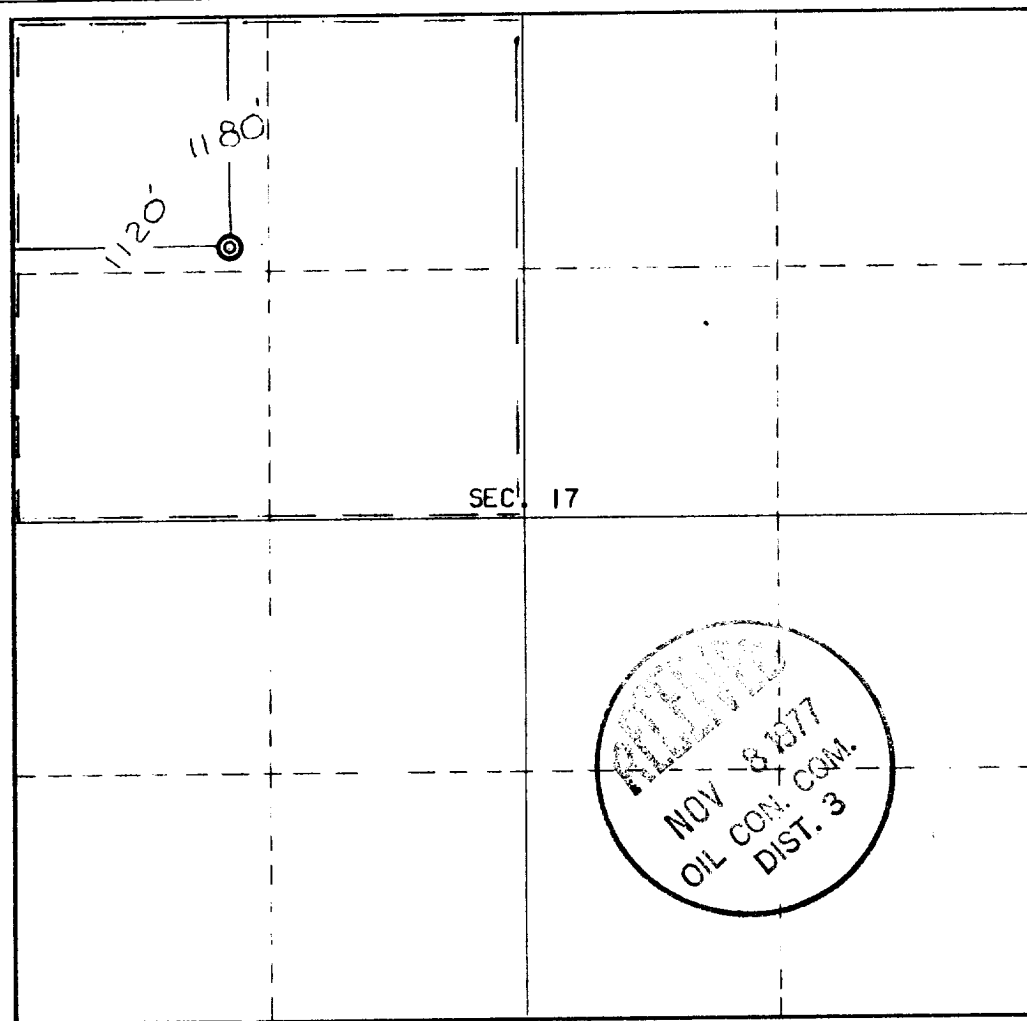

CERTIFICATION

I hereby certify that the information contained herein is true and complete to the best of my knowledge and belief.

Name Charles E. Deane
Position Superintendent

Company Caulkins Oil Company

Date Oct. 26, 1977

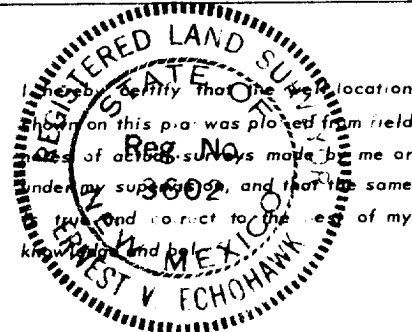

Date Surveyed October 18, 1977

Registered Professional Engineer and/or Land Surveyor

E.V. Echohawk
Certificate No. 3602
E.V. Echohawk LS

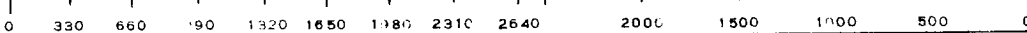

Breech A #729

D-17-26N-6W

Caulkins Oil Company

F 30-039-21532 11-8-77

F. Loc. 1180/N; 1120/W Elev. 6389 GL Spd. Comp. TD PB

Casing S. W Sx. Int. W Sx. Pr. W Sx. T. Prod. Stim.

T
R
A
N
S

I.P. BO/D MCF/D After Hrs. SICP PSI After Days GOR Grav. 1st Del. S

TOPS		NITD	Well Log	TEST DATA						
Kirtland		C-103	Plat	Schd.	PC	Q	PW	PD	D	Ref. No.
Fruitland		C-104	Electric Log							
Pictured Cliffs			C-122							
Cliff House		Ditr	Dfa							
Menefee		Datr	Dac							
Point Lookout		160								
Mancos										
Gallup										
Sanostee										
Greenhorn										
Dakota										
Morrison										
Entrada										

P
O
O
I

S Blanco PCo. RA S 17 T 26N R 6W U D Oper. Caulkins Oil Company Lse. Breech A No. 729

F 30-039-21532 11-8-77

F. Loc. 1180/N; 1120/W Elev. 6389 GL Spd. Comp. TD PB

Casing S. W Sx. Int. W Sx. Pr. W Sx. T. Prod. Stim.

TRANS

I.P. BO/D MCF/D After Hrs. SICP PSI After Days GOR Grav. 1st Del. \$

TOPS		NITD	Well Log	TEST DATA						
Kirtland		C-103	Plat	Schd.	PC	Q	PW	PD	D	Ref. No.
Fruitland		C-104	Electric Log							
Pictured Cliffs			C-122							
Cliff House		Ditr	Dfa							
Menefee		Datr	Dac							
Point Lookout		160								
Mancos										
Gallup										
Sanostee										
Greenhorn										
Dakota										
Morrison										
Entrada										

Otero Cha Co. RA S 17 T 26N R 6W UD Oper. Caulkins Oil Company Lse. Breech A No. 729

UNITED STATES
DEPARTMENT OF THE INTERIOR
GEOLOGICAL SURVEY

SUBMIT IN TRIPPLICATE*
(Other instructions on re-
verse side)

Form approved.
Budget Bureau No. 42-R1424.

SUNDRY NOTICES AND REPORTS ON WELLS

(Do not use this form for proposals to drill or to deepen or plug back to a different reservoir.
Use "APPLICATION FOR PERMIT—" for such proposals.)

1. OIL WELL <input type="checkbox"/> GAS WELL <input checked="" type="checkbox"/> OTHER		5. LEASE DESIGNATION AND SERIAL NO. SF 079035-A
2. NAME OF OPERATOR Caulkins Oil Company		6. IF INDIAN, ALLOTTEE OR TRIBE NAME
3. ADDRESS OF OPERATOR P.O. Box 780, Farmington, New Mexico		7. UNIT AGREEMENT NAME
4. LOCATION OF WELL (Report location clearly and in accordance with any State requirements.* See also space 17 below.) At surface 1180' from the North and 1120' from the West		8. FARM OR LEASE NAME Breech A
14. PERMIT NO.		9. WELL NO. 729
15. ELEVATIONS (Show whether DF, RT, GR, etc.) 6389 Gr.		10. FIELD AND POOL, OR WILDCAT South Blanco
		11. SEC., T., R., M., OR BLK. AND SURVEY OR AREA Sec. 17 26N 6W
		12. COUNTY OR PARISH Rio Arriba
		13. STATE New Mex.

16. Check Appropriate Box To Indicate Nature of Notice, Report, or Other Data

NOTICE OF INTENTION TO:		SUBSEQUENT REPORT OF:	
TEST WATER SHUT-OFF <input type="checkbox"/>	PULL OR ALTER CASING <input type="checkbox"/>	WATER SHUT-OFF <input type="checkbox"/>	REPAIRING WELL <input type="checkbox"/>
FRACTURE TREAT <input type="checkbox"/>	MULTIPLE COMPLETE <input type="checkbox"/>	FRACTURE TREATMENT <input type="checkbox"/>	ALTERING CASING <input type="checkbox"/>
SHOOT OR ACIDIZE <input type="checkbox"/>	ABANDON* <input type="checkbox"/>	SHOOTING OR ACIDIZING <input type="checkbox"/>	ABANDONMENT* <input type="checkbox"/>
REPAIR WELL <input type="checkbox"/>	CHANGE PLANS <input checked="" type="checkbox"/>	(Other) <input type="checkbox"/>	(Other) <input type="checkbox"/>

(NOTE: Report results of multiple completion on Well Completion or Recompletion Report and Log form.)

17. DESCRIBE PROPOSED OR COMPLETED OPERATIONS (Clearly state all pertinent details, and give pertinent dates, including estimated date of starting any proposed work. If well is directionally drilled, give subsurface locations and measured and true vertical depths for all markers and zones pertinent to this work.)*

Application to Drill this well now on file in your office.

We now plan to recomplete well in this quarter section in the Pictured Cliffs and Chacra zones.

Please dismiss application to drill.

18. I hereby certify that the foregoing is true and correct

SIGNED <u>Charles E. Casper</u>	TITLE <u>Superintendent</u>	DATE <u>3-7-78</u>
---------------------------------	-----------------------------	--------------------

(This space for Federal or State office use)

APPROVED BY _____	TITLE _____	DATE _____
-------------------	-------------	------------

CONDITIONS OF APPROVAL, IF ANY:

*See Instructions on Reverse Side

COPY TO ~~REVERSE~~

UNITED STATES
DEPARTMENT OF THE INTERIOR
GEOLOGICAL SURVEY

SUBMIT IN TRIPLICATE*
(Other instructions on re-
verse side)

Form approved.
Budget Bureau No. 42-R1424.

SUNDRY NOTICES AND REPORTS ON WELLS

(Do not use this form for proposals to drill or to deepen or plug back to a different reservoir.
Use "APPLICATION FOR PERMIT—" for such proposals.)

1. OIL WELL <input type="checkbox"/> GAS WELL <input checked="" type="checkbox"/> OTHER		5. LEASE DESIGNATION AND SERIAL NO. SF 079035-A
2. NAME OF OPERATOR Caulkins Oil Company		6. IF INDIAN, ALLOTTEE OR TRIBE NAME
3. ADDRESS OF OPERATOR P.O. Box 780, Farmington, New Mexico		7. UNIT AGREEMENT NAME
4. LOCATION OF WELL (Report location clearly and in accordance with any State requirements.* See also space 17 below.) At surface 1180' from the North and 1120' from the West		8. FARM OR LEASE NAME Breech A
14. PERMIT NO.		9. WELL NO. 729
15. ELEVATIONS (Show whether DF, RT, GR, etc.) 6389 Gr.		10. FIELD AND POOL, OR WILDCAT South Blanco
		11. SEC., T., R., M., OR BLK. AND SURVEY OR AREA Sec. 17 26N 6W
		12. COUNTY OR PARISH Rio Arriba
		13. STATE New Mex.

16. Check Appropriate Box To Indicate Nature of Notice, Report, or Other Data

NOTICE OF INTENTION TO:		SUBSEQUENT REPORT OF:	
TEST WATER SHUT-OFF <input type="checkbox"/>	PULL OR ALTER CASING <input type="checkbox"/>	WATER SHUT-OFF <input type="checkbox"/>	REPAIRING WELL <input type="checkbox"/>
FRACTURE TREAT <input type="checkbox"/>	MULTIPLE COMPLETE <input type="checkbox"/>	FRACTURE TREATMENT <input type="checkbox"/>	ALTERING CASING <input type="checkbox"/>
SHOOT OR ACIDIZE <input type="checkbox"/>	ABANDON* <input type="checkbox"/>	SHOOTING OR ACIDIZING <input type="checkbox"/>	ABANDONMENT* <input type="checkbox"/>
REPAIR WELL <input type="checkbox"/>	CHANGE PLANS <input checked="" type="checkbox"/>	(Other) <input type="checkbox"/>	

(NOTE: Report results of multiple completion on Well Completion or Recompletion Report and Log form.)

17. DESCRIBE PROPOSED OR COMPLETED OPERATIONS (Clearly state all pertinent details, and give pertinent dates, including estimated date of starting any proposed work. If well is directionally drilled, give subsurface locations and measured and true vertical depths for all markers and zones pertinent to this work.)*

Application to Drill this well now on file in your office.

We now plan to recomplete well in this quarter section in the Pictured Cliffs and Chacra zones.

Please dismiss application to drill.

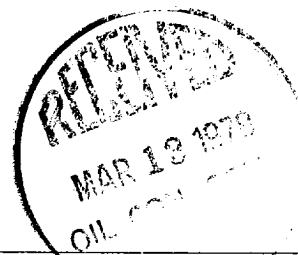

18. I hereby certify that the foregoing is true and correct

SIGNED <u>Richard E. Vergara</u>	TITLE <u>Superintendent</u>	DATE <u>3-7-78</u>
(This space for Federal or State office use)		
APPROVED BY _____	TITLE _____	DATE _____
CONDITIONS OF APPROVAL, IF ANY:		

*See Instructions on Reverse Side

Federal Building
701 Camino del Rio
Durango, Colorado 81301

March 8, 1978

Gaulkins Oil Company
Box 780
Farmington, New Mexico 87401

Gentlemen:

Your Sundry Notice of March 7, 1978 requested dismissal of your Application for Permit to Drill the No. 729 Breech "A" well in the NE1/4 sec. 17, T. 26 N., R. 6 W., Rio Arriba County, New Mexico, on Federal oil and gas lease SF 079035-A.

Returned herewith are copies of your unapproved application. Recompletion operations of an existing well in lieu of the subject well will require appropriate applications and approvals.

Sincerely yours,

(Orig. 280.) E. A. SCHMIDT

E. A. Schmidt
Acting District Engineer

Enclosure: AFD's

EASchmidt/ds

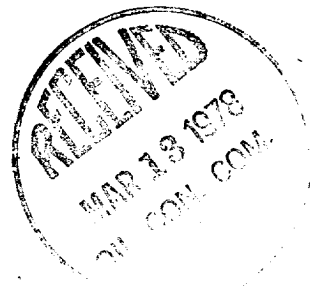

Stat