

NEW MEXICO OIL CONSERVATION COMMISSION
WELL LOCATION AND ACREAGE DEDICATION PLAT

Form C-102
Supersedes C-1
Effective 1-1-65

All distances must be from the outer boundaries of the Section.

Operator SUPRON ENERGY CORPORATION		Lease JICARILLA "F"		Well No. 5
Unit Letter F	Section 33	Township 26 NORTH	Range 4 WEST	County RIO ARriba
Actual Footage Location of Well:				
1720 feet from the NORTH line and		1495 feet from the WEST line		
Ground Level Elev. 6856	Producing Formation MESAVERDE DAKOTA	Pool BLANCO BASIN	Dedicated Acreage: W/2 320 Acres	

1. Outline the acreage dedicated to the subject well by colored pencil or hachure marks on the plat below.
2. If more than one lease is dedicated to the well, outline each and identify the ownership thereof (both as to working interest and royalty).
3. If more than one lease of different ownership is dedicated to the well, have the interests of all owners been consolidated by communitization, unitization, force-pooling, etc?

☐ Yes ☐ No If answer is "yes," type of consolidation _____

If answer is "no," list the owners and tract descriptions which have actually been consolidated. (Use reverse side of this form if necessary.) _____

No allowable will be assigned to the well until all interests have been consolidated (by communitization, unitization, forced-pooling, or otherwise) or until a non-standard unit, eliminating such interests, has been approved by the Commission.

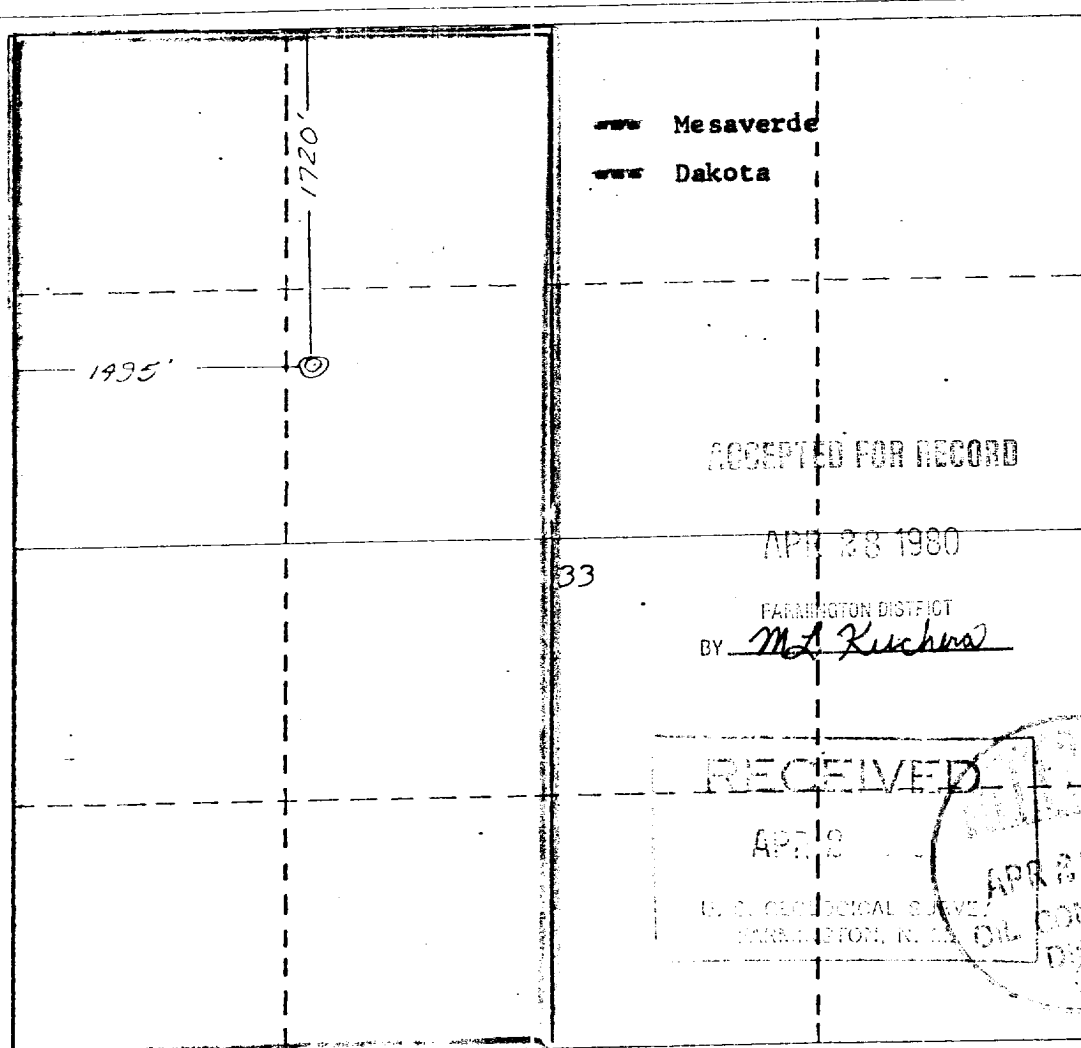

CERTIFICATION

I hereby certify that the information contained herein is true and complete to the best of my knowledge and belief.

Rudy D. Motto
Name

Rudy D. Motto

Position
Area Superintendent

Company
Supron Energy Corporation

Date
April 23, 1979

I hereby certify that the location shown on this plat was plotted from field notes of a trial survey made by me or under my supervision and that the same is true and correct to the best of my knowledge and belief.

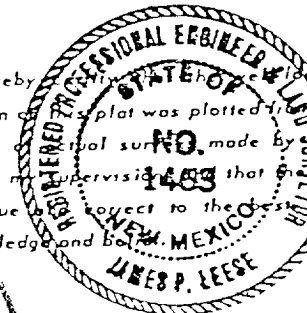

Date Surveyed
April 1979
Registered Professional Engineer
and/or Land Surveyor

James P. Leese
James P. Leese

Certificate No.
1463

N.M.O.C.C.