

UNITED STATES
DEPARTMENT OF THE INTERIOR
GEOLOGICAL SURVEY

APPLICATION FOR PERMIT TO DRILL, DEEPEN, OR PLUG BACK

1a. TYPE OF WORK

DRILL ☒DEEPEN ☐PLUG BACK ☐

b. TYPE OF WELL

OIL
WELL ☐GAS
WELL ☒

OTHER

SINGLE
ZONE ☐MULTIPLE
ZONE ☒

2. NAME OF OPERATOR

Consolidated Oil & Gas, Inc.

3. ADDRESS OF OPERATOR

1860 Lincoln Street, Denver, Colorado 80295

4. LOCATION OF WELL (Report location clearly and in accordance with any State requirements.*)

At surface

960' FNL & 850' FEL

At proposed prod. zone Same

14. DISTANCE IN MILES AND DIRECTION FROM NEAREST TOWN OR POST OFFICE*

8-3/4 miles NW of Ojita, New Mexico

15. DISTANCE FROM PROPOSED*

LOCATION TO NEAREST
PROPERTY OR LEASE LINE, FT.
(Also to nearest drlg. unit line, if any)

850

16. NO. OF ACRES IN LEASE

320

17. NO. OF ACRES ASSIGNED
TO THIS WELL

E/320 + 160

18. DISTANCE FROM PROPOSED LOCATION*

TO NEAREST WELL, DRILLING, COMPLETED,
OR APPLIED FOR, ON THIS LEASE, FT.

200'

19. PROPOSED DEPTH

8240'

20. ROTARY OR CABLE TOOLS

Rotary

21. ELEVATIONS (Show whether DF, RT, GR, etc.)

7080' GR

22. APPROX. DATE WORK WILL START*

September 1, 1979

23.

PROPOSED CASING AND CEMENTING PROGRAM

SIZE OF HOLE	SIZE OF CASING	WEIGHT PER FOOT	SETTING DEPTH	QUANTITY OF CEMENT
15"	10-3/4"	40.5#	300'	Circ (approx 300 sx)
9-7/8"	7-5/8"	26.4#	4150'	250 sx
6-3/4"	5-1/2"	15.5#	8240'	250 sx

1. Drill 15" hole to \pm 300'. Set 10-3/4" casing. Circulate cement to surface.
2. WOC 12 hrs.
3. Install blowout preventer. Pressure test surface casing and blowout preventer to 1000#.
4. Drill 9-7/8" hole to approximately 300' below top of Pictured Cliff or to approximately 4150' with fresh water gel mud. Log. Run 7-5/8" casing and cement with approximately 250 sx. WOC 12 hrs.
5. Air or gas drill 6-3/4" hole to 8240'. Log.
6. Set 5-1/2" liner with approximately 250 sx.
7. Selectively perforate and stimulate the Gallup and Dakota and complete as required by rules and regulations.

IN ABOVE SPACE DESCRIBE PROPOSED PROGRAM: If proposal is to deepen or plug back, give data on present productive zone and proposed new productive zone. If proposal is to drill or deepen directionally, give pertinent data on subsurface locations and measured and true vertical depths. Give blowout preventer program, if any.

24.

SIGNED

TITLE

Senior Prod. Engr.

DATE

July 10, 1979

(This space for Federal or State office use)

PERMIT NO.

APPROVAL DATE

APPROVED BY

TITLE

DATE

CONDITIONS OF APPROVAL, IF ANY:

ok Frank

30-039-22121

5. LEASE DESIGNATION AND SERIAL NO.

6. IF INDIAN, ALLOTTEE OR TRIBE NAME

Jicarilla Apache

7. UNIT AGREEMENT NAME

Contract No. 101

8. FARM OR LEASE NAME

Jicarilla "C"

9. WELL NO.

1-E

1974 FIELD AND POOL OR WILDCAT

Gallup/Dakota

11. SEC., T., R., M., OR BLK.
AND SURVEY OR AREA

Sec. 11, T26N, R4W, NMPM

12. COUNTY OR PARISH

13. STATE

Rio Arriba New Mexico

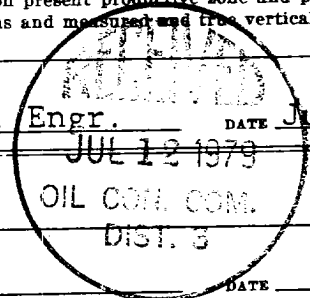

NEW MEXICO OIL CONSERVATION COMMISSION
WELL LOCATION AND ACREAGE DEDICATION PLAT

Form C-102
Supersedes C-128
Effective 1-1-65

All distances must be from the outer boundaries of the Section.

Operator Consolidated Oil & Gas Inc.		Lease Jicarilla C		Well No. #1 E
Unit Letter A	Section 11	Township 26	Range 4	County Rio Arriba
Actual Footage Location of Wells: 960 feet from the North line and 850 feet from the East line				
Ground Level Elev. 7080	Producing Formation Dakota	Pool Basin Dakota	Dedicated Acreage: 320 Acres	

1. Outline the acreage dedicated to the subject well by colored pencil or hachure marks on the plat below.
2. If more than one lease is dedicated to the well, outline each and identify the ownership thereof (both as to working interest and royalty).
3. If more than one lease of different ownership is dedicated to the well, have the interests of all owners been consolidated by communitization, unitization, force-pooling, etc?

☒ Yes ☐ No If answer is "yes" type of consolidation Communitization

If answer is "no," list the owners and tract descriptions which have actually been consolidated. (Use reverse side of this form if necessary.)

No allowable will be assigned to the well until all interests have been consolidated (by communitization, unitization, forced-pooling, or otherwise) or until a non-standard unit, eliminating such interests, has been approved by the Commission.

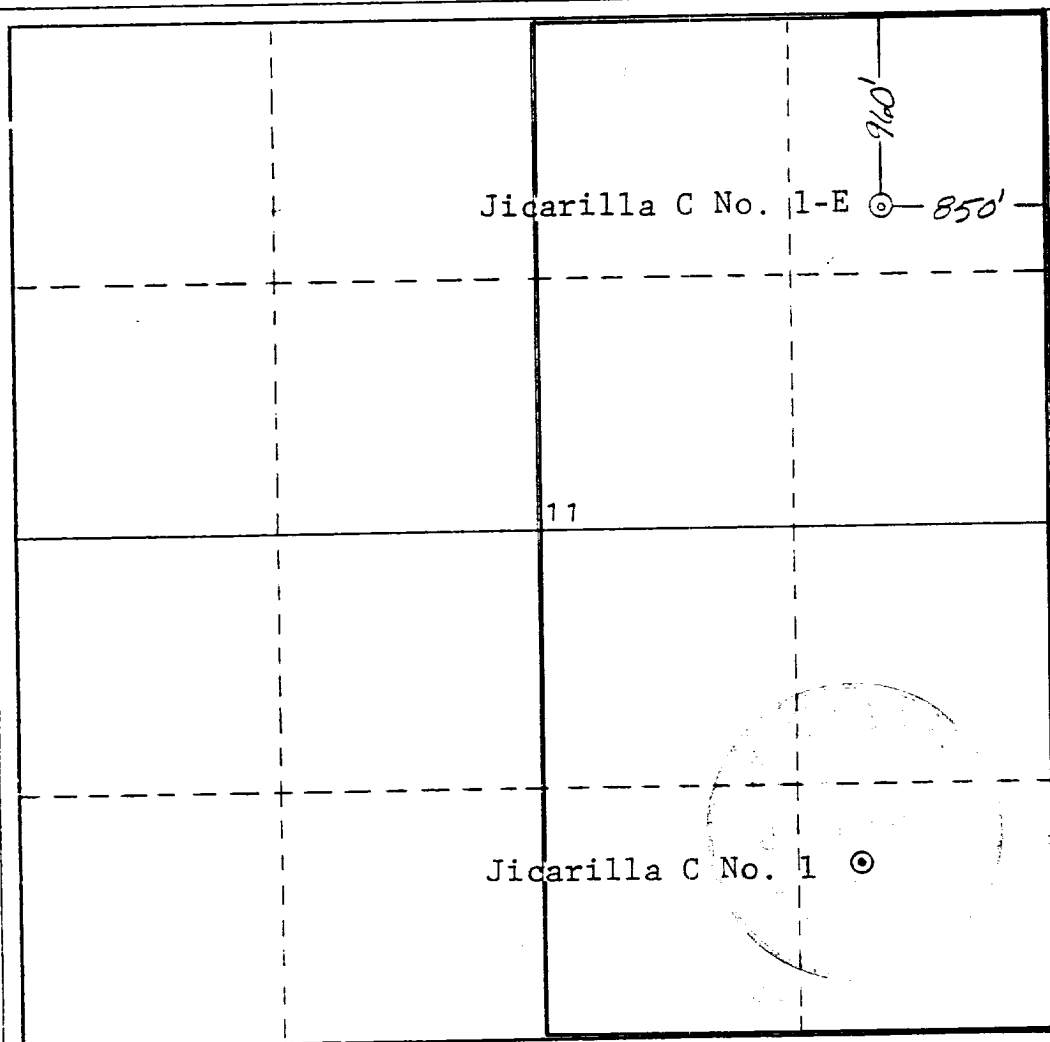

CERTIFICATION

I hereby certify that the information contained herein is true and complete to the best of my knowledge and belief.

C. M. Parham

Name

C. M. Parham

Position

Sr. Production Engineer

Company

Consolidated Oil & Gas, Inc.

Date

July 10, 1979

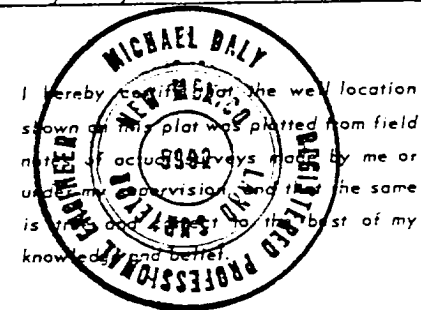

Date Surveyed

18 June, 1979

Registered Professional Engineer and/or Land Surveyor

Michael Daly

Certificate No.

5992

0 330 660 990 1320 1650 1980 2310 2640 2000 1500 1000 500 0

NEW MEXICO OIL CONSERVATION COMMISSION
WELL LOCATION AND ACREAGE DEDICATION PLAT

Form C-102
Supersedes C-128
Effective 1-1-65

All distances must be from the outer boundaries of the Section.

Operator Consolidated Oil & Gas, Inc.		Lease Jicarilla C		Well No. #1 E	
Unit Letter A	Section 11	Township 26	Range 4	County Rio Arriba	
Actual Footage Location of Well: 960 feet from the North line and 850 feet from the East line					
Ground Level Elev. 7080	Producing Formation Gallup		Pool W. 14th - S. B S Mesa Gallup		Dedicated Acreage: 320 160 Acres

1. Outline the acreage dedicated to the subject well by colored pencil or hachure marks on the plat below.
2. If more than one lease is dedicated to the well, outline each and identify the ownership thereof (both as to working interest and royalty).
3. If more than one lease of different ownership is dedicated to the well, have the interests of all owners been consolidated by communitization, unitization, force-pooling, etc?

☒ Yes ☐ No If answer is "yes," type of consolidation Communitization

If answer is "no," list the owners and tract descriptions which have actually been consolidated. (Use reverse side of this form if necessary.)

No allowable will be assigned to the well until all interests have been consolidated (by communitization, unitization, forced-pooling, or otherwise) or until a non-standard unit, eliminating such interests, has been approved by the Commission.

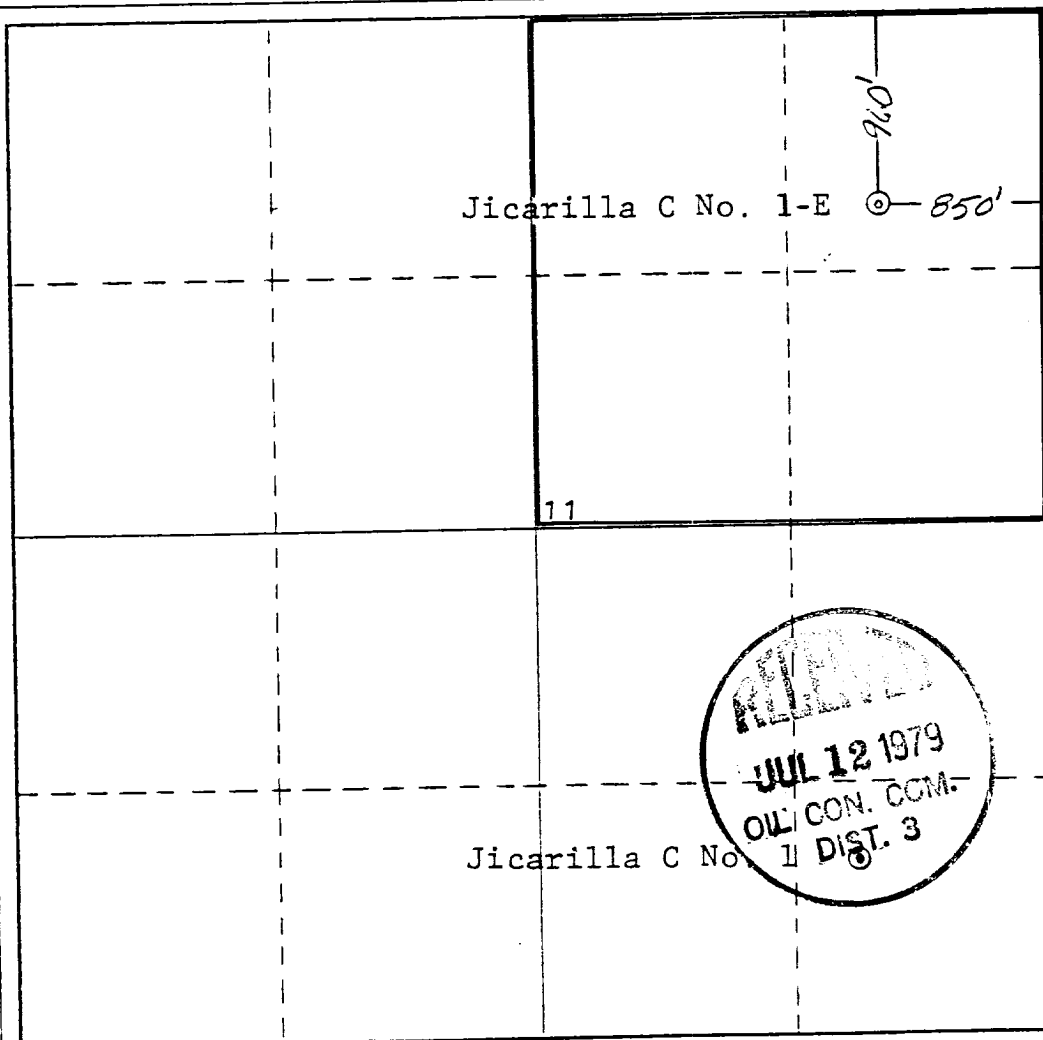

CERTIFICATION

I hereby certify that the information contained herein is true and complete to the best of my knowledge and belief.

C. M. Parham

Name
C. M. Parham
Position
Sr. Production Engineer
Company
Consolidated Oil & Gas, Inc.
Date
July 10, 1979

I hereby certify that the well location shown on this plat was plotted from field notes of actual surveys made by me or under my supervision and that the same is true and correct to the best of my knowledge and belief.

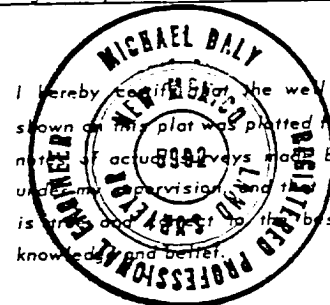

Date Surveyed
18 June, 1979
Registered Professional Engineer and/or Land Surveyor
Michael Daly
Certificate No.
5992