

UNITED STATES
DEPARTMENT OF THE INTERIOR
GEOLOGICAL SURVEY

APPLICATION FOR PERMIT TO DRILL, DEEPEN, OR PLUG BACK

1a. TYPE OF WORK
DRILL ☒ DEEPEN ☐ PLUG BACK ☐

b. TYPE OF WELL
OIL WELL ☒ GAS WELL ☒ OTHER ☐ SINGLE ZONE ☐ MULTIPLE ZONE ☐

2. NAME OF OPERATOR
Jerome P. McHugh

3. ADDRESS OF OPERATOR
Box 208 Farmington, NM 87401

4. LOCATION OF WELL (Report location clearly and in accordance with any State requirements.*)
At surface 1850' FNL - 1450 FEL ✓
At proposed prod. zone

14. DISTANCE IN MILES AND DIRECTION FROM NEAREST TOWN OR POST OFFICE*
30 miles southwest of Dulce, NM

15. DISTANCE FROM PROPOSED*
LOCATION TO NEAREST
PROPERTY OR LEASE LINE, FT. 1450'
(Also to nearest drilg. unit line, if any)

18. DISTANCE FROM PROPOSED LOCATION*
TO NEAREST WELL, DRILLING, COMPLETED,
OR APPLIED FOR, ON THIS LEASE, FT. 300'

21. ELEVATIONS (Show whether DF, RT, GR, etc.)
6715' GR

23. PROPOSED CASING AND CEMENTING PROGRAM

SIZE OF HOLE	SIZE OF CASING	WEIGHT PER FOOT	SETTING DEPTH	QUANTITY OF CEMENT
12-1/4"	8-5/8"	24#	250'	150 sx *
7-7/8"	4-1/2"	11.6#	7730'	1025 sx *

*detailed info on Operations Plan

Plan to drill with mud to test producing formation. Will set 8-5/8" surface csg through Ojo Alamo and circulate cement to surface. If productive, will set 4-1/2" csg, selectively perforate, frac, clean out after frac, run 1-1/4" tbg and complete well.

Plan to use BOP furnished by rig while drilling (10" 3000 psi hydraulic)

Plan to use BOP rental while completing (6" 3000 psi double gate manual)

NMERB: Gas dedicated to El Paso Natural Gas Co.

IN ABOVE SPACE DESCRIBE PROPOSED PROGRAM: If proposal is to deepen or plug back, give data on present productive zone and proposed new productive zone. If proposal is to drill or deepen directionally, give pertinent data on subsurface locations and measured and true vertical depths. Give blowout preventer program, if any.

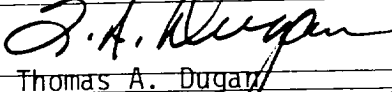
24. 
SIGNED Thomas A. Dugan TITLE Agent DATE 8-23-79
(This space for Federal or State office use)

PERMIT NO. APPROVAL DATE

APPROVED BY TITLE DATE
CONDITIONS OF APPROVAL, IF ANY:

30-039-22157
5. LEASE DESIGNATION AND SERIAL NO.
Contract 120
6. IF INDIAN, ALLOTTEE OR TRIBE NAME
Jicarilla
7. UNIT AGREEMENT NAME
8. FARM OR LEASE NAME
Jicarilla
9. WELL NO.
#1E
10. FIELD AND POOL, OR WILDCAT
Basin Dakota
11. SEC., T., R., M., OR BLK.
AND SURVEY OR AREA
Sec 30 T26N R4W
12. COUNTY OR PARISH
Rio Arriba
13. STATE
NM

17. NO. OF ACRES ASSIGNED
TO THIS WELL
N-322.12 320

20. ROTARY OR CABLE TOOLS
Rotary

22. APPROX. DATE WORK WILL START*
9-1-79

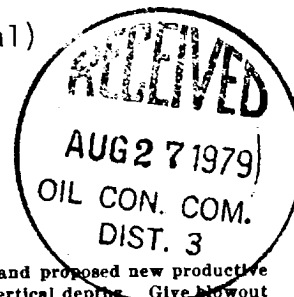

Clear

NEW MEXICO OIL CONSERVATION COMMISSION
WELL LOCATION AND ACREAGE DEDICATION PLAT

Form C-102
Supersedes C-128
Effective 1-1-65

All distances must be from the outer boundaries of the Section.

Operator Jerome P. McHugh		Lease Jicarilla		Well No. 1E
Unit Letter G	Section 30	Township 26 North	Range 4 West	County Rio Arriba
Actual Footage Location of Well: 1850 feet from the North line and 1450 feet from the East line				
Ground Level Elev. 6715	Producing Formation Dakota	Pool Basin	Dedicated Acreage: 322.12 320 Acres	

1. Outline the acreage dedicated to the subject well by colored pencil or hachure marks on the plat below.
2. If more than one lease is dedicated to the well, outline each and identify the ownership thereof (both as to working interest and royalty).
3. If more than one lease of different ownership is dedicated to the well, have the interests of all owners been consolidated by communitization, unitization, force-pooling, etc?

☐ Yes ☐ No If answer is "yes," type of consolidation _____

If answer is "no," list the owners and tract descriptions which have actually been consolidated. (Use reverse side of this form if necessary.) _____

No allowable will be assigned to the well until all interests have been consolidated (by communitization, unitization, forced-pooling, or otherwise) or until a non-standard unit, eliminating such interests, has been approved by the Commission.

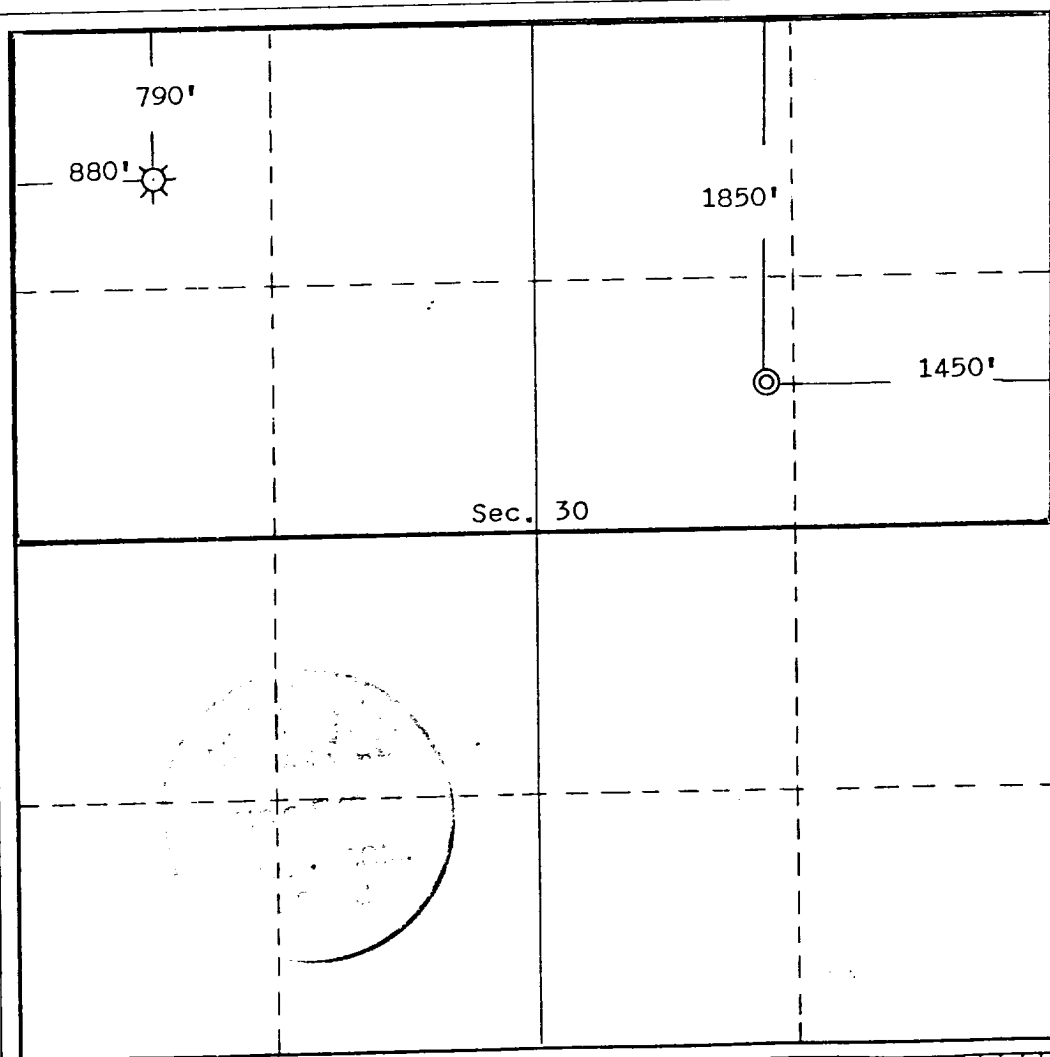

CERTIFICATION

I hereby certify that the information contained herein is true and complete to the best of my knowledge and belief.

Thomas A. Dugan

Name
Thomas A. Dugan
Position
Agent
Company
Jerome P. McHugh

Date
8-23-79

I hereby certify that the well location shown on this plat was plotted from field notes of actual surveys made by me or under my supervision, and that the same is true and correct to the best of my knowledge and belief.

Date Surveyed
August 7, 1979

Registered Professional Engineer
and/or Land Surveyor

Edgar L. Risenhoover
Certificate No. 5979

Edgar L. Risenhoover, L.S.