

UNITED STATES  
DEPARTMENT OF THE INTERIOR  
GEOLOGICAL SURVEY

30-039-22318

## APPLICATION FOR PERMIT TO DRILL, DEEPEN, OR PLUG BACK

1a. TYPE OF WORK DRILL <input checked="" type="checkbox"/> DEEPEN <input type="checkbox"/> PLUG BACK <input type="checkbox"/>			5. LEASE DESIGNATION AND SERIAL NO. SF-079139-A
b. TYPE OF WELL OIL WELL <input type="checkbox"/> GAS WELL <input checked="" type="checkbox"/> OTHER <input type="checkbox"/> SINGLE ZONE <input type="checkbox"/> MULTIPLE ZONE <input type="checkbox"/>			6. IF INDIAN, ALLOTTEE OR TRIBE NAME
2. NAME OF OPERATOR J. Gregory Merriam			7. UNIT AGREEMENT NAME
3. ADDRESS OF OPERATOR P.O. Box 507, Farmington, NM 87401			8. FARM OR LEASE NAME Federal Com A
4. LOCATION OF WELL (Report location clearly and in accordance with any State requirements.)* At surface 907-970 FSL & 792 FWL At proposed prod. zone same			9. WELL NO. 4
14. DISTANCE IN MILES AND DIRECTION FROM NEAREST TOWN OR POST OFFICE* 17 miles north of Counselors, New Mexico			10. FIELD AND POOL, OR WILDCAT <i>ext.</i> Ballard Pictured Cliffs
15. DISTANCE FROM PROPOSED* LOCATION TO NEAREST PROPERTY OR LEASE LINE, FT. (Also to nearest drilg. unit line, if any)	395' 820'	16. NO. OF ACRES IN LEASE 1040	17. NO. OF ACRES ASSIGNED TO THIS WELL 80 160
18. DISTANCE FROM PROPOSED LOCATION* TO NEAREST WELL, DRILLING, COMPLETED, OR APPLIED FOR, ON THIS LEASE, FT.	200'	19. PROPOSED DEPTH 2650	20. ROTARY OR CABLE TOOLS Rotary
21. ELEVATIONS (Show whether DF, RT, GR, etc.) 6605 GL			22. APPROX. DATE WORK WILL START* April 1, 1980

## 23. PROPOSED CASING AND CEMENTING PROGRAM

SIZE OF HOLE	SIZE OF CASING	WEIGHT PER FOOT	SETTING DEPTH	QUANTITY OF CEMENT
9-3/4"	7"	20#	90	60 sacks
5"	2-7/8"	6.4#	2650	150 sacks

Will drill 9-3/4" hole to 90 ft. and set 90 ft of 7", 20# casing to 90 ft and cement to surface with 60 sacks cement.

Will drill 5" hole to 2650 ft. and set 2650 ft of 2-7/8", 6.4# casing and cement with 150 sacks cement.

Will perforate and stimulate the Pictured Cliffs as warranted.

Gas is not dedicated.

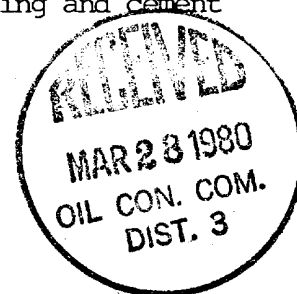

IN ABOVE SPACE DESCRIBE PROPOSED PROGRAM: If proposal is to deepen or plug back, give data on present productive zone and proposed new productive zone. If proposal is to drill or deepen directionally, give pertinent data on subsurface locations and measured and true vertical depths. Give blowout preventer program if any.

24. SIGNED <i>J. Gregory Merriam</i>	TITLE OPERATOR AS AMENDED	DATE January 11, 1980
(This space for Federal or State office use)		
PERMIT NO.	APPROVAL DATE MAR 21 1980 JAMES F. SIMS DISTRICT ENGINEER	
APPROVED BY CONDITIONS OF APPROVAL, IF ANY: <i>ad 3rd</i>	DATE JAN 15 1980	

\*See Instructions On Reverse Side

U. S. GEOLOGICAL SURVEY  
DURANGO, COLO.

## OIL CONSERVATION DIVISION

STATE OF NEW MEXICO  
ENERGY AND MINERALS DEPARTMENTP. O. BOX 2088  
SANTA FE, NEW MEXICO 87501Form C-107  
Revised 10-1-78

All distances must be from the outer boundaries of the Section

Operator <b>J. GREGORY MERRION</b>			Lease <b>FEDERAL COM "A"</b>		Well No. <b>4</b>
Unit Letter <b>M</b>	Section <b>35</b>	Township <b>25N</b>	Range <b>6W</b>	County <b>Rio Arriba</b>	
Actual Footage Location of Well: <b>907</b> feet from the <b>South</b> line and <b>792</b> feet from the <b>West</b> line					
Ground Level Elev. <b>6605</b>	Producing Formation <b>Pictured Cliffs</b>		Pool <b>Ballard</b>	Dedicated Acreage: <b>160</b> Acres	

1. Outline the acreage dedicated to the subject well by colored pencil or hatchure marks on the plat below.
2. If more than one lease is dedicated to the well, outline each and identify the ownership thereof (both as to working interest and royalty).  
See Attachment
3. If more than one lease of different ownership is dedicated to the well, have the interests of all owners been consolidated by communitization, unitization, force-pooling, etc?

☒ Yes ☐ No If answer is "yes," type of consolidation Communitization

If answer is "no," list the owners and tract descriptions which have actually been consolidated. (Use reverse side of this form if necessary.)

No allowable will be assigned to the well until all interests have been consolidated (by communitization, unitization, forced-pooling, or otherwise) or until a non-standard unit, eliminating such interests, has been approved by the Commission.

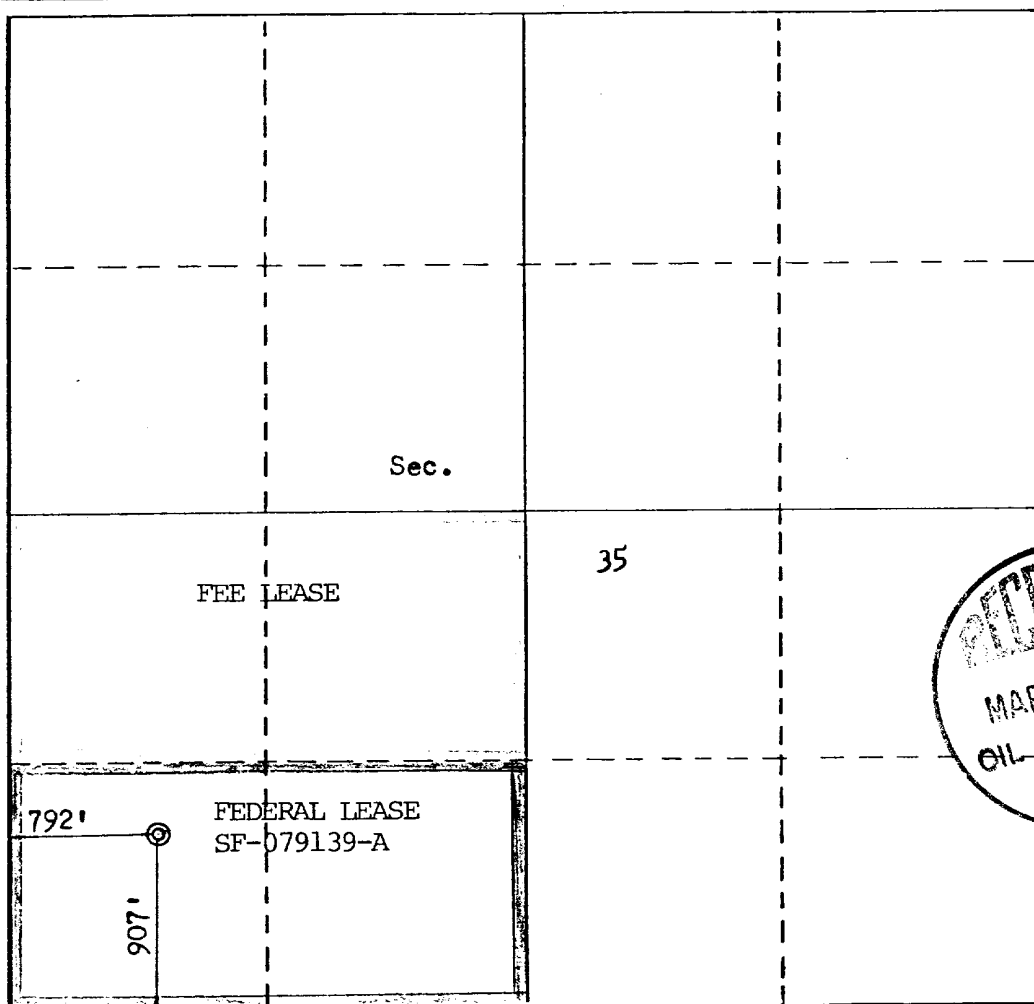

## CERTIFICATION

I hereby certify that the information contained herein is true and complete to the best of my knowledge and belief.

Name

J. Gregory Merrion

Position

Operator

Company

J. Gregory Merrion

Date

January 10, 1980

I hereby certify that the well location on this plat was plotted from field notes of actual surveys made by me or under my supervision, and that the same is true and correct to the best of my knowledge and belief.

Date Surveyed

January 10, 1980

Registered Professional Engineer  
and/or Land Surveyor

Fred B. Kerr, Jr.

Certificate No.

3950

FRED B. KERR, JR.

UNITED STATES  
DEPARTMENT OF THE INTERIOR  
GEOLOGICAL SURVEY

**SUNDRY NOTICES AND REPORTS ON WELLS**

(Do not use this form for proposals to drill or to deepen or plug back to a different reservoir. Use Form 9-331-C for such proposals.)

1. oil well ☐ gas well ☒ other ☐

2. NAME OF OPERATOR  
J. Gregory Merrion

3. ADDRESS OF OPERATOR  
P.O. Box 507, Farmington, NM 87401

4. LOCATION OF WELL (REPORT LOCATION CLEARLY. See space 17 below.)  
AT SURFACE: 907' FSL & 792' FWL  
AT TOP PROD. INTERVAL: same  
AT TOTAL DEPTH: same

16. CHECK APPROPRIATE BOX TO INDICATE NATURE OF NOTICE, REPORT, OR OTHER DATA

REQUEST FOR APPROVAL TO:      SUBSEQUENT REPORT OF:

TEST WATER SHUT-OFF ☐ ☐

FRACTURE TREAT ☐ ☐

SHOOT OR ACIDIZE ☐ ☐

REPAIR WELL ☐ ☐

PULL OR ALTER CASING ☐ ☐

MULTIPLE COMPLETE ☐ ☐

CHANGE ZONES ☐ ☐

ABANDON\* ☐ ☐

(other) Change Cementing Plan

5. LEASE  
SF-079139-A

6. IF INDIAN, ALLOTTEE OR TRIBE NAME

7. UNIT AGREEMENT NAME

8. FARM OR LEASE NAME  
Federal Com A

9. WELL NO.  
4

10. FIELD OR WILDCAT NAME  
Ballard Pictured Cliffs

11. SEC., T., R., M. OR BLK. AND SURVEY OR AREA  
Section 35, T25N, R6W

12. COUNTY OR PARISH  
Rio Arriba

13. STATE  
N.M.

14. API NO.

15. ELEVATIONS. (SHOW DE KDB AND WD)  
6605 GL

(NOTE: Report results of multiple completion or zone change on Form 9-330.)

17. DESCRIBE PROPOSED OR COMPLETED OPERATIONS (Clearly state all pertinent details, and give pertinent dates, including estimated date of starting any proposed work. If well is directionally drilled, give subsurface locations and measured and true vertical depths for all markers and zones pertinent to this work.)\*

2-7/8" production casing will be cemented with 160 sacks (378 cu. ft.) class H cement with 2% D-79 extender followed by 100 sacks (118 cu. ft.) class H cement. (Total slurry volume 496 cu. ft. is 200% of theoretical requirement to return cement to surface.)



Subsurface Safety Valve: Manu. and Type \_\_\_\_\_

18. I hereby certify that the foregoing is true and correct

SIGNED J. Gregory Merrion TITLE Operator DATE January 24, 1980

APPROVED BY \_\_\_\_\_  
CONDITIONS OF APPROVAL, IF ANY: at 3000

(This space for Federal or State office use)

TITLE APPROVED  
AS AMENDED

DATE JAN 28 1980

James F. Sims  
DISTRICT ENGINEER

\*See Instructions on Reverse Side

U. S. GEOLOGICAL SURVEY  
DURANGO, COLO.

J. GREGORY MERRION  
Federal Com A - 4

OWNERSHIP OF COMMUNITIZED TRACTS

Tract 1. Federal Lease SF-079139-A (80 acres)

OVERRIDING ROYALTY AND PERCENTAGES

U. S. A.	12.500000 %
E. Hunter Stone II	0.625000 %
Ben Donegan	1.000000 %
Helen Fields Harkins	2.500000 %
Texas Natural Petroleum Co.	0.380854 %
Hortense E. Davant	0.122073 %
Grace K. Davant	0.122073 %
B. W. Woolley	0.625000 %
Big Chief Drilling Co.	0.625000 %
Total	18.500000 %

NAME AND PERCENTAGE OF WORKING INTEREST OWNERS

C. J. Warren	16.660000 %
First National Bank of Albuquerque, Trustee	8.330000 %
Nancy S. Friedman	8.330000 %
Continental-Emsco Company	9.188325 %
Halliburton Company	3.311675 %
Kimbell Oil Company	54.170000 %

Tract 2. Fee Lease (80 acres)

OVERRIDING ROYALTY AND PERCENTAGES

J. Gregory Merrion	3.2500 %
Iris Balbach	1.5625 %
Lorna Harvey	1.5625 %
Marjorie O. Underwood or Genevieve Organ	0.4060 %

NAME AND PERCENTAGE OF WORKING INTEREST OWNERS

J. Gregory Merrion	35.93227 %
D. J. Merrion, Trustee	28.13600 %
William W. Merrion	28.13600 %
R. E. Merrion	7.79573 %

SURFACE USE OPERATIONS PLAN

J. GREGORY MERRION  
Federal Com. A-4

1. & 2. A topographical map is attached showing location of drillsite and access roads to location; no new roads to be made.
3. Wells within one mile radius are shown on the topographical map.
4. A. Existing facilities owned or controlled by the Operator and shown on the attached map are as follows: wellheads.  
B. No new facilities are contemplated.  
C. Disturbed areas will be reseeded per BLM specifications.
5. Water will be hauled from fee land waterhole.  
Truck will haul water on proposed access route shown.
6. No construction materials will be used.
7. Methods of disposal of waste materials:  
A. Cuttings will be buried in drilling pit.  
B. Drilling fluids will be buried in drilling pit.  
C. No produced fluids are anticipated.  
D. Sewage will be buried.  
E. Garbage and other waste material will be buried.  
F. Operator will clean up, fill, and level pits and reseed location per BLM specifications.
8. No ancillary facilities.
9. Wellsite layout attached.
10. Restoration of drillsite -- pits will be filled and leveled and reseeded per BLM specifications immediately after completion.
11. Other information:  
The drillsite is fairly level, grass and brush covered semi-arid land. There is no other surface use of facilities existent. An archeological survey statement will be furnished.
12. Operator representative: J. Gregory Merrion 325-5093  
P.O. Box 507  
Farmington, NM 87401
13. Certification:

I hereby certify that I, or persons under my direct supervision, have inspected the proposed drillsite and access route; that I am familiar with the conditions which presently exist; that the statements made in this plan are, to the best of my knowledge, true and correct; and, that the work associated with the operations proposed herein will be performed by J. Gregory Merrion and its contractors and subcontractors in conformity with this plan and the terms and conditions under which it is approved.

1 - 11 - 80

Date

  
J. Gregory Merrion  
Operator

LOCATION AND EQUIPMENT LOG

J. GREGORY MERRION  
Federal Com. A-4  
Section 35, T25N, R6W  
Rio Arriba County, New Mexico

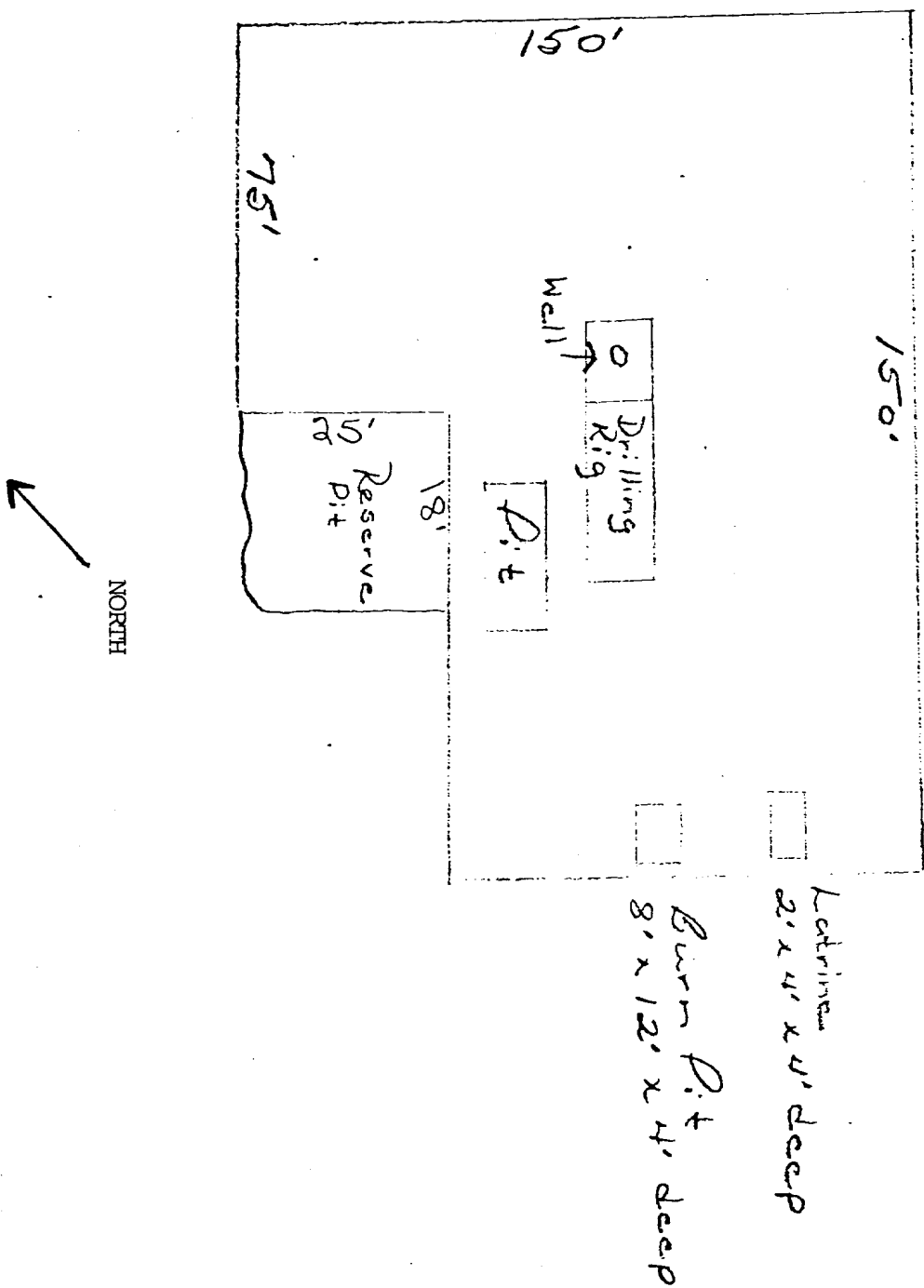



Vicinity Map for  
J. Gregory Merrion Federal Com "A" 4  
970' FNL & 792' FWL Section 35, T25N, R6W  
RIO ARRIBA COUNTY, NEW MEXICO