

Denny E. Faust
DEPUTY OIL & GAS INSPECTOR

AUG 19 1999

State of New Mexico
Energy, Minerals and Natural Resources Department

OIL CONSERVATION DIVISION
P.O. Box 2088
Santa Fe, New Mexico 87504-2088

NO BTEX landfills

RECEIVED
MAY 27 1999

OIL CON. DIV.
DIST. 3

Approved
PIT REMEDIATION AND CLOSURE REPORT

Operator: Amoco Production Company (Williams Field Services) Telephone: (801) 584-6361
Address: P.O. Box 58900, Salt Lake City, Utah 84158-0900
WellName: REAMES A #1E (85453)
Location: Unit or Qtr/Qtr Sec J Sec 24 T 26N R 6W County Rio Arriba
PitType Dehydrator
LandType: BLM

Pit Location: Pit dimensions: length 28 ft., width 26 ft., depth 8 ft.
(Attach diagram)

Reference: Wellhead

Footage from reference: 76 ft.

Direction from reference: 60 Degrees East of North

Depth To Ground Water:	Less than 50 feet	(20 points)	
(Vertical distance from	50 feet to 99 feet	(10 points)	
contaminants to seasonal	Greater than 100 feet	(0 points)	<u>0</u>
high water elevation of			
ground water)			

Wellhead Protection Area:	Yes	(20 points)	
(Less than 200 feet from a private	No	(0 points)	<u>0</u>
domestic water source, or: less than			
1000 feet from all other water sources)			

Distance To Surface Water:	Less than 200 feet	(20 points)	
(Horizontal distance to perennial	200 feet to 1,000 feet	(10 points)	
lakes, ponds, rivers, streams, creeks,	Greater than 1,000 feet	(0 points)	<u>0</u>
irrigation canals and ditches)			

Ranking Score (TOTAL POINTS): 0

Date Remediation Started: 6/1/98

Date Completed: 6/1/98

Remediation Method: Excavation ☒

Approx. Cubic Yard 215

(check all appropriate sections)

Landfarmed ☒

Insitu Bioremediation

Other Landfarmed soil after mechanical aeration.

Remediation Location: Onsite ☒ Offsite

(ie. landfarmed onsite, name and location of offsite facility)

General Description Of Remedial Action:

The pit was excavated to remove gross petroleum contamination. The excavated material was mechanically aerated and placed into an onsite landfarm.

Ground Water Encountered: No

Final Pit:

Closure Sampling:

(if multiple samples, attach sample results and diagram of sample locations and depths)

Sample location REAMS A#1E-V-EXFL-01

Two samples were collected, one sample from the excavation bottom and the second sample was made up of 4 points from each excavation wall.

Sample depth 12 feet

Sample date 6/1/98

Sample time 16:25

Sample Result

Benzene (ppm) <0.05

Total BTEX (ppm) 1.100

Field Headspace (ppm)

TPH (ppm) 38

Ground Water Sample: No

I HEREBY CERTIFY THAT THE INFORMATION ABOVE IS TRUE AND COMPLETE TO THE BEST OF MY KNOWLEDGE AND BELIEF

DATE 5-20-99

SIGNATURE

PRINTED NAME Mark Harvey for Williams Field Services
AND TITLE

PIT RETIREMENT FORM

85453

Date: 6.1.98

Weather SUNNY 80'S

Well Name REAMES A # 1 E Operator AMOCO

Sec 24 T 26 R 6 UL J

Land Type: BLM STATE FEE INDIAN

County RIO ARriba

One Call Made (505-765-1234)? Y N

Line Marking Evident? Y N

Pit Location:

Reference Wellhead X Other _____

Distance from: 76

Direction: 60 Degrees X E N X
of
W S

Starting Pit Dimensions 14 X 13 X 2

Final Pit Dimensions 28 X 26 X 8

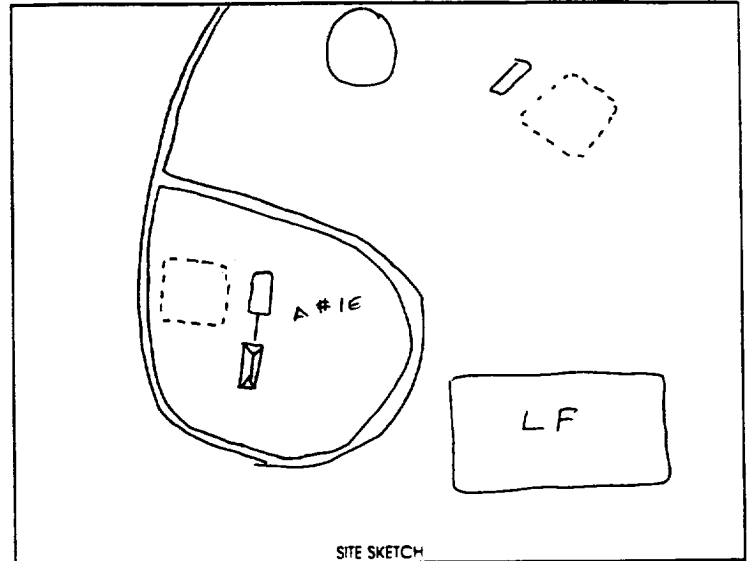

Organic Vapor Readings: Start _____ Soil Description: SILTY CLAY
@ 2' _____
@ 4' _____
@ 6' _____
@ 8' _____
@ _____
@ _____

Well Proximity To: Residence, Domestic Water Well, Stock Well >100
Arroyo, Wash, Lake, Stream >100
Estimated or Known Distance to Ground Water >100

Source of Backfill (if other than processed material) _____

Samples collected: Type Progress: Verification ID REAMES A # 1 E . V . EXWA . 01 soil / water
Progress: Verification ID REAMES A # 1 E . V . EXFL . 01 soil / water
Progress: Verification: ID _____ soil / water

Sample sent to Lab Via: Courier Hand Carried Other _____ Preservative: ICE Other _____

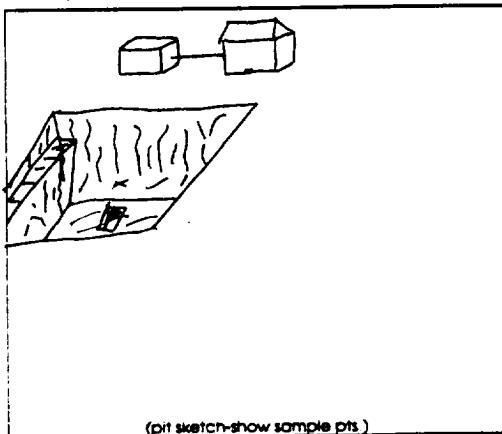

Comments: SITE HAD LITTLE TO NO STAINING OR ODOR -
WALLS APPEAR TO BE CLEAN - FOUR FOOT SAMPLE
TRENCH IN FLOOR

Soil Shipped to: ON SITE LANDFARM

Prepared by: Maul Y M/L

85453

Q W A L L A B O R A T O R I E S , I N C .

2911 ROTARY TERRACE, P.O. BOX 562/PITTSBURG, KS 66762/(316)232-1970

LABORATORY REPORT:

REFERENCE #: 9806168

SENT **WILLIAMS FIELD SERVICE-MS4JI**
 TO: **P.O. BOX 58900**
SALT LAKE CITY, UTAH 84108
MARK HARVEY
 PROJECT: JICARILLA PIT REMEDIATION

DATE REPORTED: 06/17/98
 DATE COLLECTED: 06/01/98
 DATE RECEIVED: 06/04/98

Reference Fraction: 9806168-04A
 Sample ID: REAMS A#1E-V-EXFL-01
 Sample Date Collected: 06/01/98 16:25:00

Sample Matrix: SOIL

TEST	METHOD	RESULT	UNITS	DL	ANALYZED	BY
BTEX	SW846 8021			3.0		
BENZENE		ND	MG/KG	0.050	06/06/98	JK
TOLUENE		0.2	MG/KG	0.050	06/06/98	JK
ETHYLBENZENE		ND	MG/KG	0.050	06/06/98	JK
TOTAL XYLENES		0.8	MG/KG	0.050	06/06/98	JK
BFB (SURROGATE)		104	125	75		
TPH	SW846-8015	38.0	MG/KG	2.0	06/06/98	SKW

ND=NONE DETECTED
 DL=DETECTION LIMIT
 SU=STANDARD UNITS
 B=DETECTED IN METHOD BLANK

APPROVED BY: _____

 TERRY KOESTER
 LABORATORY DIRECTOR

85453

Q W A L L A B O R A T O R I E S , I N C .

2911 ROTARY TERRACE, P.O. BOX 562/PITTSBURG, KS 66762/(316)232-1970

LABORATORY REPORT:

REFERENCE #: 9806168

SENT **WILLIAMS FIELD SERVICE-MS4JI**
 TO: **P.O. BOX 58900**
SALT LAKE CITY, UTAH 84108
MARK HARVEY

DATE REPORTED: 06/17/98
 DATE COLLECTED: 06/01/98
 DATE RECEIVED: 06/04/98

PROJECT: JICARILLA PIT REMEDIATION

Reference Fraction: 9806168-03A

Sample ID: REAMS A#1E-V-EXWA-01

Sample Matrix: SOIL

Sample Date Collected: 06/01/98 16:25:00

TEST	METHOD	RESULT	UNITS	DL	ANALYZED	BY
BTEX	SW846 8021			3.0		
BENZENE		ND	MG/KG	0.050	06/06/98	JK
TOLUENE		ND	MG/KG	0.050	06/06/98	JK
ETHYLBENZENE		ND	MG/KG	0.050	06/06/98	JK
TOTAL XYLENES		0.3	MG/KG	0.050	06/06/98	JK
BFB (SURROGATE)		114	125	75		
TPH	SW846-8015	7.72	MG/KG	2.0	06/06/98	SKW

ND=NONE DETECTED

DL=DETECTION LIMIT

SU=STANDARD UNITS

B=DETECTED IN METHOD BLANK

APPROVED BY: _____

 TERRY KOESTER
 LABORATORY DIRECTOR

QWAL LABORATORIES, INC.

2911 ROTARY TERRACE, P.O. BOX 562/PITTSBURG, KS 66762/(316)232-1970

LABORATORY REPORT:

REFERENCE #: 9807321

SENT WILLIAMS FIELD SERVICE-MS4JI
TO: P.O. BOX 58900
SALT LAKE CITY, UTAH 84108
MARK HARVEY

DATE REPORTED: 07/14/98
DATE COLLECTED: 07/06/98
DATE RECEIVED: 07/09/98

PROJECT: PIT REMEDIATION

Reference Fraction: 9807321-20A

Sample ID: REAMES A#1E-V-LF-01 / 85453 / 3 PPM Sample Matrix: SOIL

Sample Date Collected: 07/06/98 10:07:00

TEST	METHOD	RESULT	UNITS	DL	ANALYZED	BY
TPH	SW846-8015	179	MG/KG	40.0	07/11/98	SKW

ND-NONE DETECTED

DL-DETECTION LIMIT

SU-STANDARD UNITS

B-DETECTED IN METHOD BLANK

APPROVED BY:

TERRY KOESTER
LABORATORY DIRECTOR

Q W A L L A B O R A T O R I E S , I N C .

2911 ROTARY TERRACE, P.O. BOX 562/PITTSBURG, KS 66762/(316)232-1970

LABORATORY REPORT:

REFERENCE #: 9808275

SENT WILLIAMS FIELD SERVICE-MS4JI
TO: P.O. BOX 58900
SALT LAKE CITY, UTAH 84108
MARK HARVEY
PROJECT: JICARILLA DISTRICT '98

DATE REPORTED: 08/13/98
DATE COLLECTED: 08/07/98
DATE RECEIVED: 08/11/98

OVm - 3

Reference Fraction: 9808275-19A
Sample ID: REAMES A#1E-V-LF-02
Sample Date Collected: 08/07/98 14:36:00

Sample Matrix: SOIL

TEST	METHOD	RESULT	UNITS	DL	ANALYZED	BY
TPH	SW846-8015	64.4	MG/KG	2.0	08/12/98	SKW

ND=NONE DETECTED
DL=DETECTION LIMIT
SU=STANDARD UNITS
B=DETECTED IN METHOD BLANK

APPROVED BY:

TERRY KOESTER
LABORATORY DIRECTOR