

NEW MEXICO OIL CONSERVATION COMMISSION
WELL LOCATION AND ACREAGE DEDICATION AT

Form C-102
Supersedes C-12B
Effective 1-1-65

All distances must be from the outer boundaries of the Section.

Operator Jerome P. McHugh		Lease Jicarilla		Well No. 12	
Unit Letter J	Section 30	Township 26 North	Range 4 West	County Rio Arriba	
Actual Footage Location of Well: 1650 feet from the South line and 1650 feet from the East line					
Ground Level Elev. 6691	Producing Formation Gallup-Dakota	Pool W Lindrith Gallup-Dakota	Dedicated Acreage: 160.0 * Acres		

1. Outline the acreage dedicated to the subject well by colored pencil or hachure marks on the plat below.
2. If more than one lease is dedicated to the well, outline each and identify the ownership thereof (both as to working interest and royalty).
3. If more than one lease of different ownership is dedicated to the well, have the interests of all owners been consolidated by communitization, unitization, force-pooling, etc?

☐ Yes ☐ No If answer is "yes," type of consolidation _____

If answer is "no," list the owners and tract descriptions which have actually been consolidated. (Use reverse side of this form if necessary.) _____

No allowable will be assigned to the well until all interests have been consolidated (by communitization, unitization, forced-pooling, or otherwise) or until a non-standard unit, eliminating such interests, has been approved by the Commission.

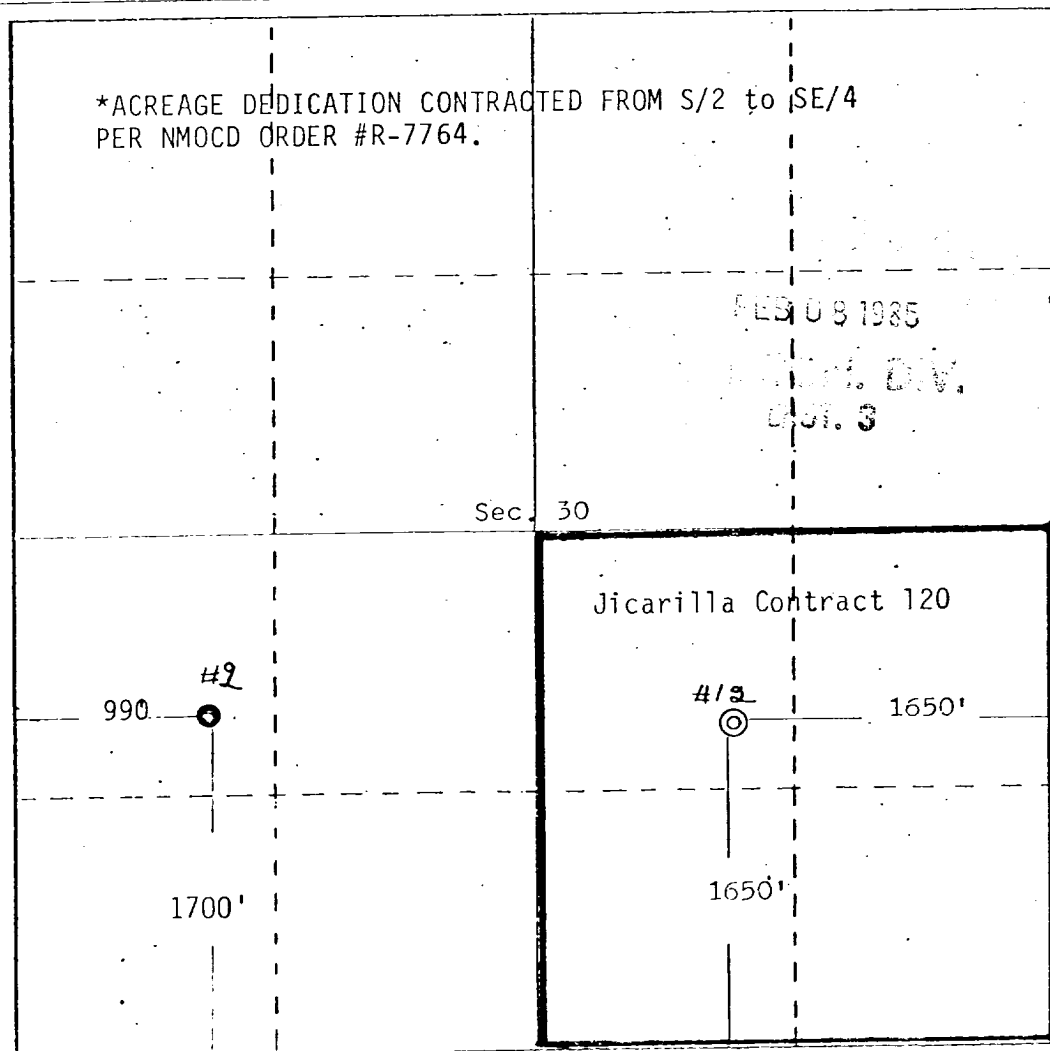

CERTIFICATION

I hereby certify that the information contained herein is true and complete to the best of my knowledge and belief.

Name
Jim L. Jacobs

Position

Agent

Company

DUGAN PRODUCTION CORP.

Date
2-5-85

I hereby certify that the well location shown on this plat was plotted from field notes of actual surveys made by me or under my supervision, and that the same is true and correct to the best of my knowledge and belief.

Date Surveyed
March 22, 1980

Registered Professional Engineer and/or Land Surveyor

Edgar L. Risenhoover
Certificate No. 5979

Edgar L. Risenhoover, L.S.