



Southern  
Rockies  
Business  
Unit

June 12, 1996

Mr. William J. LeMay, Director  
New Mexico Oil Conservation Division  
2040 S. Pacheco Street  
P. O. Box 6429  
Santa Fe, NM 87505

**Application for Exception to Rule 303-C**  
**Downhole Commingling**  
**Jicarilla 155 #13~~W~~ Well** *is 13m*  
**Unit L Section 30-T26N-R5W**  
**Otero Chacra, Blanco Mesaverde and Basin Dakota**  
**Rio Arriba County, New Mexico**

RECEIVED  
JUN 17 1996

OIL CON. DIV.  
DML 3

Enclosed please find an administrative application form (C-107-A) and attachments for downhole commingling for the captioned well. By copy of this application by certified mail, return receipt requested, Amoco is notifying all offset operators in the formations captioned above as well as all affected interest owners if the ownership of those formations is not common. Amoco is the only offset operator in both formations. The Division Director may approve the proposed downhole commingling in the absence of a valid objection from any offset operator or any interest owner in those instances where ownership is not common in the zones to be commingled within 20 days after the receipt of the application if, in his opinion, waste will not result thereby, and correlative rights will not be violated.

Sincerely,

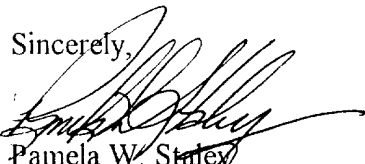
  
Pamela W. Staley

Enclosures

cc: Steve Smethie  
Patty Haefele  
Wellfile  
Proration file

Frank Chavez, Supervisor  
NMOCD District III  
1000 Rio Brazos Road  
Aztec, NM 87410

Robert Kent  
Bureau of Land Management  
435 Montano NE  
Albuquerque, NM 87107

DISTRICT I  
P.O. Box 1980, Hobbs NM 88241-1980

State of New Mexico  
Energy, Minerals and Natural Resources Department

Form C-107-A  
New 3-12-96

RECEIVED  
JUN 17 1996

OIL CON. DIV.  
DIST. 3

OIL CONSERVATION DIVISION

DISTRICT II  
811 South First St., Artesia, NM 88210-2835

APPROVAL PROCESS:  
2040 S. Pacheco  
Santa Fe, New Mexico 87505-6429

☒ Administrative ☐ Hearing

DISTRICT III  
1000 Rio Brazos Rd., Aztec, NM 87410-1693

EXISTING WELLBORE  
☒ YES ☐ NO

APPLICATION FOR DOWNHOLE COMMINGLING

Amoco Production Company P.O. Box 800 Denver, CO 80201

Operator Address  
Jicarilla Contract #155 13E Unit L Section 30-T26N-R5W Rio Arriba

Lease Well No. Unit Ltr. - Sec Twp - Rge County

Spacing Unit Lease Types: (check 1 or more)

OGRID NO. 000778 Property Code 000741 API NO. 3003922347 Federal ☒ State (and/or) Fee

The following facts are submitted in support of downhole commingling:	Upper Zone	Intermediate Zone	Lower Zone
1. Pool Name and Pool Code	OTERO CHACRA 82329	BLANCO MESAVERDE 72319	BASIN DAKOTA 71599
2. Top and Bottom of Pay Section (Perforations)	3827' - 3939'	5130' - 5254'	7166' - 7366'
3. Type of production (Oil or Gas)	GAS	GAS	GAS
4. Method of Production (Flowing or Artificial Lift)	FLOWING	FLOWING	FLOWING
5. Bottomhole Pressure Oil Zones - Artificial Lift: Gas & Oil - Flowing: All Gas Zones: Estimated Current Measured Current Estimated or Measured Original	a. (Current) 643 PSI b. (Original) 1156 PSI	a. 880 PSI b. 1426 PSI	a. 969 PSI b. 2944 PSI
6. Oil Gravity (° API) or Gas BTU Content	1194 BTU	1200 BTU	1247 BTU
7. Producing or Shut-In?	PRODUCING	PRODUCING	PRODUCING
Production Marginal? (yes or no) • If Shut-In, give data and oil/gas/water rates of last production Note: For new zones with no production history, applicant shall be required to attach production estimates and supporting data • If Producing, give date and oil/gas/water rates of recent test (within 60 days)	YES Date: Rates: 5/96 15 MCFD .01 BCPD 0 BWPD	NO Date: Rates: 5/96 150 MCFD 26 BOPD 0 BWPD	NO Date: Rates: 5/96 160 MCFD 1.4 BCPD 1.34 BWPD
8. Fixed Percentage Allocation Formula -% for each zone	Oil: 1 % Gas 5 %	Oil: 98 % Gas 46 %	Oil: 1 % Gas 49 %

9. If allocation formula is based upon something other than current or past production, or is based upon some other method, submit attachments with supporting data and/or explaining method and providing rate projections or other required data.

10. Are all working, overriding, and royalty interests identical in all commingled zones? ☒ Yes ☐ No  
If not, have all working, overriding, and royalty interests been notified by certified mail? ☐ Yes ☐ No  
Have all offset operators been given written notice of the proposed downhole commingling? ☒ Yes ☐ No

11. Will cross-flow occur? ☒ Yes ☐ No If yes, are fluids compatible, will the formations not be damaged, will any cross-flowed production be recovered, and will the allocation formula be reliable. ☒ Yes ☐ No (If No, attach explanation)

12. Are all produced fluids from all commingled zones compatible with each other? ☒ Yes ☐ No

13. Will the value of production be decreased by commingling? ☐ Yes ☒ No (If Yes, attach explanation)

14. If this well is on, or communitized with, state or federal lands, either the Commissioner of Public Lands or the United States Bureau of Land Management has been notified in writing of this application. ☒ Yes ☐ No JICARILLA CONTRACT #155

15. NMOCD Reference Cases for Rule 303(D) Exceptions: ORDER NO(S):

16. ATTACHMENTS:

- \* C-102 for each zone to be commingled showing its spacing unit and acreage dedication.
- \* Production curve for each zone for at least one year. (If not available, attach explanation.)
- \* For zones with no production history, estimated production rates and supporting data.
- \* Data to support allocation method or formula.
- \* Notification list of all offset operators.
- \* Notification list of working, overriding, and royalty interests for uncommon interest cases.
- \* Any additional statements, data, or documents required to support commingling.

I hereby certify that the information above is true and complete to the best of my knowledge and belief.

SIGNATURE Pamela Staley TITLE REGULATORY AFFAIRS REP DATE 6/12/96  
TYPE OR PRINT NAME PAMELA W. STALEY TELEPHONE NO. ( 303 ) 830-5344

All distances must be from the outer boundaries of the Section

Operator AMOCO PRODUCTION COMPANY			Lease JICARILLA CONTRACT 155		Well No. 13-E
Unit Letter L	Section 30	Township 26N	Range 5W	County Rio Arriba	
Actual Footage Location of Well: 1560 feet from the South line and 790 feet from the West line					
Ground Level Elev. 6619	Producing Formation Dakota/Chacra		Pool Basin Dakota /Otero Chacra		Dedicated Acreage: 320/160 Acres

1. Outline the acreage dedicated to the subject well by colored pencil or hatchure marks on the plat below.
2. If more than one lease is dedicated to the well, outline each and identify the ownership thereof (both as to working interest and royalty).
3. If more than one lease of different ownership is dedicated to the well, have the interests of all owners been consolidated by communitization, unitization, force-pooling, etc?

☐ Yes ☐ No If answer is "yes," type of consolidation \_\_\_\_\_

If answer is "no," list the owners and tract descriptions which have actually been consolidated. (Use reverse side of this form if necessary.) \_\_\_\_\_

No allowable will be assigned to the well until all interests have been consolidated (by communitization, unitization, forced-pooling, or otherwise) or until a non-standard unit, eliminating such interests, has been approved by the Commission.

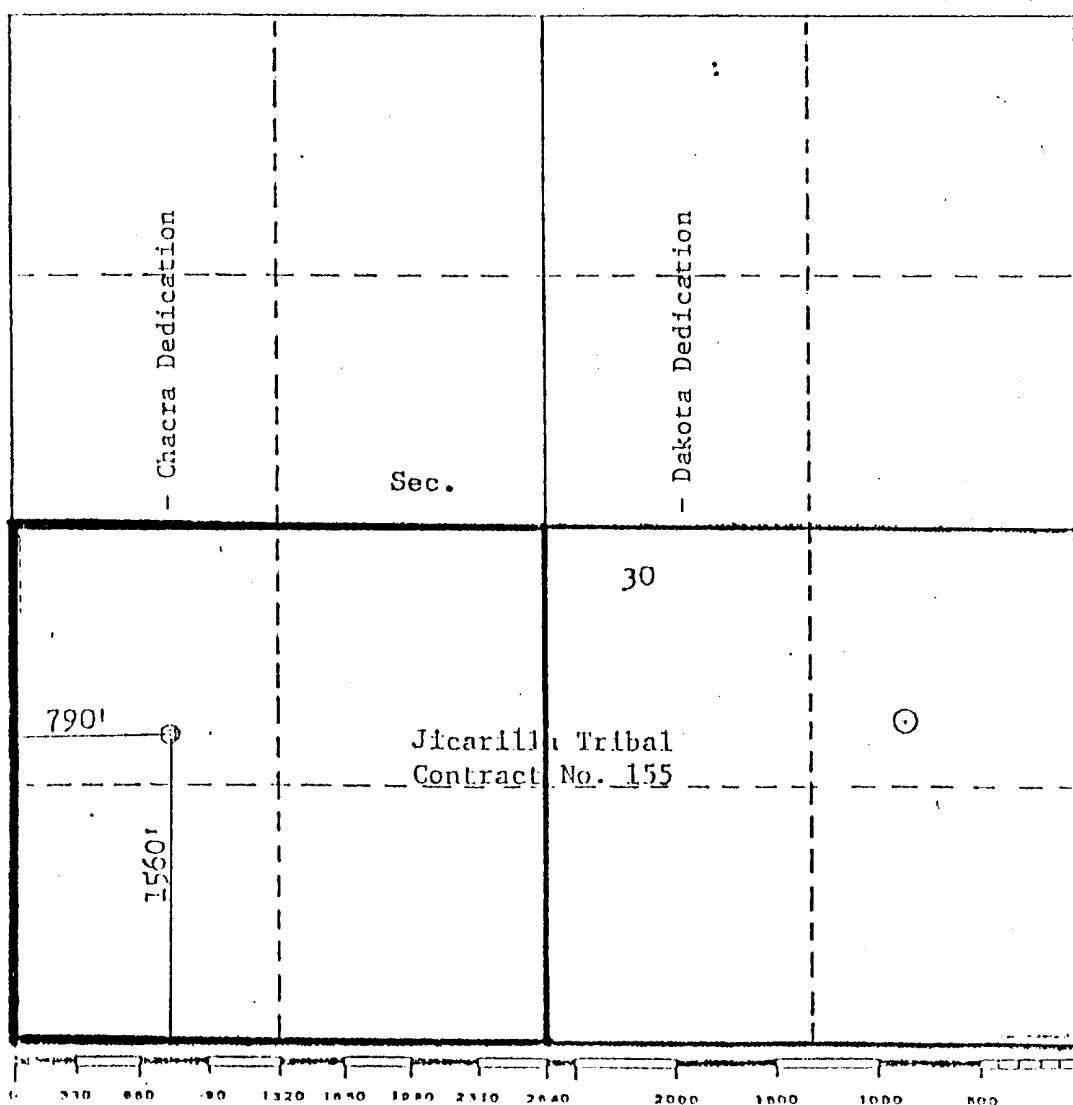

## CERTIFICATION

I hereby certify that the information contained herein is true and complete to the best of my knowledge and belief.

*W. L. Peterson*  
Name

W. L. PETERSON

Position

DISTRICT ENGINEER

Company

AMOCO PRODUCTION COMPANY

Date

SEPTEMBER 11, 1981

I hereby certify that the well location shown on this plat was plotted from field notes of actual surveys made by me or under my supervision, and that the same is true and correct to the best of my knowledge and belief.

Date Surveyed

January 21, 1980

Registered Professional Engineer  
and/or Land Surveyor

*Fred B. Kerr Jr.*  
Fred B. Kerr Jr.

Certificate No.

3950

District I  
PO Box 1980, Hobbs, NM 88241-1980

District II

811 South First, Artesia, NM 88210

District III

1000 Rio Brazos Rd., Aztec, NM 87410

District IV

2040 South Pacheco, Santa Fe, NM 87505

State of New Mexico  
Energy, Minerals & Natural Resources Department

OIL CONSERVATION DIVISION  
2040 South Pacheco  
Santa Fe, NM 87505

Form C-102

Revised October 18, 1994

Instructions on back

Submit to Appropriate District Office

State Lease - 4 Copies

Fee Lease - 3 Copies

☐ AMENDED REPORT

WELL LOCATION AND ACREAGE DEDICATION PLAT

1 API Number 30-039-22347		2 Pool Code 72319		3 Pool Name Blanco Mesaverde	
4 Property Code 000741		5 Property Name Jicarilla Contract 155			6 Well Number 13m
7 OGRID No. 000778		8 Operator Name Amoco Production Company			9 Elevation 6619'

10 Surface Location

UL or lot no.	Section	Township	Range	Lot Idn	Feet from the	North/South line	Feet from the	East/West line	County
L	30	26N	5W		1560	South	790	West	Rio Arriba

11 Bottom Hole Location If Different From Surface

UL or lot no.	Section	Township	Range	Lot Idn	Feet from the	North/South line	Feet from the	East/West line	County

12 Dedicated Acres 160	13 Joint or Infill	14 Consolidation Code	15 Order No.
---------------------------	--------------------	-----------------------	--------------

NO ALLOWABLE WILL BE ASSIGNED TO THIS COMPLETION UNTIL ALL INTERESTS HAVE BEEN CONSOLIDATED  
OR A NON-STANDARD UNIT HAS BEEN APPROVED BY THE DIVISION

16				17 OPERATOR CERTIFICATION I hereby certify that the information contained herein is true and complete to the best of my knowledge and belief.  Signature <u>Patty Haeefe</u> Patty Haeefe Printed Name Staff Assistant Title Nov. 6, 1995 Date
				18 SURVEYOR CERTIFICATION I hereby certify that the well location shown on this plat was plotted from field notes of actual surveys made by me or under my supervision, and that the same is true and correct to the best of my belief.  Date of Survey 9/11/91 Signature and Seal of Professional Surveyor: on file  3950 Certificate Number

790'

1560'

JICARILLA #155-13E MV

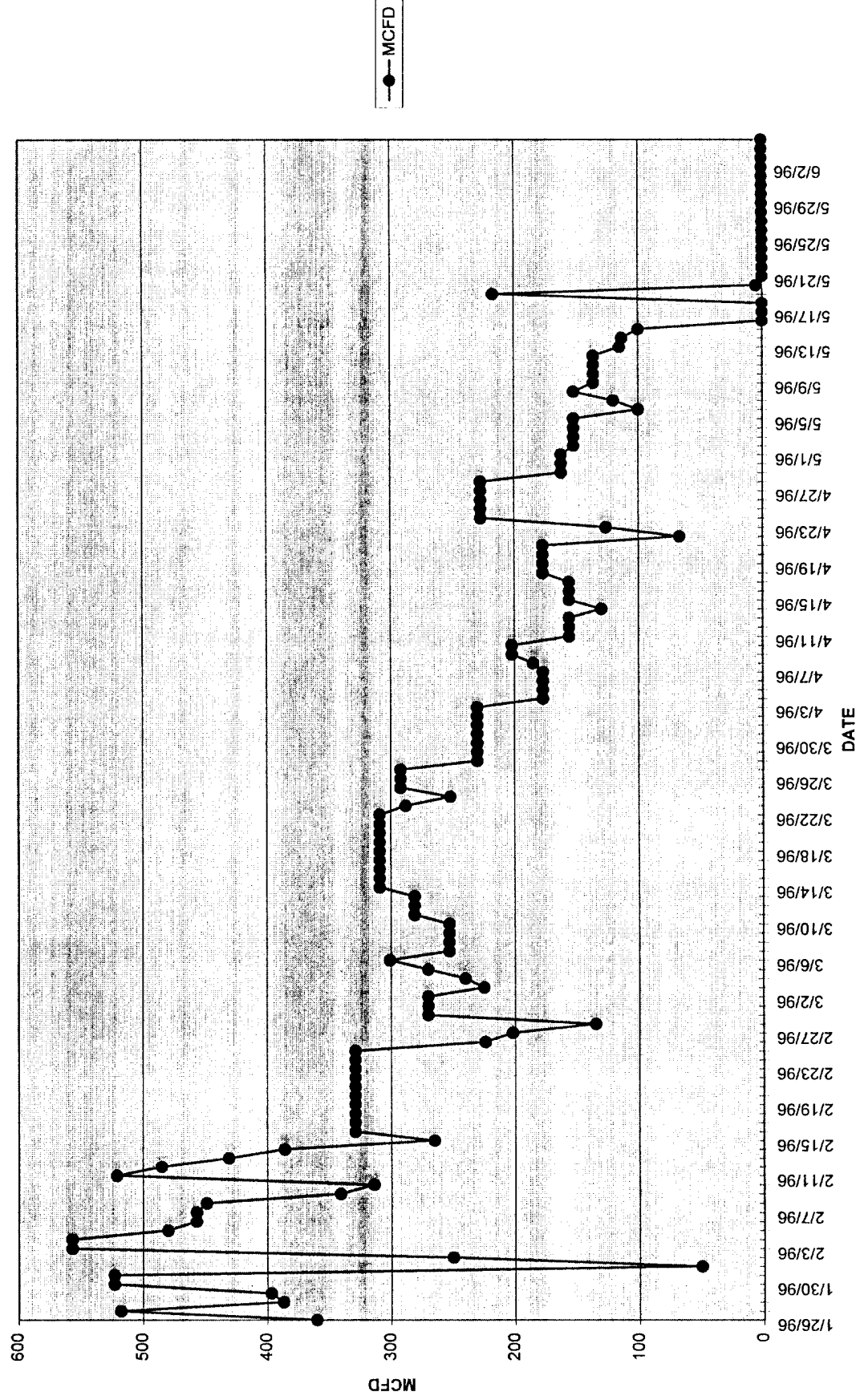

Engr: zhab0b

JICARILLA CONTRACT 155 13E

Operator— AMOCO PRODUCTION CO

300392234700CK L302605-013ECK

APC\_WI — 1.0000000

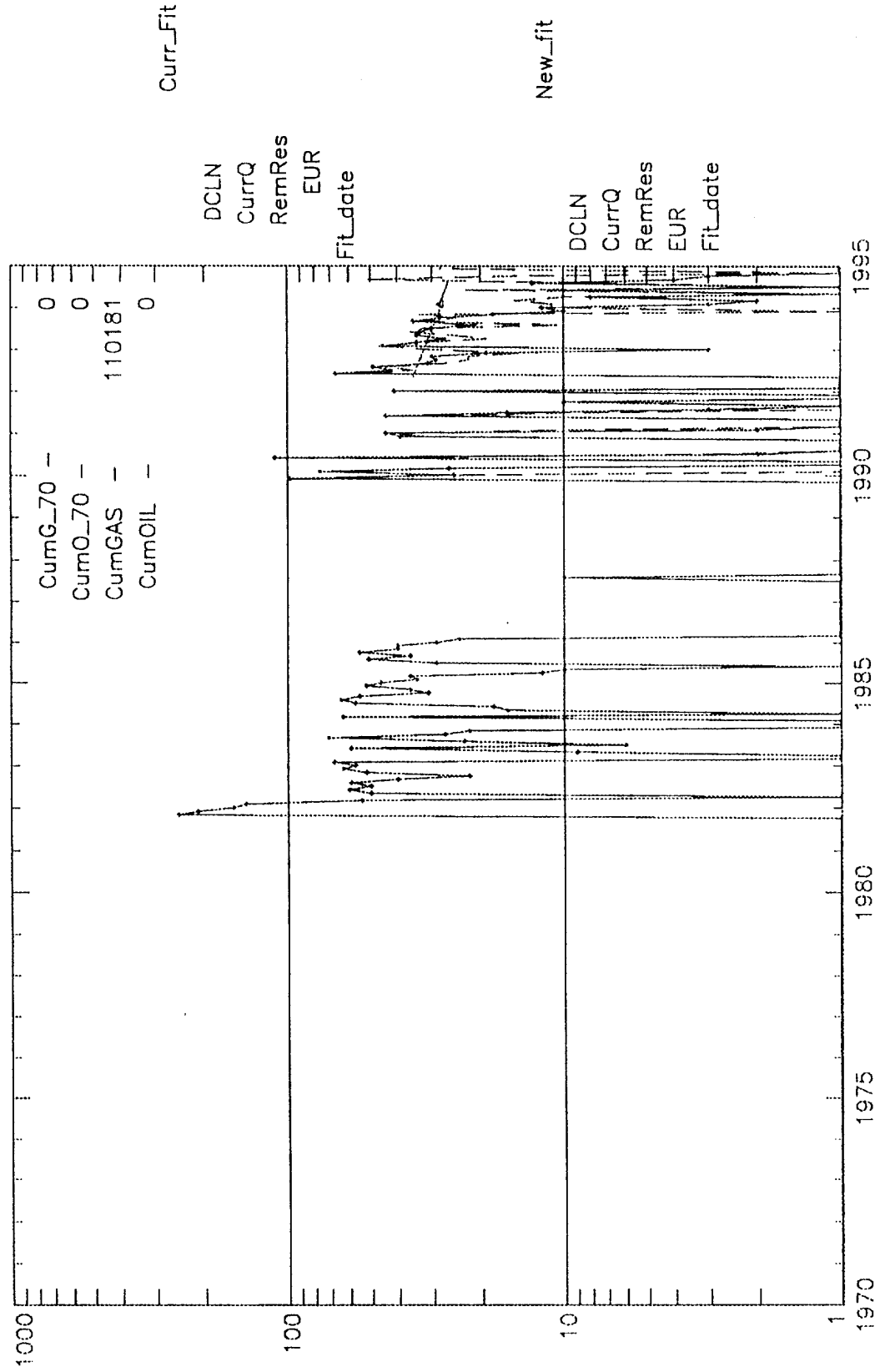

Engr: zhab0b

JICARILLA CONTRACT 155 13E

Operator— AMOCO PRODUCTION CO

300392234700DK L302605-013EDK

APC\_WI — 1.0000000

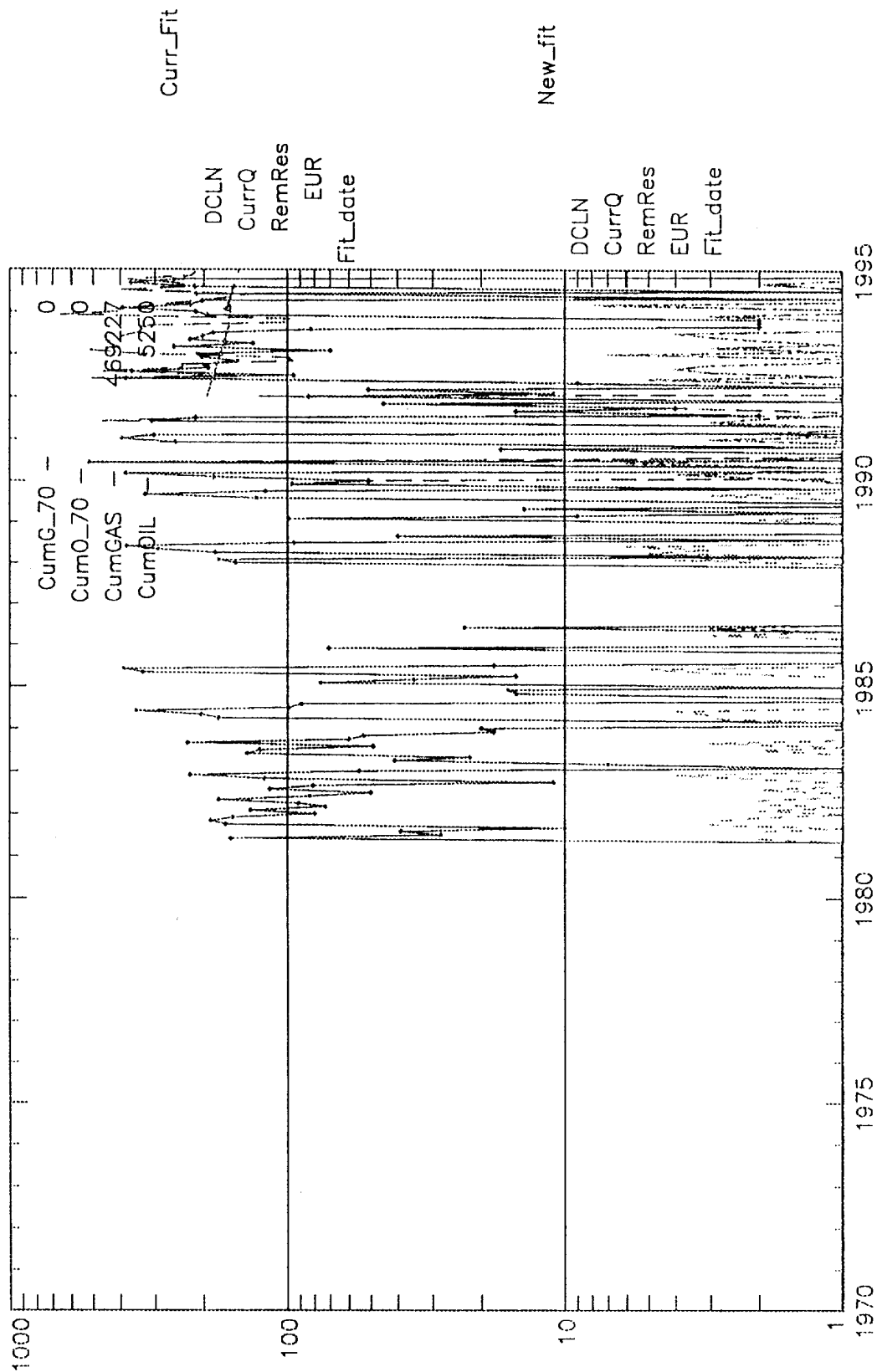

**OFFSET OPERATORS**

Meridian Oil, Inc.  
P.O. Box 4289  
Farmington, NM 87499