

All distances must be from the outer boundaries of the Section.

REVISED Form C-102

Lessor AMOCO PRODUCTION COMPANY			Lease JICARILLA APACHE 102			Well No. 8E		
Unit Letter I	Section 3	Township 26N	Range 1W	County Rio Arriba				
Actual Footage Location of Well:								
1700 feet from the		South line and		940 feet from the		East line		
Ground Level Elev. 6905		Producing Formation Dakota/Mesaverde		Pool Basin Dakota/Blanco Mesaverde		Dedicated Acreage: 5320/321.14 Acres		

1. Outline the acreage dedicated to the subject well by colored pencil or hachure marks on the plat below.
2. If more than one lease is dedicated to the well, outline each and identify the ownership thereof (both as to working interest and royalty).
3. If more than one lease of different ownership is dedicated to the well, have the interests of all owners been consolidated by communitization, unitization, force-pooling, etc?

☐ Yes ☐ No If answer is "yes," type of consolidation _____

If answer is "no," list the owners and tract descriptions which have actually been consolidated. (Use reverse side of this form if necessary.) _____

No allowable will be assigned to the well until all interests have been consolidated (by communitization, unitization, forced-pooling, or otherwise) or until a non-standard unit, eliminating such interests, has been approved by the Commission.

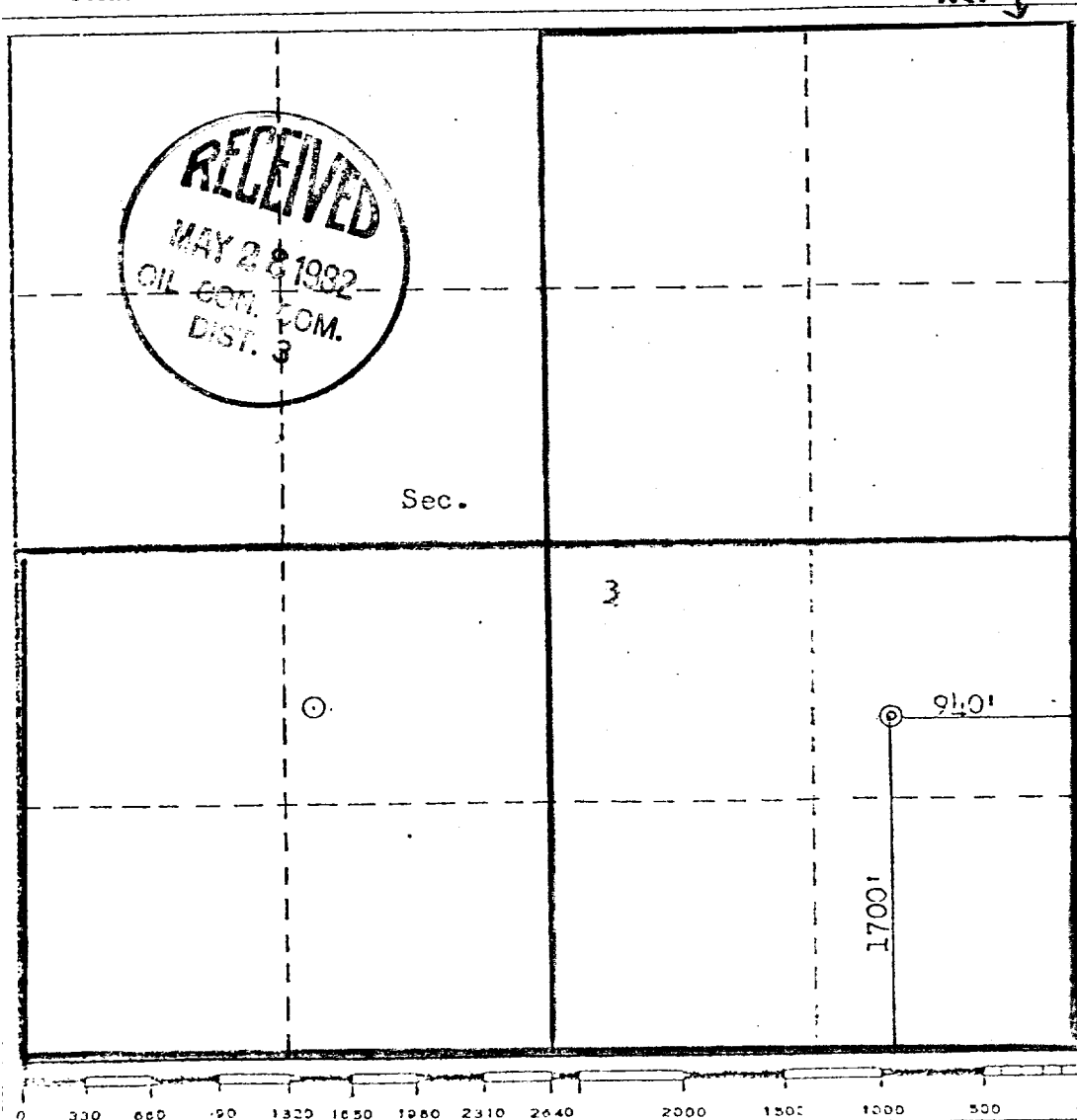

CERTIFICATION	
I hereby certify that the information contained herein is true and complete to the best of my knowledge and belief.	
Name	D. H. Shoemaker
Position	DISTRICT ENGINEER
Company	AMOCO PRODUCTION COMPANY
Date	May 26, 1982
I hereby certify that the well location shown on this plat was plotted from field notes of actual surveys made by me or under my supervision, and that the same is true and correct to the best of my knowledge and belief.	
Date Surveyed	April 25, 1980
Registered Professional Engineer and/or Land Surveyor	Fred B. Kery Jr.
Certificate No.	3950