



STATE OF NEW MEXICO  
ENERGY AND MINERALS DEPARTMENT  
OIL CONSERVATION DIVISION

BRUCE KING 2  
GOVERNOR

LARRY KEHOE  
SECRETARY

August 25, 1980

POST OFFICE BOX 2088  
STATE LAND OFFICE BUILDING  
SANTA FE, NEW MEXICO 87501  
(505) 827-2434

Supron Energy Corporation  
P. O. Box 808  
Farmington, New Mexico 87401

Attention: Mr. Kenneth E. Roddy

Administrative Order NSL-1231

Gentlemen:

Reference is made to your application for approval of a non-standard location for your Jicarilla "G" Well No. 4-E to be located 1800 feet from the North line and 630 feet from the West line of Section 11, Township 26 North, Range 5 West, NMPM, Basin-Dakota Gas Pool, Rio Arriba County, New Mexico.

By authority granted me under the provisions of Rule 3 of Order No. R-1670, the above-described unorthodox location is hereby approved.

Sincerely,

JOE D. RAMEY,  
Director

JDR/RLS/dr

cc: Oil Conservation Division - Aztec  
Oil & Gas Engineering Committee - Hobbs  
U. S. Geological Survey - Farmington



7-2  
7-11

OIL CONSERVATION COMMISSION  
      C. F.       DISTRICT

OIL CONSERVATION COMMISSION  
BOX 2088  
SANTA FE, NEW MEXICO

DATE July 2, 1980  
RE: Proposed MC \_\_\_\_\_  
Proposed DHC \_\_\_\_\_  
Proposed NSL   x   \_\_\_\_\_  
Proposed SWD \_\_\_\_\_  
Proposed WFX \_\_\_\_\_  
Proposed PMX \_\_\_\_\_

Gentlemen:

I have examined the application dated June 25, 1980  
for the San Juan Energy Corp. Mill G #4E E-11-26N-5W  
Operator Lease and Well No. Unit, S-T-R

and my recommendations are as follows:

Approved  
\_\_\_\_\_  
\_\_\_\_\_  
\_\_\_\_\_  
\_\_\_\_\_  
\_\_\_\_\_

Yours very truly,

Frank S. Chav

SUPRON ENERGY CORPORATION  
POST OFFICE BOX 808  
FARMINGTON, NEW MEXICO 87401

June 24, 1980

Energy and Minerals Department  
Oil Conservation Division  
P. O. Box 2088  
Santa Fe, New Mexico 87501

Attention: Mr. Joe D. Ramey

Gentlemen:

We request administrative approval to drill our Jicarilla "G" No. 4-E well on a non-standard location. We originally had the well staked in a standard location, but failed to get archeological clearance because some artifacts were found. Because of archeological and topographical reasons, we were unable to stake a standard location.

The proposed well is 1800 feet from the North line and 630 feet from the West line of Section 11, Township 26 North, Range 5 West, Rio Arriba County, New Mexico.

We have attached copies of letters to offset operators stating our intentions.

Also attached are copies of Form No. C-107 and copies of the topographical map of the area.

This well will be a Basin Dakota completion.

*Kenneth E. Roddy*  
Kenneth E. Roddy  
Production Superintendent

KER:ml  
Attachments

cc: Haskell Fleetwood  
Southland Royalty  
Oil Conservation Division, ✓  
Aztec, New Mexico



June 23, 1980

El Paso Exploration Company  
P.O. Box 289  
Farmington, New Mexico 87401

Gentlemen:

Supron Energy Corporation proposes to drill the Jicarilla "G" No. 4-E, a Basin Dakota well, located 1800 feet from the North line and 630 feet from the West line of Section 11, Township 26 North, Range 5 West, N.M.P.M., Rio Arriba County, New Mexico.

This location was re-staked in an unorthodox spot after the original location failed to pass the Archeological inspection. We were unable to find a conventional location that would pass the inspection.

Our records indicate that you are the owner and operator of acreage which adjoins this drilling block. If you have no objections to this proposed well, we would appreciate your signing the attached two (2) copies of this letter and returning same to this office.

Your prompt consideration of this will be greatly appreciated.

Kenneth E. Roddy  
Production Superintendent

KER:bjs

The above well is approved

BY: \_\_\_\_\_

TITLE: \_\_\_\_\_

DATE: \_\_\_\_\_



June 23, 1950

Southland Royalty Company  
P.O. Drawer 570  
Farmington, New Mexico 87401

Gentlemen:

Supron Energy Corporation proposes to drill the Jicarilla "G" No. 4-E, a Basin Dakota well, located 1800 feet from the North line and 630 feet from the West line of Section 11, Township 26 North, Range 5 West, N.M.P.M., Rio Arriba County, New Mexico.

This location was re-staked in an unorthodox spot after the original location failed to pass the Archeological inspection. We were unable to find a conventional location that would pass the inspection.

Our records indicate that you are the owner and operator of acreage which adjoins this drilling block. If you have no objections to this proposed well, we would appreciate your signing the attached two (2) copies of this letter and returning same to this office.

Your prompt consideration of this will be greatly appreciated.

SUPRON ENERGY CORPORATION

Original signed by  
Kenneth E. Roddy

Kenneth E. Roddy  
Production Superintendent

KER:cr

The above well is hereby approved.

BY: \_\_\_\_\_

TITLE: \_\_\_\_\_

DATE: \_\_\_\_\_

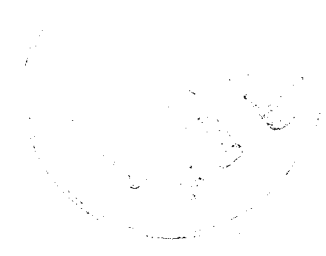

June 23, 1980

Exxon Company  
P.O. Box 1600  
Midland, Texas 79702

Gentlemen:

Supron Energy Corporation proposes to drill the Jicarilla "C" No. 4-B, a Basin Dakota well, located 1800 feet from the North line and 630 feet from the West line of Section 11, Township 20 North, Range 5 West, N.M.P.M., Rio Arriba County, New Mexico.

This location was re-staked in an unorthodox spot after the original location failed to pass the Archeological inspection. We were unable to find a conventional location that would pass the inspection.

Our records indicate that you are the owner and operator of acreage which adjoins this drilling block. If you have no objections to this proposed well, we would appreciate your signing the attached two (2) copies of this letter and returning same to this office.

Your prompt consideration of this will be greatly appreciated.

SUPRON ENERGY CORPORATION

Kenneth E. Roody  
Production Superintendent

KEK:cr

The above mentioned well is hereby approved.

BY: \_\_\_\_\_

TITLE: \_\_\_\_\_

DATE: \_\_\_\_\_

June 23, 1980

Conoco, Inc.  
P.O. Box 460  
Hobbs, New Mexico 88240

Gentlemen:

Supron Energy Corporation proposes to drill the Jicarilla "G" No. 4-E, a Basin Dakota well, located 1800 feet from the North line and 630 feet from the West line of Section 11, Township 26 North, Range 5 West, N.M.P.M., Rio Arriba County, New Mexico.

This location was re-staked in an unorthodox spot after the original location failed to pass the Archeological inspection. We were unable to find a conventional location that would pass the inspection.

Our records indicate that you are the owner and operator of acreage which adjoins this drilling block. If you have no objections to this proposed well, we would appreciate your signing the attached two (2) copies of this letter and returning same to this office.

Your prompt consideration of this will be greatly appreciated.

*[Handwritten signature]*  
Kenneth E. Roddy

Kenneth E. Roddy  
Production Superintendent

KER:bjs

The above well is approved

BY: \_\_\_\_\_

TITLE: \_\_\_\_\_

DATE: \_\_\_\_\_

June 23, 1980

Amoco Production Company  
501 Airport Drive  
Farmington, New Mexico 87401

Gentlemen:

Supron Energy Corporation proposes to drill the Jicarilla "C" No. 4-E, a Basin Dakota well, located 1800 feet from the North line and 630 feet from the West line of Section 11, Township 26 North, Range 5 West, N.M.P.M., Rio Arriba County, New Mexico.

This location was re-staked in an unorthodox spot after the original location failed to pass the Archeological inspection. We were unable to find a conventional location that would pass the inspection.

Our records indicate that you are the owner and operator of acreage which adjoins this drilling block. If you have no objections to this proposed well, we would appreciate your signing the attached two (2) copies of this letter and returning same to this office.

Your prompt consideration of this will be greatly appreciated.

Kenneth E. Roddy  
Production Superintendent

KER:bjs

The above well is approved

BY: \_\_\_\_\_

TITLE: \_\_\_\_\_

DATE: \_\_\_\_\_





June 23, 1980

Tenneco, Inc.  
720 S. Colorado Blvd.  
Denver, Colorado 80222

Gentlemen:

Supron Energy Corporation proposes to drill the Jicarilla "G" No. 4-E, a Basin Dakota well, located 1300 feet from the North line and 630 feet from the West line of Section 11, Township 26 North, Range 5 West, N.M.P.M., Rio Arriba County, New Mexico.

This location was re-staked in an unorthodox spot after the original location failed to pass the Archeological inspection. We were unable to find a conventional location that would pass the inspection.

Our records indicate that you are the owner and operator of acreage which adjoins this drilling block. If you have no objections to this proposed well, we would appreciate your signing the attached two (2) copies of this letter and returning same to this office.

Your prompt consideration of this will be greatly appreciated.

SUPRON ENERGY CORPORATION

Original Signed By  
Kenneth E. Roddy

Kenneth E. Roddy  
Production Superintendent

KER:er

This well is hereby approved.

BY: \_\_\_\_\_

TITLE: \_\_\_\_\_

DATE: \_\_\_\_\_

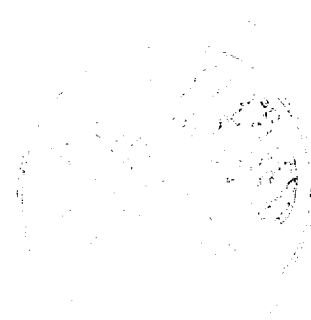

Supron Energy Corporation  
 Jicarilla G #4-E  
 NW $\frac{1}{4}$  Sec 11, T26N, R5W, N.M.P.M  
 Rio Arriba Co., New Mexico

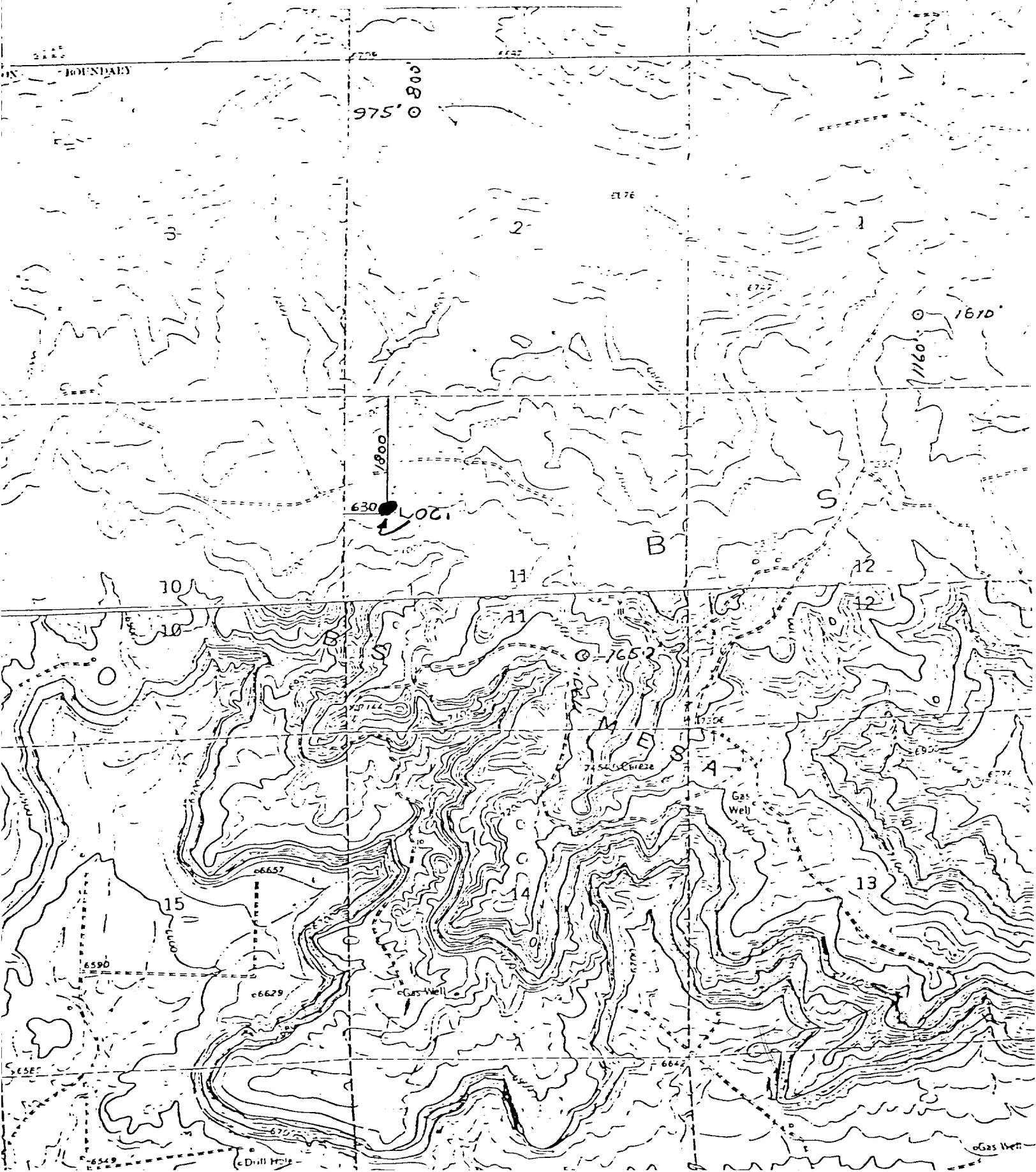

All distances must be from the outer boundaries of the Section.

Operator <b>SUPRON ENERGY CORPORATION</b>			Lease <b>JICARILLA G</b>		Well No. <b>#4-E</b>
Unit Letter <b>E</b>	Section <b>11</b>	Township <b>26 NORTH</b>	Range <b>5 WEST</b>	County <b>RIO ARriba</b>	
Actual Postage Location of Well:					
1800 feet from the		<b>NORTH</b>	line and	630 feet from the	<b>WEST</b> line
Ground Level Elev. <b>7256</b>	Producing Formation <b>DAKOTA</b>		Pool <b>BASIN</b>		Dedicated Acreage: <b>W/2 320</b> Acres

1. Outline the acreage dedicated to the subject well by colored pencil or hatch marks on the plat below.
2. If more than one lease is dedicated to the well, outline each and identify the ownership thereof (both as to working interest and royalty).
3. If more than one lease of different ownership is dedicated to the well, have the interests of all owners been consolidated by communitization, unitization, force-pooling, etc?

☐ Yes ☐ No If answer is "yes," type of consolidation \_\_\_\_\_

If answer is "no," list the owners and tract descriptions which have actually been consolidated. (Use reverse side of this form if necessary.) \_\_\_\_\_

No allowable will be assigned to the well until all interests have been consolidated (by communitization, unitization, forced-pooling, or otherwise) or until a non-standard unit, eliminating such interests, has been approved by the Division.

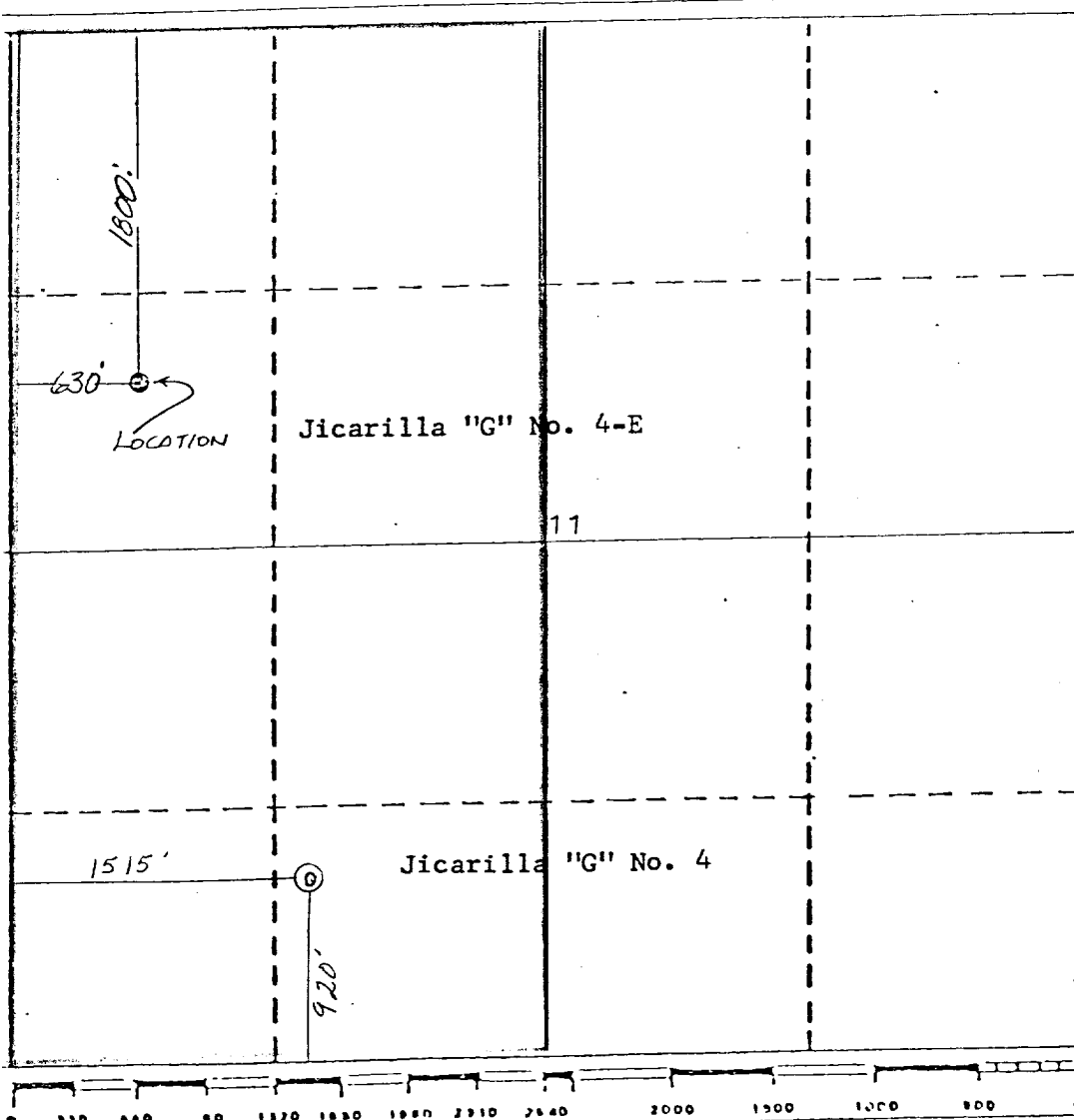

CERTIFICATION

I hereby certify that the information contained herein is true and complete to the best of my knowledge and belief.

*Kenneth E. Roddy*  
Name

Kenneth E. Roddy

Position

Production Superintendent

Company

SUPRON ENERGY CORPORATION

Date

June 23, 1980

I hereby certify that the location shown on this plat was plotted from field notes and actual surveys made by me or under my supervision and that the same is true and correct to the best of my knowledge and belief.

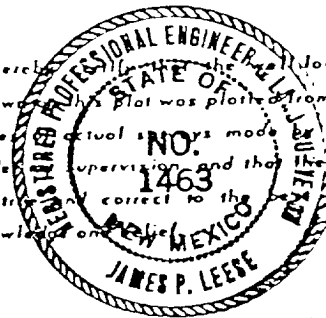

Date Surveyed

May 9, 1980

Registered Professional Engineer and/or Land Surveyor

*James P. Leese*  
James P. Leese

Certificate No.

1463

SUPRON ENERGY CORPORATION

WELL: JICARILLA "G" No. 4-E

LOCATION: 1800 feet from the North line and 630 feet from the West line of Section 11, Township 26 North, Range 5 West, N.M.P.M., Rio Arriba County, New Mexico.

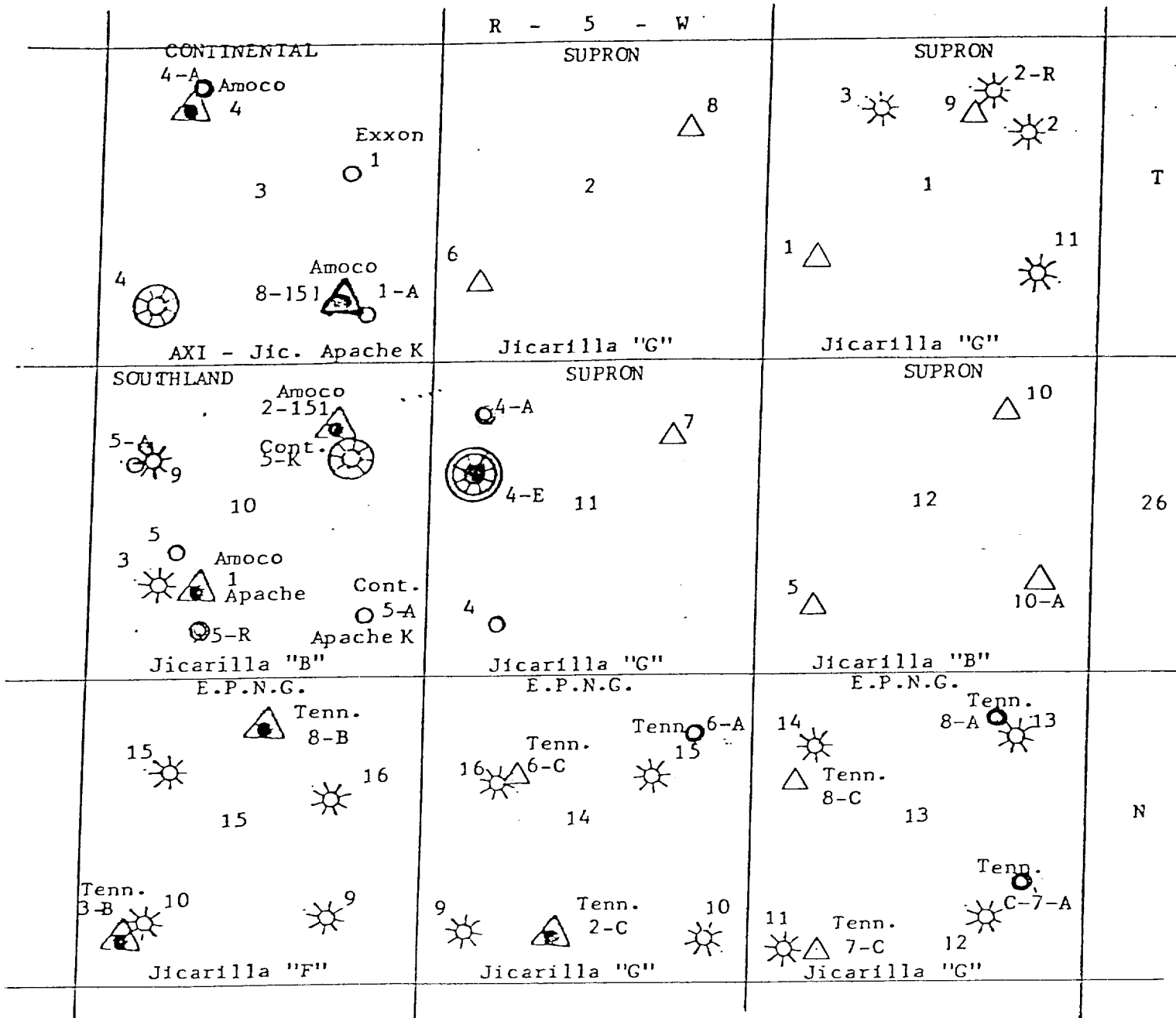

Proposed Dakota



Mesaverde



Pictured Cliffs



Dakota



Dakota - Mesaverde Dual

Pictured Cliffs - Mesaverde Dual



LOCATION AND EQUIPMENT LAYOUT

Supron Energy Corp.  
Quinnella "G" No. 1-E

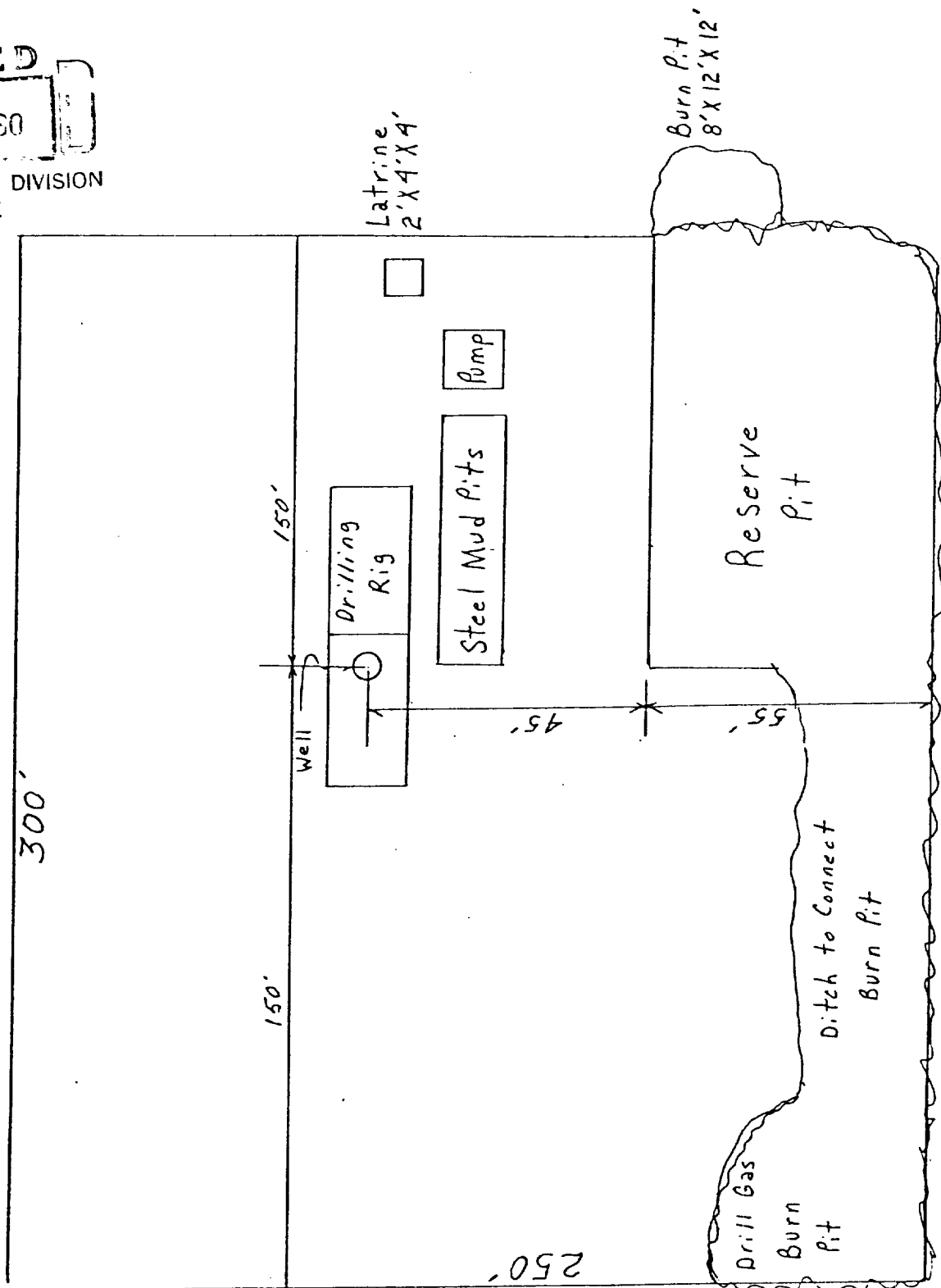
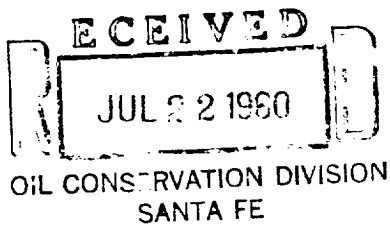

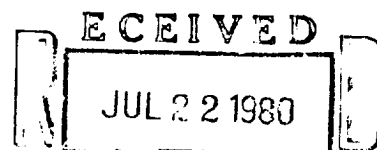

OIL CONSERVATION DIVISION

Proposed Well: SUPRON - JICARILLA G #4E

Land Status: Jicarilla Apache Tribe.

Location: The proposed location is in the Center  $\frac{1}{2}$  of the East  $\frac{1}{2}$  of the NW $\frac{1}{4}$  of the NW $\frac{1}{4}$  of Section 11, Township 26 North, Range 5 West, N.M.P.M., Rio Arriba County, New Mexico. The well will be 800 feet from the north line and 1120 feet from the west line of Section 26. (Figure 2)

U.T.M.: Center - 13; 2,91,070 mE; 40,42,460 mN.

Access: Existing - adjacent to Supron - Jicarilla G #4A.

Area Surveyed: 2.07 acres.

Terrain: Mesa with northerly drainage, alluvial surface deposits, and sandstone outcrops.

Soil: Sandy clayey loam.

Vegeation: Piñon, juniper, mountain mahogany, scrub oak, bitter-brush, serviceberry, narrowleaf yucca, broadleaf yucca, prickly pear, indian ricegrass.

Cultural Resources: Site SJC-588, a Gallina phase site, was found on the proposed well location. Due to topographic restrictions, it was not possible to avoid the site which is immediately east of an existing well location (Jicarilla G #4A) on a narrow bench on the north side of BS Mesa (also known as Honolulu Mesa).

Recommendations: Archaeological clearance is not recommended for the proposed well at this location. It was suggested that the proposed well be moved slightly west and be entirely contained on the large existing Jicarilla G #4A well location. The eastern edge of the existing well location is fifty to seventyfive feet west of the proposed well stake. It is therefore recommended that there be no new disturbance east of the existing Jicarilla G #4A well location.

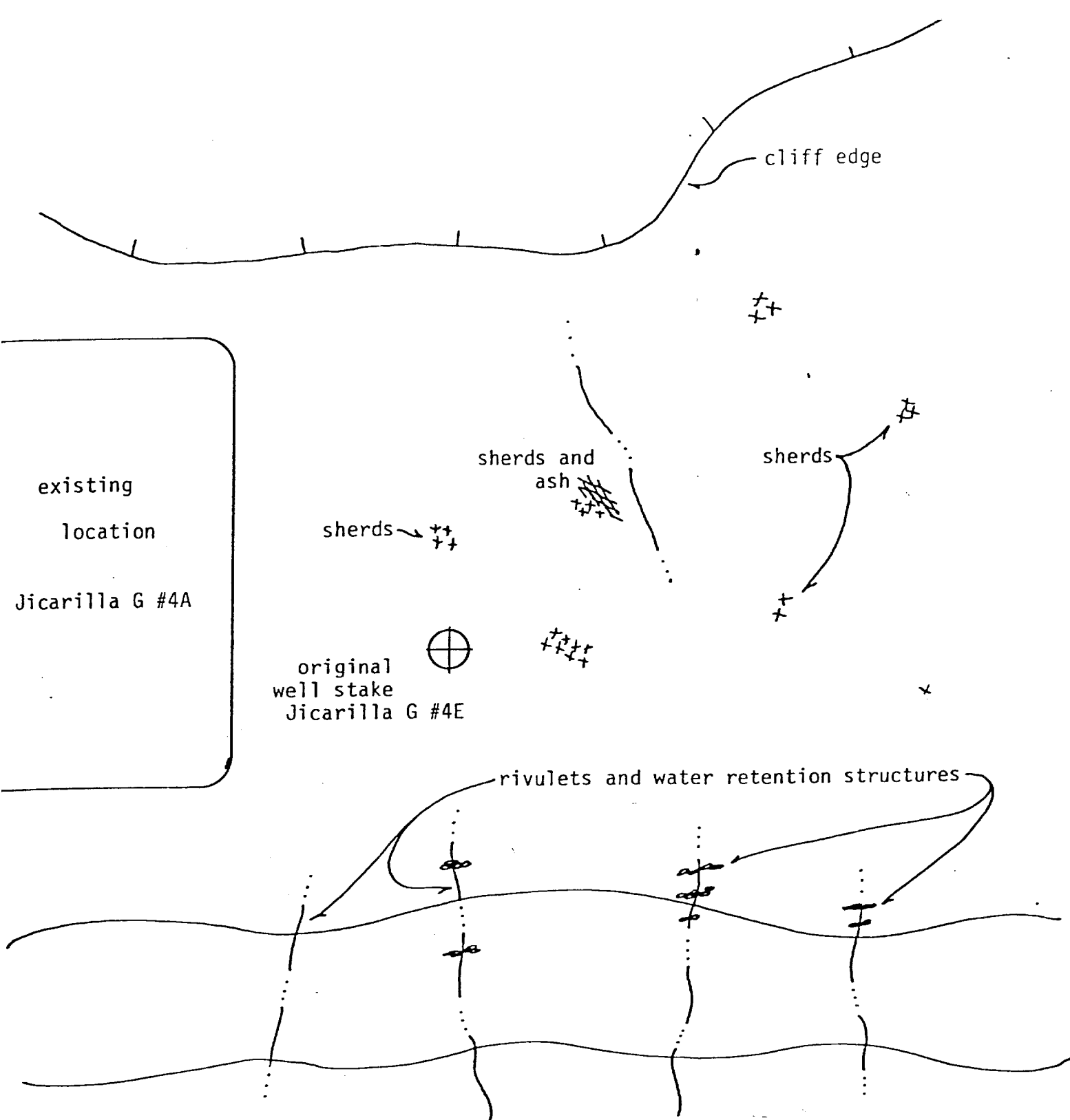

0 15  
meters

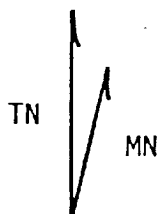

SJC 588  
C $\frac{1}{2}$ , E $\frac{1}{2}$ , NW $\frac{1}{4}$ , NW $\frac{1}{4}$   
Section 11  
T 26N, R 5W  
Rio Arriba County  
New Mexico

