

**NEW MEXICO OIL CONSERVATION COMMISSION
WELL LOCATION AND ACREAGE DEDICATION PLAT**

Form C-102
Supersedes C-128
Effective 1-1-65

All distances must be from the outer boundaries of the Section.

Operator Southland Royalty Company			Lease JICARILLA 101		Well No. #3E
Unit Letter E	Section 1	Township 26N	Range 4W	County Rio Arriba	
Actual Footage Location of Well: 1650 feet from the North line and 915 feet from the West line					
Ground Level Elev: 7062'	Producing Formation Gallup - Dakota		Pool Wildhorse - Basin Dakota		Dedicated Acreage: 160/320 Acres

1. Outline the acreage dedicated to the subject well by colored pencil or hachure marks on the plat below.
2. If more than one lease is dedicated to the well, outline each and identify the ownership thereof (both as to working interest and royalty).
3. If more than one lease of different ownership is dedicated to the well, have the interests of all owners been consolidated by communitization, unitization, force-pooling, etc?

☐ Yes ☐ No If answer is "yes," type of consolidation _____

If answer is "no," list the owners and tract descriptions which have actually been consolidated (Use reverse side of this form if necessary.) _____

No allowable will be assigned to the well until all interests have been consolidated (by communitization, unitization, forced-pooling, or otherwise) or until a non-standard unit, eliminating such interests, has been approved by the Commission.

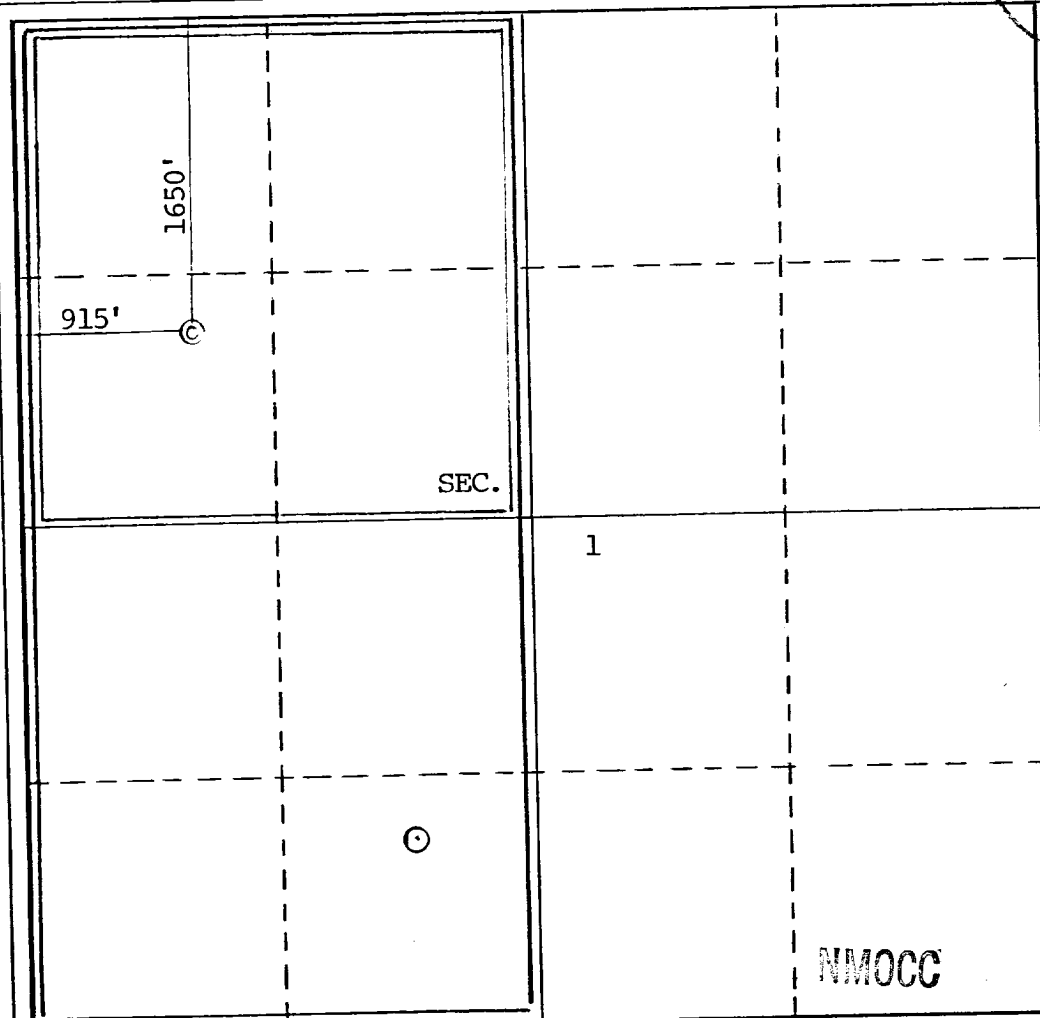
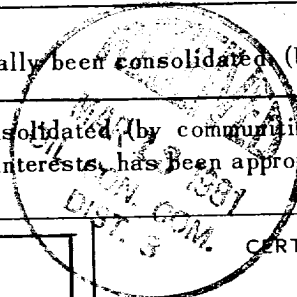

CERTIFICATION

I hereby certify that the information contained herein is true and complete to the best of my knowledge and belief.

R. E. Fielder

Name
Robert E. Fielder
Position
District Engineer
Company
Southland Royalty Company
Date
March 6, 1981

I hereby certify that the well location shown on this plat was plotted from field notes of actual surveys made by me or under my supervision, and that the same is true and correct to the best of my knowledge and belief.

Reissued August 17, 1980

Date Surveyed
June 12, 1978
Registered Professional Engineer and/or Land Surveyor
1981

Fred Kerr
Certificate No. **28**
3950

NMOCC