

UNITED STATES
DEPARTMENT OF THE INTERIOR
GEOLOGICAL SURVEY

APPLICATION FOR PERMIT TO DRILL, DEEPEN, OR PLUG BACK

1a. TYPE OF WORK DRILL <input checked="" type="checkbox"/> DEEPEN <input type="checkbox"/> PLUG BACK <input type="checkbox"/>		5. LEASE DESIGNATION AND SERIAL NO. NM-13807		
b. TYPE OF WELL OIL WELL <input checked="" type="checkbox"/> GAS WELL <input type="checkbox"/> OTHER <input type="checkbox"/> SINGLE ZONE <input type="checkbox"/> MULTIPLE ZONE <input type="checkbox"/>		6. IF INDIAN, ALLOTTEE OR TRIBE NAME -		
2. NAME OF OPERATOR Benson-Montin-Greer Drilling Corp.		7. UNIT AGREEMENT NAME Canada Ojitos Unit		
3. ADDRESS OF OPERATOR 221 Petroleum Center Building, Farmington, NM 87401		8. FARM OR LEASE NAME Canada Ojitos Unit		
4. LOCATION OF WELL (Report location clearly and in accordance with any State requirements.) At surface 1685' FNL, 1860' FWL, Sec. 20, T-26N, R-1W At proposed prod. zone same		9. WELL NO. 22 (F-20)		
14. DISTANCE IN MILES AND DIRECTION FROM NEAREST TOWN OR POST OFFICE* Approx. 9 miles northwest of Llaves, New Mexico		10. FIELD AND POOL, OR WILDCAT West Puerto Chiquito Mancos		
15. DISTANCE FROM PROPOSED* LOCATION TO NEAREST PROPERTY OR LEASE LINE, FT. (Also to nearest drlg. unit line, if any) -		11. SEC. T., R., M., OR BLK. AND SURVEY OR AREA Sec. 20, T-26N, R-1W		
16. NO. OF ACRES IN LEASE 2,080.80		12. COUNTY OR PARISH Rio Arriba		
17. NO. OF ACRES ASSIGNED TO THIS WELL 640.00		13. STATE New Mexico		
18. DISTANCE FROM PROPOSED LOCATION* TO NEAREST WELL, DRILLING, COMPLETED, OR APPLIED FOR, ON THIS LEASE, FT. -		19. PROPOSED DEPTH 8675'		
20. ROTARY OR CABLE TOOLS Rotary		21. APPROX. DATE WORK WILL START* as soon as approved		
21. ELEVATIONS (Show whether DF, RT, GR, etc.) 7724' GR		22. APPROX. DATE WORK WILL START* as soon as approved		
23. DRILLING OPERATIONS AUTHORIZED ARE SUBJECT TO COMPLIANCE WITH AN ATTACHED PROPOSED CASING AND CEMENTATION PROGRAM		This action is subject to administrative appeal pursuant to 30 CFR 290.		
SIZE OF HOLE	SIZE OF CASING	WEIGHT PER FOOT	SETTING DEPTH	QUANTITY OF CEMENT
15"	10-3/4"	40.5#	500'	250 sacks, circulated
9-7/8"	7-5/8"	26.40#	7325'	350 sacks
6-3/4"	5-1/2" (liner)	15.5#	7000-8675'	175 sacks

See Exhibit III attached - Schematic drawing of Blow-out Preventer Stack.



IN ABOVE SPACE DESCRIBE PROPOSED PROGRAM: If proposal is to deepen or plug back, give data on present productive zone and proposed new productive zone. If proposal is to drill or deepen directionally, give pertinent data on subsurface locations and measured and true vertical depths. Give blowout preventer program, if any.

24. SIGNED [Signature] TITLE Vice-President DATE June 17, 1981

(This space for Federal or State office use)

PERMIT NO. _____

APPROVAL DATE _____

APPROVED BY _____
CONDITIONS OF APPROVAL, IF ANY:

TITLE _____

APPROVED AS AMENDED DATE JUL 16 1981 JAMES F. SIMS DISTRICT ENGINEER

NMOC

All distances must be from the outer boundaries of the Section.

Operator BENSON-MONTIN-GREER DRILLING CORP.			Lease CANADA OJITOS UNIT		Well No. 22 (F-20)
Unit Letter F	Section 20	Township 26 NORTH	Range 1 WEST	County RIO ARriba	
Actual Footage Location of Well: 1685 feet from the NORTH line and 1860 feet from the WEST line					
Ground Level Elev. 7724	Producing Formation Niobrara		Pool West Puerto Chiquito Mancos	Dedicated Acreage: 640.00 Acres	

1. Outline the acreage dedicated to the subject well by colored pencil or hachure marks on the plat below.
See attachment for dedicated acreage.
2. If more than one lease is dedicated to the well, outline each and identify the ownership thereof (both as to working interest and royalty).
3. If more than one lease of different ownership is dedicated to the well, have the interests of all owners been consolidated by communitization, unitization, force-pooling, etc?

☐ Yes ☐ No If answer is "yes," type of consolidation _____

If answer is "no," list the owners and tract descriptions which have actually been consolidated. (Use reverse side of this form if necessary.) _____

No allowable will be assigned to the well until all interests have been consolidated (by communitization, unitization, forced-pooling, or otherwise) or until a non-standard unit, eliminating such interests, has been approved by the Division

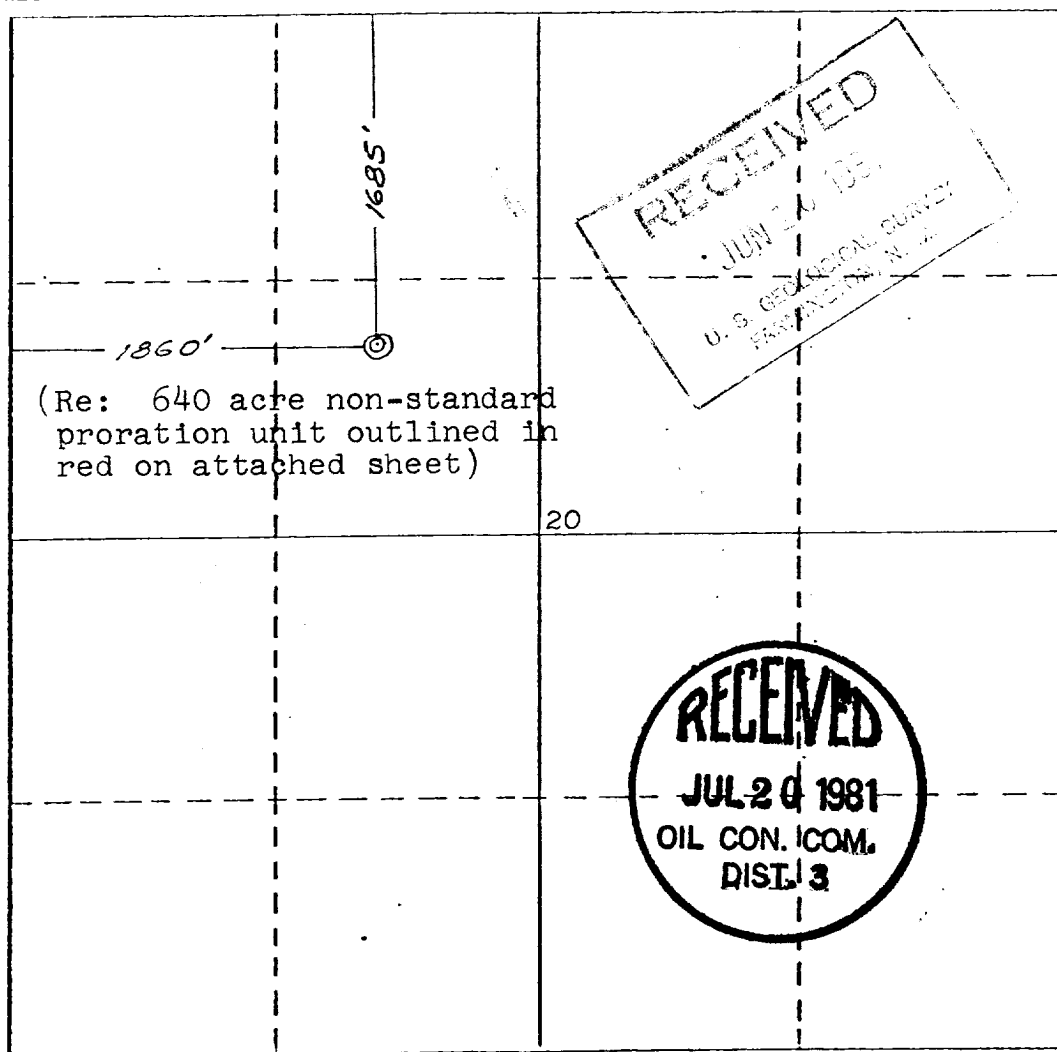

CERTIFICATION

I hereby certify that the information contained herein is true and complete to the best of my knowledge and belief.

Name
Virgil L. Stoabs
Position
Vice-President
Company
Benson-Montin-Greer Drilling Corp.
Date
June 16, 1981

REGISTERED PROFESSIONAL ENGINEER & LAND SURVEYOR
STATE OF NEW MEXICO
NO 1463
I hereby certify that the location shown on this plat was plotted from field notes of actual surveys made by me or under my supervision and to the best of my knowledge and belief.

Date Surveyed
May 21, 1981
Registered Professional Engineer and/or Land Surveyor
James P. Leese

Certificate No.
1463

0 330 660 990 1320 1650 1980 2310 2640 2970 3300 3630 3960 4290 4620 4950 5280 5610 5940 6270 6600

EXHIBIT B

Benson-Montin-Greer Drilling Corp.
Canada Ojitos Unit #22 (F-20)
SE/4 NW/4 Section 20, T-26N, R-1W
Rio Arriba County, New Mexico

R-1-W

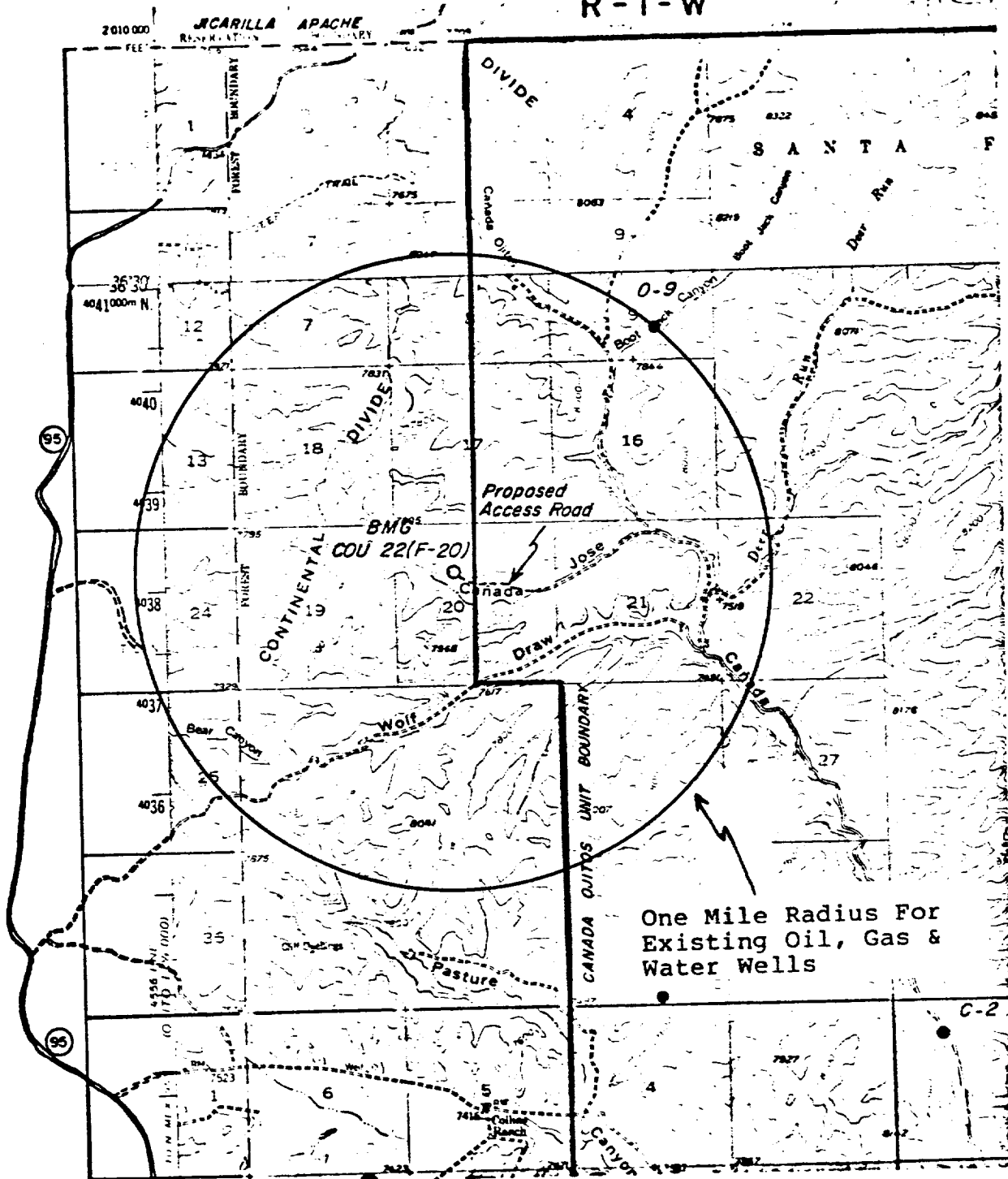

LEGEND:

- Producing oil well
- ⬢ Dry Hole
- Location

No water wells within radius of interest.