

NO. OF COPIES RECEIVED	
DISTRIBUTION	
SANTA FE	
FILE	
U.S.G.S.	
LAND OFFICE	
OPERATOR	

NEW MEXICO OIL CONSERVATION COMMISSION

30-039-22833

Form C-101  
Revised 1-1-65

5A. Indicate Type of Lease
STATE <input checked="" type="checkbox"/> FEE <input type="checkbox"/>
5. State Oil & Gas Lease No.
E-291-35

APPLICATION FOR PERMIT TO DRILL, DEEPEN, OR PLUG BACK

1a. Type of Work		7. Unit Agreement Name	
b. Type of Well DRILL <input checked="" type="checkbox"/> DEEPEN <input type="checkbox"/> PLUG BACK <input type="checkbox"/>		Rincon Unit	
OIL WELL <input type="checkbox"/> GAS WELL <input checked="" type="checkbox"/> OTHER <input type="checkbox"/> SINGLE ZONE <input type="checkbox"/> MULTIPLE ZONE <input type="checkbox"/>		8. Farm or Lease Name	
2. Name of Operator		Rincon Unit	
El Paso Natural Gas Company		9. Well No.	
3. Address of Operator		233	
P.O. Box 289, Farmington, New Mexico 87401		10. Field and Pool, or Wildcat	
4. Location of Well		Blanco	
UNIT LETTER <u>L</u> LOCATED <u>1450</u> FEET FROM THE <u>South</u> LINE		Largo Chacra Ext. & M.V.	
AND <u>940</u> FEET FROM THE <u>West</u> LINE OF SEC. <u>2</u> TWP. <u>26-N</u> RGE. <u>7-W</u> NMPM <u>1</u>			
		12. County	
		Rio Arriba	
		19. Proposed Depth	
		5445'	
		19A. Formation	
		Chacra & Mesa Verde	
		20. Rotary or C.T.	
		Rotary	
21. Elevations (Show whether DF, RT, etc.)		21A. Kind & Status Plug. Bond	
6509' GL		Statewide	
		21B. Drilling Contractor	
		22. Approx. Date Work will start	

23.

PROPOSED CASING AND CEMENT PROGRAM

SIZE OF HOLE	SIZE OF CASING	WEIGHT PER FOOT	SETTING DEPTH	SACKS OF CEMENT	EST. TOP
13 3/4"	9 5/8"	36#	200'	190 sks	surface
8 3/4"	7"	20#	4070'	426 sks	Ojo Alamo 202'
6 1/4"	4 1/2"	10.5#	3920-5445'	191 sks	Liner top

Selectively perforate & sand water fracture the chacra & Mesa Verde formations.

A 3000 psi WP and 6000 psi test double gate preventor equipped with blind and pipe rams will be used for blow out prevention on this well.

This gas is dedicated. W/2 of Sec. 2 is dedicated to this well.

The production of this well will be commingled in accordance to order # 2073.

APPROVAL VALID  
FOR 90 DAYS UNLESS  
DRILLING COMMENCED,  
EXPIRES 4-5-82

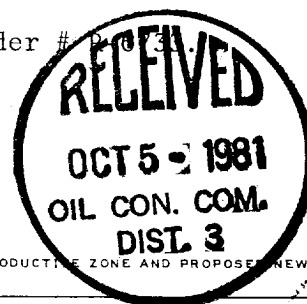

IN ABOVE SPACE DESCRIBE PROPOSED PROGRAM; IF PROPOSAL IS TO DEEPEN OR PLUG BACK, GIVE DATA ON PRESENT PRODUCTION ZONE AND PROPOSED NEW PRODUCTION ZONE. GIVE BLOWOUT PREVENTER PROGRAM, IF ANY.

I hereby certify that the information above is true and complete to the best of my knowledge and belief.

Signed A. G. Guico Title Drilling Clerk Date October 2, 1981

(This space for State Use)

APPROVED BY Original Signed by CHARLES GHOLSON TITLE DEPUTY OIL & GAS INSPECTOR, DIST. #3 DATE OCT 5 - 1981

CONDITIONS OF APPROVAL, IF ANY:

## OIL CONSERVATION DIVISION

STATE OF NEW MEXICO  
ENERGY AND MINERALS DEPARTMENTP. O. BOX 2088  
SANTA FE, NEW MEXICO 87501Form C-107  
Revised 10-1-77

All distances must be from the outer boundaries of the Section.

Operator <b>EL PASO NATURAL GAS COMPANY</b>			Lease <b>RINCON UNIT (E-291-35)</b>		Well No. <b>233</b>
Unit Letter <b>L</b>	Section <b>2</b>	Township <b>26N</b>	Range <b>7W</b>	County <b>Rio Arriba</b>	
Actual Footage Location of Well: <b>1450</b> feet from the <b>South</b> line and <b>940</b> feet from the <b>West</b> line					
Ground Level Elev. <b>6509</b>	Producing Formation <b>CHACRA - MESA VERDE</b>	Pool <b>LARGO CHACRA EXTENSION BLANCO MESA VERDE</b>	Dedicated Acreage: <b>160.00 &amp; 320.68 acres</b>		

1. Outline the acreage dedicated to the subject well by colored pencil or hachure marks on the plat below.
2. If more than one lease is dedicated to the well, outline each and identify the ownership thereof (both as to working interest and royalty).
3. If more than one lease of different ownership is dedicated to the well, have the interests of all owners been consolidated by communitization, unitization, force-pooling, etc?

☒ Yes ☐ No If answer is "yes," type of consolidation Unitization

If answer is "no," list the owners and tract descriptions which have actually been consolidated. (Use reverse side of this form if necessary.) \_\_\_\_\_

No allowable will be assigned to the well until all interests have been consolidated (by communitization, unitization, forced-pooling, or otherwise) or until a non-standard unit, eliminating such interests, has been approved by the Commission.

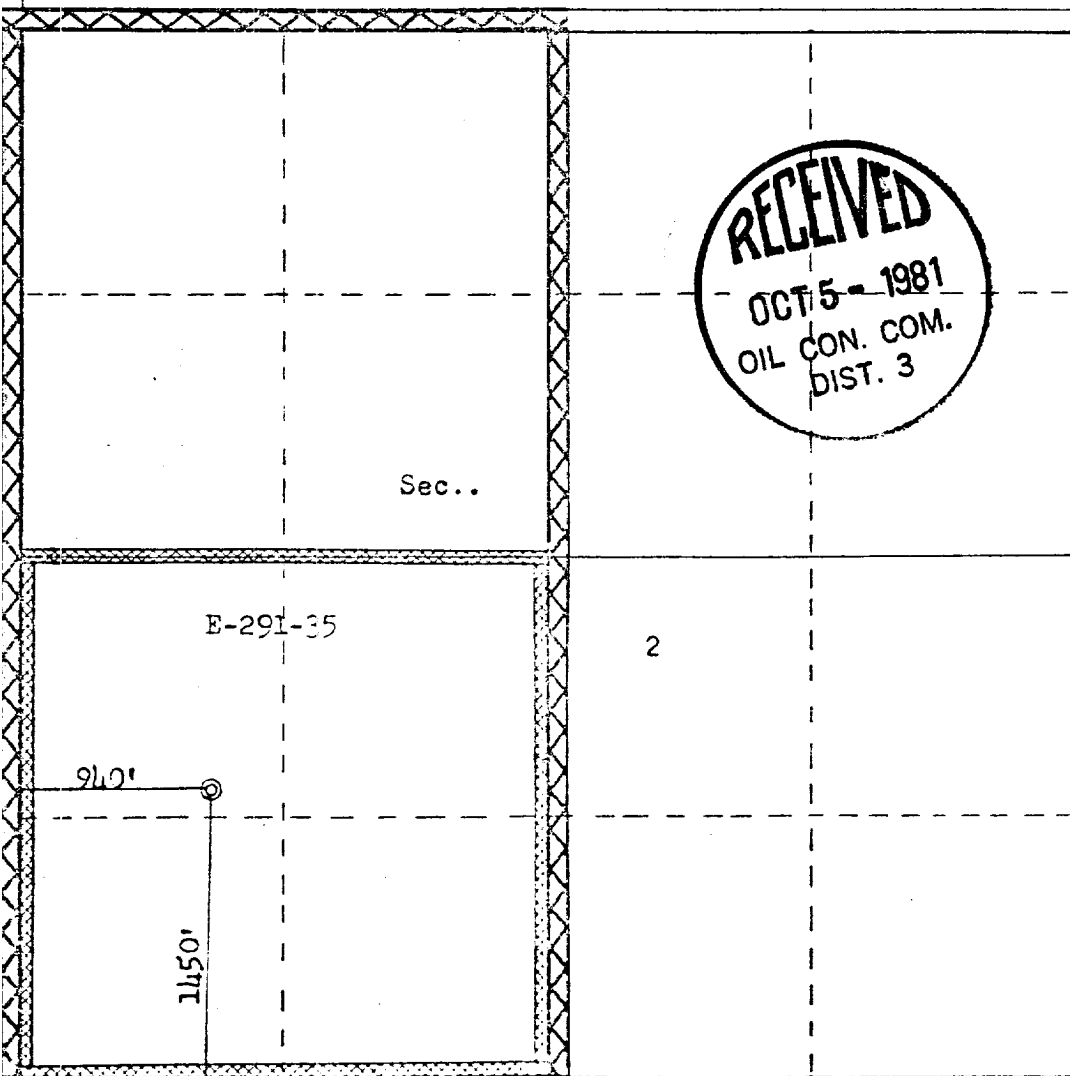

Scale: 1"=1000'

## CERTIFICATION

I hereby certify that the information contained herein is true and complete to the best of my knowledge and belief.

Name A. G. Brisco  
Position Drilling Clerk  
Company El Paso Natural Gas Company  
Date 10-5-81

I hereby certify that the well location shown on this plat was plotted from field notes of actual surveys made by me or under my supervision, and that the same is true and correct to the best of my knowledge and belief.

Date Surveyed August 25, 1981  
Registered Professional Engineer and Land Surveyor  
Fred E. Kent Jr.  
Certificate No. 3950