

UNITED STATES
DEPARTMENT OF THE INTERIOR
GEOLOGICAL SURVEY

SUNDRY NOTICES AND REPORTS ON WELLS

(Do not use this form for proposals to drill or to deepen or plug back to a different reservoir. Use Form 9-331-C for such proposals.)

1. oil ☐ gas ☒ other ☐

2. NAME OF OPERATOR

Tenneco Oil Company

3. ADDRESS OF OPERATOR

Box 3249, Englewood, CO 80155

4. LOCATION OF WELL (REPORT LOCATION CLEARLY. See space 17 below.)

AT SURFACE: 810' FNL, 1850' FWL

AT TOP PROD. INTERVAL:

AT TOTAL DEPTH:

16. CHECK APPROPRIATE BOX TO INDICATE NATURE OF NOTICE, REPORT, OR OTHER DATA

REQUEST FOR APPROVAL TO:

TEST WATER SHUT-OFF ☐
FRACTURE TREAT ☐
SHOOT OR ACIDIZE ☐
REPAIR WELL ☐
PULL OR ALTER CASING ☐
MULTIPLE COMPLETE ☐
CHANGE ZONES ☐
ABANDON* ☐

SUBSEQUENT REPORT OF:

☐
☐
☐
☐
☐
☐
☐
☐

(other) ☐

RECEIVED

JUL 23 1982

(NOTE: Report results of multiple completion or zone change on Form 9-330.)

U. S. GEOLOGICAL SURVEY
FARMINGTON, N. M.

17. DESCRIBE PROPOSED OR COMPLETED OPERATIONS (Clearly state all pertinent details, and give pertinent dates, including estimated date of starting any proposed work. If well is directionally drilled, give subsurface locations and measured and true vertical depths for all markers and zones pertinent to this work.)*

Tenneco proposes to convert the above captioned well into a dual completion by also completing the chakra zone in accordance with the attached detailed procedure.

Attached is a copy of the revised dedication plat.

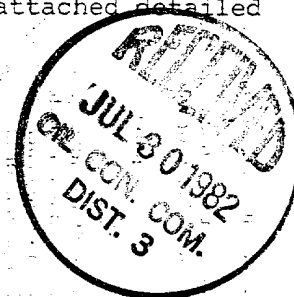

Subsurface Safety Valve: Manu. and Type _____ Set @ _____ Ft.

18. I hereby certify that the foregoing is true and correct

SIGNED Denise Wilson TITLE Production Analyst DATE July 20, 1982

(This space for Federal or State office use)

APPROVED BY _____ TITLE _____ DATE _____
CONDITIONS OF APPROVAL, IF ANY:

oh

*See Instructions on Reverse Side

NMOCC

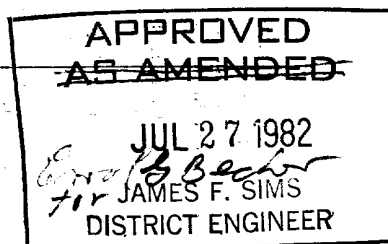

LEASE Jicarilla B

WELL NO. 7E

9-5/8 "OD, 36 LB, CSG. W/ 200 SX

TOC @ Surface

4 1/2 "OD, 11.6/10.5 LB, K-55 CSG. W/ 425/570 SX

TOC @ 500' (Survey)

DETAILED PROCEDURE: (Chacra Completion)

1. Tag PBTD and CO w/ foam before setting model "D".
Set model "D" pkr w/ expendable plug @ 4200. Dump
1 sx sd on pkr. Load hole w/ 2% KCl. PT to
2500 psi. RIH and spot 500 gal 7 1/2% HCl @ 4148'.
2. Perf Chacra w/ 3-1/8 csg gun 1 JSFF as follows:
4064-4074
4118-4127 Total: 32' - 32 holes
4135-4148
3. RIH w/ tbq & pkr. Acidize Chacra via tbq w/ 1000
15% weighted HCl and 48-1.1 S.G. balls.
4. RIH w/ pkr to knock balls off. *Blow dry. pook.*
5. Frac w/ 70 Q foamed 2% KCl @ 24bpm.

Foam Vol	Downhole sand ppg	Cum'l prop
17,000	PAD	
5,000	1# 20/40	5,000 <i>flush to in</i>
8,000	2# 20/40	21,000 <i>2 bbl of pr</i>
10,000	3# 20/40	51,000
20,000	4# 20/40	131,000

6. SI for 1-2 hours & turn to pit through 1/2" tapped
bull plug.
7. Kill well w/ 2% KCl.
8. RIH w/ mule shoe, 2-3/8 tbq, pump-thru plug, SN,
seal assy, and blast joints. Position seal assy
and blast jt. so mule shoe is @ 7450' & blast joint
are opposite Chacra perfs.
9. CO to mod. D w/ foam. Knock out plug and land
2-3/8 tbq.
10. NDBOP. NUWH. Pump out plug in 2-3/8. Swab in if
needed. FTCD Chacra up backside.
11. SI for AOF.

CHACRA

DV 4216'

DAKOTA

7638'

4064
4148

7356'
7541'

FC @ 7594'

OIL CONSERVATION DIVISION

P. O. BOX 2088

SANTA FE, NEW MEXICO 87501

Form C-107
Revised 10-1-78STATE OF NEW MEXICO
ENERGY AND MINERALS DEPARTMENT

All distances must be from the outer boundaries of the Section.

Operator TENNECO OIL COMPANY		Lease JICARILLA "B"		Well No. 7E
Unit Letter C	Section 16	Township 26N	Range 5W	County Rio Arriba
Actual Footage Location of Well:				
810 feet from the North line and		1850 feet from the West line		
Ground Level Elev. 6602	Producing Formation Dakota	Pool Basin Dakota / Und. Chaco	Dedicated Acreage 320/160 Acres	

1. Outline the acreage dedicated to the subject well by colored pencil or hachure marks on the plat below.
2. If more than one lease is dedicated to the well, outline each and identify the ownership thereof (both as to working interest and royalty).
3. If more than one lease of different ownership is dedicated to the well, have the interests of all owners been consolidated by communitization, unitization, force-pooling, etc?

☐ Yes ☐ No If answer is "yes," type of consolidation _____

If answer is "no," list the owners and tract descriptions which have actually been consolidated. (Use reverse side of this form if necessary.) _____

No allowable will be assigned to the well until all interests have been consolidated (by communitization, unitization, forced-pooling, or otherwise) or until a non-standard unit, eliminating such interests, has been approved by the Commission.

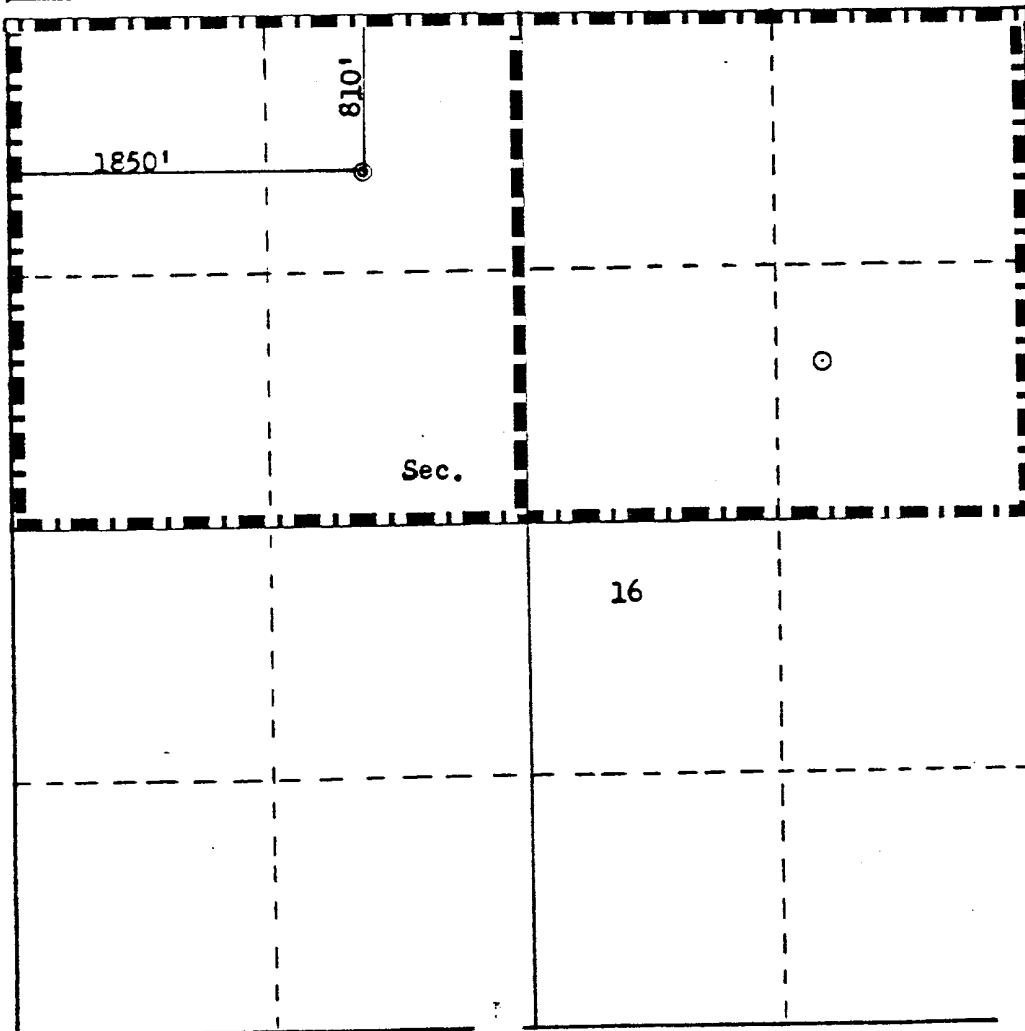

Scale: 1"=1000'

CERTIFICATION

I hereby certify that the information contained herein is true and complete to the best of my knowledge and belief.

Don H. Morrison

Name
Production Analyst

Position
Tenneco Oil Company

Company
10-13-81

Date

I hereby certify that the well location shown on this plat was plotted from field notes of actual surveys made by me or under my supervision, and that the same is true and correct to the best of my knowledge and belief.

Date Surveyed
October 1, 1981

Registered Professional Engineer
and Land Surveyor

Frank B. Kett Jr.

Certificate No.
3950