

Form C-107  
Revised 2-1-82

APPLICATION FOR MULTIPLE COMPLETION

|                               |      |             |                 |
|-------------------------------|------|-------------|-----------------|
| TENNECO OIL CO.               |      | Rio Arriba  | August 26, 1982 |
| Operator                      |      | County      | Date            |
| Box 3249, Englewood, CO 80155 |      | Jicarilla B | 7E              |
| Address                       |      | Lease       | Well No.        |
| C                             | 16   | 26N         | 5W              |
| Location of Well              | Unit | Section     | Township        |
|                               |      |             | Range           |

All Applicants for multiple completion must complete Items 1 and 2 below.

| 1. The following facts are submitted:  | Upper Zone    | Intermediate Zone | Lower Zone    |
|--|---------------|-------------------|---------------|
| a. Name of Pool and Formation  | Und. Chacra   |                   | Basin Dakota  |
| b. Top and Bottom of Pay Section (Perforations)  | 4064-4148' KB |                   | 7356-7541' KB |
| c. Type of production (Oil or Gas)   | Gas           |                   | Gas           |
| d. Method of Production (Flowing or Artificial Lift)   | Flowing       |                   | Flowing       |
| e. Daily Production<br><input type="checkbox"/> Actual<br><input checked="" type="checkbox"/> Estimated<br><u>Oil Bbls.</u><br><u>Gas MCF</u><br>Water Bbls. | 1040 mcfpd    |                   | 1207 mcfpd    |

2. The following must be attached:

- Diagrammatic Sketch of the Multiple Completion, showing all casing strings, including diameters and setting depths, centralizers and/or turbolizers and location thereof, quantities used and top of cement, perforated intervals, tubing strings, including diameters and setting depth, location and type of packers and side door chokes, and such other information as may be pertinent.
- Plat showing the location of all wells on applicant's lease, all offset wells on offset leases, and the names and addresses of operators of all leases offsetting applicant's lease.
- Electrical log of the well or other acceptable log with tops and bottoms of producing zones and intervals of perforation indicated thereon. (If such log is not available at the time application is filed it shall be submitted as provided by Rule 112-A.)

I hereby certify that the information above is true and complete to the best of my knowledge and belief.

Signed Daniel Wilson Title Production Analyst Date August 26, 1982

(This space for State Use)

Approved By Original Signed by FRANK T. CHAVEZ Title

SUPERVISOR DISTRICT #.3

Date SEP 2 1982

NOTE: If the proposed multiple completion will result in an unorthodox well location and/or a non-standard proration unit in one or more of the producing zones, then separate application for approval of the same should be filed simultaneously with this application.

WELL NO. 7E

TOC @ Surface

284' KB

TOC @ 500' KB

### DETAILED PROCEDURE

4,064' KB

Chacra

4,148' KB

PKR a -  
4247 KB

2 3/8" tubing  
@ 7350' KB

7356' KB

Dakota

7541' KB

7590' KB

PBTD

7640' KB

TD

## OIL CONSERVATION DIVISION

STATE OF NEW MEXICO  
ENERGY AND MINERALS DEPARTMENTP. O. BOX 2088  
SANTA FE, NEW MEXICO 87501Form C-107  
Revised 10-1-78

All distances must be from the outer boundaries of the Section.

|   |                                      |                               |  |                             |  |
|---|--------------------------------------|-------------------------------|--|-----------------------------|--|
| Operator<br><b>TENNECO OIL COMPANY</b>  |                                      | Lease<br><b>JICARILLA "B"</b> |  | Well No.<br><b>7E</b>       |  |
| Unit Letter<br><b>C</b>   | Section<br><b>16</b>                 | Township<br><b>26N</b>        | Range<br><b>5W</b>                       | County<br><b>Rio Arriba</b> |  |
| Actual Footage Location of Well:<br><b>810</b> feet from the <b>North</b> line and <b>1850</b> feet from the <b>West</b> line |                                      |                               |  |                             |  |
| Ground Level Elev.<br><b>6602</b>   | Producing Formation<br><b>Dakota</b> |                               | Pool<br><b>Basin Dakota / Und. Chaco</b> |                             | Dedicated Acreage:<br><b>320/160</b> Acres |

1. Outline the acreage dedicated to the subject well by colored pencil or hachure marks on the plat below.
2. If more than one lease is dedicated to the well, outline each and identify the ownership thereof (both as to working interest and royalty).
3. If more than one lease of different ownership is dedicated to the well, have the interests of all owners been consolidated by communitization, unitization, force-pooling, etc?

☐ Yes ☐ No If answer is "yes," type of consolidation \_\_\_\_\_

If answer is "no," list the owners and tract descriptions which have actually been consolidated. (Use reverse side of this form if necessary.) \_\_\_\_\_

No allowable will be assigned to the well until all interests have been consolidated (by communitization, unitization, forced-pooling, or otherwise) or until a non-standard unit, eliminating such interests, has been approved by the Commission.

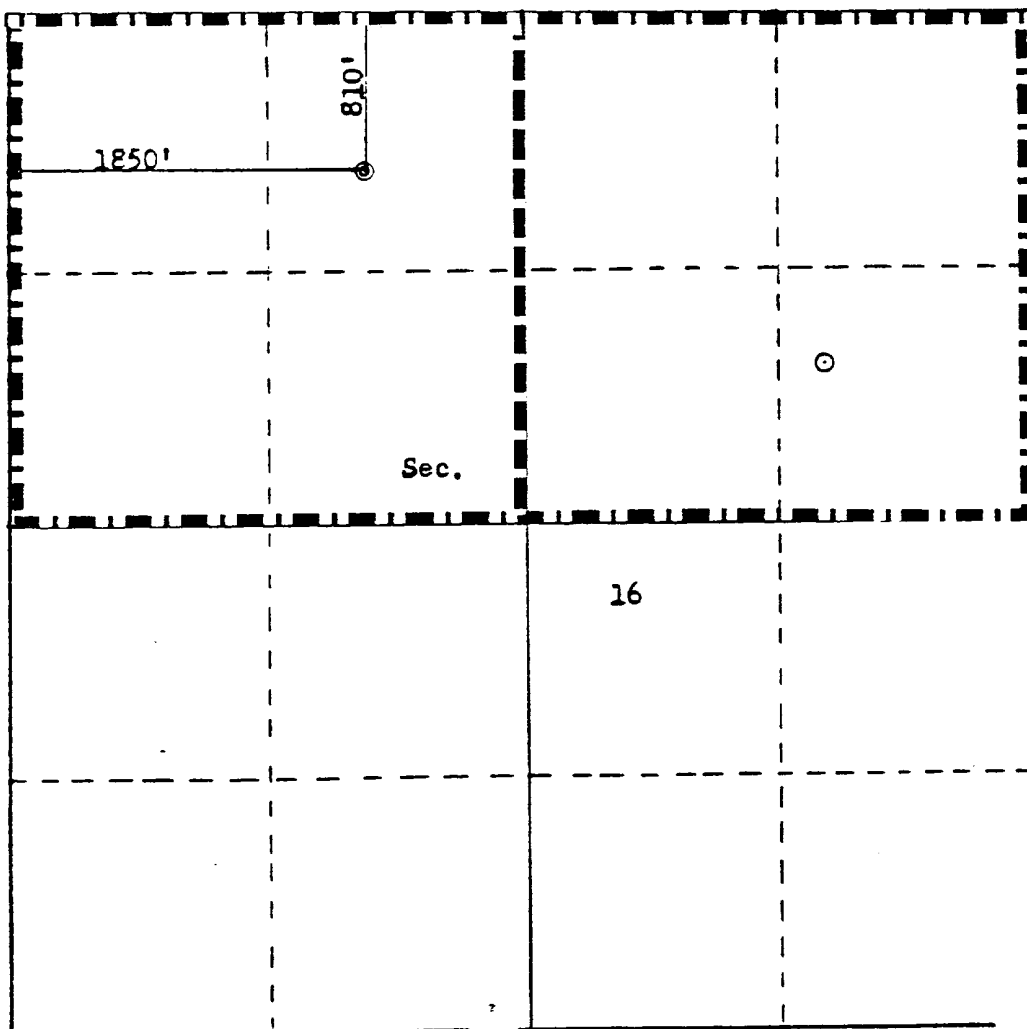

Scale: 1"=1000'

## CERTIFICATION

I hereby certify that the information contained herein is true and complete to the best of my knowledge and belief.

*Don H. Morrison*  
Name  
Production Analyst  
Position  
Tenneco Oil Company  
Company  
10-13-81  
Date

I hereby certify that the well location shown on this plat was plotted from field notes of actual surveys made by me or under my supervision, and that the same is true and correct to the best of my knowledge and belief.

Date Surveyed  
**October 14, 1981**  
Registered Professional Engineer  
and Land Surveyor  
*Fred B. Kert Jr.*  
Certificate No.  
**3958**

TENNECO  
 Jicarilla B 7E, T26N, R5W, Sec. 16  
 810' FNL, 1850' FWL, Rio Arriba County, New Mexico

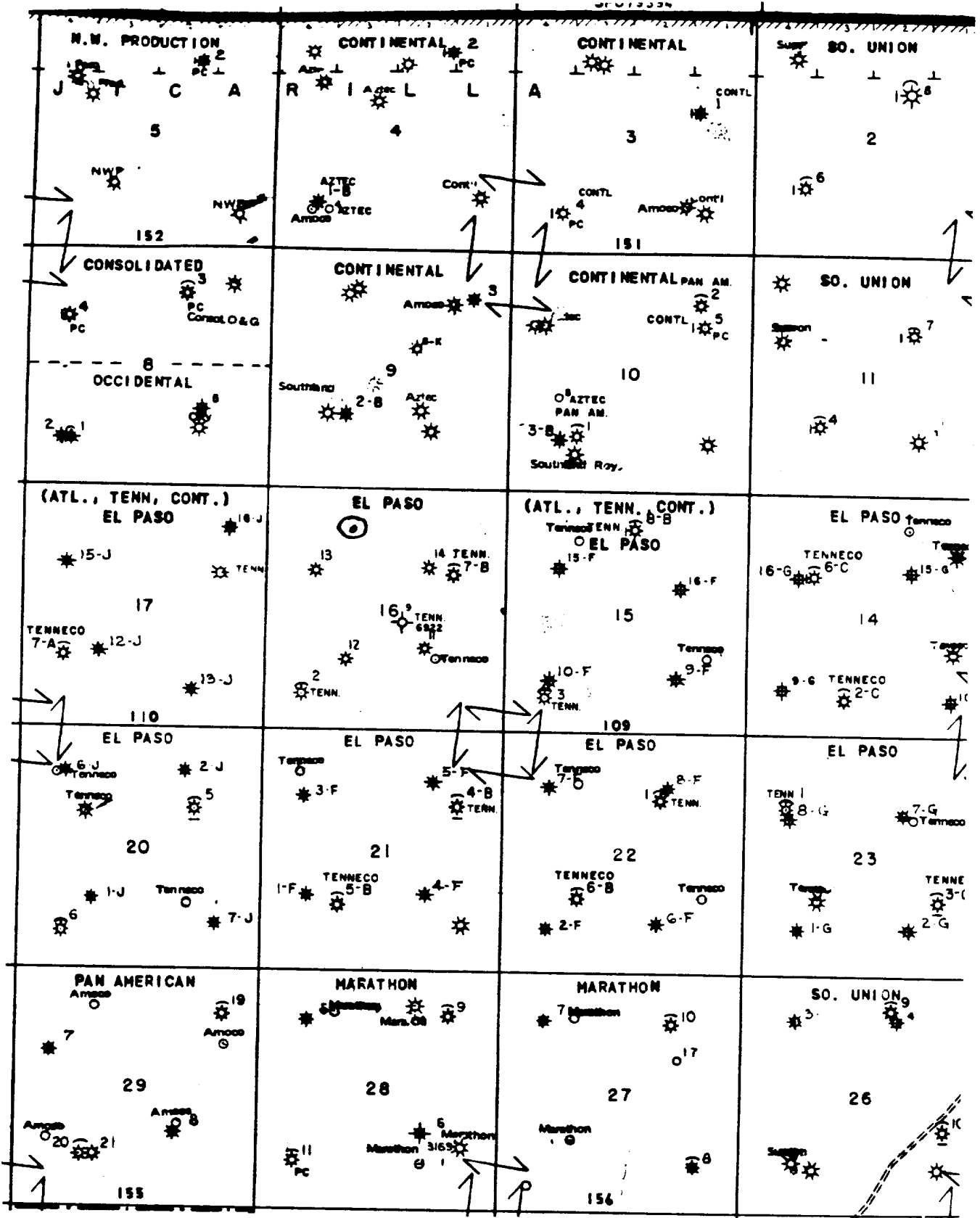

MAILING LIST OF OFFSET OPERATORS

APPLICATION FOR MULTIPLE COMPLETION

TENNECO JICARILLA B 7E, RIO ARRIBA COUNTY, NEW MEXICO

Southland Royalty Co.  
Bloomfield Highway  
Farmington, NM 87401

Amoco Production Co.  
501 Airport Road  
Farmington, NM 87401

Consolidated Oil & Gas, Inc.  
P. O. Box 2038  
Farmington, NM 87401

Conoco  
P. O. Box 460  
Hobbs, NM 88240