

District I
P.O. Box 1980, Hobbs, NM.

State of New Mexico
Energy, Minerals and Natural Resources Dept.

SUBMIT 1 COPY
TO APPROPRIATE
DISTRICT
OFFICE AND 1
COPY TO SANTA
FE OFFICE

District II
P.O. Drawer DD, Artesia, NM 88221

OIL CONSERVATION DIVISION
2040 S. Pacheco
Santa Fe, New Mexico 87504

District III
1000 Rio Brazos Rd, Aztec, NM 87410

PIT REMEDIATION AND CLOSURE REPORT

Operator: Caulkins Oil Company

Telephone: (505) 632-1544

Address: P.O. Box 340, Bloomfield, NM 87413

Facility or Well Name: Breach "E" 50-E

Location: Unit or Qtr/Qtr Sec D Sec 5 T 26N R 6W County Rio Arriba

Pit Type: Separator X Dehydrator Other

Land Type: BLM X , State____, Fee____, Other_____

Pit Location: Pit dimensions: length 20', width 20', depth 4'
(Attach diagram)

References: wellhead X , other _____

Footage from reference: 65'

Direction from reference: 265 Degrees _____ East North _____
of
X West South _____

Depth to Ground Water:
(Vertical distance from contaminants
to seasonal high water elevation of
ground water)

Less than 50 feet	(20 points)	
50 feet to 99 feet	(10 points)	
Greater than 100 feet	(0 points)	<u>0</u>

Wellhead Protection Area:
(Less than 200 feet from a private domestic water source, or; less than 1000 feet from all other water sources)

Yes (20 points) _____
No (0 points) 0

Distance to Surface Water:
(Horizontal distance to perennial
lakes, ponds, rivers, streams, creeks,
irrigation canals and ditches)

Less than 200 feet (20 points)
200 feet to 1000 feet (10 points)
Greater than 1000 feet (0 points) 0

RANKING SCORE (TOTAL POINTS): 0

ROBERT L. VERQUER, SUPERINTENDENT

CAULKINS OIL SITE SECURITY DIAGRAM

WELL NAME: Breach E 50-E

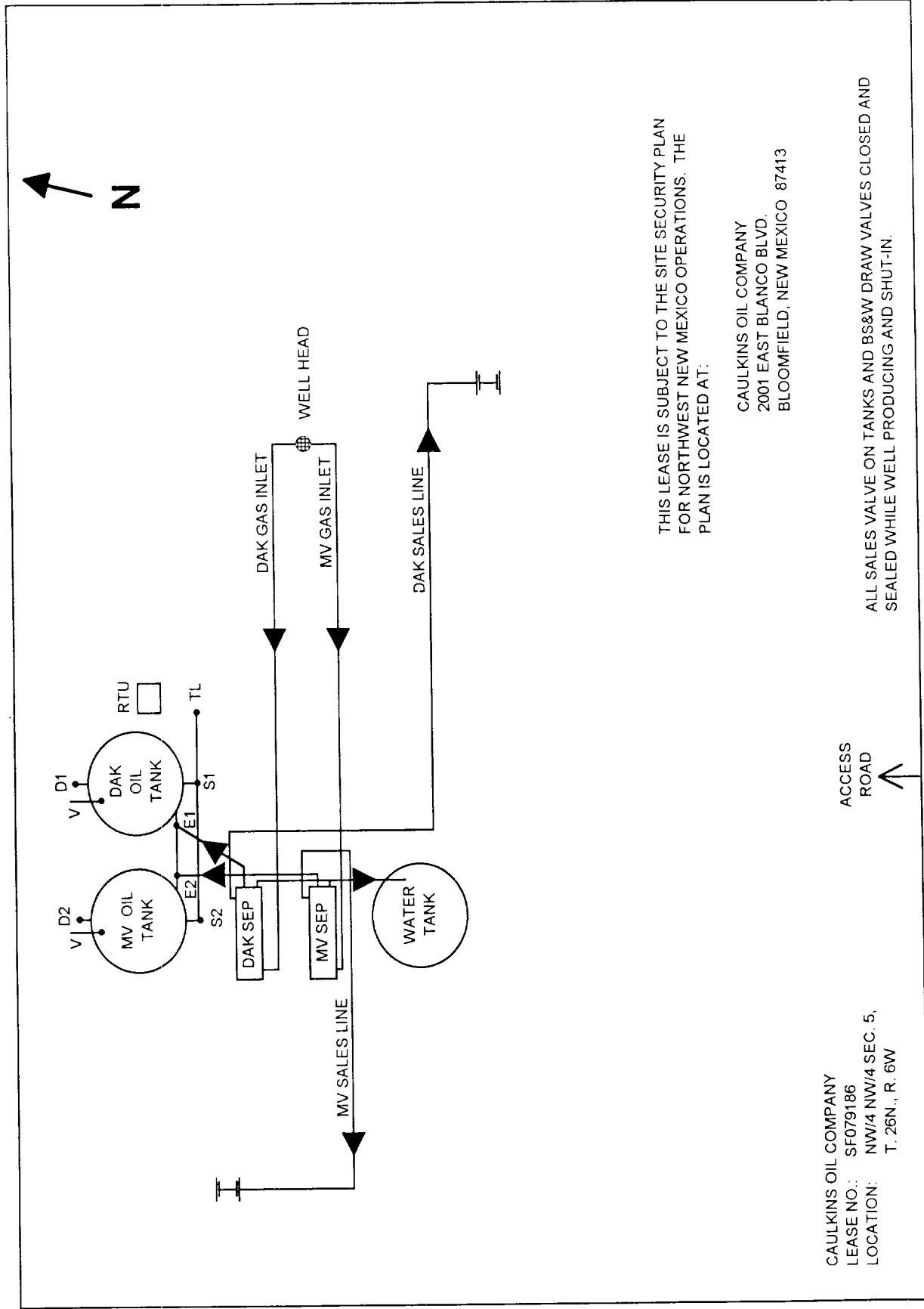

THIS LEASE IS SUBJECT TO THE SITE SECURITY PLAN
FOR NORTHWEST NEW MEXICO OPERATIONS. THE
PLAN IS LOCATED AT:

CAULKINS OIL COMPANY
2001 EAST BLANCO BLVD.
BLOOMFIELD, NEW MEXICO 87413

CAULKINS OIL COMPANY
LEASE NO.: SF079186
LOCATION: NW/4 NW/4 SEC. 5,
T. 26N., R. 6W

ACCESS
ROAD

ALL SALES VALVE ON TANKS AND BS&W DRAW VALVES CLOSED AND
SEALED WHILE WELL PRODUCING AND SHUT-IN.



TOTAL RECOVERABLE PETROLEUM HYDROCARBONS

Diesel Range Organics

Caulkins Oil Company

Project ID: NA
Sample Matrix: Soil
Preservative: Cool
Condition: Intact

Report Date: 07/08/96
Date Sampled: 06/25/96
Date Received: 06/26/96
Date Extracted: 07/03/96
Date Analyzed: 07/03/96

Sample ID	Lab ID	Concentration (mg/kg)	Detection Limit (mg/kg)
Breach E 50 E	4069	ND	18.8

ND- Analyte not detected at the stated detection limit.

Quality Control:	<u>Surrogate</u>	<u>% Recovery</u>	<u>Acceptance Limits</u>
	o - Terphenyl	93%	50 - 150%

Reference: EPA Method 8015A, modified. "Nonhalogenated Volatile Organics by Gas Chromatography." Test Methods for Evaluating Solid Waste, Physical/Chemical Methods, SW-846, 3rd Ed, Final Update I, July, 1992. USEPA.

Comments:

Analyst

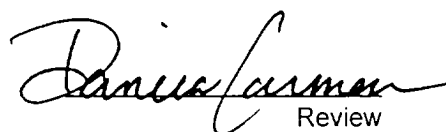
Review



TOTAL VOLATILE PETROLEUM HYDROCARBONS
Gasoline Range Organics

Caulkins Oil Co.

Project ID: NA
Sample Matrix: Soil
Preservative: Cool
Condition: Intact

Report Date: 07/08/96
Date Sampled: 06/25/96
Date Received: 06/26/96
Date Extracted: 07/01/96
Date Analyzed: 07/01/96

Sample ID	Lab ID	Concentration (mg/kg)	Detection Limit (mg/kg)
Breach E 50 E	4069	ND	18.8

ND- Analyte not detected at the stated detection limit.

Quality Control:	<u>Surrogate</u>	<u>% Recovery</u>	<u>Acceptance Limits</u>
	Trifluorotoluene	88%	50 - 150%

Reference: Method for the Determination of Gasoline Range Organics,
State of Tennessee, Department of Environment and Conservation, Division
of Underground Storage Tanks.

Comments:

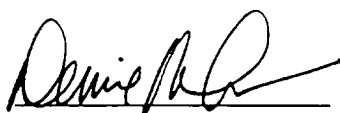
Analyst

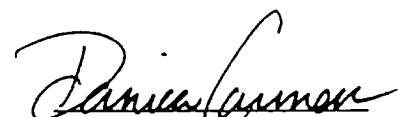
Review