

FIELD PIT SITE ASSESSMENT FORM

GENERAL	<p>Meter: <u>94-345</u> Location: <u>Canyon Largo Unit 313</u> Operator #: <u>5997</u> Operator Name: <u>met rign oil & gas</u>, P/L District: <u>Ballard</u> Coordinates: Letter: <u>A</u> Section <u>28</u> Township: <u>25</u> Range: <u>6</u> Or Latitude _____ Longitude _____ Pit Type: Dehydrator _____ Location Drip: <u>X</u> Line Drip: _____ Other: _____ Site Assessment Date: <u>07/07/94</u> Area: <u>07</u> Run: <u>72</u></p>
SITE ASSESSMENT	<p>NMOCD Zone: (From NMOCD Maps) Inside <input checked="" type="checkbox"/> (1) Outside <input type="checkbox"/> (2)</p> <p>Land Type: BLM <input checked="" type="checkbox"/> (1) State <input type="checkbox"/> (2) Fee <input type="checkbox"/> (3) Indian <input type="checkbox"/> (3) <u>Denny G. Faust</u> DEPUTY OIL & GAS INSPECTOR</p> <p>Depth to Groundwater Less Than 50 Feet (20 points) <input checked="" type="checkbox"/> (1) 50 Ft to 99 Ft (10 points) <input type="checkbox"/> (2) Greater Than 100 Ft (0 points) <input type="checkbox"/> (3)</p> <p>Wellhead Protection Area : Is it less than 1000 ft from wells, springs, or other sources of fresh water extraction? , or ; Is it less than 200 ft from a private domestic water source? <input type="checkbox"/> (1) YES (20 points) <input checked="" type="checkbox"/> (2) NO (0 points)</p> <p>Horizontal Distance to Surface Water Body Less Than 200 Ft (20 points) <input checked="" type="checkbox"/> (1) 200 Ft to 1000 Ft (10 points) <input type="checkbox"/> (2) Greater Than 1000 Ft (0 points) <input type="checkbox"/> (3)</p> <p>Name of Surface Water Body <u>Largo Wash</u> (Surface Water Body : Perennial Rivers, Major Wash, Streams, Creeks, Irrigation Canals, Ditches, Lakes, Ponds) Distance to Nearest Ephemeral Stream <input type="checkbox"/> (1) < 100' (Navajo Pits Only) <input type="checkbox"/> (2) > 100'</p> <p>TOTAL HAZARD RANKING SCORE: <u>40</u> POINTS</p>
REMARKS	<p>Remarks : <u>Redline Book - Inside</u> <u>Vulnerable Zone - Inside</u> <u>Three pits on site, location drip pit is dry, will close one pit.</u></p> <p style="text-align: right;"><u>DIG & HAUL</u></p>

SEP 10 1996

RECEIVED
 APR - 4 1996

OIL CON. DIV
 DIST. 2

ORIGINAL PIT LOCATION

ORIGINAL PIT LOCATION

Original Pit : a) Degrees from North 161° Footage from Wellhead 126'
b) Length : 25' Width : 25' Depth : 3'

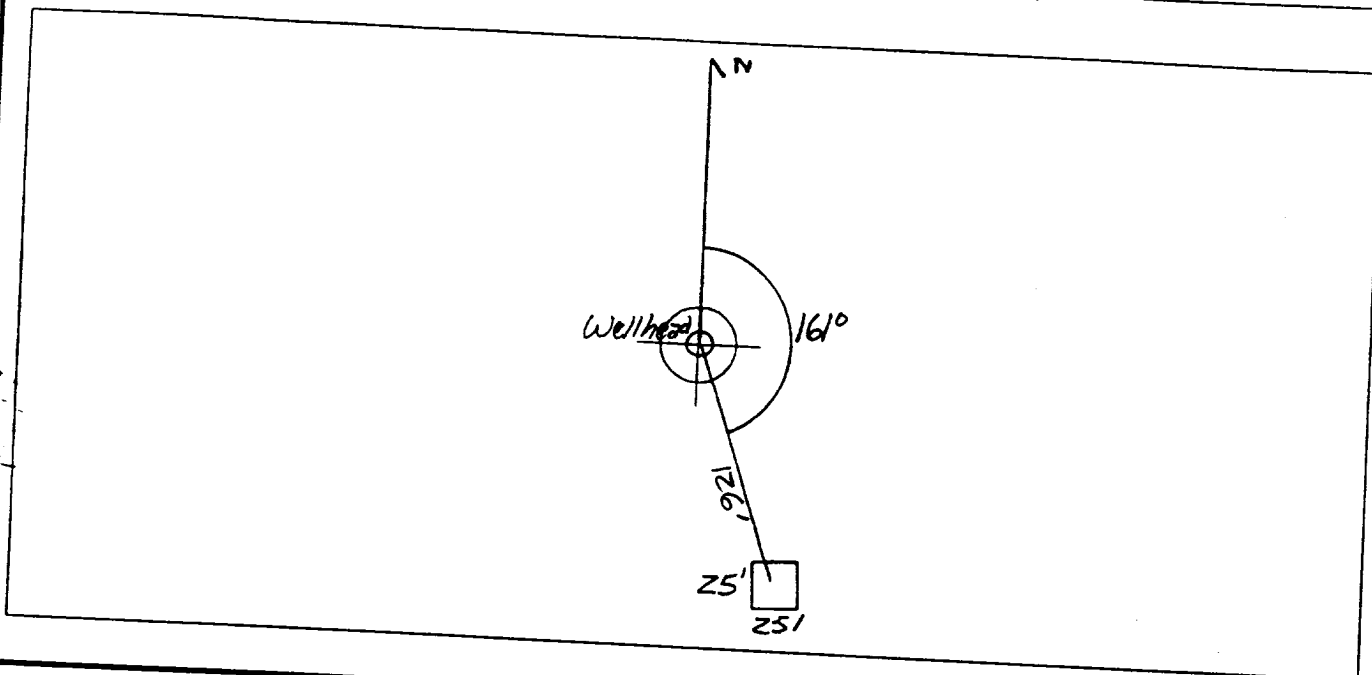

REMARKS

Remarks :

Pictures @ 14:35 (5-8, Roll 13)
Dump Truck.

Completed By:

Amber Kelly

Signature

7/7/94

Date

FIELD PIT REMEDIATION/CLOSURE FORM

GENERAL	Meter: <u>94345</u> Location: <u>Canyon Largo Unit 313</u> Coordinates: Letter: <u>A</u> Section <u>28</u> Township: <u>25</u> Range: <u>6</u> Or Latitude _____ Longitude _____ Date Started : <u>8/30/94</u> Run: <u>07</u> <u>72</u>
FIELD OBSERVATIONS	Sample Number(s): <u>KD 245</u> Sample Depth: <u>7'</u> Feet Final PID Reading <u>1 ppm</u> PID Reading Depth <u>7'</u> Feet <div style="text-align: center;">Yes No</div> Groundwater Encountered <input type="checkbox"/> <input checked="" type="checkbox"/> Approximate Depth _____ Feet
CLOSURE	Remediation Method : <div style="display: flex; justify-content: space-between;"> <div> Excavation Onsite Bioremediation Backfill Pit Without Excavation </div> <div style="text-align: right;"> <input checked="" type="checkbox"/> Approx. Cubic Yards <u>70</u> <input type="checkbox"/> <input type="checkbox"/> </div> </div> Soil Disposition: <div style="display: flex; justify-content: space-between;"> <div> Envirotech <input checked="" type="checkbox"/> Other Facility <input type="checkbox"/> </div> <div> <input type="checkbox"/> Tierra Name: _____ </div> </div> Pit Closure Date: <u>8/30/94</u> Pit Closed By: <u>BEI</u>
REMARKS	Remarks : <u>Excavated pit to 7', Contamination Cleared up, Took</u> <u>PID Sample, Closed pit.</u>
	Signature of Specialist: <u>[Signature]</u>



FIELD SERVICES LABORATORY

ANALYTICAL REPORT

PIT CLOSURE PROJECT - Soil Samples Inside the GWV Zone

SAMPLE IDENTIFICATION

	Field ID	Lab ID
SAMPLE NUMBER:	KD 245	946033
MTR CODE SITE NAME:	94345	N/A
SAMPLE DATE TIME (Hrs):	8-30-94	1225
SAMPLED BY:	N/A	
DATE OF TPH EXT. ANAL.:	9-1-94	9/1/94
DATE OF BTEX EXT. ANAL.:	9/1/94	9/1/94
TYPE DESCRIPTION:	VC	Brown fine sand

REMARKS:

RESULTS

PARAMETER	RESULT	UNITS	QUALIFIERS			
			DF	Q	M(g)	V(ml)
BENZENE	<0.025	MG/KG	1			
TOLUENE	<0.025	MG/KG	1			
ETHYL BENZENE	<0.025	MG/KG	1			
TOTAL XYLENES	<0.025	MG/KG	1			
TOTAL BTEX	<0.10	MG/KG				
TPH (418.1)	14.2 14.2	MG/KG			2.03	28
HEADSPACE PID	1	PPM				
PERCENT SOLIDS	80.1	%				

-- TPH is by EPA Method 418.1 and BTEX is by EPA Method 8020 --

The Surrogate Recovery was at 94 % for this sample All QA/QC was acceptable.

Narrative:

ATZ results attached.

DF = Dilution Factor Used

Approved By:

Date:

9/30/94



2709-D Pan American Freeway, NE Albuquerque, NM 87107
Phone (505) 344-3777 FAX (505) 344-4413

September 15, 1994

El Paso Natural Gas Co.
P.O. Box 4990
Farmington, NM 87499

Project Name/Number: PIT CLOSURE 24324

Attention: John Lambdin

On 09/01/94, Analytical Technologies, Inc., (ADHS License No. AZ0015), received a request to analyze **non-aqueous** samples. The samples were analyzed with EPA methodology or equivalent methods. The results of these analyses and the quality control data, which follow each set of analyses, are enclosed.

If you have any questions or comments, please do not hesitate to contact us at (505) 344-3777.

İttilah Kalkışın

Letitia Krakowski, Ph.D.
Project Manager

Al Mitchell

H. Mitchell Rubenstein, Ph.D.
Laboratory Manager

MR:jt

Enclosure

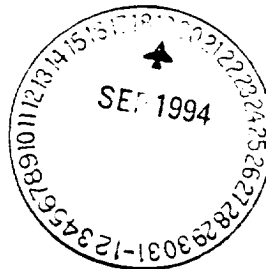

GAS CHROMATOGRAPHY RESULTS

TEST : BTEX (EPA 8020)
 CLIENT : EL PASO NATURAL GAS CO. ATI I.D.: 409308
 PROJECT # : 24324
 PROJECT NAME : PIT CLOSURE

SAMPLE ID. #	CLIENT I.D.	MATRIX	DATE SAMPLED	DATE EXTRACTED	DATE ANALYZED	DIL. FACTOR
01	946033	NON-AQ	08/30/94	09/11/94	09/11/94	1
02	946034	NON-AQ	08/30/94	09/11/94	09/11/94	20
03	946035	NON-AQ	08/30/94	09/11/94	09/11/94	1

PARAMETER	UNITS	01	02	03
BENZENE	MG/KG	<0.025	<0.5	<0.025
TOLUENE	MG/KG	<0.025	23	1.5
ETHYLBENZENE	MG/KG	<0.025	12	0.8
TOTAL XYLENES	MG/KG	<0.025	75	5.6

SURROGATE:

BROMOFLUOROBENZENE (%)	94	95	48*
------------------------	----	----	-----

*OUTSIDE ATI QUALITY CONTROL LIMITS DUE TO MATRIX INTERFERENCE