

UNITED STATES  
DEPARTMENT OF THE INTERIOR  
GEOLOGICAL SURVEY

## APPLICATION FOR PERMIT TO DRILL, DEEPEN, OR PLUG BACK

1a. TYPE OF WORK

DRILL ☒DEEPEN ☐PLUG BACK ☐

b. TYPE OF WELL

OIL  
WELL ☐GAS  
WELL ☒

OTHER

SINGLE  
ZONE ☐MULTIPLE  
ZONE ☒

2. NAME OF OPERATOR

Supron Energy Corporation

3. ADDRESS OF OPERATOR

P.O. Box 808, Farmington, New Mexico 87401

4. LOCATION OF WELL (Report location clearly and in accordance with any State requirements.)

At surface

790 ft./S; 1120 ft./W line

At proposed prod. zone Same as above

14. DISTANCE IN MILES AND DIRECTION FROM NEAREST TOWN OR POST OFFICE\*

30 miles northwest of Ojito, New Mexico

15. DISTANCE FROM PROPOSED\*

LOCATION TO NEAREST

PROPERTY OR LEASE LINE, FT.

(Also to nearest drlg. unit line, if any)

4160 ft.

4160 ft.

18. DISTANCE FROM PROPOSED LOCATION\*

TO NEAREST WELL, DRILLING, COMPLETED,  
OR APPLIED FOR, ON THIS LEASE, FT.

235 ft.

16. NO. OF ACRES IN LEASE

2560

19. PROPOSED DEPTH

7607

17. NO. OF ACRES ASSIGNED  
TO THIS WELL

320 (West half)

20. ROTARY OR CABLE TOOLS

Rotary

21. ELEVATIONS (Show whether DF, RT, GR, etc.)

6664 Gr.

22. APPROX. DATE WORK WILL START\*

June 15, 1982

23. PROPOSED CASING AND CEMENTING PROGRAM

| SIZE OF HOLE | SIZE OF CASING | WEIGHT PER FOOT | SETTING DEPTH | QUANTITY OF CEMENT               |
|--------------|----------------|-----------------|---------------|----------------------------------|
| 12 1/4"      | 8 5/8"         | 24.00           | 250           | 200 sacks (Circulate to surface) |
| 7 7/8"       | 5 1/2"         | 15.50           | 7607          | 1100 sacks.                      |

We propose to drill a 12 1/4" hole with natural mud to total depth of about 250 ft. and run 8 5/8", 24.00# casing. We will use enough cement to circulate to the surface. We will drill a 7 7/8" hole with mud to total depth of 7607 ft. R.K.B. 5 1/2", 15.50#, K-55 casing will be run to total depth with stage collars set at about 5950 ft. and 3145 ft. We will cement the first stage with 250 sacks of 50-50 pozmix. We will cement the second stage with 300 sacks of 50-50 pozmix and 150 sacks of Class "B". The third stage will be cemented with 250 sacks of 65-35-6 and 150 sacks of Class "B". Stage collars will be drilled out and casing will be pressure-tested. The Dakota zone will be perforated and fractured and a bridge plug placed between zones. The Mesaverde zone will be perforated and fractured. The bridge plug will be removed and both zones will be cleaned up. 2 1/16" tubing will be run to the Dakota zone with a packer to separate the zones. An additional string of 2 1/16" tubing will be run to the Mesaverde zone. The packer will be tested and the well will be connected to a gas gathering system. The gas from both zones has been previously dedicated to a gas transporter.

IN ABOVE SPACE DESCRIBE PROPOSED PROGRAM: If proposal is to deepen or plug back, give data on present productive zone and proposed new productive zone. If proposal is to drill or deepen directionally, give pertinent data on subsurface locations and measured and true vertical depths. Give blowout preventer program, if any.

SIGNED

Rudy D. Motto

TITLE Area Superintendent

DATE April 27, 1982

(This space for Federal or State office use)

PERMIT NO.

APPROVED BY  
CONDITIONS OF APPROVAL, IF ANY:

sk 7

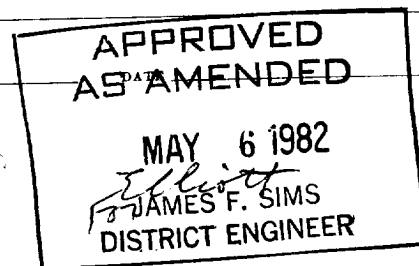
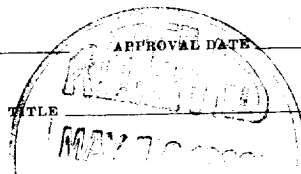

111000

**NEW MEXICO OIL CONSERVATION COMMISSION  
WELL LOCATION AND ACREAGE DEDICATION PLAT**

Form C-102  
Supersedes C-128  
Effective 1-1-85

All distances must be from the outer boundaries of the Section.

|                                                                                                                                                                                                 |                                                  |                               |                                                                          |                             |                        |
|-------------------------------------------------------------------------------------------------------------------------------------------------------------------------------------------------|--------------------------------------------------|-------------------------------|--------------------------------------------------------------------------|-----------------------------|------------------------|
| Operator<br><b>SUPRON ENERGY CORPORATION</b>                                                                                                                                                    |                                                  |                               | Lease<br><b>JICARILLA J</b>                                              |                             | Well No.<br><b>8-E</b> |
| Unit Letter<br><b>M</b>                                                                                                                                                                         | Section<br><b>25</b>                             | Township<br><b>26 NORTH</b>   | Range<br><b>5 WEST</b>                                                   | County<br><b>RIO ARriba</b> |                        |
| Actual Footage Location of Well:<br><div style="display: flex; justify-content: space-between;"> <span>790 feet from the SOUTH line and</span> <span>1120 feet from the WEST line</span> </div> |                                                  |                               |                                                                          |                             |                        |
| Ground Level Elev.<br><b>6664</b>                                                                                                                                                               | Producing Formation<br><b>Dakota / Mesaverde</b> | Pool<br><b>Basin / Blanco</b> | Dedicated Acreage:<br><b>W/2 320.00</b> Acres<br><b>W/2 320.00</b> Acres |                             |                        |

1. Outline the acreage dedicated to the subject well by colored pencil or hachure marks on the plat below.
2. If more than one lease is dedicated to the well, outline each and identify the ownership thereof (both as to working interest and royalty).
3. If more than one lease of different ownership is dedicated to the well, have the interests of all owners been consolidated by communitization, unitization, force-pooling, etc?

☐ Yes   ☐ No   If answer is "yes," type of consolidation \_\_\_\_\_

If answer is "no," list the owners and tract descriptions which have actually been consolidated. (Use reverse side of this form if necessary.) \_\_\_\_\_

No allowable will be assigned to the well until all interests have been consolidated (by communitization, unitization, forced-pooling, or otherwise) or until a non-standard unit, eliminating such interests, has been approved by the Commission.

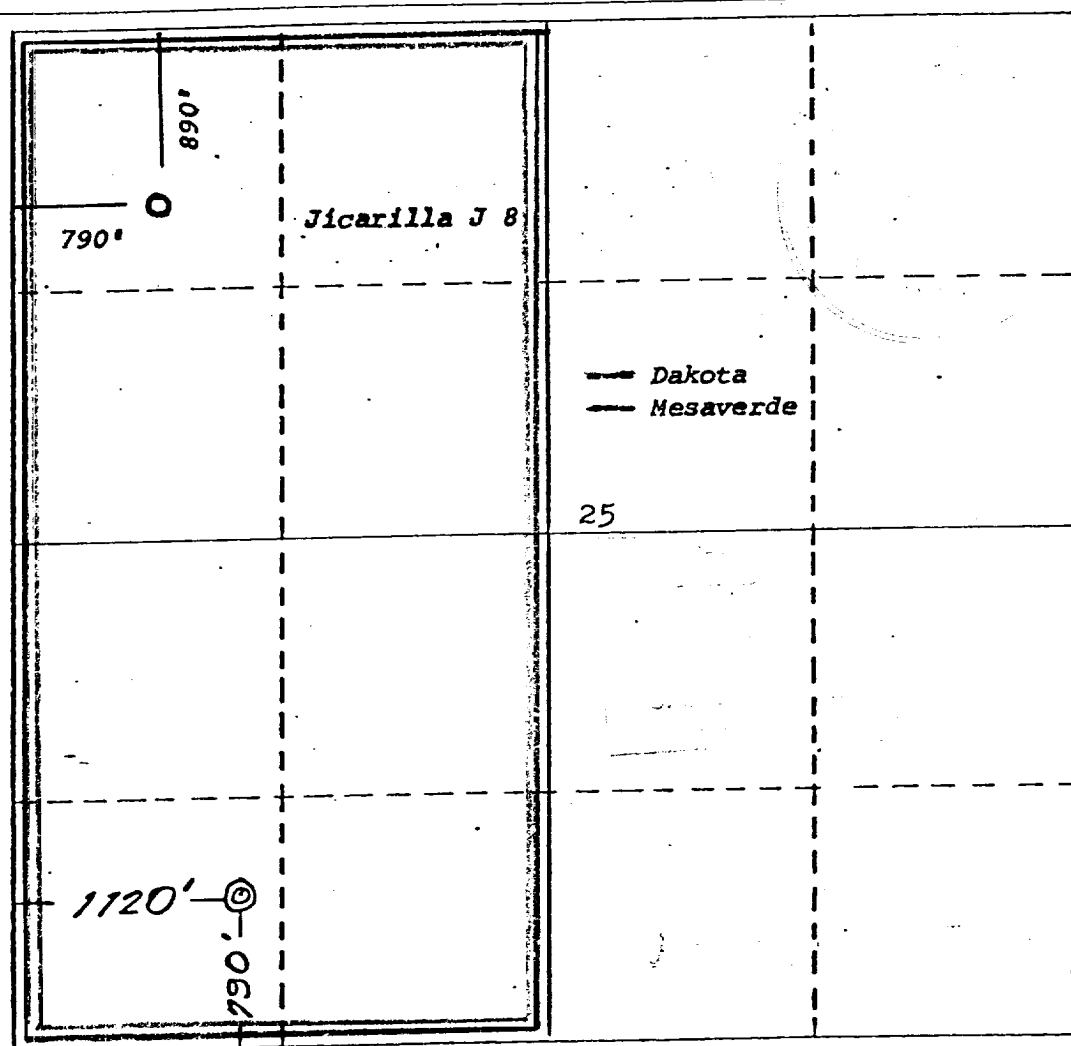

**CERTIFICATION**

I hereby certify that the information contained herein is true and complete to the best of my knowledge and belief.

*Ludy D. Math*  
Name

**Area Superintendent**

Position

**Supron Energy Corporation**

Company

**March 23, 1982**

Date

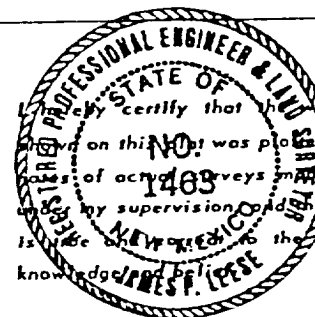

Date Surveyed

**March 22, 1982**

Registered Professional Engineer  
and/or Land Surveyor

*James P. Leese*  
James P. Leese

Certificate No.

**1463**

SUPRON ENERGY CORPORATION  
SW $\frac{1}{4}$ , Sec. 25, T26N, R5W, N.M.P.M.,  
Rio Arriba County, New Mexico

