

UNITED STATES
DEPARTMENT OF THE INTERIOR
GEOLOGICAL SURVEY

APPLICATION FOR PERMIT TO DRILL, DEEPEN, OR PLUG BACK

1a. TYPE OF WORK

DRILL ☒DEEPEN ☐PLUG BACK ☐

b. TYPE OF WELL

OIL WELL ☐ GAS WELL ☒ OTHER ☐SINGLE ZONE ☐MULTIPLE ZONE ☒

2. NAME OF OPERATOR

SUPRON ENERGY CORPORATION

3. ADDRESS OF OPERATOR

P. O. Box 808; Farmington, New Mexico 87401

4. LOCATION OF WELL (Report location clearly and in accordance with any State requirements.)*

At surface
1815 ft. F/North line and 1850 ft. F/West line
At proposed prod. zone Same as above

14. DISTANCE IN MILES AND DIRECTION FROM NEAREST TOWN OR POST OFFICE*

20 Miles Northwest of Ojito, New Mexico

15. DISTANCE FROM PROPOSED*

LOCATION TO NEAREST
PROPERTY OR LEASE LINE, FT.
(Also to nearest drlg. unit line, if any) 790 ft.

18. DISTANCE FROM PROPOSED LOCATION*

TO NEAREST WELL, DRILLING, COMPLETED,
OR APPLIED FOR, ON THIS LEASE, FT. 2015 ft.

16. NO. OF ACRES IN LEASE

2560

19. PROPOSED DEPTH

8320 ft.

17. NO. OF ACRES ASSIGNED
TO THIS WELL

W 1/2 320.00

20. ROTARY OR CABLE TOOLS

Rotary

21. ELEVATIONS (Show whether DF, RT, GR, etc.)

7263 Gr.

22. APPROX. DATE WORK WILL START*

July 1, 1982

23.

PROPOSED CASING AND CEMENTING PROGRAM

SIZE OF HOLE	SIZE OF CASING	WEIGHT PER FOOT	SETTING DEPTH	QUANTITY OF CEMENT
13 3/4"	10 3/4" - H40	32.75	250 ft.	180 sx circulated
9 7/8"	7 7/8" - K55	26.40	4200 ft.	475 sx cover the Ojo Alamo
6 3/4"	5 1/2" - K55	15.50	8320 ft.	450 sx.

We desire to drill 13 3/4" surface hole to approximately 250 ft. using natural mud as a circulating medium. Run new 10 3/4", H40, 32.75# pipe to TD and cement with approximately 180 sx of cement. Circulate cement to the surface. Test the surface pipe. Drill out w/9 7/8" bit to approximately 4200 ft. using a starch base, permaloid, nondispersed mud as the circulating medium. Log the well. Run new 7 5/8", K55, 26.40# pipe to TD. Cement with approximately 475 sx of cement to cover the Ojo Alamo zone. Pressure test the pipe. Drill 6 3/4" hole to approximately 8320 ft. using gas or air as the circulating medium. Log the well. Run new 5 1/2" K55, 15.50# csg. to TD with the top of the liner at approximately 4050 ft. Cement with approximately 450 sx of cement. Pressure test the casing and clean out to PBTD. Perforate & fracture the Dakota zone. Set a bridge plug above the Dakota zone. Perforate and fracture the Mesaverde zone. and clean this zone up. Remove the bridge plug. Clean the Dakota zone up. Run a production packer on 2 1/16" I.J. tbg. and set above the Dakota zone. Run a second string of 2 1/16" I.J. tbg. and land it in the Mesaverde zone. Nipple down the well head. Test the production packer for leakage. Test the Dakota zone. Test the Mesaverde zone. Connect to a gathering system. The gas from this well has previously been dedicated to a transporter.

IN ABOVE SPACE DESCRIBE PROPOSED PROGRAM: If proposal is to deepen or plug back, give data on present productive zone and proposed new productive zone. If proposal is to drill or deepen directionally, give pertinent data on subsurface locations and measured and true vertical depths. Give blowout preventer program, if any.

24.

SIGNED

Rudy D. Motto

TITLE Area Superintendent

DATE April 20, 1982

(This space for Federal or State office use)

PERMIT NO.

APPROVAL DATE

APPROVED BY

CONDITIONS OF APPROVAL, IF ANY:

DATE

JUN 09 1982



TMOCC

NEW MEXICO OIL CONSERVATION COMMISSION
WELL LOCATION AND ACREAGE DEDICATION PLAT

Form C-102
Superseded C-128
Effective 1-1-65

All distances must be from the outer boundaries of the Section.

Operator SUPRON ENERGY CORPORATION			Lease JICARILLA "G"		Well No. 5E
Unit Letter F	Section 12	Township 26 NORTH	Range 5 WEST	County RIO ARriba	
Actual Footage Location of Wells 1815 feet from the NORTH line and 1850 feet from the WEST line					
Ground Level Elev. 7263	Producing Formation DAKOTA MESAVERDE		Pool BASIN BLANCO		Dedicated Acreage: W/2 320.00 Acres

1. Outline the acreage dedicated to the subject well by colored pencil or hachure marks on the plat below.
2. If more than one lease is dedicated to the well, outline each and identify the ownership thereof (both as to working interest and royalty).
3. If more than one lease of different ownership is dedicated to the well, have the interests of all owners been consolidated by communitization, unitization, force-pooling, etc?

☐ Yes ☐ No If answer is "yes," type of consolidation _____

If answer is "no," list the owners and tract descriptions which have actually been consolidated. (Use reverse side of this form if necessary.) _____

No allowable will be assigned to the well until all interests have been consolidated (by communitization, unitization, forced-pooling, or otherwise) or until a non-standard unit, eliminating such interests, has been approved by the Commission.

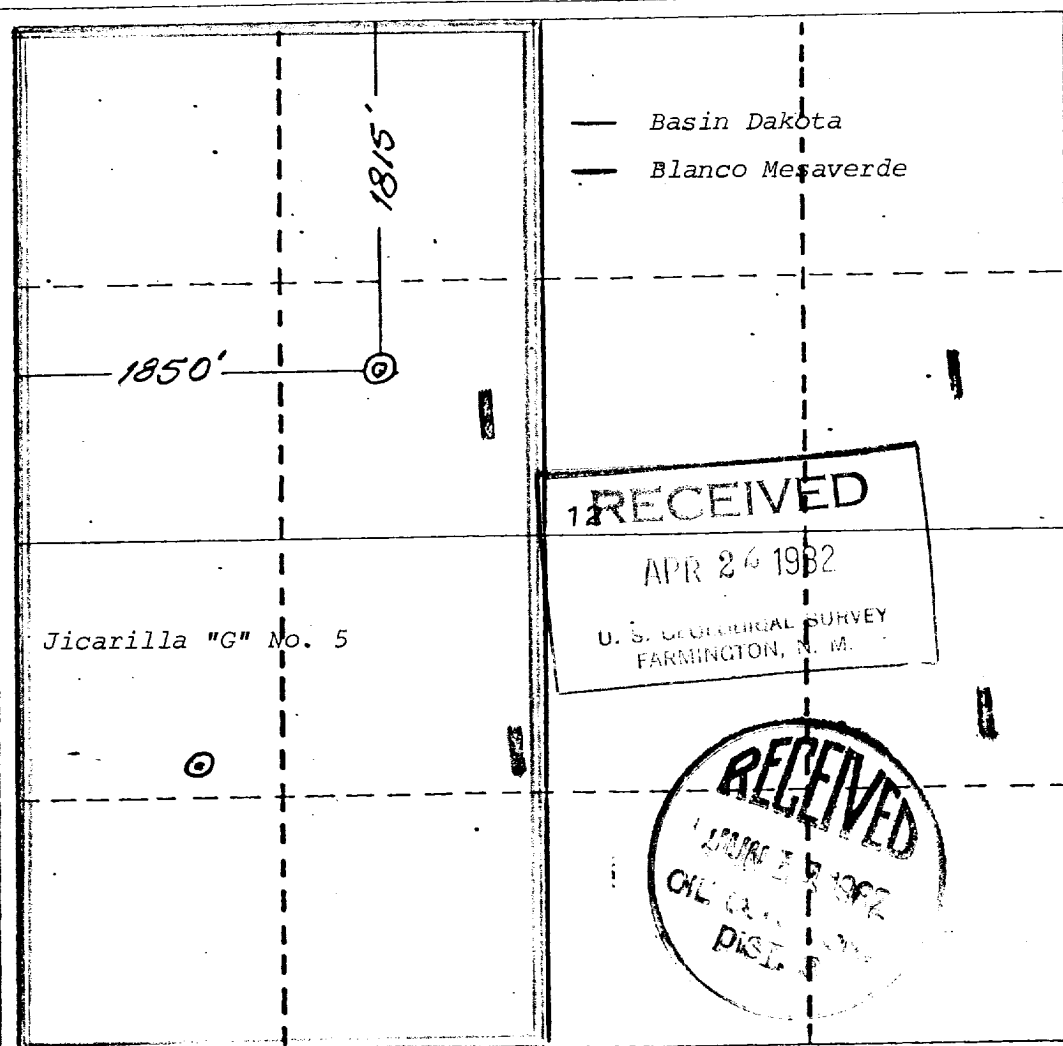

CERTIFICATION

I hereby certify that the information contained herein is true and complete to the best of my knowledge and belief.

Rudy D. Motto

Name

Rudy D. Motto

Position

Area Superintendent

Company

Supron Energy Corporation

Date

March 25, 1982

I hereby certify that the information shown on this plat was plotted from field notes of actual surveys made by me or under my supervision and that the same is true and correct to the best of my knowledge and belief.

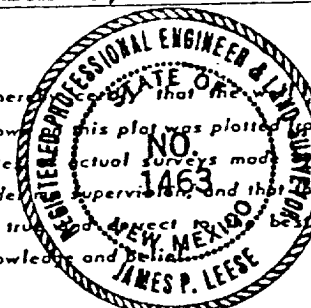

Date Surveyed

March 24, 1982

Registered Professional Engineer and/or Land Surveyor

James P. Leese

Certificate No.

1463

SUPRON ENERGY CORPORATION
NW $\frac{1}{4}$, Sec. 12, T26N, R5W, N.M.P.M.,
Rio Arriba County, New Mexico

