

District 1 & GAS INSPECTOR
P.O. Box 1980, Hobbs, NM

State of New Mexico
Energy, Minerals and Natural Resources Dept.

SUBMIT 1 COPY TO
APPROPRIATE
DISTRICT OFFICE
AND 1 COPY TO
SANTA FE OFFICE

District JAN 27 1999
P.O. Drawer DD, Artesia,
NM 88221

District III
1000 Rio Brazos Rd. Aztec
NM 87410

OIL CONSERVATION DIVISION
2040 S. Pacheco
Santa Fe, New Mexico 87504

PIT REMEDIATION AND CLOSURE REPORT

Operator: Caulkins Oil Company Telephone: (505) 632-1544

Address: P.O. Box 340, Bloomfield, NM 87413

Facility or Well Name: Breech "D" 140-M

Location: Unit or Qtr/Qtr D Sec 11 T 26N R 6W County Rio Arriba

Pit Type: Separator X Dehydrator Other

Land Type: BLM X , State , Fee , Other

Pit Location: Pit dimensions: length 35', width 20', depth 12'
(Attach diagram)

References: wellhead X, other _____

Footage from reference: 75'

Direction from reference: 280 Degrees _____ East North X
of
_____ X West South

Depth to Ground Water:	Less than 50 feet	(20 points)	
(Vertical distance from	50 feet to 99 feet	(10 points)	
contaminants to seasonal high	Greater than 100 feet	(0 points)	
water elevation of ground water)			<u>0</u>

Wellhead Protection Area: Yes (20 points)

(Less than 200 feet from a No (0 points) 0

private domestic water source,
or; less than 1000 feet from all
other water sources)

Distance to Surface Water: (Horizontal distance to perennial lakes, ponds, rivers, streams, creeks, irrigation canals and ditches)	Less than 200 feet	(20 points)	
	200 feet to 1000 feet	(10 points)	
	Greater than 1000 feet	(0 points)	<u>0</u>

RANKING SCORE (TOTAL POINTS): 0

Date Remediation Started: 6-23-97 Date Completed: 9-18-97

Remediation Method: Excavation X Approx. cubic yards 311
Check all appropriate

Check all appropriate sections:

Landfarmed X Insitu Bioremediation

Other _____

Remediation Location: Onsite X Offsite _____
(ie. landfarmed onsite,
name and location of
offsite facility) _____

General Description of Remedial Action: Aeration and Dilution

Ground Water Encountered: No X Yes Depth

Final Pit:

Closure Sampling:

(if multiple samples,
attach sample results
and diagram of sample

Sample Location Bottom of pit and landfarm

Sample depth 14'

Sample date 9-29-97 Sample time 11:15 a.m.

Benzene (ppm) _____

Total BTEX (ppm) ND

Field headspace (ppm) _____

TPH Landfarm: 2600 ppm Pit: 400 ppm

Ground Water Sample: Yes ☐ No ☒ (If yes, attach sample results)

I HEREBY CERTIFY THAT THE INFORMATION ABOVE IS TRUE AND COMPLETE TO THE BEST OF MY KNOWLEDGE AND BELIEF.

DATE October 6, 1998

SIGNATURE

Robert L. Verqueen

PRINTED NAME

NAME AND TITLE ROBERT L. VERQUER, SUPERINTENDENT

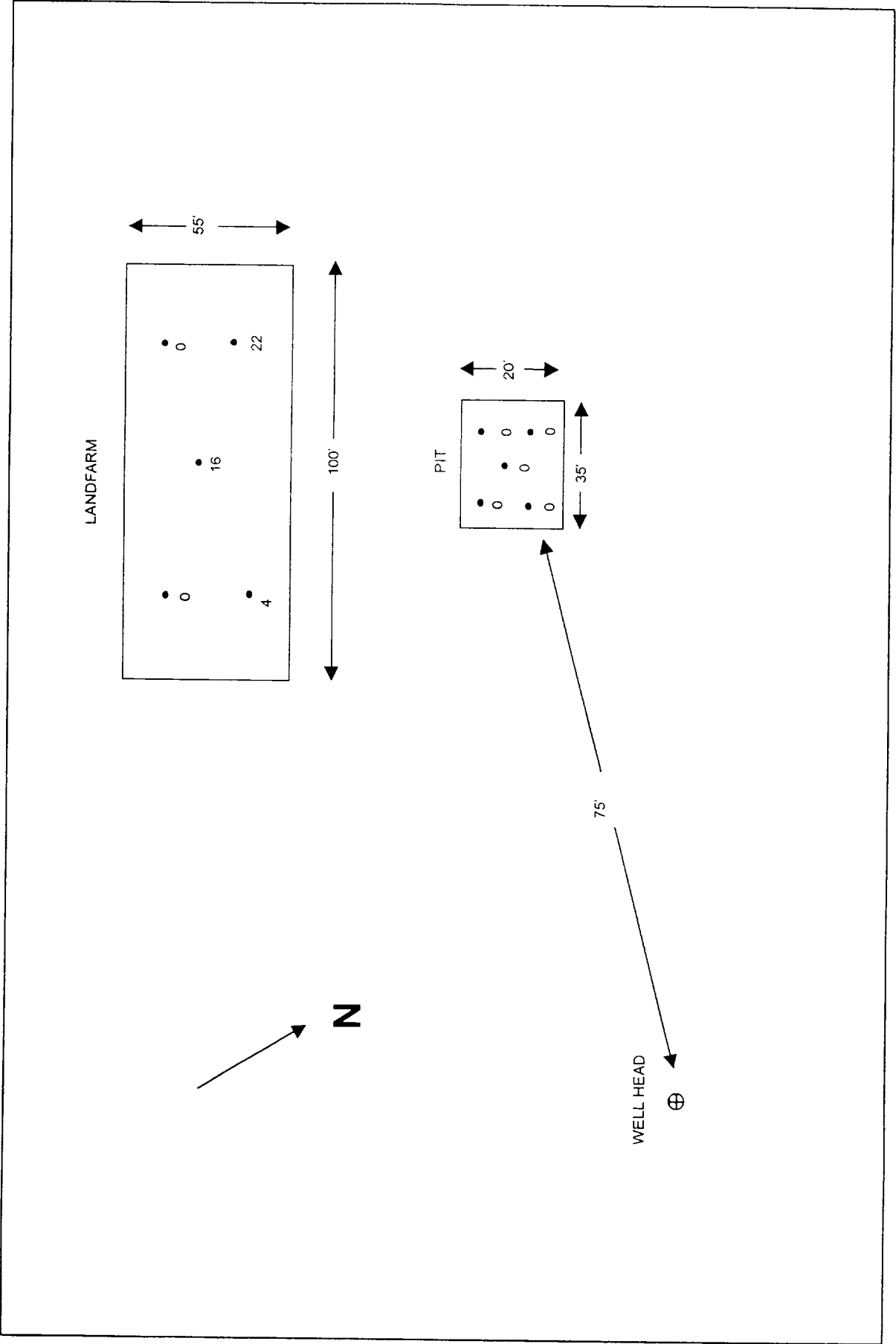



®Certificate of Analysis No. 9709201-03

FARMINGTON LABORATORY
P.O. BOX 1289
FARMINGTON, NEW MEXICO 87499-1289
PHONE (505) 326-2588

Caulkins Oil Co.
1997 E Blanco Blvd
Bloomfield, NM 87413
Attn: Bobby Verquer

Date: 10/27/97

Project: Landfarm	Project No:
Site:	Matrix: Soil
Sampled By: J. Waggoner	Date Sampled: 09/29/97
Sample ID: Breech D 140 M	Date Received: 09/29/97

Analytical Data

PARAMETER	RESULTS	DETECTION LIMIT	UNITS
Benzene	ND	1.0	µg/Kg
Toluene	ND	1.0	µg/Kg
Ethylbenzene	ND	1.0	µg/Kg
Total Xylene	ND	1.0	µg/Kg
Total Volatile Aromatic Hydrocarbons	ND		µg/Kg

Surrogate	% Recovery
------------------	-------------------

1,4-Difluorobenzene	110
---------------------	-----

4-Bromofluorobenzene	123
----------------------	-----

Method 8020

Analyzed by: LJ

Date: 10/15/97

Total Petroleum Hydrocarbons-Diesel	2600	100	mg/Kg
-------------------------------------	------	-----	-------

Surrogate	% Recovery
------------------	-------------------

n-Pentacosane	1380MI
---------------	--------

Method 8015A*** for Diesel

Analyzed by: RR

Date: 10/09/97

Gasoline Range Organics	ND	0.1	mg/Kg
-------------------------	----	-----	-------

Surrogate	% Recovery
------------------	-------------------

4-Bromofluorobenzene	67
----------------------	----

1,4-Difluorobenzene	117
---------------------	-----

Method 8015A*** for Gasoline

Analyzed by: RR

Date: 10/09/97

ND- Not detected

MI-Matrix Interference

Notes:

*Ref: Methods for Chemical Analysis of Water and Wastes, 1983, EPA

**Ref: Standard Methods for Examination of Water & Wastewater, 18th ed.

***Ref: Test Methods for Evaluating Solid Waste, EPA SW846, 3rd Ed.

QUALITY ASSURANCE: These analyses are performed in accordance with
EPA guidelines for quality assurance.

Danica Carman, Lab Manager



®Certificate of Analysis No. 9709201-04

FARMINGTON LABORATORY

P.O. BOX 1289

FARMINGTON, NEW MEXICO 87499-1289

PHONE (505) 326-2588

Caulkins Oil Co.
1997 E Blanco Blvd
Bloomfield, NM 87413
Attn: Bobby Verquer

Date: 10/27/97

Project: Bottom of Pit
Site:
Sampled By: J. Waggoner
Sample ID: Breech D 140 M

Project No:
Matrix: Soil
Date Sampled: 09/29/97
Date Received: 09/29/97

Analytical Data

PARAMETER	RESULTS	DETECTION LIMIT	UNITS
Benzene	ND	1.0	µg/Kg
Toluene	ND	1.0	µg/Kg
Ethylbenzene	ND	1.0	µg/Kg
Total Xylene	ND	1.0	µg/Kg
Total Volatile Aromatic Hydrocarbons	ND		µg/Kg

Surrogate % Recovery

1,4-Difluorobenzene 97
4-Bromofluorobenzene 117
Method 8020

Analyzed by: LJ

Date: 10/15/97

Total Petroleum Hydrocarbons-Diesel 400 40.0 mg/Kg

Surrogate % Recovery

n-Pentacosane 700MI
Method 8015A*** for Diesel
Analyzed by: RR
Date: 10/09/97

Gasoline Range Organics ND 0.1 mg/Kg

Surrogate % Recovery

4-Bromofluorobenzene 63
1,4-Difluorobenzene 90
Method 8015A*** for Gasoline
Analyzed by: RR
Date: 10/09/97

ND- Not detected

MI-Matrix Interference

Notes:

*Ref: Methods for Chemical Analysis of Water and Wastes, 1983, EPA

**Ref: Standard Methods for Examination of Water & Wastewater, 18th ed.

***Ref: Test Methods for Evaluating Solid Waste, EPA SW846, 3rd Ed.

QUALITY ASSURANCE: These analyses are performed in accordance with
EPA guidelines for quality assurance.

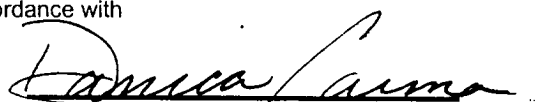
Danica Carman, Lab Manager

WELL NAME: Breech D 140-M

CAULKINS OIL
SITE SECURITY DIAGRAM

