

Amended API # to 30-039-23134

SUBMIT IN TRIPLICATE*
(Other instructions on reverse side)

Form approved.
Budget Bureau No. 42-R1425.

UNITED STATES
DEPARTMENT OF THE INTERIOR
GEOLOGICAL SURVEY

APPLICATION FOR PERMIT TO DRILL, DEEPEN, OR PLUG BACK

1a. TYPE OF WORK
DRILL ☒ DEEPEN ☐ PLUG BACK ☐

b. TYPE OF WELL
OIL WELL ☐ GAS WELL ☒ OTHER ☐
SINGLE ZONE ☐ MULTIPLE ZONE ☒

2. NAME OF OPERATOR
Ladd Petroleum Corporation

3. ADDRESS OF OPERATOR
830 Denver Club Bldg. Denver, Colo. 80202

4. LOCATION OF WELL (Report location clearly and in accordance with any State requirements.)
At surface 1010' FNL, 1650' FWL, Sec. 10-T26N-R7W

At proposed prod. zone
Same

14. DISTANCE IN MILES AND DIRECTION FROM NEAREST TOWN OR POST OFFICE*
Approx. 30 miles SE of Blanco, New Mexico

10. DISTANCE FROM PROPOSED*
LOCATION TO NEAREST
PROPERTY OR LEASE LINE, FT.
(Also to nearest drlg. unit line, if any)
1,010'

18. DISTANCE FROM PROPOSED LOCATION*
TO NEAREST WELL, DRILLING, COMPLETED,
OR APPLIED FOR, ON THIS LEASE, FT.
1,000'

21. ELEVATIONS (Show whether DF, RT, GR, etc.)
6121' GR

23. PROPOSED CASING AND CEMENTING PROGRAM

SIZE OF HOLE	SIZE OF CASING	WEIGHT PER FOOT	SETTING DEPTH	QUANTITY OF CEMENT
12 1/4"	8 5/8"	24# K-55 ST&C	225'	225 sx Class "B"
7 7/8"	5 1/2"	15.5# K-55 ST&C	7325'	450 sx Class "B" + 575 sx 65/35 Poz.

1. Drill 12 1/4" hole and set 8 5/8" casing to 225'.
2. Log BOP checks in daily drilling reports and drill 7 7/8" hole to 7325'.
3. Run test if warranted and run 5 1/2" casing if productive.
4. Run logs as needed, perforate and stimulate as needed.

EXHIBITS ATTACHED:

- "A" Location and elevation plat.
- "B" Ten point compliance program.
- "C" Blowout preventor diagram.
- "D" Multipoint requirements for APD.
- "E" Access roads and Topco maps.
- & "E 1" & "E" 2.

- "F" Drill pad/production facilities layout.
- "G" Drlg. rig layout/cuts and fills.
- "H" Well location plat.
- "I" Cultural Resources report.

IN ABOVE SPACE DESCRIBE PROPOSED PROGRAM: If proposal is to deepen or plug back, give data on present productive zone and proposed new productive zone. If proposal is to drill or deepen directionally, give pertinent data on subsurface locations and measured and true vertical depths. Give blowout preventer program, if any.

24. SIGNED J. E. Meyer TITLE Drilling Engineer DATE Oct. 19, 1982

(This space for Federal or State office use)

PERMIT NO.

APPROVED BY

CONDITIONS OF APPROVAL, IF ANY:

RECEIVED

DEC 17 1982

OIL CON. DIV.
DIST. 3

See Instructions On Reverse Side

NMOCC

5. LEASE DESIGNATION AND SERIAL NO.
USA FE- 079161

6. IF INDIAN, ALLOTTEE OR TRIBE NAME

7. UNIT AGREEMENT NAME

8. FARM OR LEASE NAME
Lindrith

9. WELL NO.
2-10M 110 E

10. FIELD AND POOL, OR WILDCAT
Basin Dakota / Lay. Gallup

11. SEC., T., R., M., OR BLM.
AND SURVEY OR AREA
Sec. 10-T26N-R7W

12. COUNTY OR PARISH
Rio Arriba

13. STATE
New Mexico

16. NO. OF ACRES ASSIGNED TO THIS WELL
U.S. GEOLOGICAL SURVEY
2561 E. WASHINGTON, N. M. N320 / N320

19. PROPOSED DEPTH
7325'

20. ROTARY OR CABLE TOOLS
Rotary

22. APPROX. DATE WORK WILL START*
December, 1982

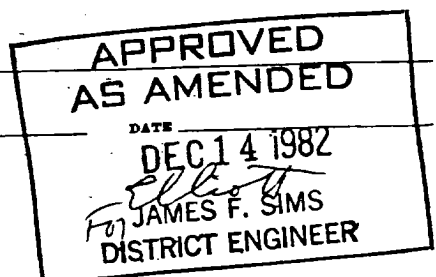

STATE OF NEW MEXICO
ENERGY AND MINERALS DEPARTMENT

OIL CONSERVATION DIVISION
P. O. BOX 2088
SANTA FE, NEW MEXICO 87501

Exhibit "A"
Location and
Elevation Plat. Form C-102
Revised 10-1-78

All distances must be from the outer boundaries of the Section.

Operator Ladd Petroleum Corporation			Lease Lindrith		Well No. 2-70M 110 E
Unit Letter C	Section 10	Township 26 North	Range 7	County Rio Arriba	
Actual Footage Location of Well:					
1010	feet from the North	line and	1650	feet from the West	line
Ground Level Elev. 6121	Producing Formation Dakota/Gallup		Pool N/A Basin / Largo Ext.	Dedicated Acreage: N320 / N320 Acres	

1. Outline the acreage dedicated to the subject well by colored pencil or hatchure marks on the plat below.
2. If more than one lease is dedicated to the well, outline each and identify the ownership thereof (both as to working interest and royalty).
3. If more than one lease of different ownership is dedicated to the well, have the interests of all owners been consolidated by communitization, unitization, force-pooling, etc?

☐ Yes ☐ No If answer is "yes," type of consolidation _____

If answer is "no," list the owners and tract descriptions which have actually been consolidated. (Use reverse side of this form if necessary.) _____

No allowable will be assigned to the well until all interests have been consolidated (by communitization, unitization, forced-pooling, or otherwise) or until a non-standard unit, eliminating such interests, has been approved by the Division.

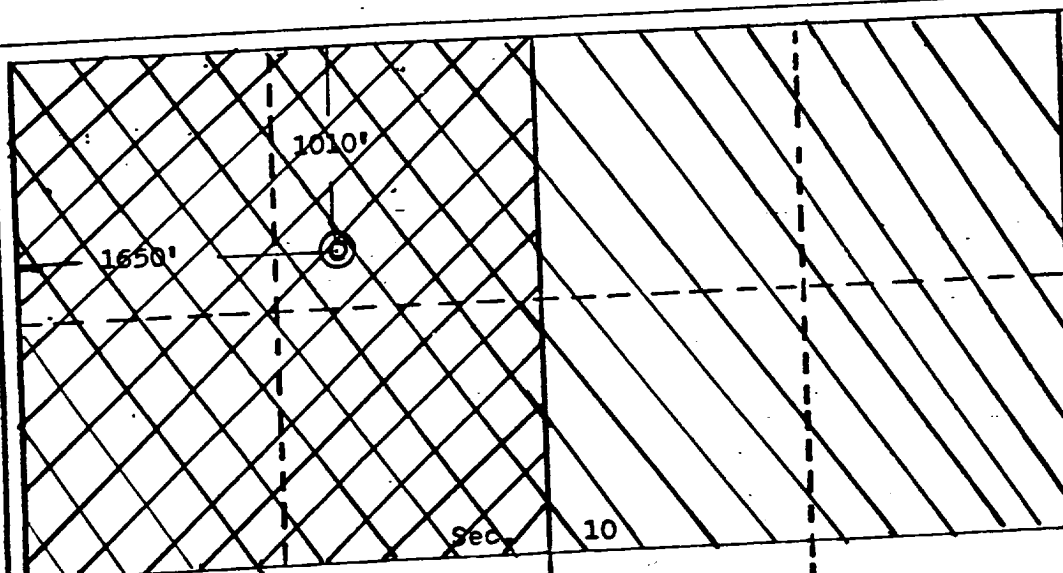

RECEIVED
DEC 17 1982
OIL CON
DIST.

RECEIVED
OCT 25 1982
U. S. GEOLOGICAL SURVEY
FARMINGTON, N. M.

CERTIFICATION

I hereby certify that the information contained herein is true and complete to the best of my knowledge and belief.

Name J. E. Nigam
Position Drilling Engineer
Company Ladd Petroleum Corp.
Date October 19, 1982

I hereby certify that the location shown on this plat was taken from field notes or actual survey made by me or under my supervision, and that the same is true and correct to the best of my knowledge and belief.

Date Surveyed
September 15, 1982
Registered Professional Engineer
and/or Land Surveyor

Edgar L. Risenhoover
Certificate No. 5979

