

DEPUTY OIL & GAS INSPECTOR

FEB 08 1999

**ENVIRONMENTAL PROTECTION OFFICE**

P.O. BOX 507  
DULCE, NEW MEXICO 87528

SUBMIT 1 COPY TO  
NATURAL  
RESOURCE DEPT  
AND OIL -GAS  
ADMINISTRATION

# PIT REMEDIATION AND CLOSURE REPORT

Operator: PNM Gas Services ( WFS ) Telephone: 324-3764

**Address:** 603 W. Elm Street Farmington, NM 87401

Facility or Well Name: Jicarilla Apache Tribal ISI-86 DRIP

**Location:** Unit: B Sec. 3 T. 26 N R. 5 W County Rio Arriba

**Pit Type:** Separator      Dehydrator      Other LINE DRIP

**Land Type:** Jicarilla Apache

Pit Location: Pit dimensions: length 18' width 18' depth 3'

(Attach diagram)      Reference:      wellhead      other Drip Riser

Footage from reference: 29'

Direction from reference: DUE Degrees      East of North       
West of South X

**Depth to Ground Water:**

(Vertical distance from contaminants to seasonal high water elevation of ground water)

Less than 50 feet	(20 points)
50 feet to 99 feet	(10 points)
Greater than 100 feet	( 0 points)

**Wellhead Protection Area:**

(Less than 200 feet from a private domestic water source, or; less than 1,000 feet from all other water sources)

Yes (20 points)  
No ( 0 points)

**Distance to Surface Water:**

(Horizontal distance to perennial lakes, ponds, rivers, streams, creeks, irrigation canals and ditches)

Less than 200 feet	(20 points)
200 feet to 1,000 feet	(10 points)
Greater than 1,000 feet	(0 points)

**Distance to Ephemeral Stream (dry wash):**

(Horizontal distance to all downgradient streams having a width of at least 10 feet)

Less than or equal to 100 feet	(10 points)
Greater than 100 feet	(0 points)

Distance to Nearest Lake, Playa, or Watering Pond:

(Horizontal distance to all downgradient lakes, playas, and livestock or wildlife water ponds)

Less than or equal to 100 feet	(10 points)
Greater than 100 feet	(0 points)

**RANKING SCORE (TOTAL POINTS) :**

Date Remediation Started: 6/1/98 Date Completed: 9/23/98

Remediation Method: Excavation X Approx. Cubic Yards 447

(Check all appropriate sections) Landfarmed X Amount Landfarmed (cubic yds): 447

Other \_\_\_\_\_

Remediation Location: Onsite \_\_\_\_\_ Offsite Jicarilla Apache Tribal  
(i.e., landfarmed onsite, name and location of offsite facility) 151-8E

General Description of Remedial Action:

Removed contaminated Soil from all four Side walls and Pit Bottom. As to get A below 100 ppm headspace reading. EXCAVATION size 24'x26'x16' 447 cu yds

Ground Water Encountered: No X Yes \_\_\_\_\_ Depth \_\_\_\_\_

Final Pit Closure Sampling:

(if multiple samples, attach sample result and diagram of sample locations and depths.)

Sample Location North, East, South, West Side walls AND Pit Bottom

Sample depth 16'

Sample date 6/2/98 Sample time 1301

Sample Results

Soil: Benzene (ppm) \_\_\_\_\_ Water: Benzene (ppb) \_\_\_\_\_

Total BTEX (ppm) \_\_\_\_\_ Toluene (ppb) \_\_\_\_\_

Field headspace (ppm) 2.3 (bottom) Ethylbenzene (ppb) \_\_\_\_\_  
17.3 (east wall)

TPH ND ppm Method 8015 Total Xylenes (ppb) \_\_\_\_\_

Ground Water Sample: Yes \_\_\_\_\_ No X (If yes, attach sample results)

I HEREBY CERTIFY THAT THE INFORMATION ABOVE IS TRUE AND COMPLETE TO THE BEST OF MY KNOWLEDGE AND MY BELIEF

DATE 6/14/98 PRINTED NAME Roy Burnham

SIGNATURE Roy Burnham AND TITLE Environmental Technician II

AFTER REVIEW OF THE PIT CLOSURE INFORMATION, PIT CLOSURE IS APPROVED IN ACCORDANCE TO JICARILLA APACHE TRIBE PIT CLOSURE ORDINANCE.

APPROVED: YES X NO \_\_\_\_\_ (REASON): \_\_\_\_\_

SIGNED: K. C. Marshall DATE: 6-29-98

SICARILLA Apache Tribal 151-8E Drip  
Sec-3 T26N R5W unit B

Site Drawing

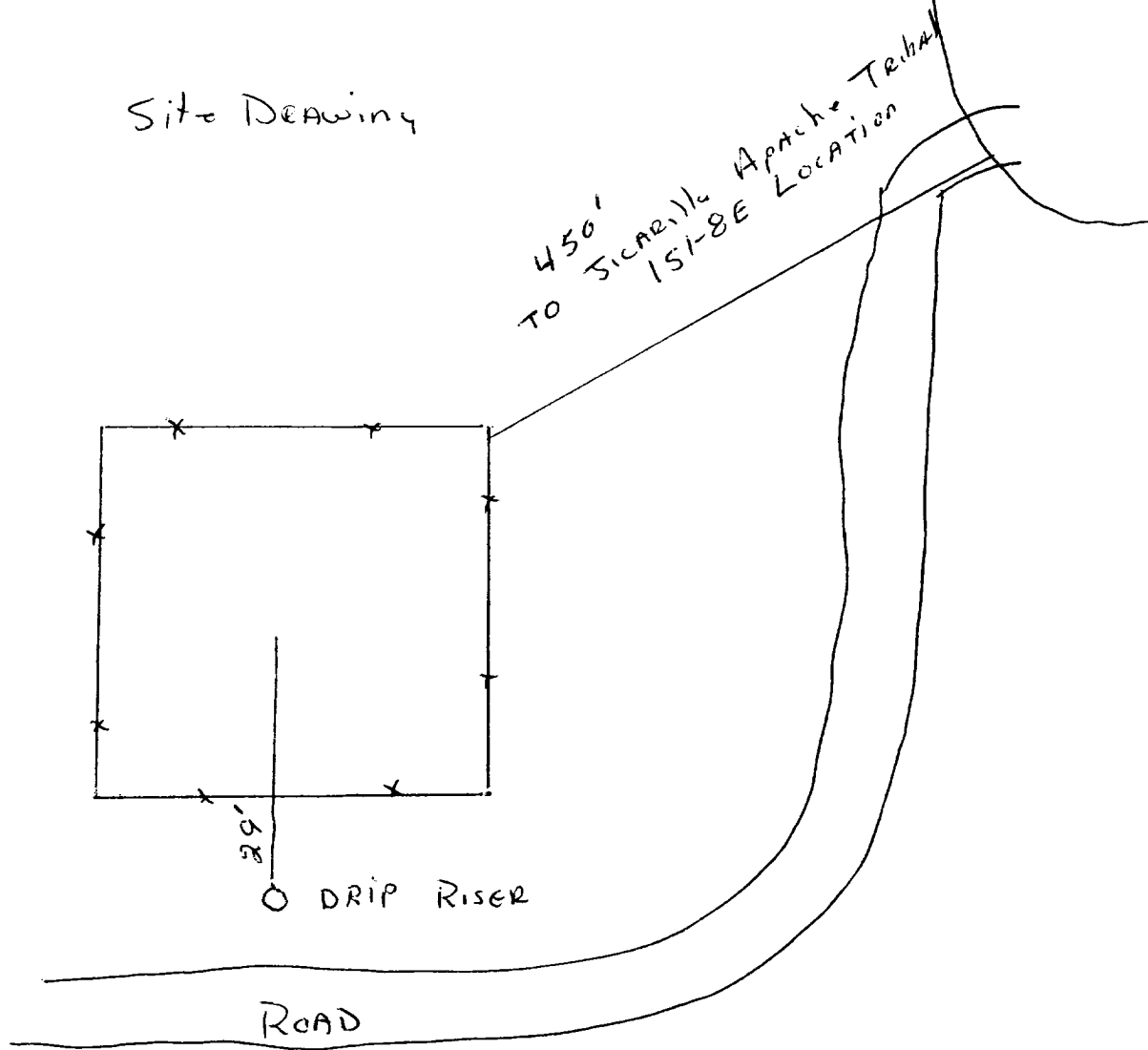

Sicaria Apache IRDAI 151-8E DRIP  
Sec 3 T26N R5W unit B

## Excavation Drawing

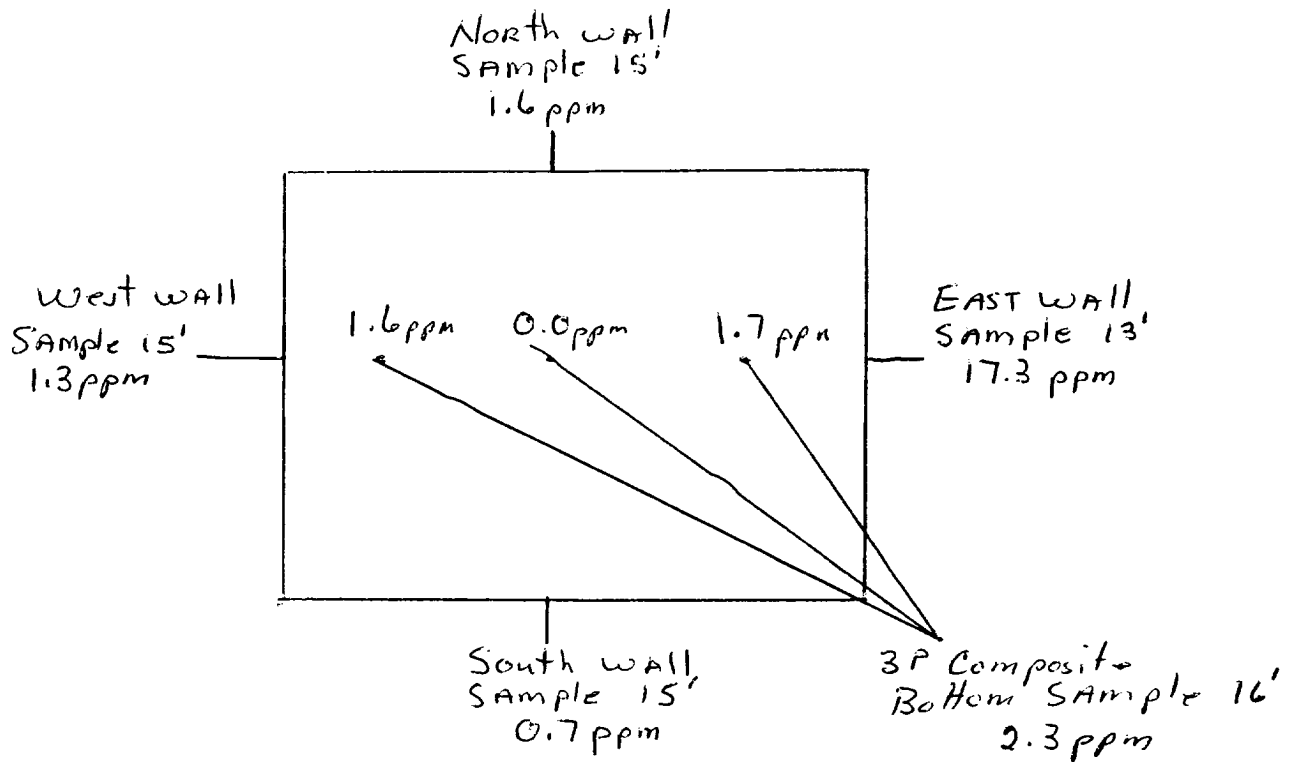

5' 2008 ppm  
10' 622 ppm  
15' 8.3 ppm  
Bottom 16' 1.6 ppm  
0.0 ppm  
1.7 ppm

# ON SITE

OFF: (505) 325-5667

LAB: (505) 325-1556

TECHNOLOGIES, LTD.

**On Site Technologies, LTD.**

**Date:** 11-Jun-98

---

**CLIENT:** PNM - Public Service Company of NM

**Project:** Jicarilla Pits

**Lab Order:** 9806016

## CASE NARRATIVE

---

Samples were analyzed using the methods outlined in the following references:

Test Methods for Evaluating Solid Waste, Physical/Chemical Methods, SW846, 3rd Edition

All method blanks, laboratory spikes, and/or matrix spikes met quality assurance objectives.

OFF: (505) 325-5667

**ON SITE**  
**TECHNOLOGIES, LTD.**

LAB: (505) 325-1556

**ANALYTICAL REPORT**

**Date:** 11-Jun-98

<b>Client:</b>	PNM - Public Service Company of NM	<b>Client Sample Info:</b>	Jic. Apache Tribal 151-8E Drip
<b>Work Order:</b>	9806016	<b>Client Sample ID:</b>	9806021301; 3pt. Comp. Bottom
<b>Lab ID:</b>	9806016-02A	<b>Matrix:</b>	SOIL
<b>Project:</b>	Jicarilla Pits	<b>Collection Date:</b>	6/2/98 1:01:00 PM
		<b>COC Record:</b>	7166

Parameter	Result	PQL	Qual	Units	DF	Date Analyzed
<b>DIESEL RANGE ORGANICS</b>		<b>SW8015</b>				Analyst: HR
T/R Hydrocarbons: C10-C28	ND	25		mg/Kg	1	6/5/98

<b>Qualifiers:</b>	PQL - Practical Quantitation Limit	S - Spike Recovery outside accepted recovery limits
	ND - Not Detected at Practical Quantitation Limit	R - RPD outside accepted recovery limits
	J - Analyte detected below Practical Quantitation Limit	E - Value above quantitation range
	B - Analyte detected in the associated Method Blank	Surr: - Surrogate

1 of 1

OFF: (505) 325-5667

# ON SITE

TECHNOLOGIES, LTD.

LAB: (505) 325-1556

## ANALYTICAL REPORT

Date: 11-Jun-98

<b>Client:</b>	PNM - Public Service Company of NM	<b>Client Sample Info:</b>	Jic. Apache Tribal 151-8E Drip
<b>Work Order:</b>	9806016	<b>Client Sample ID:</b>	9806021300; 4pt. Comp. Walls
<b>Lab ID:</b>	9806016-01A	<b>Matrix:</b>	SOIL
<b>Project:</b>	Jicarilla Pits	<b>Collection Date:</b>	6/2/98 1:00:00 PM
		<b>COC Record:</b>	7166

Parameter	Result	PQL	Qual	Units	DF	Date Analyzed
<b>DIESEL RANGE ORGANICS</b>		<b>SW8015</b>				Analyst: HR
T/R Hydrocarbons: C10-C28	ND	25		mg/Kg	1	6/5/98

<b>Qualifiers:</b>	PQL - Practical Quantitation Limit	S - Spike Recovery outside accepted recovery limits
	ND - Not Detected at Practical Quantitation Limit	R - RPD outside accepted recovery limits
	J - Analyte detected below Practical Quantitation Limit	E - Value above quantitation range
	B - Analyte detected in the associated Method Blank	Surr: - Surrogate

1 of 1

P.O. BOX 2606 • FARMINGTON, NM 87499

JICARILLA APACHE TRIBE  
ENVIRONMENTAL  
PROTECTION OFFICE  
P.O. BOX 507  
DULCE, NEW MEXICO 87528

SUBMIT 1 COPY TO  
NATURAL  
RESOURCE DEPT  
AND OIL GAS  
ADMINISTRATION

ON-SITE SOIL REMEDIATION REPORT

<b>Operator:</b> <u>PNM Gas Services ( WFS )</u> <b>Telephone:</b> <u>324-3764</u>	
<b>Address:</b> <u>603 W. Elm Street Farmington, NM 87401</u>	
<b>Facility or Well Name:</b> <u>JICARILLA Apache Tribal 151-8E DRIP</u>	
<b>Location:</b>	<b>Unit:</b> <u>B</u> <b>Sec.</b> <u>3</u> <b>T.</b> <u>26</u> <b>N</b> <b>R.</b> <u>5</u> <b>W</b> <b>County</b> <u>Rio Arriba</u>
<b>Land Type:</b> <u>Jicarilla Apache</u>	
<b>Date Remediation Started:</b> <u>6/1/98</u> <b>Date Completed:</b> <u>9/3/98</u>	
<b>Remediation Method:</b> Landfarmed <u>X</u> <b>Approx. cubic yards</b> <u>447</u> Composted <u>    </u> Other <u>    </u>	
<b>Depth to Ground Water:</b> (pts.) <u>0</u> <b>Distance to an Ephemeral Stream:</b> (pts.) <u>0</u> <b>Distance to Nearest Lake, Playa, or Watering Pond:</b> (pts.) <u>0</u> <b>Wellhead Protection Area:</b> (pts.) <u>0</u> <b>Distance to Surface Water:</b> (pts.) <u>0</u> <b>Ranking Score (Total Points):</b> <u>0</u>	<b>Final Closure Sampling:</b> <b>Sampling Date:</b> <u>8/31/98</u> <b>Time</b> <u>0933</u> <b>Sampling Results:</b> <b>Field Headspace (ppm)</b> <u>48.2</u> <b>TPH (ppm)</b> <u>26</u> <b>Method</b> <u>8015</u> <b>Other</b> <u>    </u>
<b>I HEREBY CERTIFY THAT THE INFORMATION ABOVE IS TRUE AND COMPLETE TO THE BEST OF MY KNOWLEDGE AND BELIEF</b>	
<b>DATE</b> <u>9/14/98</u> <b>PRINTED NAME</b> <u>Roy Burnham</u>	
<b>SIGNATURE</b> <u>Roy Burnham</u> <b>AND TITLE</b> <u>Environmental Technician II</u>	
<b>AFTER REVIEW OF THE SOIL REMEDIATION INFORMATION, ON-SITE REMEDIATION APPROVED IN ACCORDANCE TO THE JICARILLA APACHE TRIBE PIT CLOSURE ORDINANCE</b>	
<b>APPROVED:</b> YES <u>X</u> NO <u>    </u> <b>(REASON)</b> <u>use as Backfill</u>	
<b>SIGNED:</b> <u>Kevin M. M... (signature)</u> <b>DATE:</b> <u>9-23-98</u>	



Jicarilla Apache Tribal 151-8E Drip  
Sec. 3 T26N R5W Unit B  
WFS

Land farm

87'

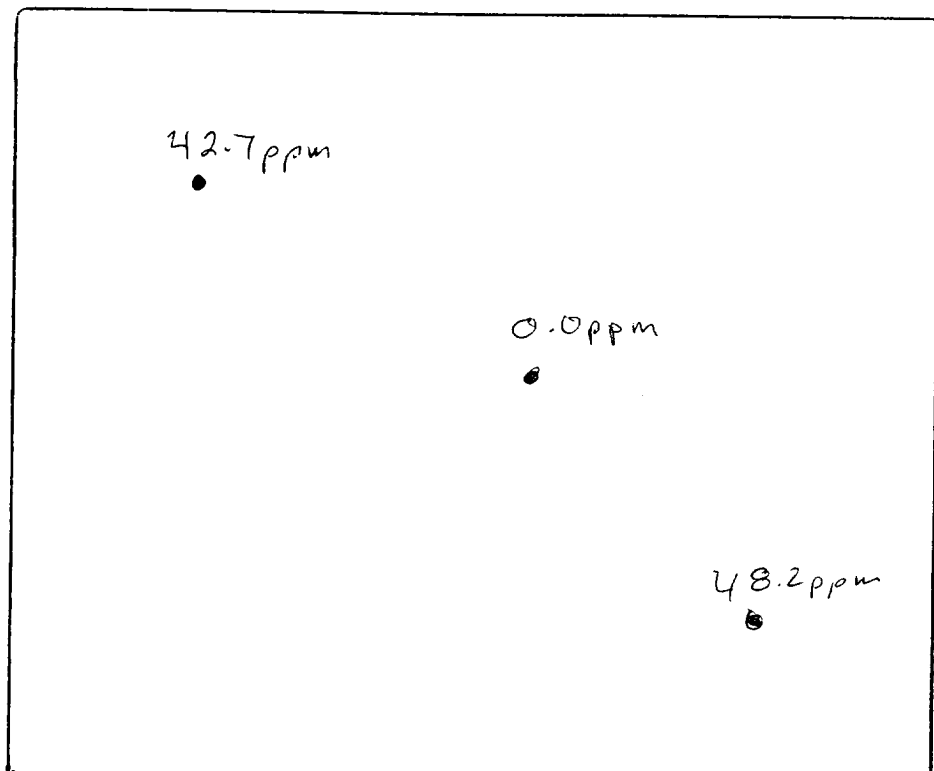

42'

Well  
Head on  
Jicarilla Apache Tribal 151-8E

51'

36'

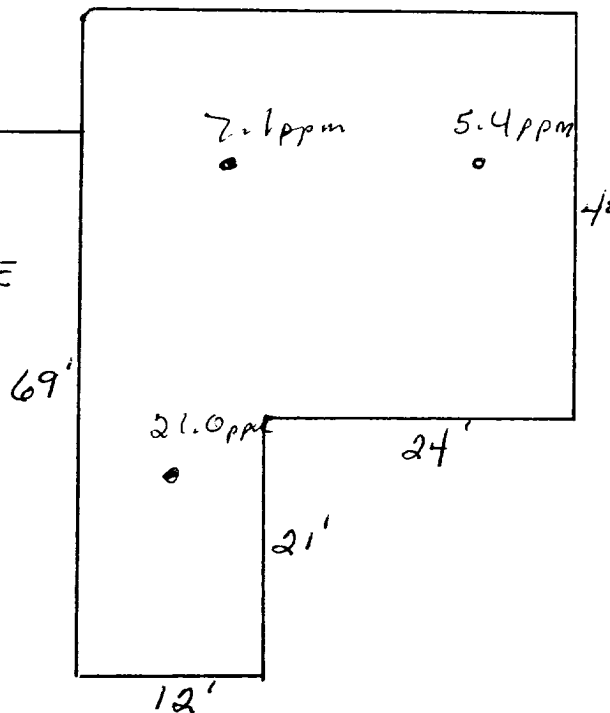

OFF: (505) 325-5667



LAB: (505) 325-1556

**On Site Technologies, LTD.**

**Date:** 10-Sep-98

---

**CLIENT:** PNM - Public Service Company of NM  
**Project:** Jicarilla Landfarms  
**Lab Order:** 9808064

---

## **CASE NARRATIVE**

Samples were analyzed using the methods outlined in the following references:

Test Methods for Evaluating Solid Waste, Physical/Chemical Methods, SW846, 3rd Edition

All method blanks, laboratory spikes, and/or matrix spikes met quality assurance objectives.

OFF: (505) 325-5667



LAB: (505) 325-1556

## ANALYTICAL REPORT

Date: 10-Sep-98

<b>Client:</b>	PNM - Public Service Company of NM	<b>Client Sample Info:</b>	Jic. Apache Tribal 151-8E Drip L
<b>Work Order:</b>	9808064	<b>Client Sample ID:</b>	9808310933; 6pt. Comp
<b>Lab ID:</b>	9808064-08A	<b>Matrix:</b>	SOIL
<b>Project:</b>	Jicarilla Landfarms	<b>Collection Date:</b>	8/31/98 9:33:00 AM
		<b>COC Record:</b>	7435

Parameter	Result	PQL	Qual	Units	DF	Date Analyzed
<b>DIESEL RANGE ORGANICS</b>		<b>SW8015</b>				Analyst: HR
T/R Hydrocarbons: C10-C28	26	25		mg/Kg	1	9/3/98

**Qualifiers:**

- PQL - Practical Quantitation Limit
- ND - Not Detected at Practical Quantitation Limit
- J - Analyte detected below Practical Quantitation Limit
- B - Analyte detected in the associated Method Blank

- S - Spike Recovery outside accepted recovery limits
- R - RPD outside accepted recovery limits
- E - Value above quantitation range
- Surr: - Surrogate

P.O. BOX 2606 • FARMINGTON, NM 87499

- TECHNOLOGY BLENDING INDUSTRY WITH THE ENVIRONMENT -