

Jimmy E. Faust
DEPUTY OIL & GAS INSPECTOR

FEB 08 1999

JICARILLA APACHE TRIBE

ENVIRONMENTAL PROTECTION OFFICE

P.O. BOX 507
DULCE, NEW MEXICO 87528

SUBMIT 1 COPY TO
NATURAL
RESOURCE DEPT
AND OIL-GAS
ADMINISTRATION

Approved

PIT REMEDIATION AND CLOSURE REPORT

Operator: PNM Gas Services (*Burlington*) Telephone: 324-3764

Address: 603 W. Elm Street Farmington, NM 87401

Facility or Well Name: *Jicarilla J21*

Location: Unit: *K* Sec. *35* T. *26 N* R. *5 W* County *Rio Arriba*

Pit Type: Separator _____ Dehydrator _____ Other *Manual drip blowdown*

Land Type: *Jicarilla Apache*

Pit Location: Pit dimensions: length *20'* width *20'* depth *3'*

(Attach diagram) Reference: wellhead *K* other _____

Footage from reference: *100'*

Direction from reference: *80* Degrees _____ East _____ North _____
of
K West *→* South *K*

Depth to Ground Water:

(Vertical distance from contaminants to seasonal high water elevation of ground water)

Less than 50 feet	(20 points)	
50 feet to 99 feet	(10 points)	<i>0</i>
Greater than 100 feet	(0 points)	

Wellhead Protection Area:

(Less than 200 feet from a private domestic water source, or; less than 1,000 feet from all other water sources)

Yes	(20 points)	<i>0</i>
No	(0 points)	

Distance to Surface Water:

(Horizontal distance to perennial lakes, ponds, rivers, streams, creeks, irrigation canals and ditches)

Less than 200 feet	(20 points)	
200 feet to 1,000 feet	(10 points)	<i>0</i>
Greater than 1,000 feet	(0 points)	

Distance to Ephemeral Stream (dry wash):

(Horizontal distance to all downgradient streams having a width of at least 10 feet)

Less than or equal to 100 feet	(10 points)	
Greater than 100 feet	(0 points)	<i>0</i>

Distance to Nearest Lake, Playa, or Watering Pond:

(Horizontal distance to all downgradient lakes, playas, and livestock or wildlife water ponds)

Less than or equal to 100 feet	(10 points)	
Greater than 100 feet	(0 points)	<i>0</i>

RANKING SCORE (TOTAL POINTS): *0*

Date Remediation Started: 10-5-98 Date Completed: 12/21/98

Remediation Method: Excavation X Approx. Cubic Yards 455

(Check all appropriate sections)

Landfarmed X Amount Landfarmed (cubic yds): 455

Other _____

Remediation Location: Onsite X Offsite _____

(i.e., landfarmed onsite, name and location of offsite facility)

General Description of Remedial Action:

Removal of contaminated soil from all four side walls as to get a below 100 ppm head space reading. The bottom is rock.
Final excavation dimensions: 32'(N+S) X 32'(E+W) X 12'(D)

Ground Water Encountered: No X Yes _____ Depth _____

Final Pit Closure Sampling:

Sample Location North, east, south and west side walls and a three point composite of the rock bottom

(if multiple samples, attach sample result and diagram of sample locations and depths.)

Sample depth 12'

Sample date 10-5-98 Sample time 1600 1555

Sample Results

Soil: Benzene (ppm) N/D Water: Benzene (ppb) _____

Total BTEX (ppm) 0.807 Toluene (ppb) _____

Field headspace (ppm) 142 Ethylbenzene (ppb) _____

TPH 130 ppm Method 8015 Total Xylenes (ppb) _____

Ground Water Sample: Yes _____ No X (If yes, attach sample results)

I HEREBY CERTIFY THAT THE INFORMATION ABOVE IS TRUE AND COMPLETE TO THE BEST OF MY KNOWLEDGE AND MY BELIEF

DATE 10-20-98 PRINTED NAME Ray Haston

SIGNATURE Ray Haston AND TITLE Environmental Technician

AFTER REVIEW OF THE PIT CLOSURE INFORMATION, PIT CLOSURE IS APPROVED IN ACCORDANCE TO JICARILLA APACHE TRIBE PIT CLOSURE ORDINANCE.

APPROVED: YES X NO _____ (REASON): _____

SIGNED: Ken C M... 11-2-98 DATE: 11-2-98

J. Carville J 21
(K) 35-26N-5W
Burlington
10-5-98

↑
N

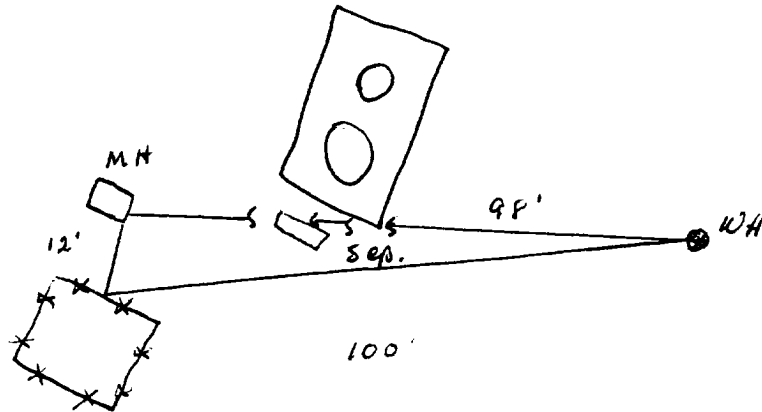

Excavation Sampling

32'(N+S) x 32'(E+W) x 12'(D)

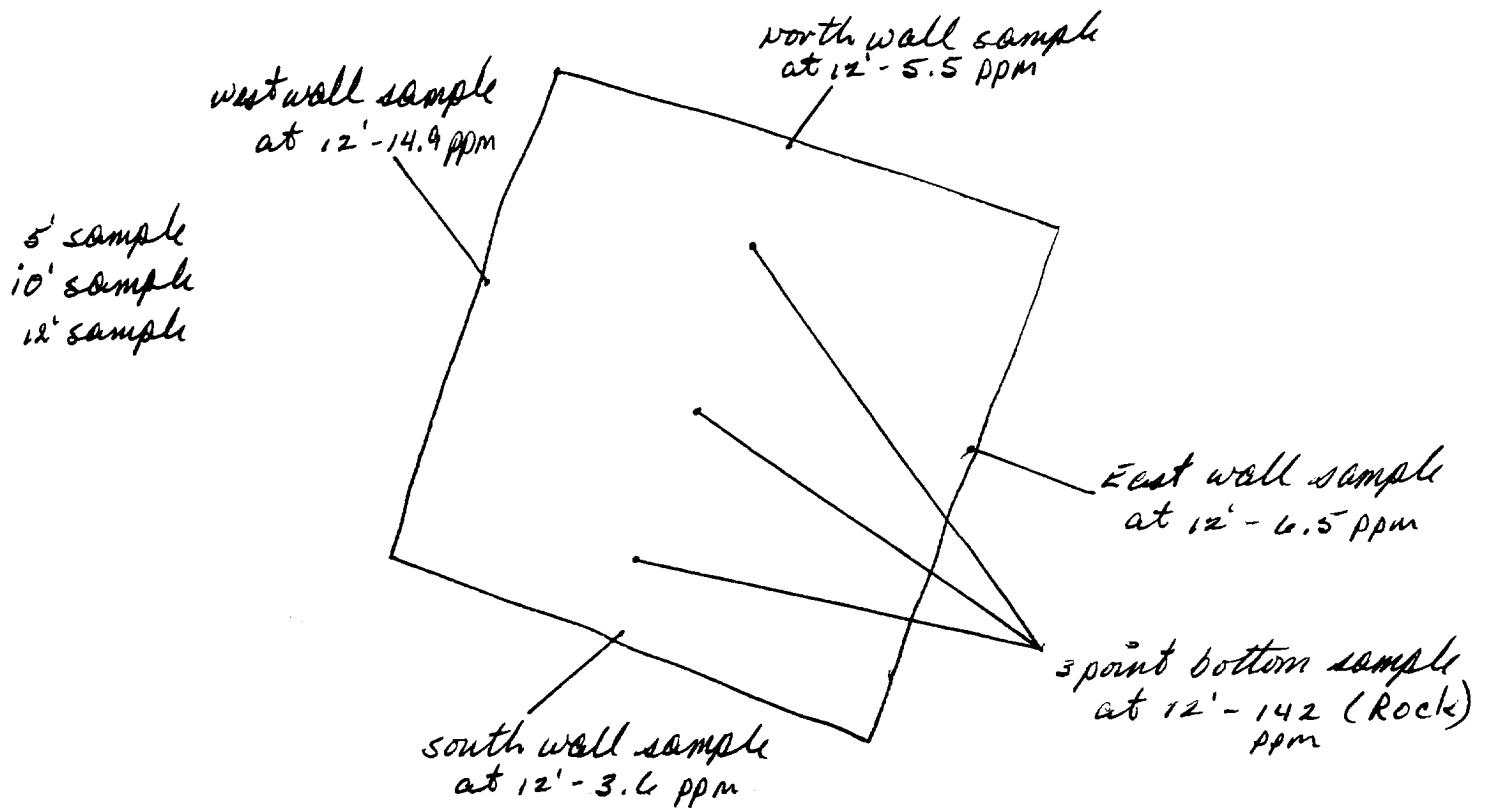

not to scale

OFF: (505) 325-5667



LAB: (505) 325-1556

On Site Technologies, LTD.

Date: 19-Oct-98

CLIENT: PNM - Public Service Company of NM
Project: Jicarilla Pit Remediation
Lab Order: 9810025

CASE NARRATIVE

Samples were analyzed using the methods outlined in the following references:

Test Methods for Evaluating Solid Waste, Physical/Chemical Methods, SW846, 3rd Edition

All method blanks, laboratory spikes, and/or matrix spikes met quality assurance objectives.

OFF: (505) 325-5667



LAB: (505) 325-1556

ANALYTICAL REPORT**Date:** 19-Oct-98

Client:	PNM - Public Service Company of NM	Client Sample Info:	Jicarilla J21
Work Order:	9810025	Client Sample ID:	9810051555; 3pt. Comp Bottom
Lab ID:	9810025-05A	Matrix:	SOIL
Project:	Jicarilla Pit Remediation	Collection Date:	10/5/98 3:55:00 PM
		COC Record:	5758

Parameter	Result	PQL	Qual	Units	DF	Date Analyzed
DIESEL RANGE ORGANICS		SW8015				Analyst: HR
T/R Hydrocarbons: C10-C28	130	25		mg/Kg	1	10/16/98
BTEX		SW8020A				Analyst: DC
Benzene	ND	5		µg/Kg	5	10/15/98
Toluene	47	10		µg/Kg	5	10/15/98
Ethylbenzene	30	5		µg/Kg	5	10/15/98
m,p-Xylene	520	10		µg/Kg	5	10/15/98
o-Xylene	210	5		µg/Kg	5	10/15/98

807
• 807 ppm

Qualifiers:

PQL - Practical Quantitation Limit

S - Spike Recovery outside accepted recovery limits

ND - Not Detected at Practical Quantitation Limit

R - RPD outside accepted recovery limits

J - Analyte detected below Practical Quantitation Limit

E - Value above quantitation range

B - Analyte detected in the associated Method Blank

Surr: - Surrogate

1 of 1

P.O. BOX 2606 • FARMINGTON, NM 87499

- TECHNOLOGY BLENDING INDUSTRY WITH THE ENVIRONMENT -

OFF: (505) 325-5667



LAB: (505) 325-1556

ANALYTICAL REPORT

Date: 19-Oct-98

Client:	PNM - Public Service Company of NM	Client Sample Info:	Jicarilla J21
Work Order:	9810025	Client Sample ID:	9810051600; 4pt. Comp Walls
Lab ID:	9810025-06A	Matrix:	SOIL
Project:	Jicarilla Pit Remediation	Collection Date:	10/5/98 4:00:00 PM
		COC Record:	5758

Parameter	Result	PQL	Qual	Units	DF	Date Analyzed
DIESEL RANGE ORGANICS		SW8015				
T/R Hydrocarbons: C10-C28	ND	25		mg/Kg	1	Analyst: HR 10/13/98

Qualifiers:

PQL - Practical Quantitation Limit

ND - Not Detected at Practical Quantitation Limit

J - Analyte detected below Practical Quantitation Limit

B - Analyte detected in the associated Method Blank

S - Spike Recovery outside accepted recovery limits

R - RPD outside accepted recovery limits

E - Value above quantitation range

Surr: - Surrogate

P.O. BOX 2606 • FARMINGTON, NM 87499

- TECHNOLOGY BLENDING INDUSTRY WITH THE ENVIRONMENT -

1 of 1

JICARILLA APACHE TRIBE
ENVIRONMENTAL
PROTECTION OFFICE
P.O. BOX 507
DULCE, NEW MEXICO 87528

SUBMIT 1 COPY TO
NATURAL
RESOURCE DEPT
AND OIL GAS
ADMINISTRATION

ON-SITE SOIL REMEDIATION REPORT

Operator: PNM Gas Services (<u>Burlington</u>) Telephone: <u>324-3764</u>	
Address: <u>603 W. Elm Street Farmington, NM 87401</u>	
Facility or Well Name: <u>Jicarilla J21</u>	
Location:	Unit: <u>K</u> Sec. <u>35</u> T. <u>26N</u> R. <u>5</u> W County <u>Rio Arriba</u>
Land Type: <u>Jicarilla Apache</u>	
Date Remediation Started: <u>10-5-98</u> Date Completed: <u>12-3-98</u>	
Remediation Method: Landfarmed <input checked="" type="checkbox"/> Approx. cubic yards <u>455</u>	
Composted <input type="checkbox"/> Other <u>Excavation was back filled from Borrao P.T. Landfarm blacked in to location.</u>	
Depth to Ground Water: (pts.) <u>0</u>	Final Closure Sampling: Sampling Date: <u>11-30-98</u> Time <u>1130</u> Sampling Results: Field Headspace (ppm) <u>2.9</u> TPH (ppm) <u>170</u> Method <u>8015</u> Other _____
Distance to an Ephemeral Stream: (pts.) <u>0</u>	
Distance to Nearest Lake, Playa, or Watering Pond: (pts.) <u>0</u>	
Wellhead Protection Area: (pts.) <u>0</u>	
Distance to Surface Water: (pts.) <u>0</u>	
Ranking Score (Total Points): <u>0</u>	
I HEREBY CERTIFY THAT THE INFORMATION ABOVE IS TRUE AND COMPLETE TO THE BEST OF MY KNOWLEDGE AND BELIEF	
DATE <u>12-16-98</u>	PRINTED NAME <u>Roy Dunham</u> <u>Ray Haston</u>
SIGNATURE <u>Ray Haston</u>	AND TITLE <u>Environmental Technician III</u>
AFTER REVIEW OF THE SOIL REMEDIATION INFORMATION, ON-SITE REMEDIATION APPROVED IN ACCORDANCE TO THE JICARILLA APACHE TRIBE PIT CLOSURE ORDINANCE	
APPROVED: YES <input checked="" type="checkbox"/> NO <input type="checkbox"/> (REASON) <u>NO Backfill</u>	
SIGNED: <u>Kent Mamm</u>	DATE: <u>12-21-98</u>

Jicarilla J21
(K) 35-26N-5W
Burlington
455 yds.

N
↑

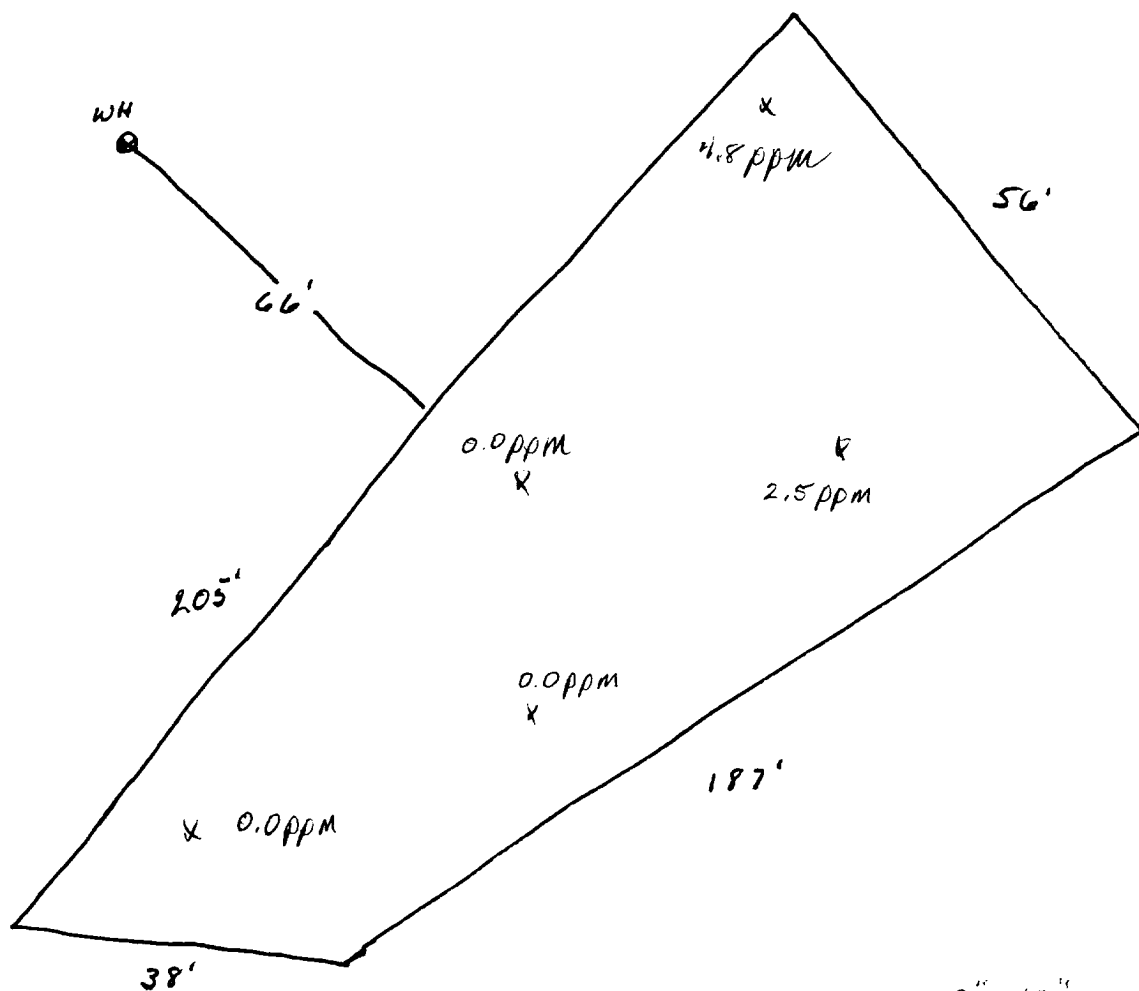

2" - 12"

Head space - 2.9 ppm

not to scale

OFF: (505) 325-5667



LAB: (505) 325-1556

On Site Technologies, LTD.

Date: 04-Dec-98

CLIENT: PNM - Public Service Company of NM
Project: Jicarilla Pit Remediation Landfarms
Lab Order: 9812001

CASE NARRATIVE

Samples were analyzed using the methods outlined in the following references:

Test Methods for Evaluating Solid Waste, Physical/Chemical Methods, SW846, 3rd Edition

All method blanks, laboratory spikes, and/or matrix spikes met quality assurance objectives.

OFF: (505) 325-5667



LAB: (505) 325-1556

ANALYTICAL REPORT

Date: 04-Dec-98

Client:	PNM - Public Service Company of NM	Client Sample Info:	Jicarilla J-21 LF
Work Order:	9812001	Client Sample ID:	9811301130; 6pt. Composite
Lab ID:	9812001-03A	Matrix:	SOIL
Project:	Jicarilla Pit Remediation Landfarms	Collection Date:	11/30/98 11:30:00 AM
		COC Record:	7444

Parameter	Result	PQL	Qual	Units	DF	Date Analyzed
DIESEL RANGE ORGANICS		SW8015				Analyst: HR
T/R Hydrocarbons: C10-C28	170	25		mg/Kg	1	12/3/98

Qualifiers:

PQL - Practical Quantitation Limit

ND - Not Detected at Practical Quantitation Limit

J - Analyte detected below Practical Quantitation Limit

B - Analyte detected in the associated Method Blank

S - Spike Recovery outside accepted recovery limits

R - RPD outside accepted recovery limits

E - Value above quantitation range

Surr: - Surrogate

P.O. BOX 2606 • FARMINGTON, NM 87499

- TECHNOLOGY BLENDING INDUSTRY WITH THE ENVIRONMENT -

1 of 1