

Denny S. Faust
DEPUTY OIL & GAS INSPECTOR

FEB 08 1999

Approved

JICARILLA APACHE TRIBE

ENVIRONMENTAL PROTECTION OFFICE

P.O. BOX 507
DULCE, NEW MEXICO 87528

SUBMIT ONE COPY
TO NATURAL
RESOURCE DEPT
AND OIL- GAS
ADMINISTRATION

PIT REMEDIATION AND CLOSURE REPORT

Operator: PNM Gas Services (CONOCO) Telephone: 324-3764

Address: 603 W. Elm Street Farmington, NM 87401

Facility or Well Name: Jicarilla B15

Location: Unit J Sec 36 T 26 N R 4 W County Rio Arriba

Pit Type: Separator ☒ Dehydrator ☐ Other _____

Land Type: Jicarilla Apache

Pit Location: Pit dimensions: Length 20 ' Width 20 ' Depth 3 '

(Attach diagram) Reference: Wellhead ☒ Other _____

Footage from reference: 115'

Direction from reference: 85 degrees ☐ East or ☐ North
☒ West ☒ South

Depth to Ground Water:

(Vertical distance from contaminants to seasonal
high water elevation of ground water)

Less than 50 feet	(20 points)	
50 feet to 99 feet	(10 points)	
Greater than 100 feet	(0 points)	<u>0</u>

Wellhead Protection Area:

(Less than 200 feet from a private domestic water source,
or, less than 1,000 feet from all other water sources)

Yes	(20 points)	
No	(0 points)	<u>0</u>

Distance to Surface Water:

(Horizontal distance to perennial lakes, ponds, rivers,
streams, creeks, irrigation canals and ditches)

Less than 200 feet	(20 points)	
200 feet to 1,000 feet	(10 points)	
Greater than 100 feet	(0 points)	<u>0</u>

Distance to Ephemeral Stream (dry wash):

(Horizontal distance to all downgradient streams having a width
of at least 10 feet)

Less than or equal to 100 feet	(10 points)	
Greater than 100 feet	(0 points)	<u>10</u>

Distance to Nearest Lake, Playa, or Watering Pond:

(Horizontal distance to all downgradient lakes, playas,
and livestock or wildlife water ponds)

Less than or equal to 100 feet	(10 points)	
Greater than 100 feet	(0 points)	<u>0</u>

RANKING SCORE (TOTAL POINTS): 10

Date Remediation Started: 11/3/98 Date Completed: 12/21/98

Remediation Method: Excavation ☒ Approx. Cubic Yards 248

(Check all appropriate sections) Landfarmed ☒ Amount Landfarmed (cubic yds) 248

Other _____

Remediation Location: Onsite ☒ Offsite _____

(i.e., landfarmed onsite, name and location of offsite facility)

General Description of Remedial Action:

Removal of contaminated soil from all four sidewalls, as to get a below 100 ppm head space reading.
Bottom is rock.

Final excavation dimensions: 33'(N&S)X29'(E&W)X7'(D)

Ground Water Encountered: No ☒ Yes ☐ Depth _____

Final Pit Closure Sampling: Sample Location Composite of North, East, South, and West sidewalls and a three point composite of rock bottom.

(If multiple samples, attach sample result and diagram of sample locations and depths.)

Sample depth 7'

Sample date 11/4/98 Sample time 0835 0830

Sample Results

Soil: Benzene (ppm) ND

Water: Benzene (ppb) _____

Total BTEX (ppm) 0.003

Toluene (ppb) _____

Field headspace (ppm) 89.2

Ethylbenzene (ppb) _____

TPH (ppm) ND

Method 8015

Total Xylenes (ppb) _____

Vertical Extent (ft) 7'

Risk Analysis form attached: Yes ☐ No ☒

Ground Water Sample: Yes ☐ No ☒ (If yes, see attached Groundwater Site Summary Report)

I HEREBY CERTIFY THAT THE INFORMATION ABOVE IS TRUE AND COMPLETE TO THE BEST OF MY KNOWLEDGE AND MY BELIEF.

DATE: 11-20-98

PRINTED NAME Ray Haston

SIGNATURE Ray Haston

TITLE Environmental Tech. III

AFTER REVIEW OF THE PIT CLOSURE INFORMATION, PIT CLOSURE IS APPROVED IN ACCORDANCE TO JICARILLA APACHE TRIBE PIT CLOSURE ORDINANCE:

APPROVED: YES ☒ NO ☐ (REASON): _____

SIGNATURE: Ken C. M...

DATE: 11-30-98

Jicarilla B15
 (J) 36-26N-4W
 CONOCO
 11-3-98

N

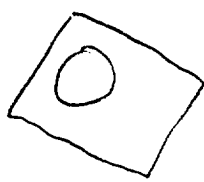
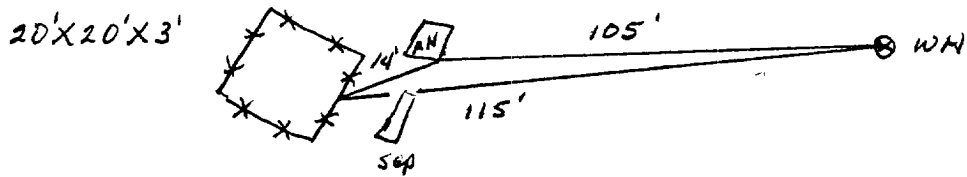

Excavation Sampling

33'(N45) x 29'(E+W) x 7'(D)

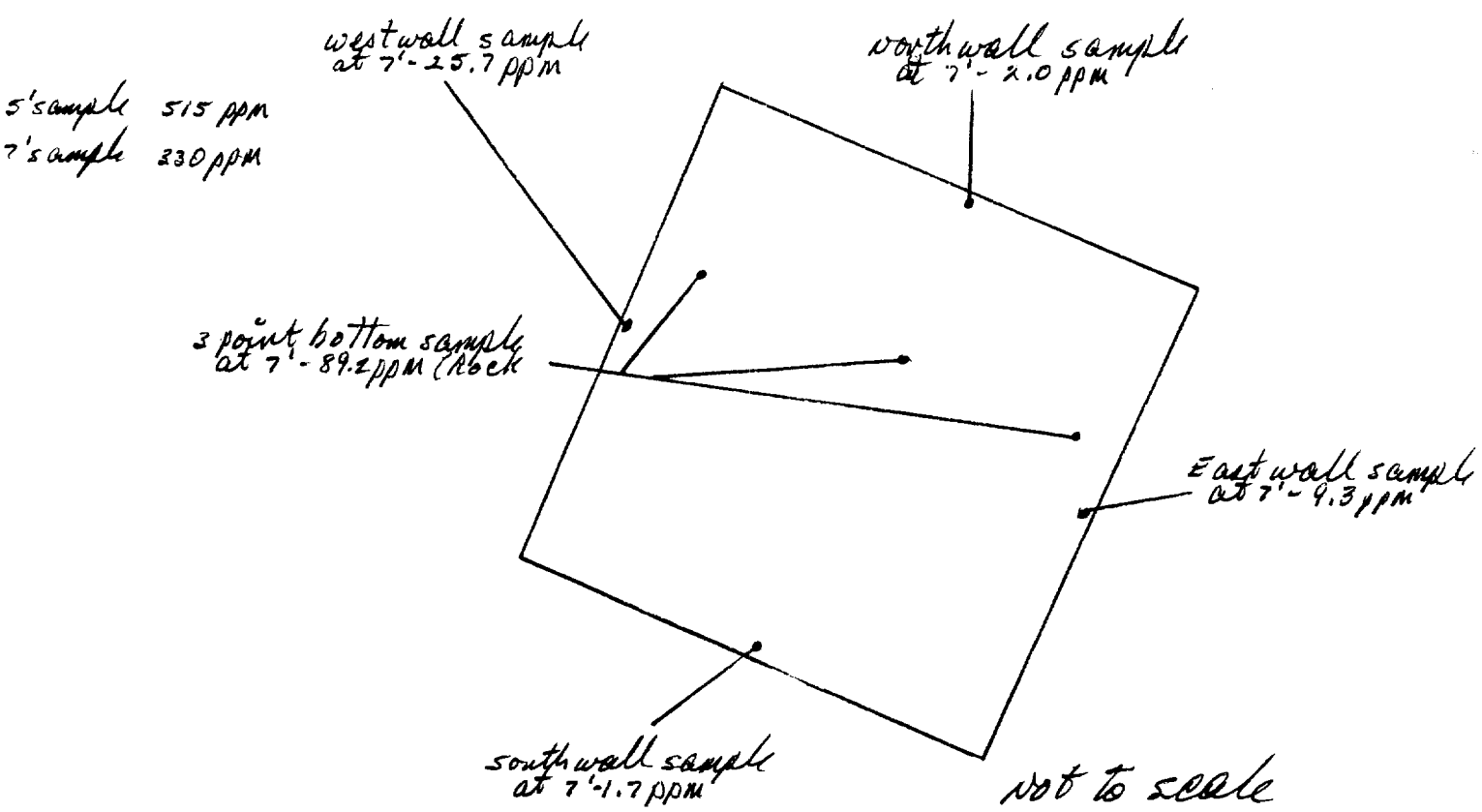

OFF: (505) 325-5667



LAB: (505) 325-1556

On Site Technologies, LTD.

Date: 16-Nov-98

CLIENT: PNM - Public Service Company of NM

Project: Jicarilla B15

Lab Order: 9811018

CASE NARRATIVE

Samples were analyzed using the methods outlined in the following references:

Test Methods for Evaluating Solid Waste, Physical/Chemical Methods, SW846, 3rd Edition

All method blanks, laboratory spikes, and/or matrix spikes met quality assurance objectives.

OFF: (505) 325-5667



LAB: (505) 325-1556

ANALYTICAL REPORT**Date:** 16-Nov-98

Client:	PNM - Public Service Company of NM	Client Sample Info:	Jicarilla B15
Work Order:	9811018	Client Sample ID:	9811040830; 3pt Bottom Comp
Lab ID:	9811018-01A	Matrix:	SOIL
Project:	Jicarilla B15	Collection Date:	11/4/98 8:30:00 AM
		COC Record:	5773

Parameter	Result	PQL	Qual	Units	DF	Date Analyzed
DIESEL RANGE ORGANICS		SW8015				Analyst: HR
T/R Hydrocarbons: C10-C28	ND	25		mg/Kg	1	11/11/98
BTEX		SW8020A				Analyst: HR
Benzene	ND	1		µg/Kg	1	11/7/98
Toluene	ND	2		µg/Kg	1	11/7/98
Ethylbenzene	ND	1		µg/Kg	1	11/7/98
m,p-Xylene	2.1	2		µg/Kg	1	11/7/98
o-Xylene	1.1	1		µg/Kg	1	11/7/98

3.2
0032 ppm

Qualifiers:

PQL - Practical Quantitation Limit

S - Spike Recovery outside accepted recovery limits

ND - Not Detected at Practical Quantitation Limit

R - RPD outside accepted recovery limits

J - Analyte detected below Practical Quantitation Limit

E - Value above quantitation range

B - Analyte detected in the associated Method Blank

Surr: - Surrogate

P.O. BOX 2606 • FARMINGTON, NM 87499*1 of 1**- TECHNOLOGY BLENDING INDUSTRY WITH THE ENVIRONMENT -*

OFF: (505) 325-5667



LAB: (505) 325-1556

ANALYTICAL REPORT

Date: 16-Nov-98

Client:	PNM - Public Service Company of NM	Client Sample Info:	Jicarilla B15
Work Order:	9811018	Client Sample ID:	9811040835; 4pt. Wall Comp
Lab ID:	9811018-02A	Matrix:	SOIL
Project:	Jicarilla B15	Collection Date:	11/4/98 8:35:00 AM
		COC Record:	5773

Parameter	Result	PQL	Qual	Units	DF	Date Analyzed
DIESEL RANGE ORGANICS		SW8015				
T/R Hydrocarbons: C10-C28	ND	25		mg/Kg	1	Analyst: HR 11/11/98

Qualifiers:	PQL - Practical Quantitation Limit	S - Spike Recovery outside accepted recovery limits
	ND - Not Detected at Practical Quantitation Limit	R - RPD outside accepted recovery limits
	J - Analyte detected below Practical Quantitation Limit	E - Value above quantitation range
	B - Analyte detected in the associated Method Blank	Surr: - Surrogate

P.O. BOX 2606 • FARMINGTON, NM 87499

- TECHNOLOGY BLENDING INDUSTRY WITH THE ENVIRONMENT -

1 of 1

JICARILLA APACHE TRIBE
ENVIRONMENTAL
PROTECTION OFFICE
P.O. BOX 507
DULCE, NEW MEXICO 87528

SUBMIT 1 COPY TO
NATURAL
RESOURCE DEPT
AND OIL GAS
ADMINISTRATION

ON-SITE SOIL REMEDIATION REPORT

Operator: PNM Gas Services (CONOCO) Telephone: 324-3764

Address: 603 W. Elm Street Farmington, NM 87401

Facility or Well Name: Jicarilla B15

Location: Unit: J Sec. 36 T. 26 N R. 4 W County Rio Arriba

Land Type: Jicarilla Apache

Date Remediation Started: 11-3-98 Date Completed: 12-11-98

Remediation Method: Landfarmed Approx. cubic yards 248
Composted
Other

Depth to Ground Water: (pts.) 0

Distance to an Ephemeral Stream: (pts.) 10

Distance to Nearest Lake, Playa,
or Watering Pond: (pts.) 0

Wellhead Protection Area: (pts.) 0

Distance to Surface Water: (pts.) 0

Ranking Score (Total Points): 10

Final Closure Sampling:

Sampling Date: 12-9-98 Time 0739

Sampling Results:

Field Headspace (ppm) 2.2

TPH (ppm) 29 Method 8015

Other

I HEREBY CERTIFY THAT THE INFORMATION ABOVE IS TRUE AND COMPLETE TO THE BEST OF MY KNOWLEDGE AND BELIEF

DATE 12-16-98 PRINTED NAME ~~Roy Burnham~~ Ray Haston

SIGNATURE Ray Haston AND TITLE Environmental Technician III

AFTER REVIEW OF THE SOIL REMEDIATION INFORMATION, ON-SITE REMEDIATION APPROVED IN ACCORDANCE TO THE
JICARILLA APACHE TRIBE PIT CLOSURE ORDINANCE

APPROVED: YES X NO (REASON) use as Backfill

SIGNED: Kate C. M...ll DATE: 12-21-98

↑
N

Jicarilla B15
(J) 36-26N-4W
CONOCO

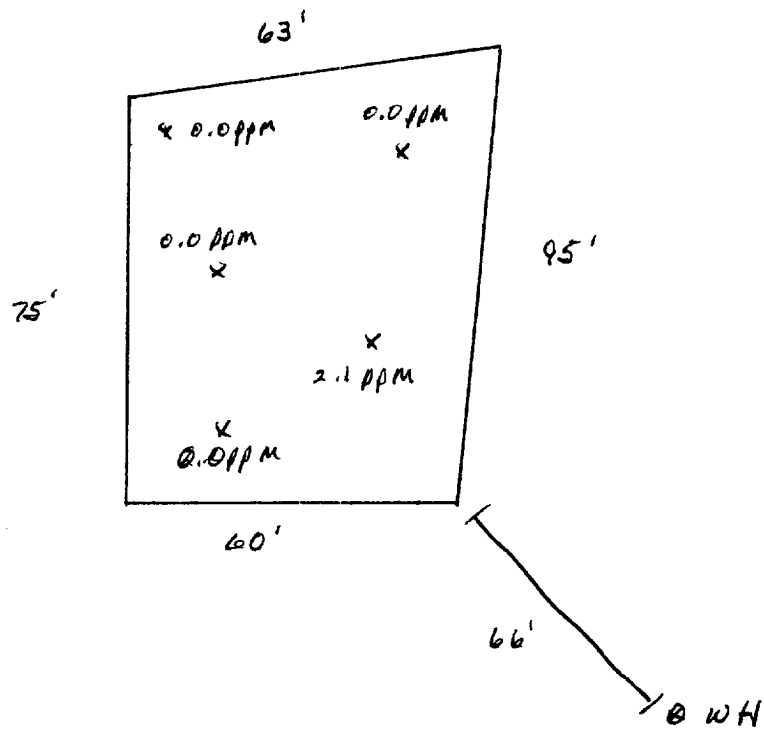

2" - 12"
Head space: 2.2 ppm

not to scale

OFF: (505) 325-5667



LAB: (505) 325-1556

On Site Technologies, LTD.

Date: 15-Dec-98

CLIENT: PNM - Public Service Company of NM
Project: Jicarilla Pit Remediation
Lab Order: 9812016

CASE NARRATIVE

Samples were analyzed using the methods outlined in the following references:

Test Methods for Evaluating Solid Waste, Physical/Chemical Methods, SW846, 3rd Edition

All method blanks, laboratory spikes, and/or matrix spikes met quality assurance objectives.

OFF: (505) 325-5667



LAB: (505) 325-1556

ANALYTICAL REPORT

Date: 15-Dec-98

Client:	PNM - Public Service Company of NM	Client Sample Info:	Jicarilla B-15 LF
Work Order:	9812016	Client Sample ID:	9812090739 6pt Composite
Lab ID:	9812016-03A	Matrix:	SOIL
Project:	Jicarilla Pit Remediation	Collection Date:	12/9/98 7:39:00 AM
		COC Record:	7448

Parameter	Result	PQL	Qual	Units	DF	Date Analyzed
DIESEL RANGE ORGANICS		SW8015				
T/R Hydrocarbons: C10-C28	29	25		mg/Kg	1	Analyst: HR 12/11/98

Qualifiers:

- PQL - Practical Quantitation Limit
- ND - Not Detected at Practical Quantitation Limit
- J - Analyte detected below Practical Quantitation Limit
- B - Analyte detected in the associated Method Blank

- S - Spike Recovery outside accepted recovery limits
- R - RPD outside accepted recovery limits
- E - Value above quantitation range
- Surr: - Surrogate

P.O. BOX 2606 • FARMINGTON, NM 87499

- TECHNOLOGY BLENDING INDUSTRY WITH THE ENVIRONMENT -

1 of 1