

**DEPUTY OIL & GAS INSPECTOR**

FEB 08 1999

Approved  
PIT

## JICARILLA APACHE TRIBE

ENVIRONMENTAL PROTECTION OFFICE

P.O. BOX 507  
DULCE, NEW MEXICO 87528

SUBMIT 1 COPY TO  
NATURAL  
RESOURCE DEPT  
AND OIL GAS  
ADMINISTRATION

# PIT REMEDIATION AND CLOSURE REPORT

Operator: PNM Gas Services (BROG) Telephone: 324-3764

Address: 603 W. Elm Street Farmington, NM 87401

Facility or Well Name: JICARILLA G-8E

Location: Unit: I Sec. 2 T. 26 N R. 5 W County Rio Arriba

Pit Type: Separator      Dehydrator X Other     

Land Type: Jicarilla Apache

**Pit Location:** Pit dimensions: length 20 width 20 depth 3  
(Attach diagram) Reference: wellhead X other \_\_\_\_\_  
Footage from reference: 90'  
Direction from reference: 45 Degrees \_\_\_\_\_ East \_\_\_\_\_ North \_\_\_\_\_  
West \_\_\_\_\_ of \_\_\_\_\_ South \_\_\_\_\_

(Vertical distance from contaminants to seasonal high water elevation of ground water)

Less than 50 feet	(20 points)
50 feet to 99 feet	(10 points)
Greater than 100 feet	( 0 points)

(Less than 200 feet from a private domestic water source, or; less than 1,000 feet from all other water sources)

Yes (20 points)  
No ( 0 points)

(Horizontal distance to perennial lakes, ponds, rivers, streams, creeks, irrigation canals and ditches)

Less than 200 feet	(20 points)
200 feet to 1,000 feet	(10 points)
Greater than 1,000 feet	( 0 points)

(Horizontal distance to all downgradient streams having a width of at least 10 feet)

Less than or equal to 100 feet	(10 points)
Greater than 100 feet	(0 points)

(Horizontal distance to all downgradient lakes, playas, and livestock or wildlife water ponds)

Less than or equal to 100 feet	(10 points)
Greater than 100 feet	(0 points)

**RANKING SCORE (TOTAL POINTS) :**

Date Remediation Started:

4/30/98

Date Completed:

5/13/98

Remediation Method:

Excavation

X

Approx. Cubic Yards

337

(Check all appropriate sections)

Landfarmed

X

Amount Landfarmed (cubic yds):

337

Other \_\_\_\_\_

Remediation Location:

Onsite

X

Offsite \_\_\_\_\_

(i.e., landfarmed onsite, name and location of offsite facility)

## General Description of Remedial Action:

Removed contaminated soil from all four side walls and the bottom of the pit as to get a below 100ppm head space reading. Final excavation 23' X 22' X 18' (hrs)

Ground Water Encountered:

No

X

Yes \_\_\_\_\_

Depth \_\_\_\_\_

## Final Pit Closure Sampling:

Sample Location

North, East, South, West side walls and pit bottom

(if multiple samples, attach sample result and diagram of sample locations and depths.)

Sample depth

18'

Sample date

4/30/98

Sample time

1340

## Sample Results

Soil: Benzene (ppm) \_\_\_\_\_

Water: Benzene (ppb) \_\_\_\_\_

Total BTEX (ppm) \_\_\_\_\_

Toluene (ppb) \_\_\_\_\_

Field headspace (ppm)

59.7 (bottom)  
75.1 (south wall)

Ethylbenzene (ppb) \_\_\_\_\_

TPH 42 ppm

Method

8015

Total Xylenes (ppb) \_\_\_\_\_

Ground Water Sample:

Yes \_\_\_\_\_

No

X

(If yes, attach sample results)

I HEREBY CERTIFY THAT THE INFORMATION ABOVE IS TRUE AND COMPLETE TO THE BEST OF MY KNOWLEDGE AND MY BELIEF

DATE

5/12/98

PRINTED NAME

Roy Burnham

SIGNATURE

Roy Burnham

AND TITLE

Environmental Technician II

AFTER REVIEW OF THE PIT CLOSURE INFORMATION, PIT CLOSURE IS APPROVED IN ACCORDANCE TO JICARILLA APACHE TRIBE PIT CLOSURE ORDINANCE.

APPROVED: YES

X

NO \_\_\_\_\_

(REASON): \_\_\_\_\_

SIGNED:

Kenn C. Mamm

DATE:

5-13-98

JICARILLA G-DE  
Sec. 2 T26N R5W Unit I  
BROG

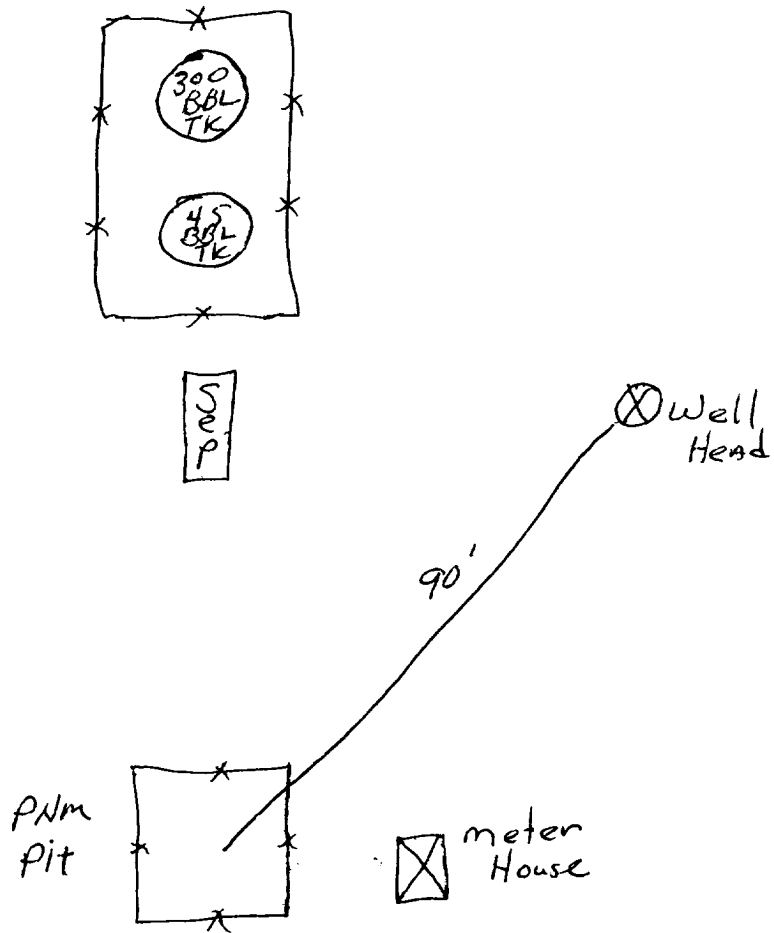

JICAT11A G-82  
Sec. 2 T26N R5W Unit I  
3 ROG

23' x 22' x 18'

# Excavation Drawing

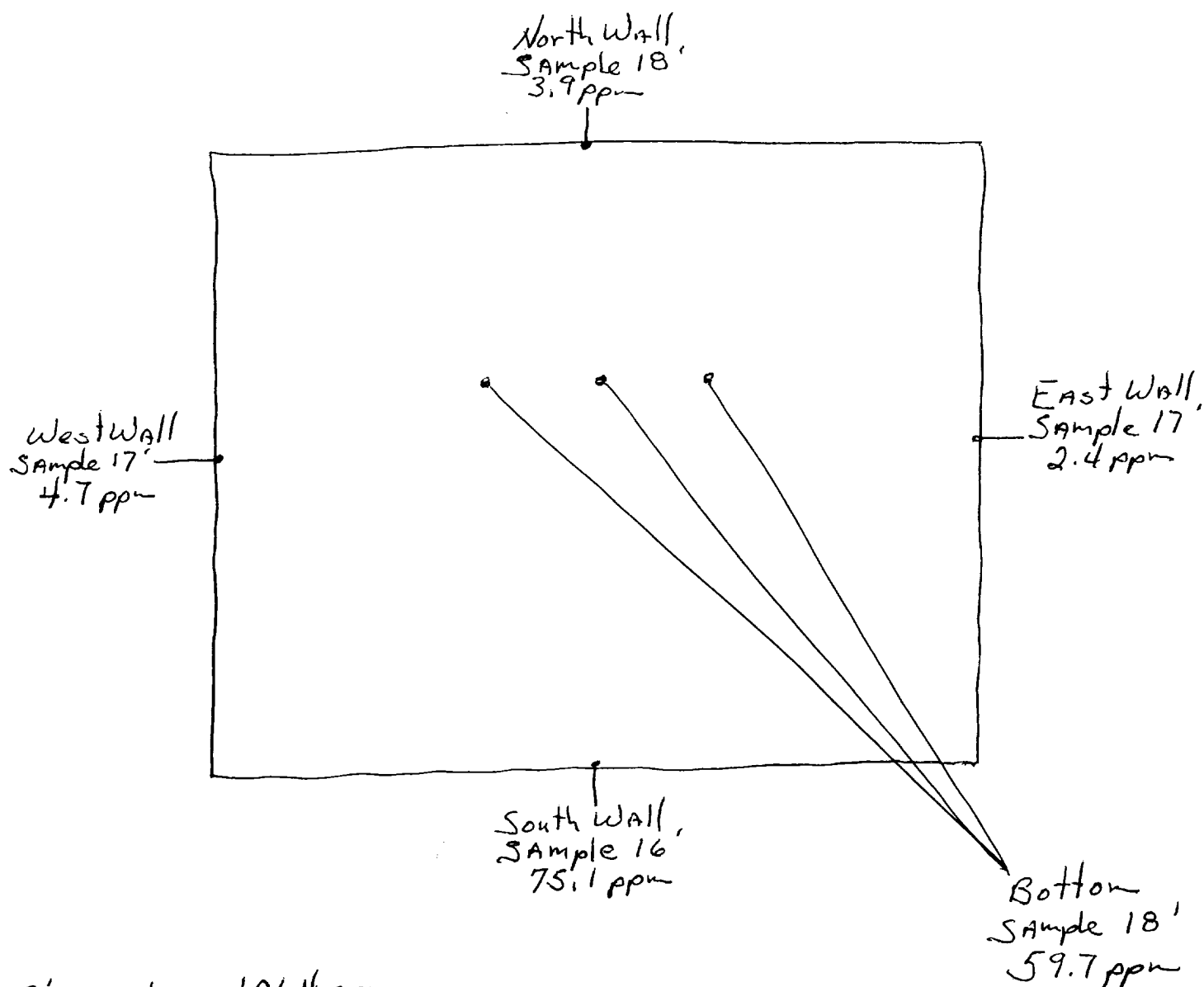

5' Sample - 1064 ppm  
10' Sample - 578 ppm  
15' Sample - 104 ppm  
18' Sample - 59.7 ppm

OFF: (505) 325-5667



LAB: (505) 325-1556

**On Site Technologies, LTD.**

**Date:** 06-May-98

---

**CLIENT:** PNM - Public Service Company of NM

**Project:** PNM Pit Remediation

**Lab Order:** 9804062

## **CASE NARRATIVE**

---

Samples were analyzed using the methods outlined in the following references:

Test Methods for Evaluating Solid Waste, Physical/Chemical Methods, SW846, 3rd Edition

All method blanks, laboratory spikes, and/or matrix spikes met quality assurance objectives.

OFF: (505) 325-5667



LAB: (505) 325-1556

## ANALYTICAL REPORT

Date: 06-May-98

**Client:** PNM - Public Service Company of NM  
**Work Order:** 9804062  
**Lab ID:** 9804062-06A    **Matrix:** SOIL  
**Project:** PNM Pit Remediation

**Client Sample Info:** Jicarilla G-8E  
**Client Sample ID:** 9804301340; 3pt. Bottom  
**Collection Date:** 4/30/98 1:40:00 PM  
**COC Record:** 7150

Parameter	Result	PQL	Qual	Units	DF	Date Analyzed
<b>DIESEL RANGE ORGANICS</b>		<b>SW8015</b>				Analyst: DC
T/R Hydrocarbons: C10-C28	42	25		mg/Kg	1	4/30/98

**Qualifiers:**

PQL - Practical Quantitation Limit

ND - Not Detected at Practical Quantitation Limit

J - Analyte detected below Practical Quantitation Limit

B - Analyte detected in the associated Method Blank

S - Spike Recovery outside accepted recovery limits

R - RPD outside accepted recovery limits

E - Value above quantitation range

Surr: - Surrogate

1 of 1

P.O. BOX 2606 • FARMINGTON, NM 87499

- TECHNOLOGY BLENDING INDUSTRY WITH THE ENVIRONMENT

OFF: (505) 325-5667



LAB: (505) 325-1556

## ANALYTICAL REPORT

Date: 06-May-98

<b>Client:</b>	PNM - Public Service Company of NM	<b>Client Sample Info:</b>	Jicarilla G-8E
<b>Work Order:</b>	9804062	<b>Client Sample ID:</b>	9804301339; 4pt. Composite
<b>Lab ID:</b>	9804062-05A	<b>Matrix:</b>	SOIL
<b>Project:</b>	PNM Pit Remediation	<b>Collection Date:</b>	4/30/98 1:39:00 PM
		<b>COC Record:</b>	7150

Parameter	Result	PQL	Qual	Units	DF	Date Analyzed
<b>DIESEL RANGE ORGANICS</b>		<b>SW8015</b>				Analyst: DC
T/R Hydrocarbons: C10-C28	ND	25		mg/Kg	1	4/30/98

**Qualifiers:**

PQL - Practical Quantitation Limit

S - Spike Recovery outside accepted recovery limits

ND - Not Detected at Practical Quantitation Limit

R - RPD outside accepted recovery limits

J - Analyte detected below Practical Quantitation Limit

E - Value above quantitation range

B - Analyte detected in the associated Method Blank

Surr: - Surrogate

1 of 1

P.O. BOX 2606 • FARMINGTON, NM 87499

- TECHNOLOGY BLENDING INDUSTRY WITH THE ENVIRONMENT -

JICARILLA APACHE TRIBE  
ENVIRONMENTAL  
PROTECTION OFFICE  
P.O. BOX 507  
DULCE, NEW MEXICO 87528

SUBMIT 1 COPY TO  
NATURAL  
RESOURCE DEPT  
AND OIL-GAS  
ADMINISTRATION

ON-SITE SOIL REMEDIATION REPORT

Operator: PNM Gas Services ( BROG ) Telephone: 324-3764  
Address: 603 W. Elm Street Farmington, NM 87401  
Facility or Well Name: Jicarilla G-8E  
Location: Unit: I Sec. 2 T. 24 N R. 5 W County Rio Arriba  
Land Type: Jicarilla Apache

Date Remediation Started: 4/30/98 Date Completed: 5/11/98  
Remediation Method: Landfarmed X Approx. cubic yards 337  
Composted —  
Other —

Depth to Ground Water: (pts.) 0  
Distance to an Ephemeral Stream: (pts.) 0  
Distance to Nearest Lake, Playa,  
or Watering Pond: (pts.) 0  
Wellhead Protection Area: (pts.) 0  
Distance to Surface Water: (pts.) 0  
Ranking Score (Total Points): 0

Final Closure Sampling:

Sampling Date: 5/7/98 Time 1245  
Sampling Results:  
Field Headspace (ppm) 85.8  
TPH (ppm) 100 Method 8015  
Other —

I HEREBY CERTIFY THAT THE INFORMATION ABOVE IS TRUE AND COMPLETE TO THE BEST OF MY KNOWLEDGE AND BELIEF

DATE 5/13/98 PRINTED NAME Roy Burnham  
SIGNATURE Roy Burnham AND TITLE Environmental Technician II

AFTER REVIEW OF THE SOIL REMEDIATION INFORMATION, ON-SITE REMEDIATION APPROVED IN ACCORDANCE TO THE  
JICARILLA APACHE TRIBE PIT CLOSURE ORDINANCE

APPROVED: YES X NO — (REASON) use as Backfill  
SIGNED: Kenneth C. Mamm DATE: 5-13-98



Section 2 T26N R5W Unit I  
3 ROG

# Land farm Drawing

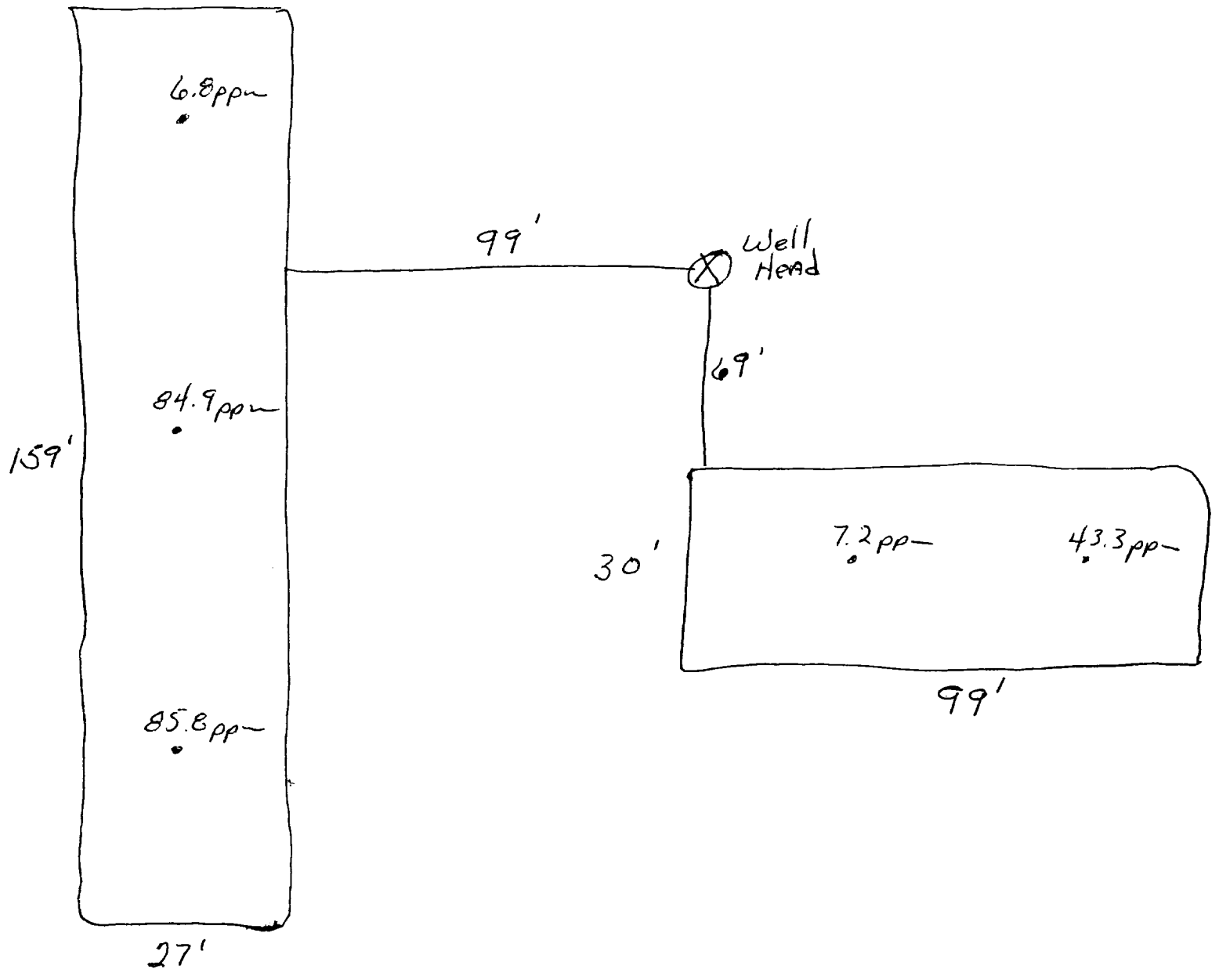

OFF: (505) 325-5667



LAB: (505) 325-1556

**On Site Technologies, LTD.**

**Date:** 12-May-98

---

**CLIENT:** PNM - Public Service Company of NM  
**Project:** PNM Pit Remediation  
**Lab Order:** 9805020

---

## **CASE NARRATIVE**

Samples were analyzed using the methods outlined in the following references:

Test Methods for Evaluating Solid Waste, Physical/Chemical Methods, SW846, 3rd Edition

All method blanks, laboratory spikes, and/or matrix spikes met quality assurance objectives.

OFF: (505) 325-5667



LAB: (505) 325-1556

## ANALYTICAL REPORT

Date: 12-May-98

<b>Client:</b>	PNM - Public Service Company of NM	<b>Client Sample Info:</b>	Jicarilla G-8E Landfarm
<b>Work Order:</b>	9805020	<b>Client Sample ID:</b>	9805071245; 5pt. Composite
<b>Lab ID:</b>	9805020-02A	<b>Matrix:</b>	SOIL
<b>Project:</b>	PNM Pit Remediation	<b>Collection Date:</b>	5/7/98 12:45:00 PM
		<b>COC Record:</b>	7145

Parameter	Result	PQL	Qual	Units	DF	Date Analyzed
<b>DIESEL RANGE ORGANICS</b>		<b>SW8015</b>				Analyst: HR
T/R Hydrocarbons: C10-C28	100	25		mg/Kg	1	5/11/98

**Qualifiers:**

PQL - Practical Quantitation Limit

ND - Not Detected at Practical Quantitation Limit

J - Analyte detected below Practical Quantitation Limit

B - Analyte detected in the associated Method Blank

S - Spike Recovery outside accepted recovery limits

R - RPD outside accepted recovery limits

E - Value above quantitation range

Surr: - Surrogate

1 of 1

P.O. BOX 2606 • FARMINGTON, NM 87499

- TECHNOLOGY BLENDING INDUSTRY WITH THE ENVIRONMENT -