

Denny S. Faust
DEPUTY OIL & GAS INSPECTOR

FEB 26 1998

JICARILLA APACHE TRIBE

ENVIRONMENTAL PROTECTION OFFICE

P.O. BOX 507
DULCE, NEW MEXICO 87528

SUBMIT 1 COPY TO
NATURAL
RESOURCE DEPT
AND OIL GAS
ADMINISTRATION

Approved

PIT REMEDIATION AND CLOSURE REPORT

Operator: PNM Gas Services (BROG) Telephone: 324-3764
Address: 603 W. Elm Street Farmington, NM 87401
Facility or Well Name: Jicarilla 10.3-12
Location: Unit: H Sec. 17 T. 24 N R. 4 W County Rio Arriba
Pit Type: Separator Dehydrator X Other
Land Type: Jicarilla Apache

Pit Location: Pit dimensions: length 23' width 22' depth 9'
(Attach diagram) Reference: wellhead X other
Footage from reference: 152'
Direction from reference: 45 Degrees East North
 West South

Depth to Ground Water:

(Vertical distance from contaminants
to seasonal high water elevation of
ground water)

Less than 50 feet (20 points)
50 feet to 99 feet (10 points)
Greater than 100 feet (0 points)

Wellhead Protection Area:

(Less than 200 feet from a private domestic
water source, or, less than 1,000 feet from all
other water sources)

Yes (20 points)
No (0 points)

Distance to Surface Water:

(Horizontal distance to perennial
lakes, ponds, rivers, streams,
creeks, irrigation canals and ditches)

Less than 200 feet (20 points)
200 feet to 1,000 feet (10 points)
Greater than 1,000 feet (0 points)

Distance to Ephemeral Stream (dry wash):

(Horizontal distance to all downgradient
streams having a width of at least 10
feet)

Less than or equal to 100 feet (10 points)
Greater than 100 feet (0 points)

**Distance to Nearest Lake, Playa, or Watering
Pond:**

(Horizontal distance to all downgradient
lakes, playas, and livestock or wildlife
water ponds)

Less than or equal to 100 feet (10 points)
Greater than 100 feet (0 points)

RANKING SCORE (TOTAL POINTS):

Date Remediation Started: 7/8/97 Date Completed: 8/27/97

Remediation Method: Excavation X Approx. Cubic Yards 169

(Check all appropriate sections)

Landfarmed X Amount Landfarmed (cubic yds): 169

Other _____

Remediation Location:

Onsite

49 cu. yds.

X

Offsite

100 cu. yds.

TNT Landfarm

Schmitz Ranch, N.M.

(i.e., landfarmed onsite, name and location of offsite facility)

General Description of Remedial Action:

Removed contaminated soil from all four side walls
AS to get A below 100 ppm head space reading.
Bottom is rock.

Ground Water Encountered: No X Yes _____ Depth _____

Final Pit Closure Sampling:

Sample Location

North, East, South, and west
side walls

Sample depth

8'

(if multiple samples, attach sample result and diagram of sample locations and depths.)

Sample date

7/8/97

Sample time

1018

Sample Results

Soil: Benzene (ppm)

ND

Water: Benzene (ppb)

Total BTEX (ppm)

0.003

Toluene (ppb)

Field headspace (ppm)

5.2

Ethylbenzene (ppb)

TPH ND ppm

Method

EC15

Total Xylenes (ppb)

Ground Water Sample:

Yes

No

X

(If yes, attach sample results)

I HEREBY CERTIFY THAT THE INFORMATION ABOVE IS TRUE AND COMPLETE TO THE BEST OF MY KNOWLEDGE AND MY BELIEF

DATE

7/17/97

PRINTED NAME

Ronald A. Dedrick

SIGNATURE

Ronald A. Dedrick

AND TITLE

Environmental Technician II

AFTER REVIEW OF THE PIT CLOSURE INFORMATION, PIT CLOSURE IS APPROVED IN ACCORDANCE TO JICARILLA APACHE TRIBE PIT CLOSURE ORDINANCE.

APPROVED: YES

X

NO

(REASON):

okay + close

SIGNED:

Kate C. McNeill

DATE:

7-22-97

Jicarilla 103-12
Sec. 17 T26N R4W Unit A
BROG

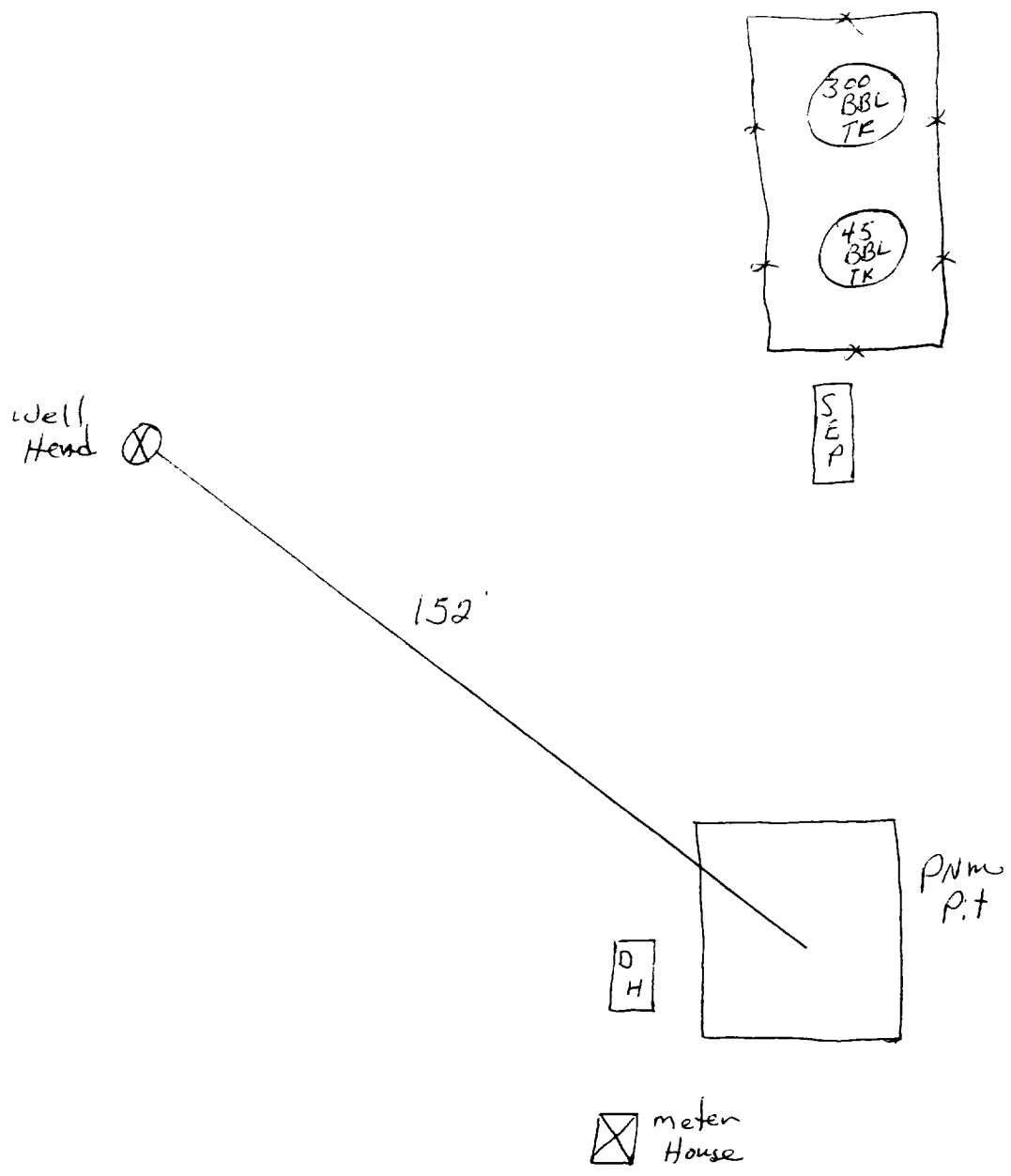

Jicarilla 10.3-12
Sec. 17 T26N R4W Unit A
BROG

23' x 22' x 9'

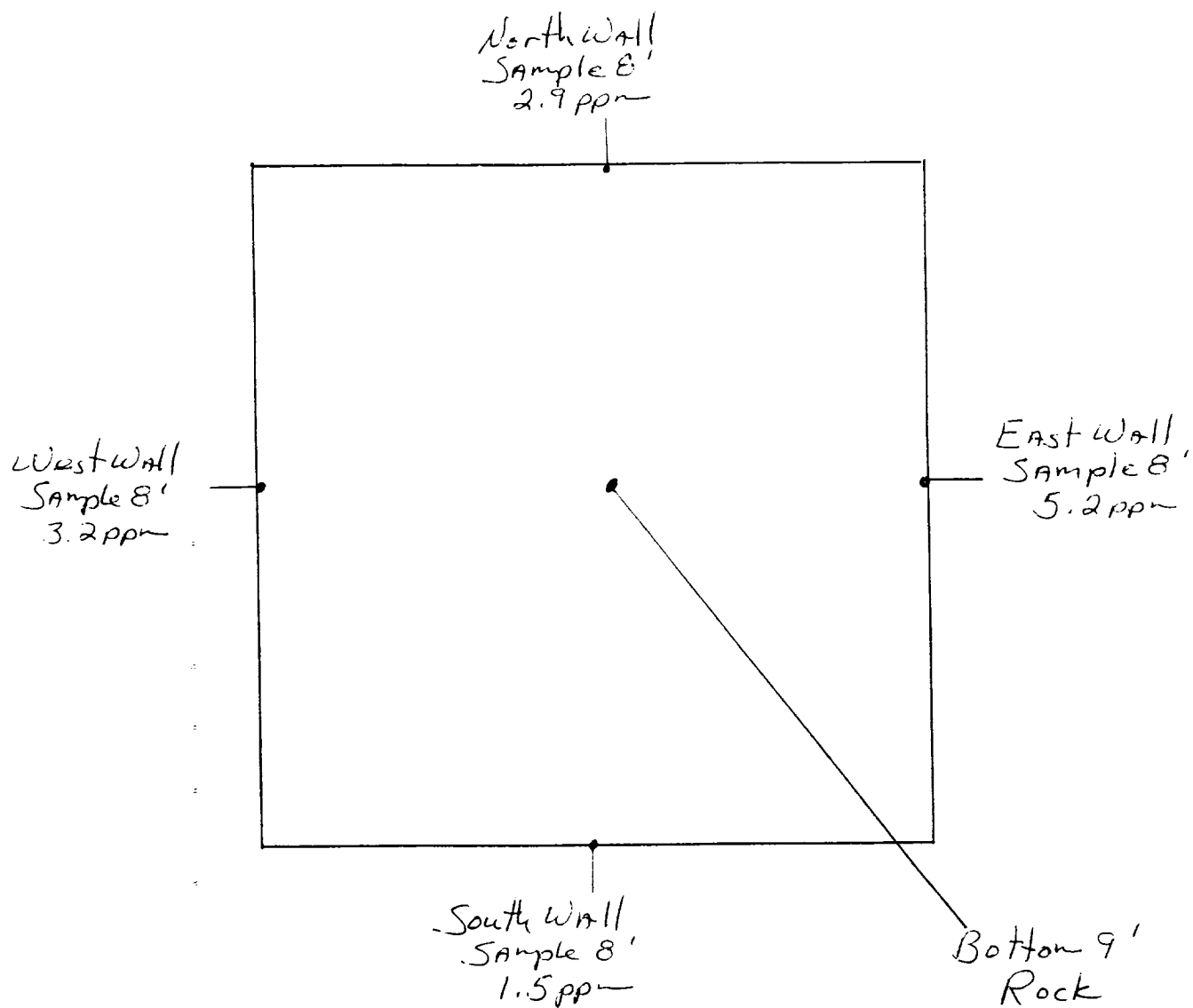

5' Sample - 352 ppm

OFF: (505) 325-5667



LAB: (505) 325-1556

ANALYTICAL REPORT

Attn: *Denver Bearden*
Company: *PNM Gas Services*
Address: *603 W. Elm*
City, State: *Farmington, NM 87401*

Date: *17-Jul-97*
COC No.: *5513*
Sample No.: *15280*
Job No.: *2-1000*

Project Name: *PNM Gas Services - Jicarilla 103-12*
Project Location: *9707081018; 4pt. Composite*
Sampled by: *SA* Date: *8-Jul-97* Time: *10:18*
Analyzed by: *DC/HR* Date: *15-Jul-97*
Sample Matrix: *Soil*

Laboratory Analysis

Parameter	Results as Received	Unit of Measure	Limit of Quantitation	Unit of Measure
<i>Diesel Range Organics (C10 - C28)</i>	ND	mg/kg	5	mg/kg

ND - Not Detected at Limit of Quantitation

Quality Assurance Report

DRO QC No.: 0548-STD

Continuing Calibration Verification

Parameter	Method Blank	Unit of Measure	True Value	Analyzed Value	RPD	RPD Limit
<i>Diesel Range (C10 - C28) *</i>	ND	ppm	200	182	9.5	15%

Matrix Spike

Parameter	1 - Percent Recovered	2 - Percent Recovered	Limit	RPD	RPD Limit
<i>Diesel Range (C10-C28)</i>	83	87	(70-130)	5	20%

Method - *SW-846 EPA Method 8015A mod. - Nonhalogenated Volatile Hydrocarbons by Gas Chromatography*

Approved by: *[Signature]*
Date: *7/17/97*

P.O. BOX 2606 • FARMINGTON, NM 87499

OFF: (505) 325-5667



LAB: (505) 325-1556

ANALYTICAL REPORT

Attn: *Denver Bearden*
Company: *PNM Gas Services*
Address: *603 W. Elm*
City, State: *Farmington, NM 87401*

Date: *17-Jul-97*
COC No.: *5513*
Sample No.: *15280*
Job No.: *2-1000*

Project Name: *PNM Gas Services - Jicarilla 103-12*
Project Location: *9707081018; 4pt. Composite*
Sampled by: *SA* Date: *8-Jul-97* Time: *10:18*
Analyzed by: *DC* Date: *16-Jul-97*
Sample Matrix: *Soil*

Laboratory Analysis

Parameter	Results as Received	Unit of Measure	Limit of Quantitation	Unit of Measure
<i>Benzene</i>	ND	ug/kg	1	ug/kg
<i>Toluene</i>	2	ug/kg	1	ug/kg
<i>Ethylbenzene</i>	ND	ug/kg	1	ug/kg
<i>m,p-Xylene</i>	2	ug/kg	1	ug/kg
<i>o-Xylene</i>	ND	ug/kg	1	ug/kg
	<i>TOTAL</i>	3		ug/kg

ND - Not Detected at Limit of Quantitation

Method - SW-846 EPA Method 8020A Aromatic Volatile Organics by Gas Chromatography

Approved by: *DAC*
Date: *7/17/97*

P.O. BOX 2606 • FARMINGTON, NM 87499

TECHNOLOGY BLENDING INDUSTRY WITH THE ENVIRONMENT

JICARILLA APACHE TRIBE
ENVIRONMENTAL
PROTECTION OFFICE
P.O. BOX 507
DULCE, NEW MEXICO 87528

SUBMIT 1 COPY TO
NATURAL
RESOURCE DEPT
AND OIL GAS
ADMINISTRATION

ON-SITE SOIL REMEDIATION REPORT

Operator: PNM Gas Services (<u>BRUG</u>) Telephone: <u>324-3764</u>	
Address: <u>603 W. Elm Street Farmington, NM 87401</u>	
Facility or Well Name: <u>Jicarilla 103-12</u>	
Location: Unit: <u>A</u> Sec. <u>17</u> T. <u>24</u> N. <u>4</u> W. County <u>Rio Arriba</u>	
Land Type: <u>Jicarilla Apache</u>	
Date Remediation Started: <u>7/8/97</u> Date Completed: _____	
Remediation Method: Landfarmed <u>X</u> Approx. cubic yards <u>69</u> Composted _____ Other _____	
Depth to Ground Water: (pts.) <u>0</u> Distance to an Ephemeral Stream: (pts.) <u>0</u> Distance to Nearest Lake, Playa, or Watering Pond: (pts.) <u>0</u> Wellhead Protection Area: (pts.) <u>0</u> Distance to Surface Water: (pts.) <u>0</u> Ranking Score (Total Points): <u>0</u>	Final Closure Sampling: Sampling Date: <u>7/21/97</u> Time <u>1329</u> Sampling Results: <u>7/31/97</u> <u>0920</u> Field Headspace (ppm) <u>94.3</u> <u>26.6</u> TPH <u>7/31/97</u> <u>05</u> Method <u>8015</u> Other _____
I HEREBY CERTIFY THAT THE INFORMATION ABOVE IS TRUE AND COMPLETE TO THE BEST OF MY KNOWLEDGE AND BELIEF	
DATE <u>8/7/97</u> PRINTED NAME <u>Ronald A. Dedrick</u>	
SIGNATURE <u>Ronald A. Dedrick</u> AND TITLE <u>Environmental Technician II</u>	
AFTER REVIEW OF THE SOIL REMEDIATION INFORMATION, ON-SITE REMEDIATION APPROVED IN ACCORDANCE TO THE JICARILLA APACHE TRIBE PIT CLOSURE ORDINANCE	
APPROVED: YES <u>X</u> NO _____ (REASON) <u>use as Backfill</u>	
SIGNED: <u>Kerr C. Merrill</u> DATE: <u>8-12-97</u>	

Jicarilla 10.3-12
Sec. 17 T.26N R.4W Unit A
BROG

Land farm

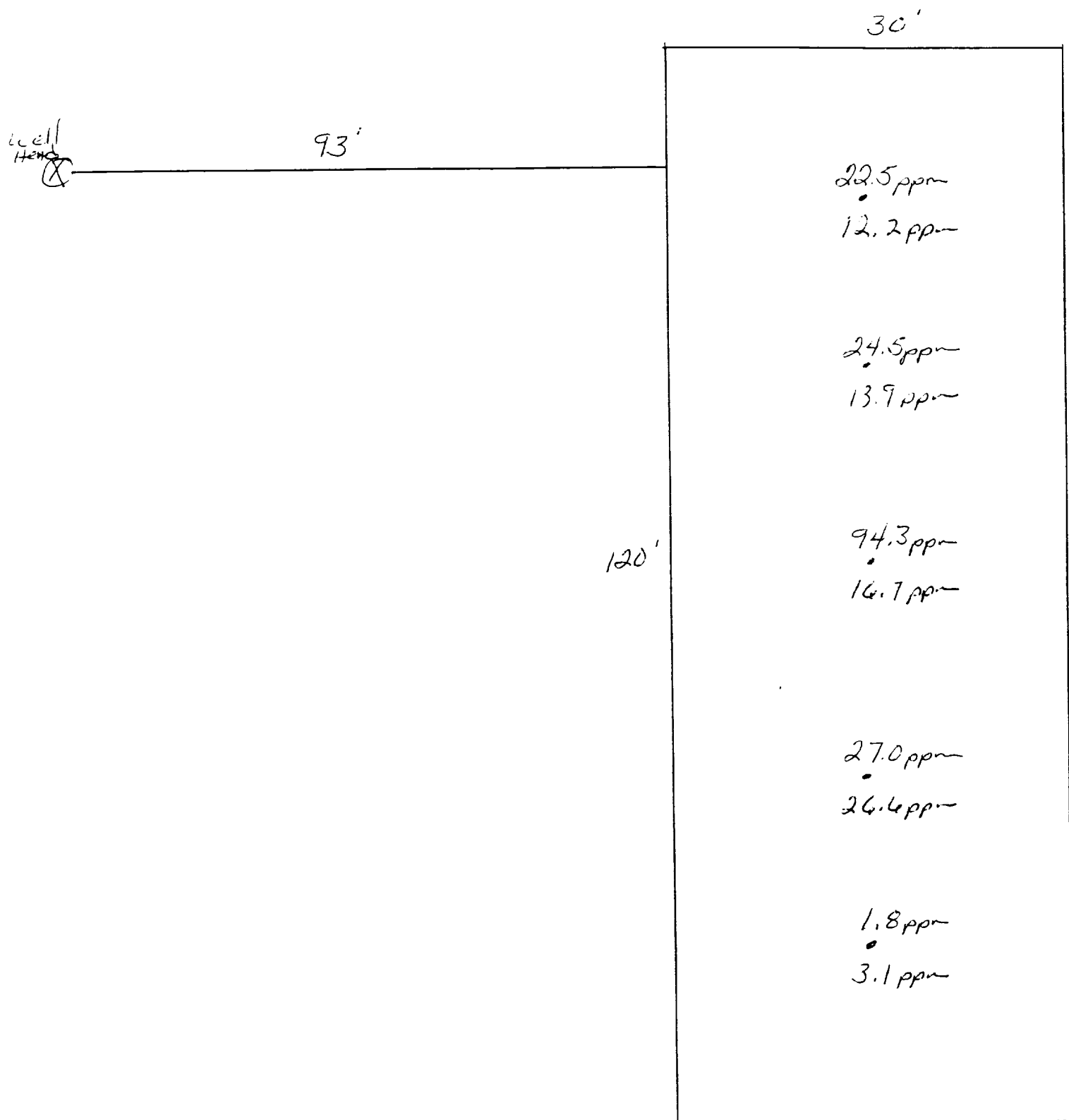

OFF: (505) 325-5667



LAB: (505) 325-1556

ANALYTICAL REPORT

Attn: *Denver Bearden*
Company: *PNM Gas Services*
Address: *603 W. Elm*
City, State: *Farmington, NM 87401*

Date: *5-Aug-97*
COC No.: *5531*
Sample No.: *15542*
Job No.: *2-1000*

Project Name: *PNM Gas Services - Jicarilla 103-12 Landfarm*
Project Location: *9707310920; 5pt. Composite*
Sampled by: *RB* Date: *31-Jul-97* Time: *9:20*
Analyzed by: *HR/DC* Date: *4-Aug-97*
Sample Matrix: *Soil*

Laboratory Analysis

Parameter	Results as Received	Unit of Measure	Limit of Quantitation	Unit of Measure
<i>Diesel Range Organics (C10 - C28)</i>	89	mg/kg	5	mg/kg

ND - Not Detected at Limit of Quantitation

Quality Assurance Report

DRO QC No.: 0548-STD

Continuing Calibration Verification

Parameter	Method Blank	Unit of Measure	True Value	Analyzed Value	RPD	RPD Limit
<i>Diesel Range (C10 - C28)</i>	ND	ppm	200	198	0.8	15%

Matrix Spike

Parameter	1 - Percent Recovered	2 - Percent Recovered	Limit	RPD	RPD Limit
<i>Diesel Range (C10-C28)</i>	112	98	(70-130)	7	20%

Method - SW-846 EPA Method 8015A mod. - Nonhalogenated Volatile Hydrocarbons by Gas Chromatography

Approved by: *[Signature]*
Date: *8/5/97*

P.O. BOX 2606 • FARMINGTON, NM 87499

- TECHNOLOGY BLENDING INDUSTRY WITH THE ENVIRONMENT -

OFF: (505) 325-5667



LAB: (505) 325-1556

ANALYTICAL REPORT

Attn: *Denver Bearden*
Company: *PNM Gas Services*
Address: *603 W. Elm*
City, State: *Farmington, NM 87401*

Date: *29-Jul-97*
COC No.: *5528*
Sample No.: *15478*
Job No.: *2-1000*

Project Name: *PNM Gas Services - Jicarilla 103-12 Landfarm*
Project Location: *9707211329; 5pt. Composite*
Sampled by: *RB* Date: *21-Jul-97* Time: *13:29*
Analyzed by: *DC* Date: *25-Jul-97*
Sample Matrix: *Soil*

Laboratory Analysis

Parameter	Results as Received	Unit of Measure	Limit of Quantitation	Unit of Measure
<i>Diesel Range Organics (C10 - C28)</i>	107	mg/kg	5	mg/kg

ND - Not Detected at Limit of Quantitation

Quality Assurance Report

DRO QC No.: 0548-STD

Continuing Calibration Verification

Parameter	Method Blank	Unit of Measure	True Value	Analyzed Value	RPD	RPD Limit
<i>Diesel Range (C10 - C28)</i>	ND	ppm	200	198	1.0	15%

Matrix Spike

Parameter	1- Percent Recovered	2 - Percent Recovered	Limit	RPD	RPD Limit
<i>Diesel Range (C10-C28)</i>	94	96	(70-130)	1	20%

Method - SW-846 EPA Method 8015A mod. - Nonhalogenated Volatile Hydrocarbons by Gas Chromatography

Approved by: 

Date: *7/29/97*

P.O. BOX 2606 • FARMINGTON, NM 87499

Telephone: (505) 325-5667 Fax: (505) 325-1556