

UNITED STATES
DEPARTMENT OF THE INTERIOR
BUREAU OF LAND MANAGEMENT

APPLICATION FOR PERMIT TO DRILL, DEEPEN, OR PLUG BACK

1a. TYPE OF WORK

DRILL ☒

DEEPEN ☐

PLUG BACK ☐

b. TYPE OF WELL

OIL
WELL ☐

GAS
WELL ☒

OTHER

SINGLE
ZONE ☐

MULTIPLE
ZONE ☒

2. NAME OF OPERATOR

Caulkins Oil Company

3. ADDRESS OF OPERATOR

P.O. Box 780 Farmington, New Mexico 87499

4. LOCATION OF WELL (Report location clearly and in accordance with any State requirements.)

At surface 1550' F/W and 1750' F/N

At proposed prod. zone: Same

14. DISTANCE IN MILES AND DIRECTION FROM NEAREST TOWN OR POST OFFICE

60 Miles Southeast of Blanco, New Mexico

16. DISTANCE FROM PROPOSED*

LOCATION TO NEAREST
PROPERTY OR LEASE LINE, FT.
(Also to nearest drg. unit line, if any)

1090'

18. NO. OF ACRES IN LEASE

640

17. NO. OF ACRES ASSIGNED
TO THIS WELL

W 320 (Infil)

18. DISTANCE FROM PROPOSED LOCATION*
TO NEAREST WELL, DRILLING, COMPLETED,
OR APPLIED FOR, ON THIS LEASE, FT.

1000'

20. PROPOSED DEPTH

7525'

22. ROTARY OR CABLE TOOLS

Rotary

21. ELEVATIONS (Show whether DF, RT, GR, etc.)

6662' GR

22. APPROX. DATE WORK WILL START*

June 1, 1985

DRILLING OPERATIONS AUTHORIZED ARE
SUBJECT TO COMPLIANCE WITH ATTACHED

PROPOSED CASING AND CEMENTING PROGRAM

"GENERAL REQUIREMENTS"

SIZE OF CASING	SIZE OF CASING	WEIGHT PER FOOT	SETTING DEPTH	QUANTITY OF CEMENT
12 3/4"	9 5/8"	32.3#	400'	Sufficient to circulate 300 Cu.Ft.
7 7/8"	5 1/2"	15.5 & 17#	7525'	3 Stages - 2000 Cu.Ft. Total

Surface formation San Jose. No abnormal pressure or temperture anticipated.

It is proposed to drill new hole, surface to 7525' using 9.0 Gel based mud. Float will be run in drill pipe at bit. ES Induction and Density Logs will be run.

A Schaeffer 10" Model LWP 6000# test BOP will be in use at all times while Drilling below surface casing. BOP will be tested at least one time during each 24 hour period and results recorded on daily drilling report.

New 9 5/8" 32.3# H-40 8rd thd, short collars surface casing will be set at approx 400' and cemented with sufficient cement to circulate to surface.

New 5 1/2" 15.5 & 17# K-55 short and long collar 8rd thd Smls casing will be cemented top to bottom in 3 stages. First stage thru shoe with 412.50 Cu.Ft. 50-50 Poz, 6% Gal, 12 1/4# Gilsonite per sack followed by 118 Cu.Ft. Neat Cement.

IN ABOVE SPACE DESCRIBE PROPOSED PROGRAM: If proposal is to deepen or plug back, give data on present productive zone and proposed new productive zone. If proposal is to drill or deepen directionally, give pertinent data on subsurface locations and measured and true vertical depths. Give blowout preventer program, if any.

24.

SIGNED

Charles E. Vergara

TITLE

Superintendent

DATE

5-6-85

(This space for Federal or State office use)

This action is subject to technical and procedural review pursuant to 43 CFR 3165.3 and appeal pursuant to 43 CFR 3165.4.

APPROVAL DATE

APPROVED
AS AMENDED

MAY 22 1985

/s/ J. Stan McKee

M. MILLENBACH
AREA MANAGER

NMOCC

*See Instructions On Reverse Side

Second stage thru tool set at approx 5500' with 412.5 Cu.Ft. 50-50 Poz, 6% Gel, 12 1/4# Gilsonite per sack followed by 118 Cu.Ft. Neat Cement.

Third stage thru tool set at approx 3500' with 825 Cu.Ft. 50-50 Poz, 6% Gel, 12 1/4# Gilsonite per sack followed by 118 Cu.Ft. Neat Cement.

Centralizers will be run on casing thru Mesa Verde and Dakota Zones.

Well will be completed in Mesa Verde and Dakota Zones.

All Zones will be perforated and fractured to stimulate production.

Packer will be set between Mesa Verde and Dakota Zones.

New 1 1/2" EUE 2.90# V-55 10rd thd Smls tubing will be run thru Packer to Dakota Zone.

New 1 1/4" NU 2.33# V-55 10rd thd Smls tubing will be run for Mesa Verde production.

Gas produced from this well contracted to El Paso Natural Gas Company.

Estimated Formation Tops:

Alamo	2446'
Pictured Cliffs	2983'
Chacra	3884'
Mesa Verde	4677'
Graneros	7216'
Dakota	7348'

OIL CONSERVATION DIVISION

STATE OF NEW MEXICO
ENERGY AND MINERALS DEPARTMENTP. O. BOX 2088
SANTA FE, NEW MEXICO 87501Form C-102
Revised 10-1-78

All distances must be from the outer boundaries of the Section.

Operator CAULKINS OIL COMPANY		Lease SANCHEZ		Well No. 4-R
Unit Letter F	Section 25	Township 26 NORTH	Range 6 WEST	County RIO ARriba
Actual Footage Location of Well: 1750 feet from the NORTH line and 1550 feet from the WEST line				
Ground Level Elev. 6652	Producing Formation Mesa Verde Dakota	Pool Blanco Mesa Verde--Basin Dakota	Dedicated Acreage: 320(Infil) Acres	

1. Outline the acreage dedicated to the subject well by colored pencil or hatchure marks on the plat below.
2. If more than one lease is dedicated to the well, outline each and identify the ownership thereof (both as to working interest and royalty).
3. If more than one lease of different ownership is dedicated to the well, have the interests of all owners been consolidated by communitization, unitization, force-pooling, etc?

☐ Yes ☐ No If answer is "yes," type of consolidation _____

If answer is "no," list the owners and tract descriptions which have actually been consolidated. (Use reverse side of this form if necessary.) _____

No allowable will be assigned to the well until all interests have been consolidated (by communitization, unitization, forced-pooling, or otherwise) or until a non-standard unit, eliminating such interests, has been approved by the Division.

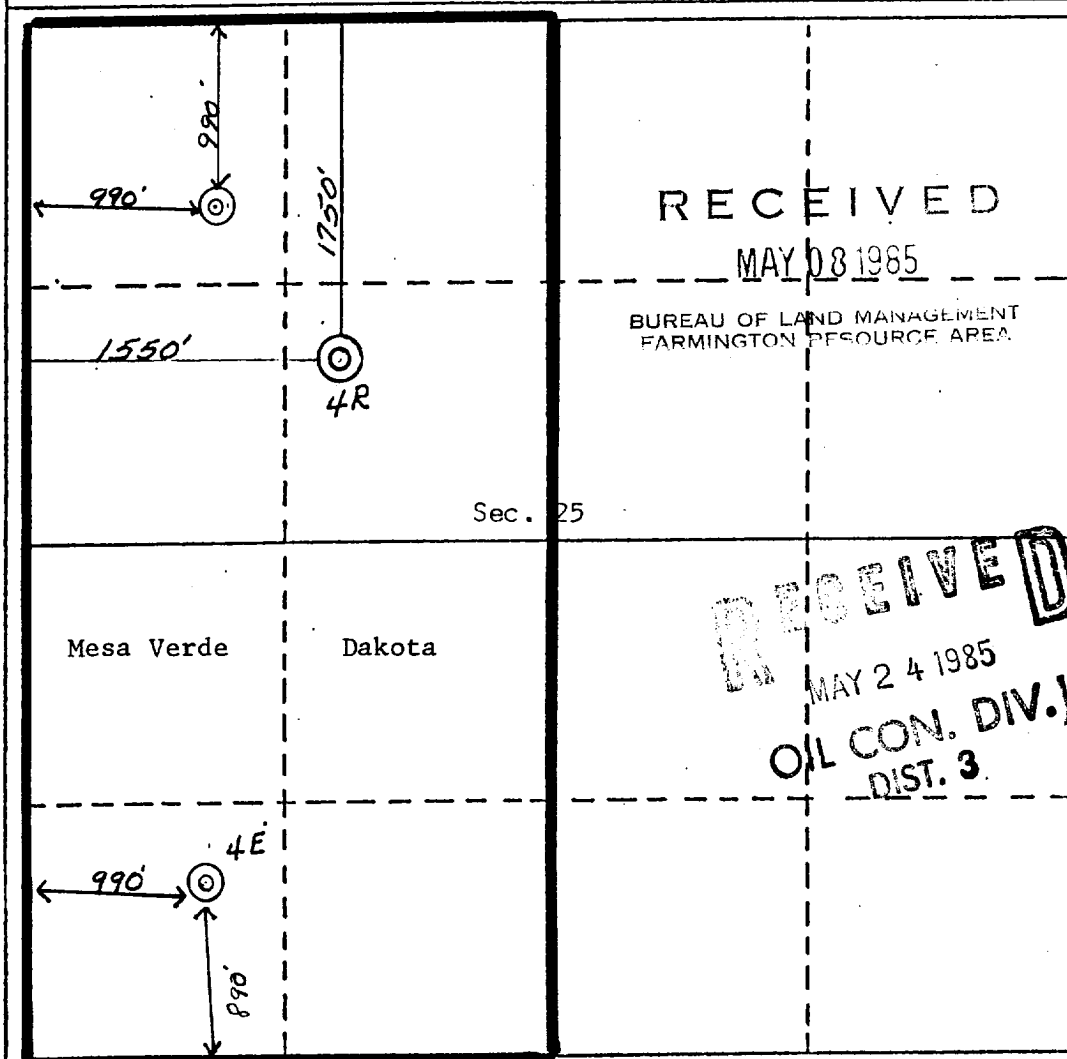

CERTIFICATION

I hereby certify that the information contained herein is true and complete to the best of my knowledge and belief.

Charles E. Verquer
Name

Charles E. Verquer

Position

Superintendent

Company

Caulkins Oil Company

Date

5-6-85

I hereby certify that the well location shown on this plat was plotted from field notes of actual surveys made by me or under my supervision, and that the same is true and correct to the best of my knowledge and belief.

Charles E. Verquer
Date Surveyed
REGISTERED LAND SURVEYOR
May 1985
REGISTERED PROFESSIONAL GEODETIC SURVEYOR
and/or Land Surveyor
Curtis O. Stocking

Certificate No.
AMC 5000

UNITED STATES
DEPARTMENT OF THE INTERIOR
BUREAU OF LAND MANAGEMENT

SUBMIT IN TRIPLICATE
(Other instructions on
reverse side)

10th approved.
Budget Bureau No. 1004-0135
Expires August 31, 1985

5. LEASE DESIGNATION AND SERIAL NO.

SF 079304

6. IF INDIAN, ALLOTTEE OR TRIBE NAME

SUNDRY NOTICES AND REPORTS ON WELLS

(Do not use this form for proposals to drill or to deepen or plug back to a different reservoir.
Use "APPLICATION FOR PERMIT" for such proposals.)

OIL WELL ☐ GAS WELL ☒ OTHER

JUG 01 1985

2. NAME OF OPERATOR

Caulkins Oil Company BUREAU OF LAND MANAGEMENT
FARMINGTON RESOURCE AREA

3. ADDRESS OF OPERATOR

P.O. Box 780 Farmington, New Mexico 87499

4. LOCATION OF WELL (Report location clearly and in accordance with any State requirements.
See also space 17 below.)
At surface

1550' F/W and 1750' F/N

14. PERMIT NO.

15. ELEVATIONS (Show whether DF, RT, GR, etc.)

6662 GR

7. UNIT AGREEMENT NAME

8. FARM OR LEASE NAME

Sanchez

9. WELL NO.

4-R

10. FIELD AND POOL, OR WILDCAT

Blanco Mesa Verde - Basin Dak.

11. SEC., T., R., M., OR BLK. AND
SURVEY OR ARMA

Section 25, 26N 6W

12. COUNTY OR PARISH 13. STATE

Rio Arriba New Mexico

16. Check Appropriate Box To Indicate Nature of Notice, Report, or Other Data

NOTICE OF INTENTION TO:

TEST WATER SHUT-OFF

FRACTURE TREAT

SHOOT OR ACIDIZE

REPAIR WELL

(Other)

PULL OR ALTER CASING

MULTIPLE COMPLETE

ABANDON*

CHANGE PLANS

SUBSEQUENT REPORT OF:

WATER SHUT-OFF

FRACTURE TREATMENT

SHOOTING OR ACIDIZING

(Other)

REPAIRING WELL

ALTERING CASING

ABANDONMENT*

Report Casing Test

(NOTE: Report results of multiple completion on Well
Completion or Recompletion Report and Log form.)

17. DESCRIBE PROPOSED OR COMPLETED OPERATIONS (Clearly state all pertinent details, and give pertinent dates, including estimated date of starting any
proposed work. If well is directionally drilled, give subsurface locations and measured and true vertical depths for all markers and zones perti-
nent to this work.)

7-13-85

Tested 5 1/2" Casing with 4000#. No decrease in pressure.

Perforated Dakota Zone as follows:

1-.42-7456	1-.42-7414	1-.42-7330
1-.42-7438	1-.42-7380	1-.42-7226
1-.42-7430	1-.42-7346	1-.42-7216
1-.42-7418	1-.42-7338	

Then fractured Dakota Zone with 171,000# 20-40 Sand and 2526 bbls
Cross Link Fluid.

7-14 85

Perforated Mesa Verde Zone as follows:

1-.42-5378	1-.42-5294	1-.42-5244	1-.42-5178
1-.42-5328	1-.42-5281	1-.42-5232	1-.42-5109
1-.42 5325	1-.42-5268	1-.42-5222	1-.42-4998
1-.42-5308	1-.42-5262	1-.42-5216	1-.42-4938

Then fractured Mesa Verde Zone with 102,500# 20-40 Sand and 1387 bbls
20# Gel Fluid.

18. I hereby certify that the foregoing is true and correct

SIGNED

Charles E. DeGuerre

TITLE

Superintendent

DATE

7-29-85

(This space for Federal or State office use)

APPROVED BY

CONDITIONS OF APPROVAL, IF ANY:

TITLE

ACCEPTED FOR RECORD

DATE

1985

*See Instructions on Reverse Side

FARMINGTON RESOURCE AREA