

UNITED STATES
DEPARTMENT OF THE INTERIOR
BUREAU OF LAND MANAGEMENT

RECEIVED
SUBMIT IN PRELIMINARY
(See instructions on
reverse side)

30-039-23909
Form approved.
Budget Bureau No. 1004-0136
Expires August 31, 1985

OCT 15 1985

APPLICATION FOR PERMIT TO DRILL, DEEPEN OR PLUG BACK

1a. TYPE OF WORK
DRILL ☒ DEEPEN ☐ PLUG BACK ☐

b. TYPE OF WELL
OIL WELL ☒ GAS WELL ☐ OTHER ☐
SINGLE ZONE ☒ MULTIPLE ZONE ☐

2. NAME OF OPERATOR
Benson-Montin-Greer Drilling Corp.

3. ADDRESS OF OPERATOR
221 Petroleum Center Building, Farmington, NM 87401

4. LOCATION OF WELL (Report location clearly and in accordance with any State requirements.)
At surface
SE SW 900' FSL, 1650' FWL Section 31, T26N, R1W
At proposed prod. zone
Same

14. DISTANCE IN MILES AND DIRECTION FROM NEAREST TOWN OR POST OFFICE
From Lindrith, NM north 11-1/4 miles

15. DISTANCE FROM PROPOSED*
LOCATION TO NEAREST
PROPERTY OR LEASE LINE, FT.
(Also to nearest drlg. unit line, if any) 900'

16. NO. OF ACRES IN LEASE
1280

17. NO. OF ACRES ASSIGNED
TO THIS WELL
640

18. DISTANCE FROM PROPOSED LOCATION*
TO NEAREST WELL, DRILLING, COMPLETED,
OR APPLIED FOR, ON THIS LEASE, FT.

19. PROPOSED DEPTH
7850'

20. ROTARY OR CABLE TOOLS
Rotary

21. ELEVATIONS (Show whether DF, RT, GR, etc.)

7569' GR

DRILLING OPERATIONS AUTHORIZED ARE
SUBJECT TO COMPLIANCE WITH ATTACHED
"GENERAL REQUIREMENTS"

22. APPROX. DATE WORK WILL START
As soon as possible

23. PROPOSED CASING AND CEMENTING PROGRAM

| SIZE OF HOLE | SIZE OF CASING | WEIGHT PER FOOT | SETTING DEPTH |
|----------------------|----------------|-----------------|---------------|
| 12-1/4" | 9-5/8" | 36# | 500' |
| 8-3/4" to 3500' | | | |
| 7-7/8" 3500 to 7850' | 5-1/2" | 17# | 7800' |

This action is subject to technical and
procedural review pursuant to 43 CFR 3165.3,
and appeal pursuant to 43 CFR 3166.4.
285 cu. ft. (250 sacks)

*See below

*First Stage -300 sacks (450 cu.ft.) from TD to approximately 6100'
Second Stage-375 sacks (500 cu.ft.) from approximately 6000 to 5100'
Third Stage -550 sacks (825 cu.ft.) from approximately 3500' to 600'
(See attachment)

See attachment for blowout preventer program.

RECEIVED
OCT 25 1985

OIL CON. DIV.
DIST. 3

IN ABOVE SPACE DESCRIBE PROPOSED PROGRAM: If proposal is to deepen or plug back, give data on present productive zone and proposed new productive zone. If proposal is to drill or deepen directionally, give pertinent data on subsurface locations and measured and true vertical depths. Give blowout preventer program, if any.

24. Michael L. State TITLE Vice President DATE 10/14/85

(This space for Federal or State office use)

PERMIT NO. _____ APPROVAL DATE _____

APPROVED BY _____ TITLE _____
CONDITIONS OF APPROVAL, IF ANY:

Hold C-100 for

Accurate Casing Program

*See Instructions On Reverse Side

OCT 23 1985
(SGD.) MAT MILLENBACH
M. MILLENBACH
AREA MANAGER

NEW MEXICO OIL CONSERVATION COMMISSION
WELL LOCATION AND ACREAGE DEDICATION PLAT

Form C-102
Supersedes C-128
Effective 1-1-65

All distances must be from the outer boundaries of the Section.

| | | | | |
|---|--|--|--|-------------------------------|
| Operator BENSON MONTIN GREER DRILLING CORP. | | Lease Canada Ojitos Unit (N-31) | | Well No. #31 (N-31) |
| Unit Letter N | Section 31 | Township 26 NORTH | Range 1 WEST | County RIO ARriba |
| Actual Footage Location of Well: 900 feet from the SOUTH line and 1650 feet from the WEST line | | | | |
| Ground Level Elev. 7569 | Producing Formation Niobrara | Pool West Pureto Chiquito Mancos | Dedicated Acreage: 640 Acres | |

1. Outline the acreage dedicated to the subject well by colored pencil or hachure marks on the plat below.
2. If more than one lease is dedicated to the well, outline each and identify the ownership thereof (both as to working interest and royalty). Unitization Agreement
3. If more than one lease of different ownership is dedicated to the well, have the interests of all owners been consolidated by communitization, unitization, force-pooling, etc?

☒ Yes ☐ No If answer is "yes," type of consolidation Unitization

If answer is "no," list the owners and tract descriptions which have actually been consolidated. (Use reverse side of this form if necessary.)

No allowable will be assigned to the well until all interests have been consolidated (by communitization, unitization, forced-pooling, or otherwise) or until a non-standard unit, eliminating such interests, has been approved by the Commission.

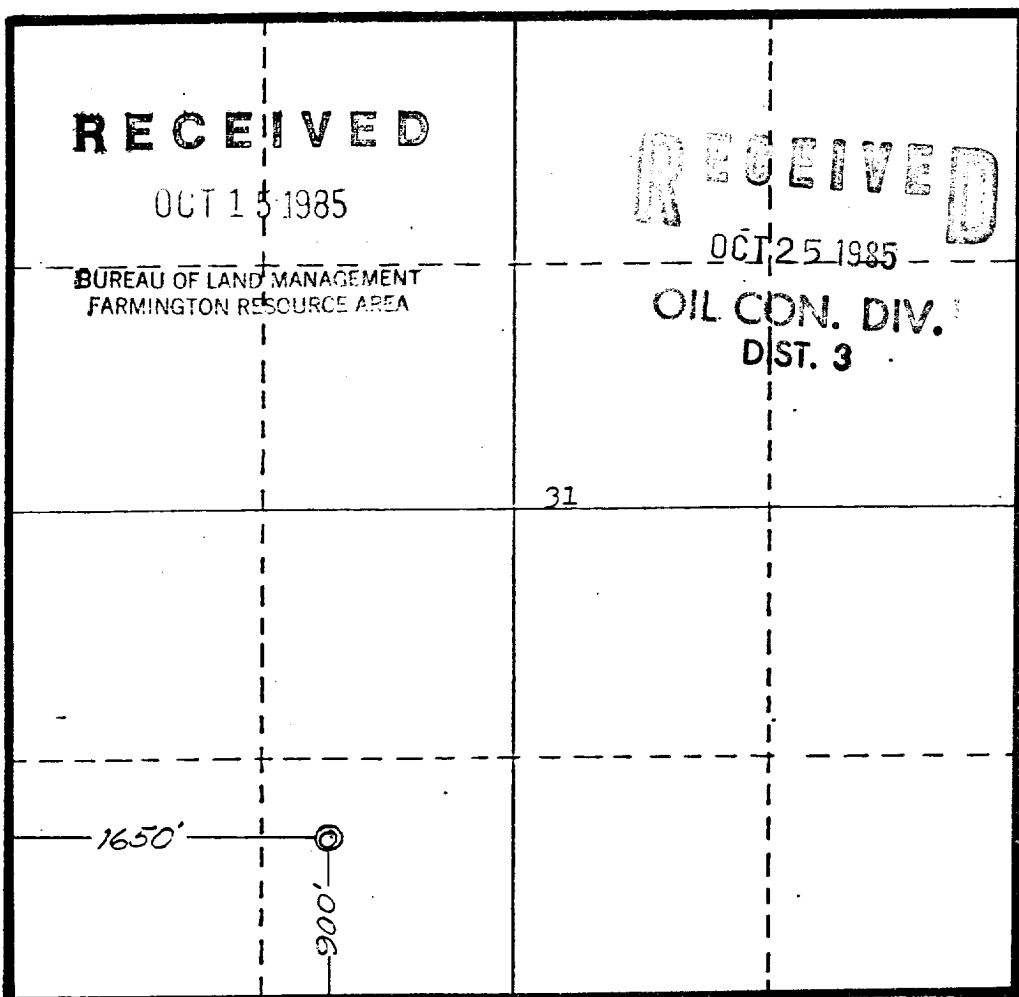

CERTIFICATION

I hereby certify that the information contained herein is true and complete to the best of my knowledge and belief.

Name

Virgil L. Stoabs

Position

Vice President

Company **Benson-Montin-Greer Drilling Corp.**

Date

October 2, 1985

I hereby certify that the well location shown on this plat was plotted from field notes of actual surveys made by me or under my supervision, and that the same is true and correct to the best of my knowledge and belief.

Date Surveyed

30 August 1985

Registered Professional Engineer and/or Land Surveyor

James P. Leese
James P. Leese

Certificate No.

1463

0 330 660 990 1320 1650 1980 2310 2640 2970 3300 3630 3960 4290 4620 4950 5280 5610 5940 6270 6600

Benson-Montin-Greer Drilling Corp.
Canada Ojitos Unit #31 (N-31)
SE/4 SW/4 Section 31, T26N, R1W
Rio Arriba County, New Mexico

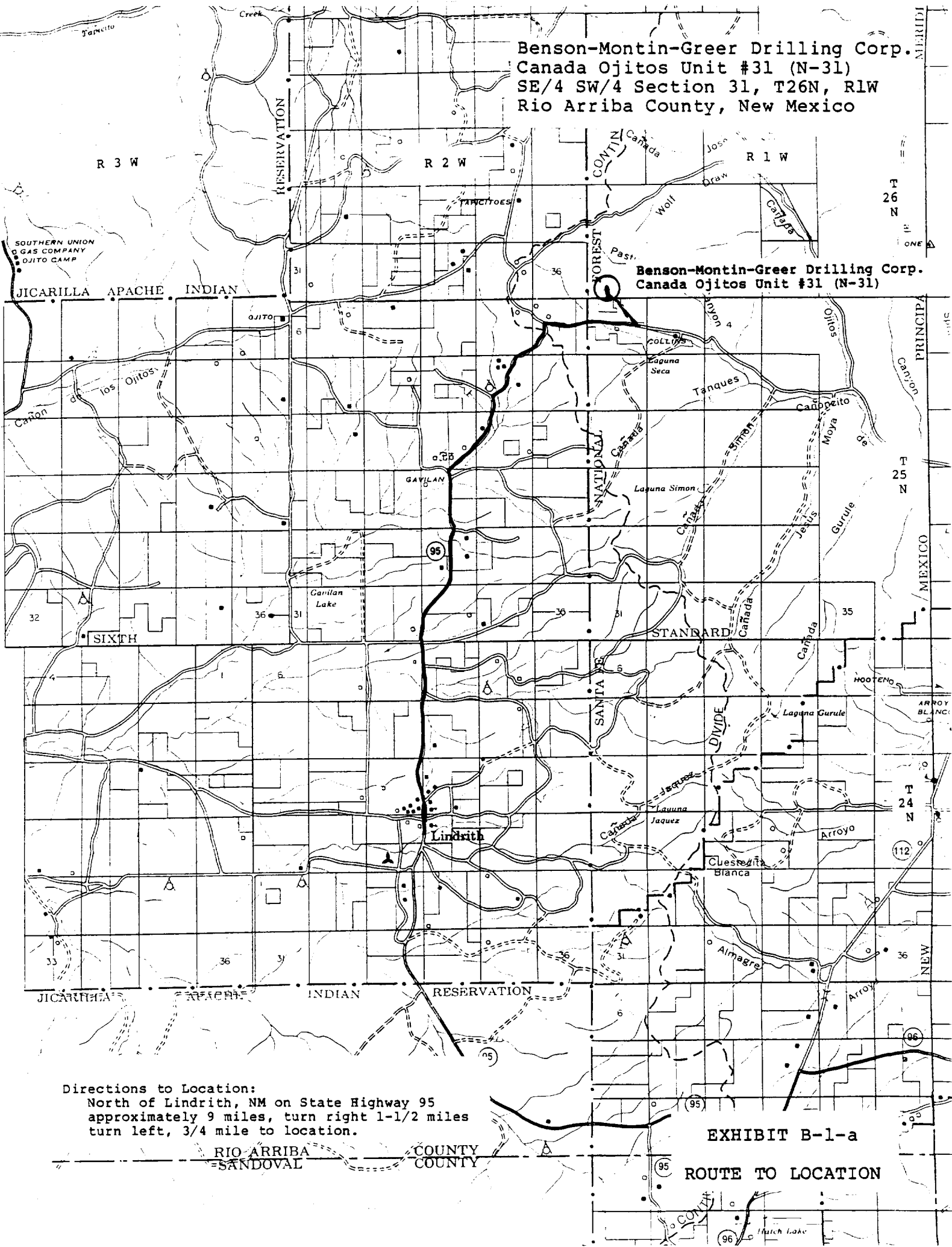

Directions to Location:
North of Lindrith, NM on State Highway 95
approximately 9 miles, turn right 1-1/2 miles
turn left, 3/4 mile to location.

EXHIBIT B-1-a

ROUTE TO LOCATION

RIO ARRIBA
SANDOVAL COUNTY