

All distances must be from the outer boundaries of the Section.

Operator AMOCO PRODUCTION COMPANY			Lease BEAR CANYON UNIT		Well No. # 1
Unit Letter G	Section 15	Township 26 NORTH	Range 2 WEST	County RIO ARriba	
Actual Footage Location of Well: 1680 feet from the NORTH line and 1780 feet from the EAST line					
Ground Level Elev. 7395	Producing Formation Mancos/Dakota	Pool Gavilan-Greenhorn-Graneros Dakota & Gavilan Mancos		Dedicated Acreage 632.0 / 640 Acres	

1. Outline the acreage dedicated to the subject well by colored pencil or hatchure marks on the plat below.
2. If more than one lease is dedicated to the well, outline each and identify the ownership thereof (both as to working interest and royalty).
3. If more than one lease of different ownership is dedicated to the well, have the interests of all owners been consolidated by communitization, unitization, force-pooling, etc?

Federal Unit has been approved

☒ Yes ☐ No If answer is "yes," type of consolidation Plan to unitize

If answer is "no," list the owners and tract descriptions which have actually been consolidated. (Use reverse side of this form if necessary.)

No allowable will be assigned to the well until all interests have been consolidated (by communitization, unitization, forced-pooling, or otherwise) or until a non-standard unit, eliminating such interests, has been approved by the Division.

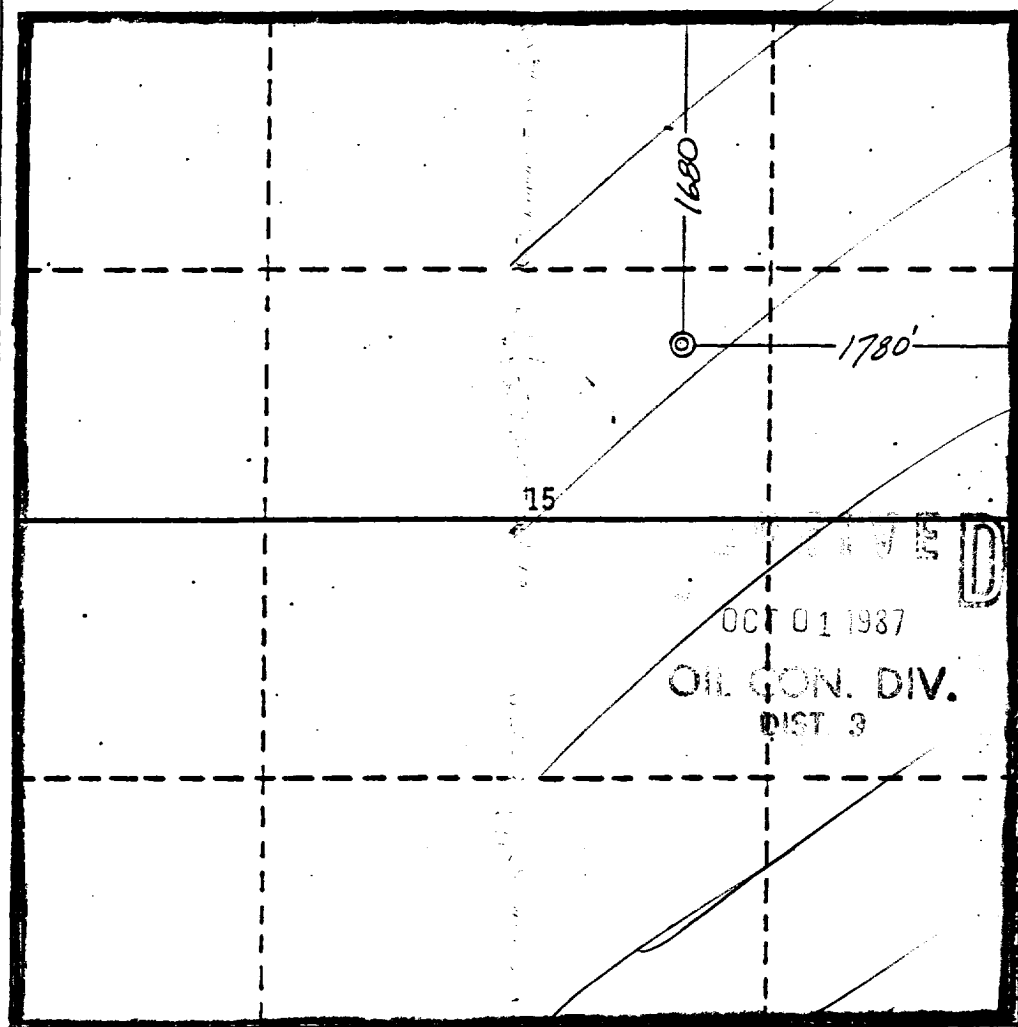

CERTIFICATION

I hereby certify that the information contained herein is true and complete to the best of my knowledge and belief.

B. D. Shaw

Name

B. D. Shaw

Position

Adm. Supervisor

Company

Amoco Production Co.

Date

May 6, 1987

I hereby certify that the location shown on this plat was plotted from field notes of the survey made or under supervision, and that the same is true and correct to the best of my knowledge and belief.

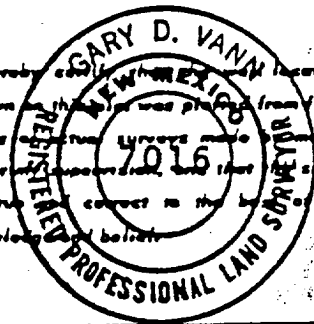

Date Surveyed

May 1, 1987

Registered Professional Engineer and/or Land Surveyor

Gary D. Vann
Gary D. Vann

Certificate No.

7016