

UNITED STATES
DEPARTMENT OF THE INTERIOR
BUREAU OF LAND MANAGEMENT

APPLICATION FOR PERMIT TO DRILL, DEEPEN, OR PLUG BACK

1a. TYPE OF WORK

DRILL ☒

DEEPEN ☐

PLUG BACK ☐

b. TYPE OF WELL

OIL
WELL ☐

GAS
WELL ☒

OTHER

SINGLE
ZONE ☐

MULTIPLE
ZONE ☒

2. NAME OF OPERATOR

Union Texas Petroleum

3. ADDRESS OF OPERATOR

375 U.S. Highway 64, Farmington New Mexico 87401

4. LOCATION OF WELL (Report location clearly and in accordance with any State requirements)

At surface

1850' FNL & 1650' FEL

At proposed prod. zone

Same as above

14. DISTANCE IN MILES AND DIRECTION FROM NEAREST TOWN OR POST OFFICE*

22 miles NW of Ojito, New Mexico

BUREAU OF LAND MANAGEMENT

15. DISTANCE FROM PROPOSED*

LOCATION TO NEAREST
PROPERTY OR LEASE LINE, FT.
(Also to nearest drlg. unit line, if any)

3679' from lease
1013' from DU

16. NO. OF ACRES IN LEASE

2560

18. DISTANCE FROM PROPOSED LOCATION*

TO NEAREST WELL, DRILLING, COMPLETED,
OR APPLIED FOR, ON THIS LEASE, FT.

2835'

19. PROPOSED DEPTH

7765'

17. NO. OF ACRES ASSIGNED
TO THIS WELL

E/2 320.77 acres
NE/4 160.48 acres

20. ROTARY OR CABLE TOOLS

Rotary

21. ELEVATIONS (Show whether DF, RT, GR, etc.)

6647 G.L. (graded) DRILLING OPERATIONS AUTHORIZED ARE

23. "GENERAL REQUIREMENTS" AND CEMENTING PROGRAM

22. APPROX. DATE WORK WILL START*

June 20, 1987

SIZE OF HOLE	SIZE OF CASING	WEIGHT PER FOOT	SETTING DEPTH	QUANTITY OF CEMENT
12-1/4"	9-5/8"	32.3#	300'	175 sxs (207 cu.ft.)
8-3/4"	7"	23.0#	3540'	335 sxs (792 cu.ft.)
6-1/4"	4-1/2" liner	10.5	3340'-7765'	535 sxs (839 cu.ft.)

Union Texas Petroleum wishes to advise we intend to drill 12-1/4" hole with mud to 300+ and set 9-5/8" 32.3#, H-40, ST&C csg. to 300'+, cementing to surface with 175 sxs (207 cu.ft.) C1 "B" with 2% CaCl2 and 1/4# flocele/sk. Wait on cement for 12 hrs.

Nipple up, test BOP. Drill 8-3/4" hole with mud out of surface to 3540'. Set 7", 23.0#, K-55, ST&C intermediate csg. to 3540', cementing to surface with 235 sxs (674 cu.ft.) 65-35 POZ with 12% gel and 12-1/4# gilsonite/sk, tailed by 100 sxs (118 cu.ft) C1 "B" with 2% CaCl2.

Drill 6-1/4" hole with air out of intermediate to a TD of 7765'. Log well, run 4-1/2", 10.5#, K-55, ST&C liner from 3340' to 7765'. Cement liner into intermediate csg with 535 sxs (839 cu.ft.) 50-50 POZ with 4% gel, 6-1/4# gilsonite/sk, and 10# salt/sk. Following perforation and treatment of the Mesaverde, Gallup and Dakota formations, standard production equipment will be installed. The well will be tied into Gas Company of NM. A cathodic protection groundbed will be drilled on location. AC power will be plowed from the Jicarilla H #7 location along the access road to the main road to the Jicarilla H #8E access road and then north to location.

IN ABOVE SPACE DESCRIBE PROPOSED PROGRAM: If proposal is to deepen or plug back, give data on present productive zone and proposed new productive zone. If proposal is to drill or deepen directionally, give pertinent data on subsurface locations and measured and true vertical depths. Give blowout preventer program, if any.

24.

SIGNED

Robert C. Frank

TITLE

Permit Coordinator

DATE April 16, 1987

(This space for Federal or State Use)

PERMIT NO.

APPROVAL DATE

APPROVED BY

CONDITIONS OF APPROVAL, IF ANY:

JUN - 4 1987

TITLE

MAY 20 1987

/s/ J. Stan McKee

FOR AREA MANAGER

*See Instructions On Reverse Side

Form C-103
Supersedes C-120
Effective 1-4-83

GON TEXAS PETROLEUM			Lease		Well No.
JICARILLA "H"					8-E
Section	Township	Range	County		
19	26 N	4 W	Rio Arriba		

1850	feet from the North	line and	1650	feet from the East	line
Ground Level Elev.	Producing Formation	Pool	Basin	Dedicated Acreage:	
6647	Mesaverde Gallup Dakota	a Blanco-	WH Gallup Ext-	E/2 322.77	Acres

- ☐ Yes ☐ No If answer is "yes," type of consolidation _____

No allowable will be assigned to the well until all interests have been consolidated (by communitization, unitization, forced-pooling, or otherwise) or until a non-standard unit, eliminating such interests, has been approved by the Commission.

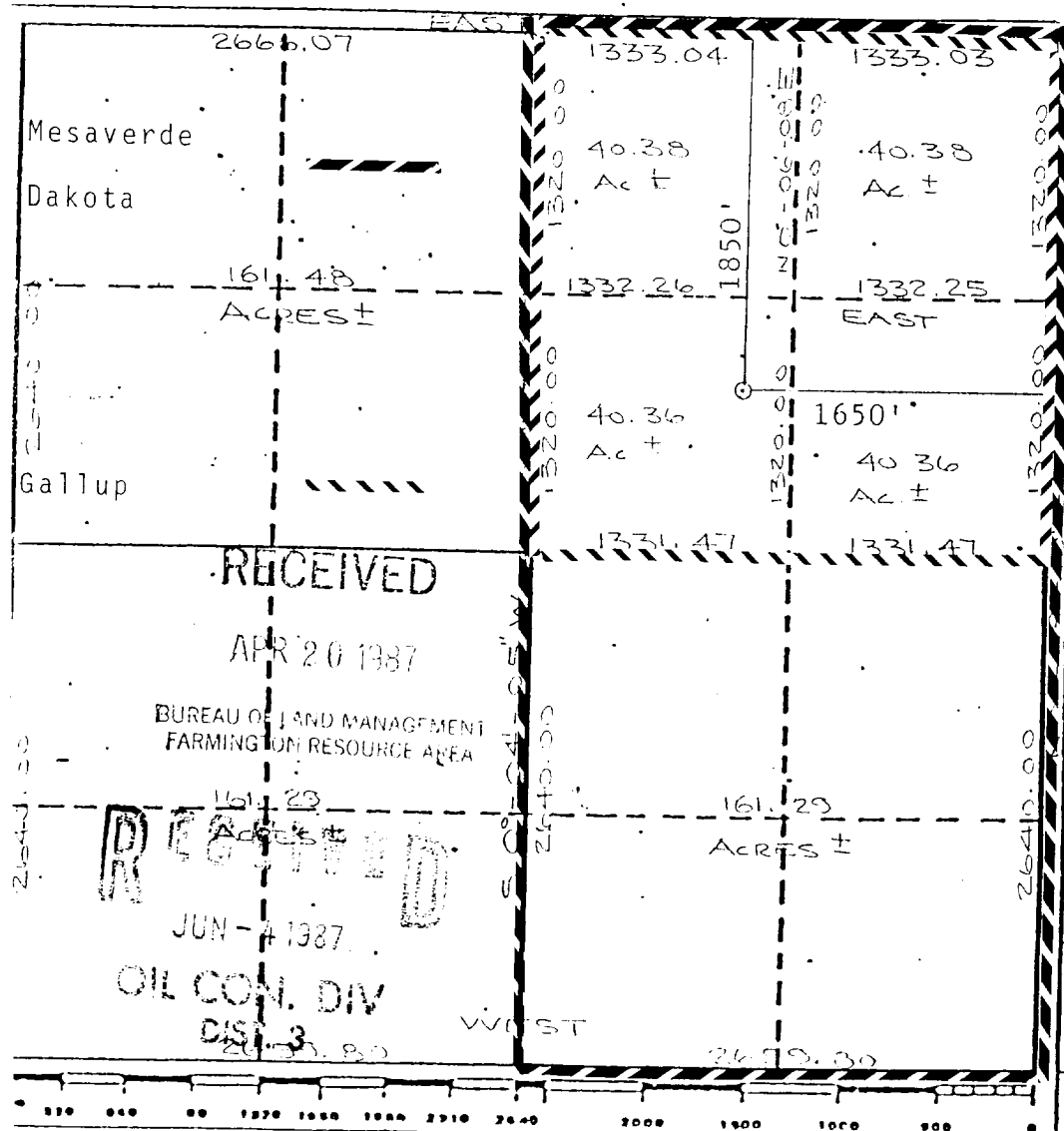

I hereby certify that the information contained herein is true and complete to the best of my knowledge and belief.

Robert C. Frank

Name
Robert C. Frank
Position
Permit Coordinator
Company
Union Texas Petroleum
Date
April 15, 1987

I hereby certify that the well location shown on this plat was plotted from field notes of actual surveys made by me or under my supervision and that the same is true and correct to the best of my knowledge and belief.

Cecil B. Ellis

Date Surveyed
March 21, 1987
Registered Professional Engineer
and/or Land Surveyor

Cecil B. Tullis

9672