

UNITED STATES
DEPARTMENT OF THE INTERIOR
BUREAU OF LAND MANAGEMENT

APPLICATION FOR PERMIT TO DRILL, DEEPEN, OR PLUG BACK

1a. TYPE OF WORK
DRILL ☒ DEEPEN ☐ PLUG BACK ☐

b. TYPE OF WELL
OIL WELL ☒ GAS WELL ☐ OTHER ☐
SINGLE ZONE ☒ MULTIPLE ZONE ☐

2. NAME OF OPERATOR
Hixon Development Company

3. ADDRESS OF OPERATOR
P. O. Box 2810, Farmington, New Mexico 87499

4. LOCATION OF WELL (Report location clearly and in accordance with any State requirements.)*
At surface 1740' FSL, 2090' FEL, Section 27, T26N, R3W
At proposed prod. zone same

14. DISTANCE IN MILES AND DIRECTION FROM NEAREST TOWN OR POST OFFICE*
15 miles NW Lindrith, NM

15. DISTANCE FROM PROPOSED* LOCATION TO NEAREST PROPERTY OR LEASE LINE, FT.
(Also to nearest drlg. unit line, if any) 550' (lease line)

19. PROPOSED DEPTH 8525'

21. ELEVATIONS (Show whether DF, RT, GR, etc.)
7390' GR

23. PROPOSED CASING AND CEMENTING PROGRAM

SIZE OF HOLE	SIZE OF CASING	WEIGHT PER FOOT	SETTING DEPTH
12-1/4"	9-5/8"	36#	300'
8-3/4"	5-1/2"	17#	8525'

5. LEASE DESIGNATION AND SERIAL NO.
JIC- 117

6. IF INDIAN, ALLOTTEE OR TRIBE NAME
Jicarilla Apache

7. UNIT AGREEMENT NAME

8. FARM OR LEASE NAME
Skip Hixon

9. WELL NO.
1

10. FIELD AND POOL, OR WILDCAT
NE Ojito Gallup/Dakota

11. SEC., T., R., M., OR BLK. AND SURVEY OR AREA
J Sec. 27, T26N, R3W

12. COUNTY OR PARISH
Rio Arriba

13. STATE
NM

17. NO. OF ACRES ASSIGNED TO THIS WELL
160

20. ROTARY OR CABLE TOOLS
Rotary

22. APPROX. DATE WORK WILL START*
October 1, 1987

24. QUANTITY OF CEMENT
256 cu. ft.
2329 cu. ft.

It is proposed to drill the subject NE Ojito Gallup/Dakota oil well.
It will be evaluated on the basis of open hole logs. Please see
the attached data required by Onshore Oil and Gas Order No. 1.

IN ABOVE SPACE DESCRIBE PROPOSED PROGRAM: If proposal is to deepen or plug back, give data on present productive zone and proposed new productive zone. If proposal is to drill or deepen directionally, give pertinent data on subsurface locations and measured and true vertical depths. Give blowout preventer program, if any.

24. SIGNED R. Perry Tuttle TITLE Geologist DATE August 10, 1987

(This space for Federal or State office use)

PERMIT NO. _____ APPROVAL DATE _____

APPROVED BY _____ TITLE _____ DATE _____

CONDITIONS OF APPROVAL, IF ANY:

Hold C-104 for N'5L

NM000

181 Arden B. Miner

FOR

*See Instructions On Reverse Side

All distances must be from the outer boundaries of the Section.

Operator Hixon Development Company		Lease Skip Hixon		Well No. 1
Unit Letter J	Section 27	Township 26 North	Range 3 West	County Rio Arriba
Actual Footage Location of Well: 1740 feet from the South line and 2090 feet from the East line				
Ground Level Elev. 7390	Producing Formation Gallup/Dakota	Pool NE Ojito Gallup/Dakota EXT	Dedicated Acreage: 160.00 Acres	

1. Outline the acreage dedicated to the subject well by colored pencil or hatchure marks on the plat below.
2. If more than one lease is dedicated to the well, outline each and identify the ownership thereof (both as to working interest and royalty).
3. If more than one lease of different ownership is dedicated to the well, have the interests of all owners been consolidated by communitization, unitization, force-pooling, etc?

☐ Yes ☐ No If answer is "yes," type of consolidation _____

If answer is "no," list the owners and tract descriptions which have actually been consolidated. (Use reverse side of this form if necessary.) _____

No allowable will be assigned to the well until all interests have been consolidated (by communitization, unitization, forced-pooling, or otherwise) or until a non-standard unit, eliminating such interests, has been approved by the Division.

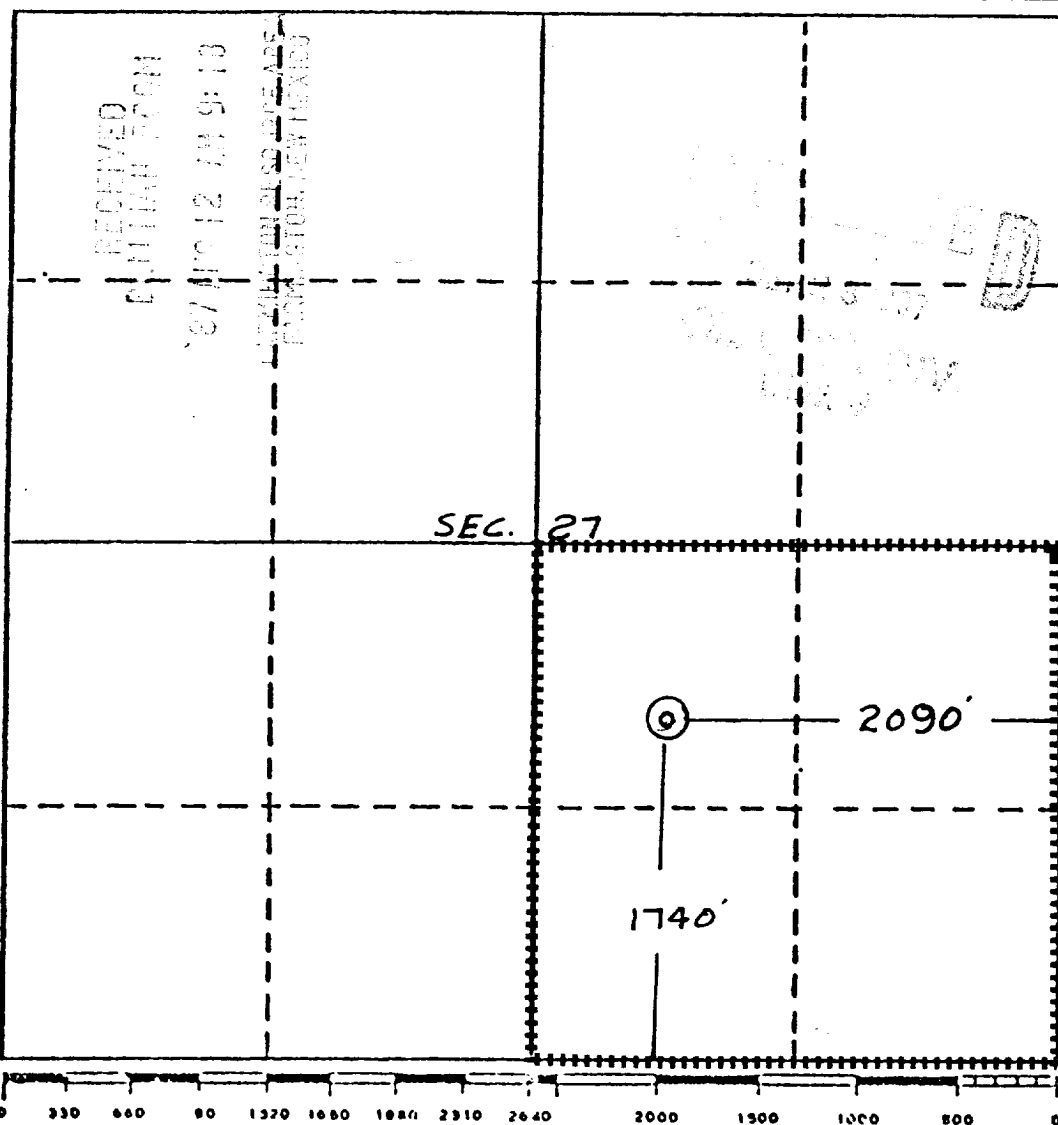

CERTIFICATION

I hereby certify that the information contained herein is true and complete to the best of my knowledge and belief.

R. P. Tuttle

Name

R. P. Tuttle

Position

Geologist

Company

Hixon Development Company

Date

August 5, 1987

I hereby certify that the location shown on this plat was obtained from field notes or observations made by me or under my supervision and that the same is true and correct to the best of my knowledge and belief.

Date Surveyed

July 30, 1987

Registered Professional Engineer and/or Land Surveyor

Edgar L. Risenhoover

Certificate No. 5979

Edgar L. Risenhoover, L.S.

