

OIL CONSERVATION DIVISION

STATE OF NEW MEXICO
ENERGY AND MINERALS DEPARTMENTP. O. BOX 2088
SANTA FE, NEW MEXICO 87501Form C-102
Revised 10-1-78

All distances must be from the outer boundaries of the Section.

Operator AMOCO PRODUCTION COMPANY		Lease BEAR CANYON UNIT		Well No. # 3
Unit Letter L	Section 11	Township 26 NORTH	Range 2 West	County RIO ARRIBA
Actual Footage Location of Well 1820 feet from the SOUTH line and 970 feet from the WEST line				
Ground Level Elev. 7353	Producing Formation Gallup/Dakota	Pool Gavilan Mancos Extension and <u>WILDCAT</u>		Dedicated Acreage 640.40 Acres

1. Outline the acreage dedicated to the subject well by colored pencil or hatchure marks on the plat below.
2. If more than one lease is dedicated to the well, outline each and identify the ownership thereof (both as to working interest and royalty).
3. If more than one lease of different ownership is dedicated to the well, have the interests of all owners been consolidated by communitization, unitization, force-pooling, etc?

☒ Yes ☐ No If answer is "yes," type of consolidation Unitization

If answer is "no," list the owners and tract descriptions which have actually been consolidated. (Use reverse side of this form if necessary.)

No allowable will be assigned to the well until all interests have been consolidated (by communitization, unitization, forced-pooling, or otherwise) or until a non-standard unit, eliminating such interests, has been approved by the Division.

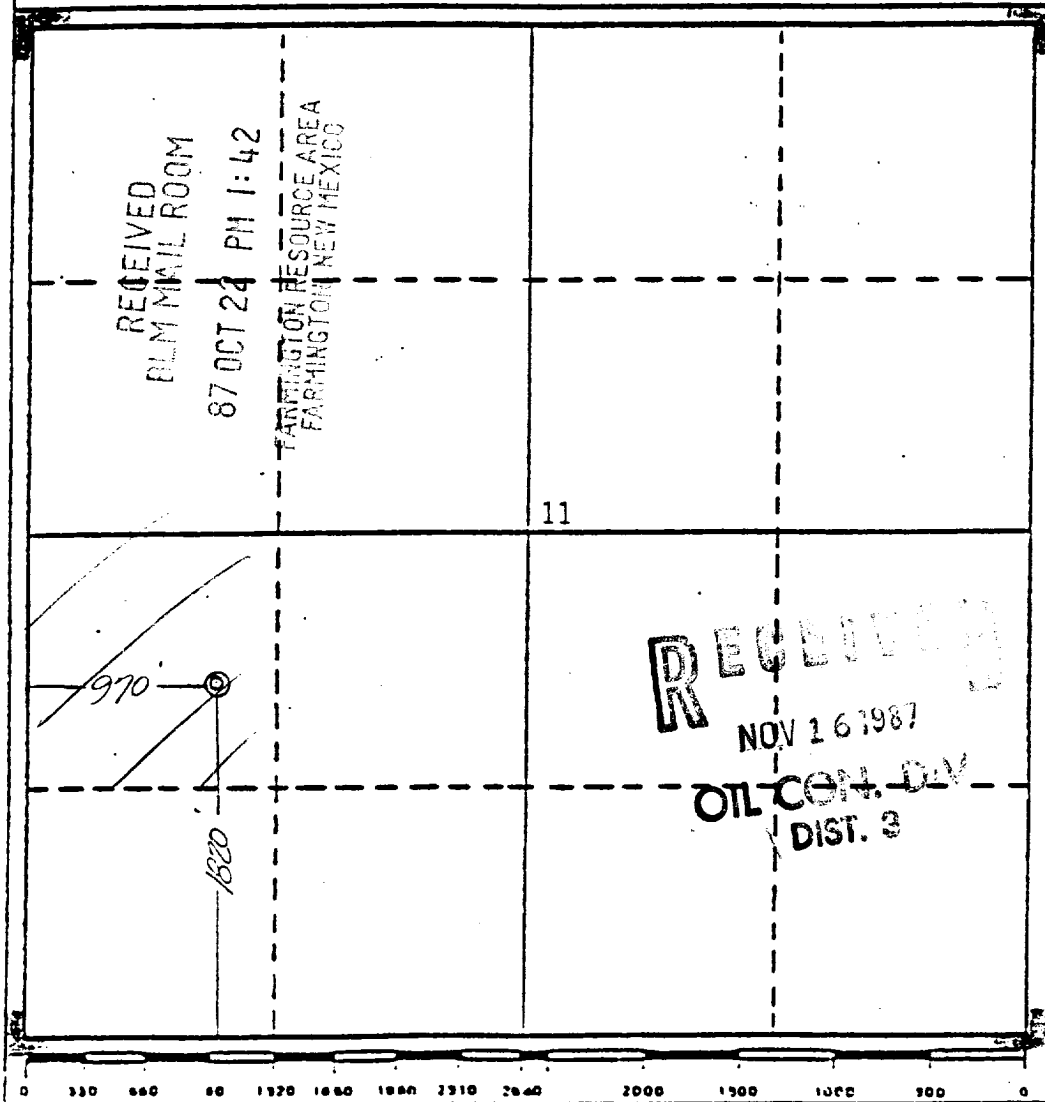

CERTIFICATION

I hereby certify that the information contained herein is true and complete to the best of my knowledge and belief.

B. D. Shaw

Name

B. D. Shaw

Position

Administrative Supervisor

Company

Amoco Production Company

Date

October 21, 1987

I hereby certify that the location shown on this plat was plotted from field notes of actual surveys made by me or under my supervision, and that the same is true and correct to the best of my knowledge and belief.

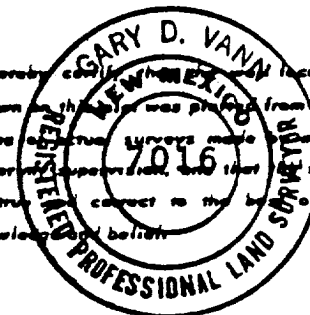

Date Surveyed

September 29, 1987

Registered Professional Engineer
and/or Land Surveyor*Gary D. Vann*
Gary D. Vann

Certificate No.

7016