

UNITED STATES
DEPARTMENT OF THE INTERIOR
BUREAU OF LAND MANAGEMENT

SUBMIT IN TRIPLICATE*

Form approved.
Budget Bureau No. 1004-0136
Expires August 31, 1985

APPLICATION FOR PERMIT TO DRILL, DEEPEN, OR PLUG BACK

1a. TYPE OF WORK

DRILL ☒

DEEPEN ☐

PLUG BACK ☐

b. TYPE OF WELL

OIL WELL ☒

GAS WELL ☐

OTHER ☐

SINGLE ZONE ☐

MULTIPLE ZONE ☒

2. NAME OF OPERATOR

Amoco Production Company

3. ADDRESS OF OPERATOR

2325 East 30th Street, Farmington, NM 87401

4. LOCATION OF WELL (Report location clearly and in accordance with any State requirements.)*

At surface

790 FSL x 850' FWL

At proposed prod. zone Same

14. DISTANCE IN MILES AND DIRECTION FROM NEAREST TOWN OR POST OFFICE*

Approximately 10 miles NE of Ojito

15. DISTANCE FROM PROPOSED*

LOCATION TO NEAREST
PROPERTY OR LEASE LINE, FT.
(Also to nearest drlg. unit line, if any)

790'

16. NO. OF ACRES IN LEASE

120*

17. NO. OF ACRES ASSIGNED
TO THIS WELL

40/33828

18. DISTANCE FROM PROPOSED LOCATION*
TO NEAREST WELL, DRILLING, COMPLETED,
OR APPLIED FOR, ON THIS LEASE, FT.

19. PROPOSED DEPTH

7600'

20. ROTARY OR CABLE TOOLS

Rotary

21. ELEVATIONS (Show whether DF, RT, GR, etc.)

7245' GR

DRILLING OPERATIONS AUTHORIZED ARE

22. APPROX. DATE WORK WILL START*

As soon as permitted

23. SUBJECT TO COMPLIANCE WITH ATTACHED PROPOSED CASING AND CEMENTING PROGRAM

This action is subject to technical and
procedural review pursuant to 43 CFR 3185.3
and appeal pursuant to 43 CFR 3185.4.
See Attached Sheet

SIZE OF HOLE	SIZE OF CASING	WEIGHT PER FOOT	SETTING DEPTH
12-1/4"	10-3/4"	40.5#, K55	300'
9-7/8"	7-5/8"	26.4#, K55	6750'
6-3/4"	5"	29.7#, N80	7600'
		15#, K55	

*Lease Description: SW/SW Section 2, E/2 SW Section 10, T26N, R2W

Amoco proposes to drill the above well to further develop the Gavilan Mancos Extension reservoir. The well will be drilled to the surface casing point using native mud. The well will then be drilled to TD with a low solids nondispersed mud system. Completion design will be based on open hole logs. Copy of all logs will be filed upon completion. Amoco's standard blowout prevention will be employed; see attached drawing for blowout preventer design. Upon completion the well site will be cleaned and the reserve pit filled and leveled. The gas from this well is not dedicated at this time.

IN ABOVE SPACE DESCRIBE PROPOSED PROGRAM: If proposal is to deepen or plug back, give data on present productive zone and proposed new productive zone. If proposal is to drill or deepen directionally, give pertinent data on subsurface locations and measured and true vertical depths. Give blowout preventer program, if any.

24.

SIGNED

C B Douglas

TITLE

Adm. Supervisor

(This space for Federal or State office use)

PERMIT NO.

APPROVAL DATE

APPROVED BY

CONDITIONS OF APPROVAL, IF ANY:

TITLE

APPROVED
DATE 4-28-88
APR 29 1988
AREA MANAGER
Orig. Sgd. Linda S. C. Bundell
Acting Area Manager

*See Instructions On Reverse Side

CONFIDENTIAL

All distances must be from the outer boundaries of the Section.

Operator AMOCO PRODUCTION COMPANY		Lease BEAR CANYON UNIT		Well No. 4
Unit Letter M	Section 2	Township 26 NORTH	Range 2 WEST	County RIO ARriba
Actual Footage Location of Well: 790 feet from the SOUTH line and 850 feet from the WEST line				
Ground Level Elev. 7245	Producing Formation Dakota/Gallup	Pool Wildcat Dakota and Gavilan Mancos Extension		Dedicated Acreage 40/640 (38.75 Acres)

1. Outline the acreage dedicated to the subject well by colored pencil or hatchure marks on the plat below.
2. If more than one lease is dedicated to the well, outline each and identify the ownership thereof (both as to working interest and royalty).
3. If more than one lease of different ownership is dedicated to the well, have the interests of all owners been consolidated by communitization, unitization, force-pooling, etc?

☒ Yes ☐ No If answer is "yes," type of consolidation Unitization

If answer is "no," list the owners and tract descriptions which have actually been consolidated. (Use reverse side of this form if necessary.)

No allowable will be assigned to the well until all interests have been consolidated (by communitization, unitization, forced-pooling, or otherwise) or until a non-standard unit, eliminating such interests, has been approved by the Division.

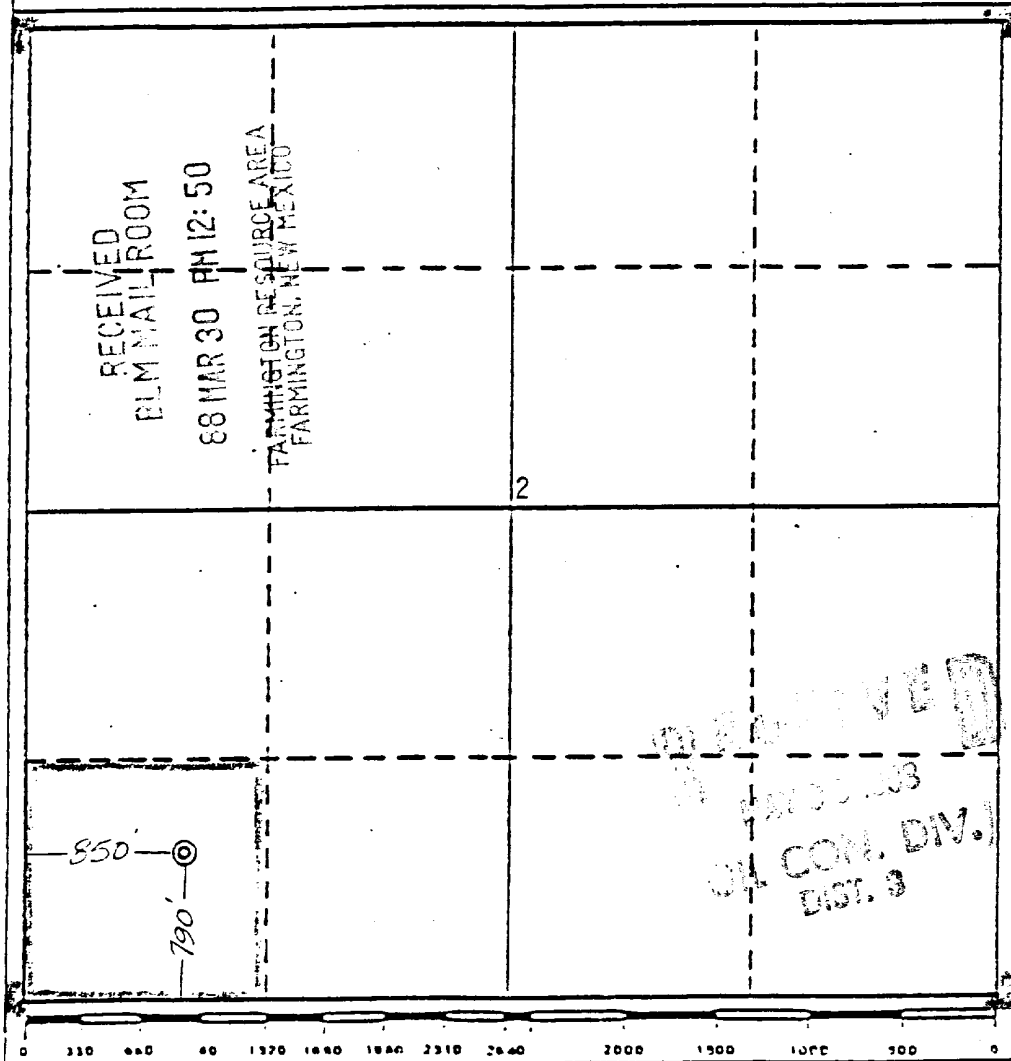

CERTIFICATION

I hereby certify that the information contained herein is true and complete to the best of my knowledge and belief.

C.B. Douglas

Name

C.B. Douglas

Position

Adm. Supervisor

Company

Amoco Production Company

Date

March 28, 1988

I hereby certify that the location shown on this plat was taken from field notes of a Registered Professional Land Surveyor and that the same is true and correct to the best of my knowledge and belief.

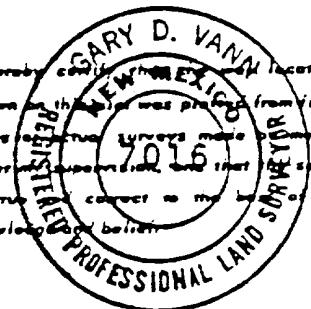

Date Surveyed

March 9, 1988

Registered Professional Engineer and/or Land Surveyor

Gary D. Vann
Gary D. Vann

Certificate No.

7016

