

UNITED STATES
DEPARTMENT OF THE INTERIOR
BUREAU OF LAND MANAGEMENT

APPLICATION FOR PERMIT TO DRILL, DEEPEN, OR PLUG BACK

1A. TYPE OF WORK

DRILL ☒

DEEPEN ☐

PLUG BACK ☐

B. TYPE OF WELL

OIL
WELL ☐

GAS
WELL ☒

OTHER

SINGLE
ZONE ☐

MULTIPLE
ZONE ☒

2. NAME OF OPERATOR

Caulkins Oil Company

3. ADDRESS OF OPERATOR

P.O. Box 340 Bloomfield, New Mexico 87413

4. LOCATION OF WELL (Report location clearly and in accordance with any State requirements.)

At surface

990' F/N and 1650' F/W

At proposed prod. zone Same

14. DISTANCE IN MILES AND DIRECTION FROM NEAREST TOWN OR POST OFFICE*

30 Miles Southwest of Blanco, New Mexico

15. DISTANCE FROM PROPOSED*

LOCATION TO NEAREST
PROPERTY OR LEASE LINE, FT.
(Also to nearest drlg. unit line, if any)

990'

18. DISTANCE FROM PROPOSED LOCATION*
TO NEAREST WELL, DRILLING, COMPLETED,
OR APPLIED FOR, ON THIS LEASE, FT.

525'

16. NO. OF ACRES IN LEASE

1760

19. PROPOSED DEPTH

7750'

17. NO. OF ACRES ASSIGNED
TO THIS WELL.

320

20. ROTARY OR CABLE TOOLS

Rotary

21. ELEVATIONS (Show whether DF, RT, GR, etc.)

DRILLING OPERATIONS AUTHORIZED ARE
SUBJECT TO COMPLIANCE WITH ATTACHED
"GENERAL REQUIREMENTS".

6630 GR

22. APPROX. DATE WORK WILL START*

June 1st, 1989

23. PROPOSED CASING AND CEMENTING PROGRAM

This action is subject to 43 CFR 3155.4-1 and
procedural review pursuant to 43 CFR 3155.4-2
and appeal pursuant to 43 CFR 3155.4-3.

SIZE OF HOLE	SIZE OF CASING	WEIGHT PER FOOT	SETTING DEPTH	QUANTITY OF CEMENT
12 1/4"	9 5/8"	36#	300' 500'	230 Cu.Ft.
7 7/8"	7"	23# & 26#	7750'	1700 Cu.Ft.

It is proposed to drill new hole, surface to 7750', using 9.1# plus gel based mud. Float will be run in drill pipe at bit. ES Gamma and Porosity Logs will be run in open hole.

A Schaeffer 10" Model LWP, 6000# test BOP will be in use at all times while drilling below surface casing and until production casing is cemented. BOP will be tested at least one time during each 24 hour period and results recorded on daily drilling report.

9 5/8" 36# surface casing will be cemented at approx 400' with sufficient cement to circulate to surface, 200 Sacks, 230 Cu.Ft.

7" 23# and 26# J-55 Smls casing will be cemented surface to 7750' in 3 stages with sufficient cement to circulate to surface, approx. 1700 Cu.Ft.

(OVER)

IN ABOVE SPACE DESCRIBE PROPOSED PROGRAM: If proposal is to deepen or plug back, give data on present productive zone and proposed new productive zone. If proposal is to drill or deepen directionally, give pertinent data on subsurface locations and measured and true vertical depths. Give blowout preventer program, if any.

SIGNED

Charles E. Wagner

TITLE

Superintendent

DATE

3-28-89

PERMIT NO.

APPROVAL DATE

APPROVED BY

TITLE

DATE

CONDITIONS OF APPROVAL, IF ANY:

*See Instructions On Reverse Side

Title 18 U.S.C. Section 1001, makes it a crime for any person knowingly and willfully to make to any department or agency of the United States any false, fictitious or fraudulent statements or representations as to any matter within its jurisdiction.

It is proposed to complete well in Mesa Verde, Tocito and Dakota Zones. After treating and testing zones separately, well will be completed in most economical manner that meets all regulations.

Estimated formation tops and bottoms:

Alamo 2600' to 2730'

Fruitland 3040' to 3110'

Pictured Cliffs 3160' to 3240'

Mesa Verde 4890' to 5600'

Tocito 6900' to 6930'

Dakota 7400' to 7740'

**NEW MEXICO OIL CONSERVATION COMMISSION
WELL LOCATION AND ACREAGE DEDICATION PLAT**

Form C-103
Supersedes C-128
Effective 1-4-83

All distances must be from the outer boundaries of the Section.

Operator CAULKINS OIL COMPANY			Lease NM 03554 <i>Breath C</i>		Well No. 144-E
Unit Letter C	Section 12	Township 26 NORTH	Range 6 WEST	County RIO ARriba	
Actual Footage Location of Well <div> <div>990</div> <div>feet from the</div> <div>NORTH</div> <div>line and</div> <div>1650</div> <div>feet from the</div> <div>WEST</div> <div>line</div> </div>					
Ground Level Elev. 6630	Producing Formation Dakota		Pool Basin		Dedicated Acreage 320 Acres

1. Outline the acreage dedicated to the subject well by colored pencil or hachure marks on the plat below.
2. If more than one lease is dedicated to the well, outline each and identify the ownership thereof (both as to working interest and royalty).
3. If more than one lease of different ownership is dedicated to the well, have the interests of all owners been consolidated by communitization, unitization, force-pooling, etc?

☐ Yes ☐ No If answer is "yes," type of consolidation _____

If answer is "no," list the owners and tract descriptions which have actually been consolidated. (Use reverse side of this form if necessary.) _____

No allowable will be assigned to the well until all interests have been consolidated (by communitization, unitization, forced-pooling, or otherwise) or until a non-standard unit, eliminating such interests, has been approved by the Commission.

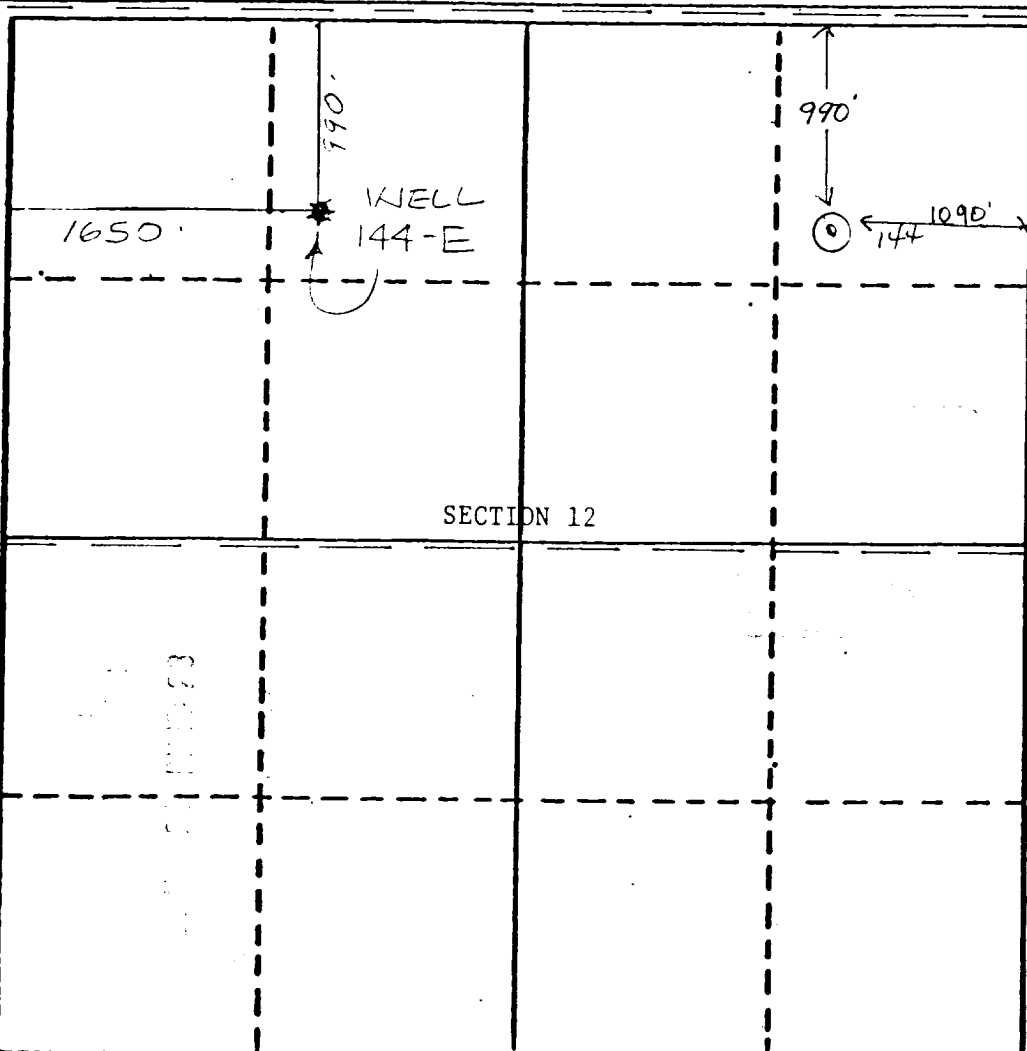

CERTIFICATION

I hereby certify that the information contained herein is true and complete to the best of my knowledge and belief.

Charles E. Verquer

Name

Charles E. Verquer

Position

Superintendent

Company

Caulkins Oil Company

Date

2-24-89

I hereby certify that the well location shown on this plat was plotted from field notes of actual surveys made by me or under my supervision, and that the same is true and correct to the best of my knowledge and belief.

J. Roger Miller
NEW MEXICO
REGISTERED PROFESSIONAL LAND SURVEYOR
8752

Date Surveyed

DECEMBER 14, 1988

Registered Professional Engineer
and/or Land Surveyor

J. ROGER MILLER

Certificate No.

9752

Well No. 144-E
990' F/N and 1650' F/W
Section 12, 26 North 6 West
Rio Arriba County, New Mexico

Scale - 2" = 1 Mile
Access road and location

Pink - ROW required to reach 144-E
Leas line from point on Sanchez 2-R ROW

Yellow - Well location

Red Cross - previous applied for ROW
and water haul route.

