

Submit to Appropriate
District Office
State Lease -- 6 copies
Fee Lease -- 5 copies

State of New Mexico
Energy, Minerals and Natural Resources Department

Form C-101
Revised 1-1-89

OIL CONSERVATION DIVISION

P.O. Box 2088
Santa Fe, New Mexico 87504-2088

DISTRICT I
P.O. Box 1980, Hobbs, NM 88240

DISTRICT II
P.O. Drawer DD, Artesia, NM 88210

DISTRICT III
1000 Rio Brazos Rd., Aztec, NM 87410

API NO. (assigned by OCD on New Wells)
30-039-24732
5. Indicate Type of Lease STATE <input checked="" type="checkbox"/> FEE <input type="checkbox"/>
6. State Oil & Gas Lease No. E-291-3

APPLICATION FOR PERMIT TO DRILL, DEEPEN, OR PLUG BACK					
1a. Type of Work: DRILL <input checked="" type="checkbox"/> RE-ENTER <input type="checkbox"/> DEEPEN <input type="checkbox"/> PLUG BACK <input type="checkbox"/>					
b. Type of Well: OIL WELL <input type="checkbox"/> GAS WELL <input checked="" type="checkbox"/> OTHER <input type="checkbox"/> SINGLE ZONE <input type="checkbox"/> MULTIPLE ZONE <input type="checkbox"/>					
2. Name of Operator Union Oil Company of California					
3. Address of Operator P.O. Box 2074, Farmington, N.M. 87401					
4. Well Location Unit Letter <u>A</u> : <u>1219</u> Feet From The <u>North</u> Line and <u>1246</u> Feet From The <u>East</u> Line Section <u>2</u> Township <u>26N</u> Range <u>7W</u> NMPM <u>Rio Arriba</u> County					
10. Proposed Depth 3244'					
11. Formation Fruitland Coal					
12. Rotary or C.T. Rotary					
13. Elevations (Show whether DF, RT, GR, etc.) 6614' GR					
14. Kind & Status Plug. Bond Current N.W.					
15. Drilling Contractor Arapahoe					
16. Approx. Date Work will start Spring 1990					
17. PROPOSED CASING AND CEMENT PROGRAM <u>E/320-34</u>					
SIZE OF HOLE	SIZE OF CASING	WEIGHT PER FOOT	SETTING DEPTH	SACKS OF CEMENT	EST. TOP
12-1/4"	8 5/8"	24.0 #	225'	175 sacks	surface
7-7/8"	4 1/2"	10.5 #	T.D.	410 sacks	surface

PROPOSED DRILLING PROGRAM

MIRU. Drill 12-1/4" hole with spud mud to 225'. Survey. Rig up and run casing and cement. WOC @ 18 hours. NUBOP, choke, and kill line (2000#) and test same plus casing. Drill out with 7 7/8" hole from 225' to T.D. with fresh water mud. Run surveys @ 500' intervals or first bit trip succeeding 500'. AT T.D. log with DISFL, GR, SP, FDS, CNL-GR. Run and cement casing. RDMOL.

APPROVAL EXPIRES 10-27-90
UNLESS DRILLING IS COMMENCED.
SPUD NOTICE MUST BE SUBMITTED
WITHIN 10 DAYS.

RECEIVED

APR 27 1990

OIL CON. DIV.
DIST. 2

IN ABOVE SPACE DESCRIBE PROPOSED PROGRAM: IF PROPOSAL IS TO DEEPEN OR PLUG BACK, GIVE DATA ON PRESENT PRODUCTIVE ZONE AND PROPOSED NEW PRODUCTIVE ZONE. GIVE BLOWOUT PREVENTER PROGRAM, IF ANY.

I hereby certify that the information above is true and complete to the best of my knowledge and belief.

SIGNATURE

Chris Russell

TITLE

AGENT

DATE

4-26-90

TYPE OR PRINT NAME

Chris Russell

TELEPHONE NO 325-8786

(This space for State Use)

APPROVED BY

35.8

TITLE

SUPERVISOR DISTRICT 2

DATE

APR 27 1990

CONDITIONS OF APPROVAL, IF ANY:

RECEIVED
JAN 10 1964
U.S. AIR FORCE
OFFICE OF THE
JOINT CHIEFS OF STAFF
WASHINGTON, D.C.

RECEIVED
JAN 10 1964
U.S. AIR FORCE
OFFICE OF THE
JOINT CHIEFS OF STAFF
WASHINGTON, D.C.

100-100000

100-100000

Submit to Appropriate
District Office
State Lease - 4 copies
Fee Lease - 3 copies

State of New Mexico
Energy, Minerals and Natural Resources Department

Form C-102
Revised 1-1-89

OIL CONSERVATION DIVISION

P.O. Box 2088
Santa Fe, New Mexico 87504-2088

DISTRICT I
P.O. Box 1980, Hobbs, NM 88240

DISTRICT II
P.O. Drawer DD, Artesia, NM 88210

DISTRICT III
1000 Rio Brazos Rd., Aztec, NM 87410

WELL LOCATION AND ACREAGE DEDICATION PLAT

All Distances must be from the outer boundaries of the section

Operator UNION OIL CO. OF CALIFORNIA			Lease RINCON UNIT		Well No. 294
Unit Letter A	Section 2	Township T.26 N.	Range R.7 W.	County RIO ARriba COUNTY	
Actual Footage Location of Well: 1219 feet from the NORTH line and 1246 feet from the EAST line					
Ground level Elev. 6614	Producing Formation FRUITLAND COAL		Pool BASIN FRUITLAND COAL		Dedicated Acreage: 320.34 Acres

- Outline the acreage dedicated to the subject well by colored pencil or hatchure marks on the plat below.
- If more than one lease is dedicated to the well, outline each and identify the ownership thereof (both as to working interest and royalty).
- If more than one lease of different ownership is dedicated to the well, have the interest of all owners been consolidated by communitization, unitization, force-pooling, etc.?
☒ Yes ☐ No If answer is "yes" type of consolidation UNITIZATION
If answer is "no" list the owners and tract descriptions which have actually been consolidated. (Use reverse side of this form if necessary.)
No allowable will be assigned to the well until all interests have been consolidated (by communitization, unitization, forced-pooling, or otherwise) or until a non-standard unit, eliminating such interest, has been approved by the Division.

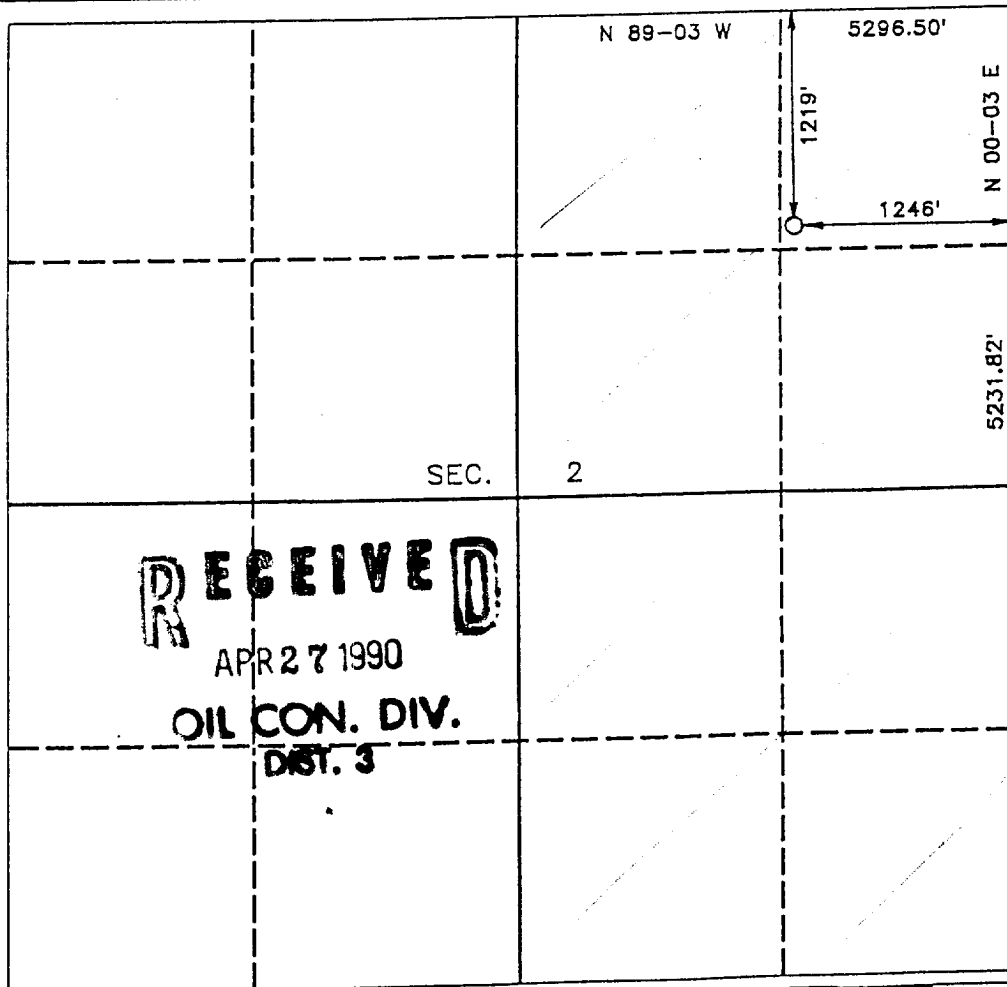

RECEIVED
APR 27 1990
OIL CON. DIV.
DIST. 3

OPERATOR CERTIFICATION

I hereby certify that the information contained herein is true and complete to the best of my knowledge and belief.

Signature

Printed Name

Position

Company

Date

SURVEYOR CERTIFICATION

I hereby certify that the well location shown on this plat was plotted from field notes of actual surveys made by me or under my supervision, and that the same is true and correct to the best of my knowledge and belief.

Date Surveyed

Signature & Seal of
Professional Surveyor

Certificate No.

Registered Professional
Land Surveyor