

UNITED STATES
DEPARTMENT OF THE INTERIOR
BUREAU OF LAND MANAGEMENT

30-039-24774

APPLICATION FOR PERMIT TO DRILL, DEEPEN, OR PLUG BACK

1a. TYPE OF WORK DRILL 1b. TYPE OF WELL GAS		5. LEASE NUMBER SF-079160 6. IF INDIAN, ALL. OR TRIBE NAME	
2. OPERATOR UNION OIL CO. OF CAL.		7. UNIT AGREEMENT NAME RINCON UNIT	
3. ADDRESS OF OPERATOR P O BOX 2074 FARMINGTON, NM, 87401 (505)-325-8786		8. FARM OR LEASE NAME RINCON Unit 9. WELL NO. 272	
4. LOCATION OF WELL 790' FNL, 1200' FEL		10. FIELD, POOL, OR WILDCAT BASIN FRUITLAND COAL 11. SEC. 01, T. 26, R. 07W A	
14. DISTANCE FROM NEAREST TOWN 40 Miles SE of Bloomfield		12. COUNTY Rio Arriba	13. STATE New Mex.
15. DISTANCE FROM PROPOSED LOCATION TO NEAREST PROPERTY OR LEASE LINE 790'	16. ACRES IN LEASE 1920.80		17. ACRES ASSIGNED TO WELL N/320.80
18. DISTANCE FROM PROPOSED LOCATION TO NEAREST WELL DRILLING, COMPLETED OR APPLIED FOR ON THIS LEASE: 325'	19. PROPOSED DEPTH 3214'	20. ROTARY OR CABLE TOOLS <small>DRILLING OPERATIONS AUTHORIZED ARE SUBJECT TO COMPLIANCE WITH ATTACHED "GENERAL REQUIREMENTS".</small> Rotary	
21. ELEVATIONS (DF, FT, GR, ETC.) 6484' GL 6584		22. APPROX. DATE WORK WILL BEGIN Spring 1990	
23. PROPOSED CASING AND CEMENTING PROGRAM SEE ATTACHED DRILLING PLAN			
24. AUTHORIZED BY: <u>Chris Russell</u> <div style="display: flex; justify-content: space-between;"> AGENT <div style="text-align: right;"> <small>This action is subject to technical and procedural review pursuant to 43 CFR 3165.3 and appeal pursuant to 43 CFR 3165.4.</small> <u>7/6/90</u> DATE </div> </div>			

PERMIT NO. **RECEIVED**

APPROVED BY MAY 29 1990

OIL CON. DIV.

APPROVAL DATE _____

TITLE _____ DATE _____

NOTE: THIS FORM ~~ISSUED~~ ³ ISSUED IN LIEU OF BLM FORM 3160-3

15
19

MAY 24 1990

FOR
Ken Townsend

Submit to Appropriate
District Office
State Lease - 4 copies
Fee Lease - 3 copies

State of New Mexico
Energy, Minerals and Natural Resources Department

Form C-102
Revised 1-1-89

OIL CONSERVATION DIVISION

P.O. Box 2088
Santa Fe, New Mexico 87504-2088

DISTRICT I
P.O. Box 1980, Hobbs, NM 88240

DISTRICT II
P.O. Drawer DD, Artesia, NM 88210

DISTRICT III
1000 Rio Brazos Rd., Aztec, NM 87410

WELL LOCATION AND ACREAGE DEDICATION PLAT

All Distances must be from the outer boundaries of the section

Operator UNION OIL CO. OF CALIFORNIA		Lease RINCON UNIT		Well No. 272
Unit Letter A	Section 1	Township T.26 N.	Range R.7 W.	County RIO ARriba COUNTY
Actual Footage Location of Well: 790 feet from the NORTH line and 1200 feet from the EAST line				
Ground level Elev. 6584	Producing Formation FRUITLAND COAL	Pool BASIN FRUITLAND COAL	Dedicated Acreage: 320.88 Acres	

1. Outline the acreage dedicated to the subject well by colored pencil or hatchure marks on the plat below.
2. If more than one lease is dedicated to the well, outline each and identify the ownership thereof (both as to working interest and royalty).
3. If more than one lease of different ownership is dedicated to the well, have the interest of all owners been consolidated by communitization, unitization, force-pooling, etc.?
☐ Yes ☐ No If answer is "yes" type of consolidation _____
If answer is "no" list the owners and tract descriptions which have actually been consolidated. (Use reverse side of this form if necessary.)
No allowable will be assigned to the well until all interests have been consolidated (by communitization, unitization, forced-pooling, or otherwise) or until a non-standard unit, eliminating such interest, has been approved by the Division.

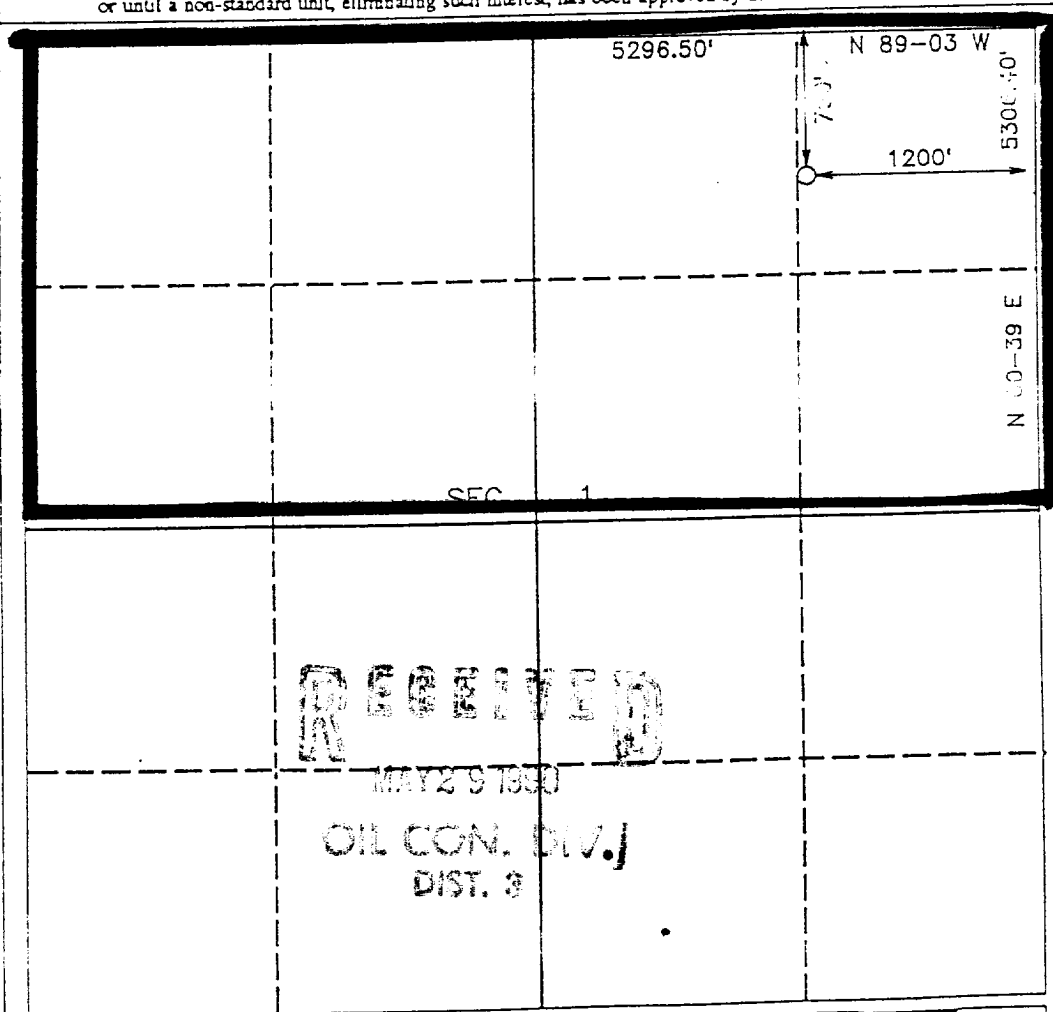

RECEIVED
MAY 29 1990
OIL CON. DIV.
DIST. 3

OPERATOR CERTIFICATION

I hereby certify that the information contained herein is true and complete to the best of my knowledge and belief.

Chris Russell
Signature

Chris Russell
Printed Name

Agent
Position

UNOCAL
Company

4/6/90
Date

SURVEYOR CERTIFICATION

I hereby certify that the well location shown on this plat was plotted from field notes of actual surveys made by me or under my supervision, and that the same is true and correct to the best of my knowledge and belief.

Date Surveyed
MARCH 1990

Signature & Seal of
Professional Surveyor
R. HOWARD DAGGETT
9678

R. Howard Daggett
Signature

Certificate No. 9678
PROFESSIONAL

Registered Professional
Land Surveyor