

UNITED STATES
DEPARTMENT OF THE INTERIOR
BUREAU OF LAND MANAGEMENT

30-039-24874

RECEIVED
BUREAU OF LAND MANAGEMENT
OCT 12 1990

APPLICATION FOR PERMIT TO DRILL, DEEPEN, OR PLUG BACK

1a. TYPE OF WORK DRILL		5. LEASE NUMBER SF-079301-A	
1b. TYPE OF WELL GAS		6. IF INDIAN, ALL. OR TRIBE NAME	
2. OPERATOR UNION OIL CO. OF CAL.		7. UNIT AGREEMENT NAME RINCON UNIT	
3. ADDRESS OF OPERATOR P O BOX 2074 FARMINGTON, NM, 87401 (505)-325-8786		8. FARM OR LEASE NAME RINCON	
		9. WELL NO. 299	
4. LOCATION OF WELL 1760' FSL, 1840' FWL		10. FIELD, POOL, OR WILDCAT BASIN FRUITLAND COAL	
		11. SEC. 06, T. 26N, R. 6W	
14. DISTANCE FROM NEAREST TOWN 40 Miles SE of Bloomfield		12. COUNTY Rio Arriba	13. STATE New Mex.
15. DISTANCE FROM PROPOSED LOCATION TO NEAREST PROPERTY OR LEASE LINE 1760'	16. ACRES IN LEASE 161.35	17. ACRES ASSIGNED TO WELL 320	
18. DISTANCE FROM PROPOSED LOCATION TO NEAREST WELL DRILLING, COMPLETED OR APPLIED FOR ON THIS LEASE: 375'	19. PROPOSED DEPTH 3162'	20. ROTARY OR CABLE TOOLS Rotary	
21. ELEVATIONS (DF, FT, GR, ETC.) 6534' GL		22. APPROX. DATE WORK WILL BEGIN Summer 1990	
23. PROPOSED CASING AND CEMENTING PROGRAM SEE ATTACHED DRILLING PLAN			
24. AUTHORIZED BY: <i>Chas Russell</i> 7-10-90 AGENT DATE			

DRILLING OPERATIONS AUTHORIZED ARE
SUBJECT TO COMPLIANCE WITH ATTACHED
"GENERAL REQUIREMENTS".
This action is subject to technical and
procedural review pursuant to 43 CFR 3165.3
and appeal pursuant to 43 CFR 3165.4.

PERMIT

RECEIVED

APPROVAL DATE

APPROVED BY **AUG 13 1990**

TITLE DATE

OIL CON. DIV.

NOTE: THIS PERMIT IS ISSUED IN LIEU OF BLM FORM 3160-3

NMOCD

for Keller
AUG 13 1990

01

1913020
1913020
1913020
1913020
1913020

Submit to Appropriate
District Office
State Lease - 4 copies
Fee Lease - 3 copies

State of New Mexico
Energy, Minerals and Natural Resources Department

Form C-102
Revised 1-1-89

OIL CONSERVATION DIVISION

P.O. Box 2088
Santa Fe, New Mexico 87504-2088

DISTRICT I
P.O. Box 1980, Hobbs, NM 88240

DISTRICT II
P.O. Drawer DD, Artesia, NM 88210

DISTRICT III
1000 Rio Brazos Rd., Aztec, NM 87410

WELL LOCATION AND ACREAGE DEDICATION PLAT

All Distances must be from the outer boundaries of the section

Operator UNION OIL OF CALIFORNIA			Lease SF-079301-A		Well No. Rincon Unit 299
Unit Letter K	Section 6	Township 26 North	Range 6 West	County Rio Arriba	
Actual Footage Location of Well: 1760 feet from the South line and 1840 feet from the West line					
Ground level Elev. 6534'	Producing Formation Fruitland Coal		Pool Basin Fruitland Coal		Dedicated Acreage: 320 3/4 Acres

1. Outline the acreage dedicated to the subject well by colored pencil or hatchure marks on the plat below.
2. If more than one lease is dedicated to the well, outline each and identify the ownership thereof (both as to working interest and royalty).
3. If more than one lease of different ownership is dedicated to the well, have the interest of all owners been consolidated by communitization, unitization, force-pooling, etc.?
☐ Yes ☐ No If answer is "yes" type of consolidation _____
If answer is "no" list the owners and tract descriptions which have actually been consolidated. (Use reverse side of this form if necessary.) _____
No allowable will be assigned to the well until all interests have been consolidated (by communitization, unitization, forced-pooling, or otherwise) or until a non-standard unit, eliminating such interest, has been approved by the Division.

RECEIVED
AUG 13 1990
OIL CON. DIV.
DIST. I

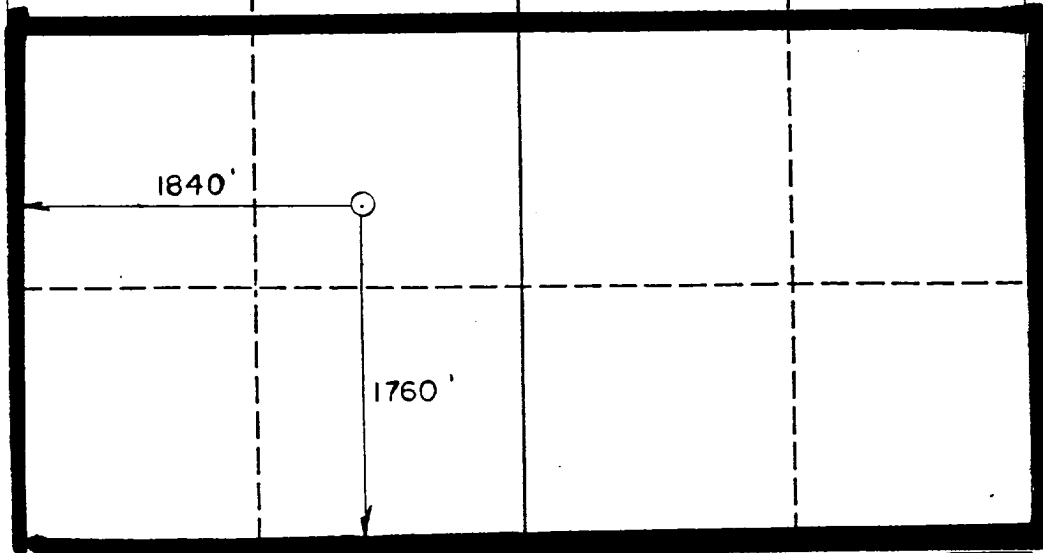

OPERATOR CERTIFICATION

I hereby certify that the information contained herein is true and complete to the best of my knowledge and belief.

Signature *Chris Russell*
Printed Name **Chris Russell**
Position **Agent**
Company **UNOCAL**
Date **July 10, 1990**

SURVEYOR CERTIFICATION

I hereby certify that the well location shown on this plat was plotted from field notes of actual surveys made by me or under my supervision, and that the same is true and correct to the best of my knowledge and belief.

Date Surveyed **28 AUG 1990**
Signature *[Signature]*
Professional Surveyor
Seal of the State of New Mexico
6844
Certification