

UNITED STATES
DEPARTMENT OF THE INTERIOR
BUREAU OF LAND MANAGEMENT

APPLICATION FOR PERMIT TO DRILL, DEEPEN, OR PLUG BACK

1a. TYPE OF WORK DRILL <input checked="" type="checkbox"/> DEEPEN <input type="checkbox"/> PLUG BACK <input type="checkbox"/>				5. LEASE DESIGNATION AND SERIAL NO. SF 079295	
b. TYPE OF WELL OIL WELL <input type="checkbox"/> GAS WELL <input checked="" type="checkbox"/> OTHER <input type="checkbox"/> SINGLE ZONE <input checked="" type="checkbox"/> MULTIPLE ZONE <input type="checkbox"/>				6. IF INDIAN, ALLOTTEE OR TRIBE NAME	
2. NAME OF OPERATOR Mesa Operating Limited Partnership				7. UNIT AGREEMENT NAME	
3. ADDRESS OF OPERATOR P.O. Box 2009, Amarillo, Texas 79189				8. FARM OR LEASE NAME FC FED COM	
4. LOCATION OF WELL (Report location clearly and in accordance with any State requirements.)* At surface 1885' FSL & 1685' FWL At proposed prod. zone Same				9. WELL NO. # 29	
14. DISTANCE IN MILES AND DIRECTION FROM NEAREST TOWN OR POST OFFICE* Approximately 25 miles SE of Blanco, New Mexico				10. FIELD AND POOL, OR WILDCAT Basin Fruitland Coal	
15. DISTANCE FROM PROPOSED* LOCATION TO NEAREST PROPERTY OR LEASE LINE, FT. (Also to nearest drlg. unit line, if any)		16. NO. OF ACRES IN LEASE 61 641.07		17. NO. OF ACRES ASSIGNED TO THIS WELL S/2 320	
18. DISTANCE FROM PROPOSED LOCATION* TO NEAREST WELL, DRILLING, COMPLETED, OR APPLIED FOR, ON THIS LEASE, FT.		19. PROPOSED DEPTH 3210'		20. ROTARY OR CABLE TOOLS Rotary	
21. ELEVATIONS (Show whether DF, RT, GR, etc.) 6725' GR				22. APPROX. DATE WORK WILL START*	
23. DRILLING OPERATIONS AUTHORIZED ARE SUBJECT TO COMPLIANCE WITH ATTACHED "GENERAL REQUIREMENTS" This action is subject to technical and procedural review pursuant to 43 CFR 3165.3 and appeal pursuant to 43 CFR 3165.4 PROPOSED CASING AND CEMENTING PROGRAM					
SIZE OF HOLE	SIZE OF CASING	WEIGHT PER FOOT	SETTING DEPTH	"GENERAL REQUIREMENTS"	
12 1/4"	8 5/8"	24#	200'	150 sx "B" & 2% CaCl (Surface)	
7 7/8"	5 1/2"	17#	3210'	400 Poz/300 "B" (Surface)	

Propose to spud well with 12 1/4" hole and drill to 200' and set 8 5/8" surface casing. Will cement with 150 sx Class "B" (177 Ft³) and raise cement to surface. Will nipple up 2000 psi BOP assembly and drill 7 7/8" hole to TD of + 3210' with fresh water mud system. Will then log well and evaluate for possible commercial production. If successful, will then run 5 1/2" casing to + 3210' and cement with 400 sx Pozmix (720 Ft³) followed by 300 sx Class "B" (350 Ft³) cement. Will move off drilling rig and move in completion unit.

xc: BLM-Farmington (0-5), NMOCD-Aztec (1), WF, Reg, Land, Expl., Drlg

IN ABOVE SPACE DESCRIBE PROPOSED PROGRAM: If proposal is to deepen or plug back, give data on present productive zone and proposed new productive zone. If proposal is to drill or deepen directionally, give pertinent data on subsurface locations and measured and true vertical depths. Give blowout preventer program, if any.

24. SIGNED <u>Cathy L. McKee</u>		TITLE <u>Regulatory Analyst</u>		DATE <u>6/20/90</u>	
(This space for Reviewer's signature or initials)					
PERMIT NO. <u>RECEIVED</u>					
APPROVAL DATE <u>AUG 20 1990</u>					
APPROVED BY <u>[Signature]</u>					
CONDITIONS OF APPROVAL, IF ANY:					

OIL CON. DIV.
DIST. 3

NMOCD

*See Instructions On Reverse Side

Submit to Appropriate
District Office
State Lease - 4 copies
Fee Lease - 3 copies

State of New Mexico
Energy, Minerals and Natural Resources Department

Form C-102
Revised 1-1-89

OIL CONSERVATION DIVISION

DISTRICT I
P.O. Box 1980, Hobbs, NM 88240

P.O. Box 2088
Santa Fe, New Mexico 87504-2088

DISTRICT II
P.O. Drawer DD, Artesia, NM 88210

DISTRICT III
1000 Rio Brazos Rd., Aztec, NM 87410

WELL LOCATION AND ACREAGE DEDICATION PLAT

All Distances must be from the outer boundaries of the section

Operator Mesa Operating Limited Partnership			Lease FC Federal Com		Well No. 29
Unit Letter K	Section 23	Township 26N	Range 6W	County Rio Arriba	NMPM
Actual Footage Location of Well: 1885 feet from the South line and 1685 feet from the West line					
Ground level Elev. 6725'	Producing Formation Fruitland Coal		Pool Basin Fruitland Coal		Dedicated Acreage: S/2 320 Acres

1. Outline the acreage dedicated to the subject well by colored pencil or hatchure marks on the plat below.
2. If more than one lease is dedicated to the well, outline each and identify the ownership thereof (both as to working interest and royalty).
3. If more than one lease of different ownership is dedicated to the well, have the interest of all owners been consolidated by communitization, unitization, force-pooling, etc.?
☒ Yes ☐ No If answer is "yes" type of consolidation Communitization
If answer is "no" list the owners and tract descriptions which have actually been consolidated. (Use reverse side of this form if necessary).
No allowable will be assigned to the well until all interests have been consolidated (by communitization, unitization, forced-pooling, or otherwise) or until a non-standard unit, eliminating such interest, has been approved by the Division.

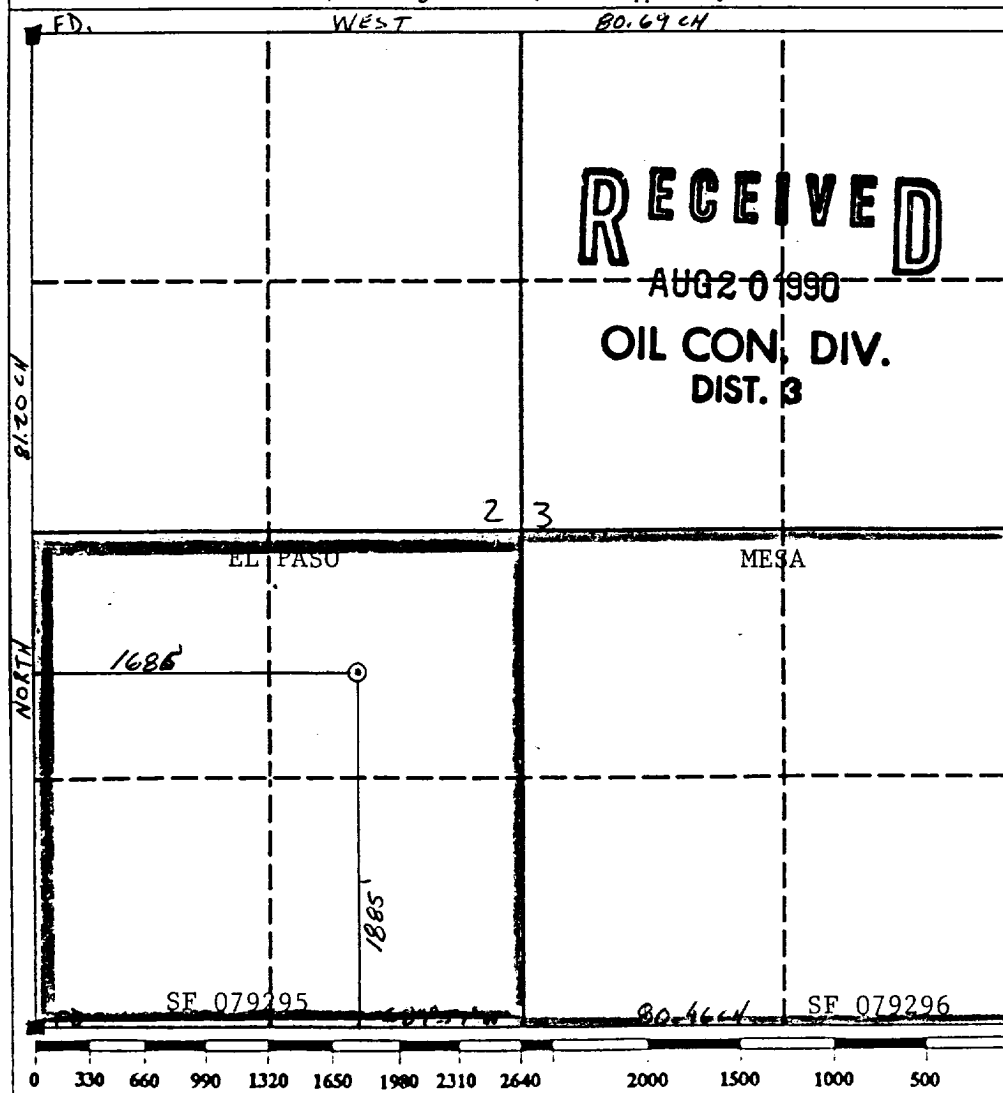

OPERATOR CERTIFICATION I hereby certify that the information contained herein is true and complete to the best of my knowledge and belief. Signature <u>Carolyn L. McKee</u> Printed Name <u>Carolyn L. McKee</u> Position <u>Regulatory Analyst</u> Company <u>Mesa Ltd Partnership</u> Date <u>6/20/90</u>	
SURVEYOR CERTIFICATION I hereby certify that the well location shown on this plat was plotted from field notes of actual surveys made by me or under my supervision, and that the same is true and correct to the best of my knowledge and belief. Date Surveyed <u>6/8/90</u> <u>Roy A. Rush</u> Signature & Seal of Professional Surveyor Certificate No. <u>8894</u> 8894	

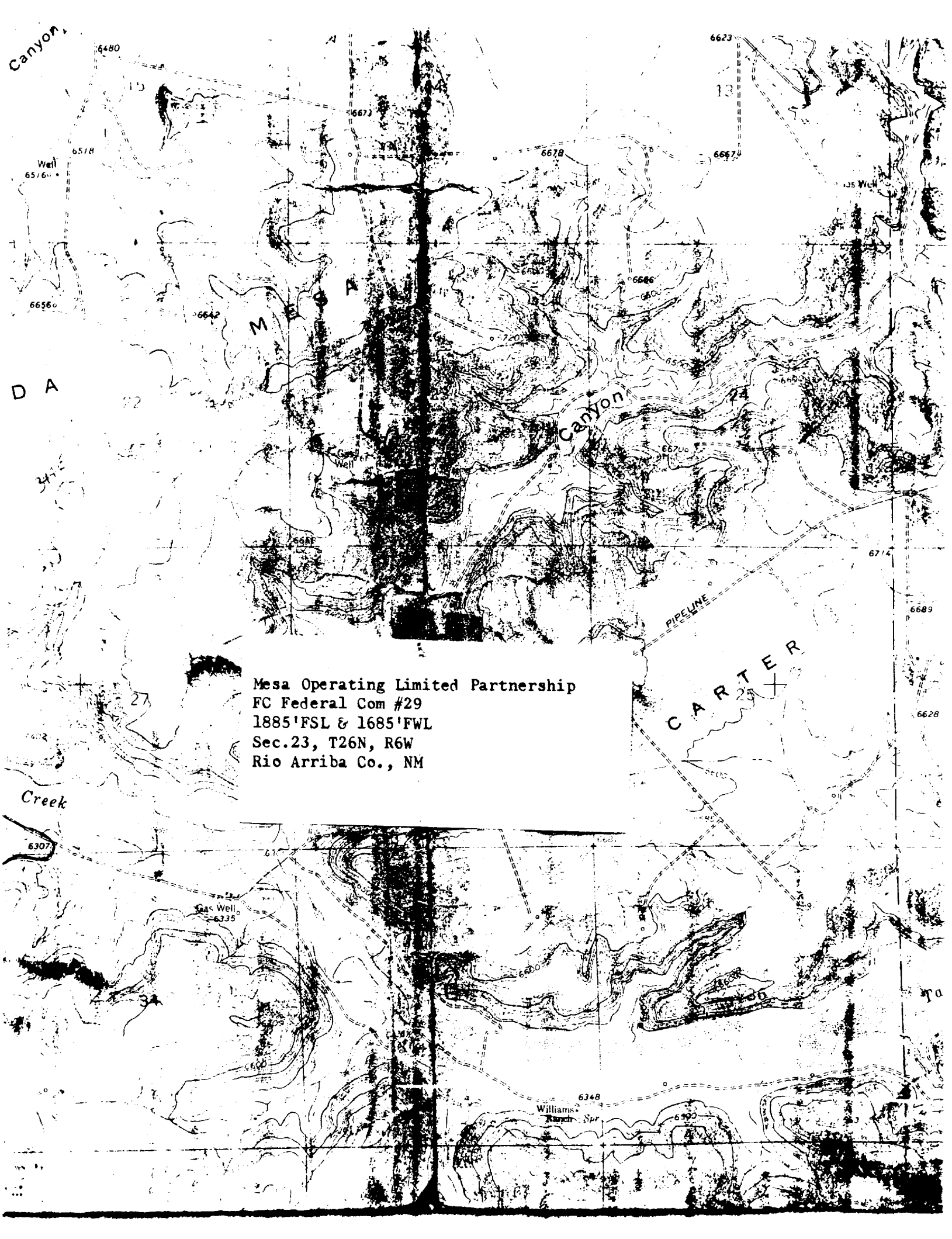

Mesa Operating Limited Partnership
FC Federal Com #29
1885'FSL & 1685'FWL
Sec.23, T26N, R6W
Rio Arriba Co., NM