

# CAULKINS OIL COMPANY

P. O. BOX 340

BLOOMFIELD, NEW MEXICO 87413

PHONE: 505-632-1544

FAX 505-632-1471

October 25, 2001

State of New Mexico  
Oil Conservation Division  
ATTN: Mr. David Catanach  
1220 S. St. Francis Drive  
Santa Fe, NM 87504



Re: Administrative Approval to Downhole Commingle  
Breach "B" 781, Sec. 14-26N-7W Unit Letter L  
Ice Canyon Gallup, Blanco Mesa Verde and Otero Chacra Formations

Dear Mr. Catanach:

This well was originally completed as a dual completion Basin Dakota – Ice Canyon Gallup – Blanco Mesa Verde (DHC-2032) commingled below a packer with Otero Chacra producing above packer.

During completion operations in January 1999, a fish was left in hole at 6212'. Attempts to recover fish were unsuccessful so we decided to complete well leaving fish in place. This allowed us to produce well down to the sales line rather than lose our initial production from the well to the atmosphere during a drawn out fishing job.

August 2001. We moved a workover rig to location to attempt recovery of fish in hole. During fishing operations we had a downhole fire which led to plugging the Dakota zone in this well. At this time we decided to commingle the Ice Canyon Gallup, Blanco Mesa Verde and Otero Chacra zones in this wellbore. Production tubing was run to 6052' and request for approval to produce commingled well under Order # R-11363 was submitted to the Aztec NMOCD office. I was informed the Order # R-11363 does not cover three commingled zones and that I would need to submit form C-107-A for approval. This well has been shut-in since August 14, 2001 and will remain shut-in pending approval of commingling application.

Allocation percentages were calculated using the average production from the July 2000 through June 2001 monthly volume statements for all three zones.

Please find the enclosed documents:

- A. NMOCD form C-107-A
- B. NMOCD form C-102 for each zone
- C. Notification list of offset operators
- D. Vicinity map
- E. Sundry Notice notifying BLM of intention to commingle

If you have any questions or need more information please contact Robert L. Verquer at (505) 632-1544.

Sincerely,

Robert L. Verquer  
Superintendent

## DISTRICT I

P.O. Box 1980, Hobbs, NM 88240

## DISTRICT II

811 South First St., Artesia, NM 88210

## DISTRICT III

1000 Rio Bravo Rd., Aztec, NM 87410

State of New Mexico

Energy, Minerals and Natural Resources Department

## OIL CONSERVATION DIVISION

1220 S. St. Francis Dr.  
Santa Fe, New Mexico 87504

Form C-107-A

New 3-12-96

APPROVAL PROCESS:

☒ Administrative ☐ Hearing

EXISTING WELLBORE

YES NO

## APPLICATION FOR DOWNHOLE COMMINGLING

CAULKINS OIL COMPANY

P.O. BOX 340, BLOOMFIELD, NM 87413

OPERATOR

ADDRESS

BREECH "B"

781

L - SEC. 14-26N-7W

RIO ARriba

LEASE

WELL NO

UNIT LTR. - SEC. - TWP. - RGE

COUNTY

Spacing Unit Lease types: (check 1 or more)

OGRID NO. 003824

Property Code 2456

API NO. 30-039-25839

Federal ☒ , State ☐ , (and/or) Fee

The following facts are submitted in support of downhole commingling:	Upper Zone	Intermediate Zone	Lower Zone
1. Pool Name and Pool Code	Otero Chacra	Mesa Verde	Gallup
2. Top and Bottom of Pay Section (Perforations)	2827' - 3199'	4548' - 5249'	5669' - 6123'
3. Type of production (Oil or Gas)	Gas	Gas and Condensate	Gas and Condensate
4. Method of Production (Flowing or Artificial Lift)	Flowing	Flowing	Flowing
5. Bottomhole Pressure Zones - Artificial Lift: Estimated Current Gas & Oil - Flowing: Measured Current All Gas Zones: Estimated or Measured Original	a. (Current) 423 b. (Original)	a. (Current) 517 b. (Original)	a. (Current) 608 b. (Original)
Oil Gravity (° API) or Gas BTU Content	1193 BTU	1243 BTU	1243 BTU
7. Producing or Shut-In	Shut-in	Shut-in	Shut-in
Production Marginal? (yes or no)	Yes	Yes	Yes
* If Shut-In, give date and oil/gas/water rates of last production <small>Note: For new zones with no production history, applicant shall be required to attach production estimates and supporting data.</small>	Date: 12 month average Gas Oil Water Rates: 66 0 0 MCF/D Bbl Bbl	Date: 12 month average Gas Oil Water Rates: 29 .15 1 MCF/D Bbl Bbl	Date: 12 month average Gas Oil Water Rates: 40 .32 1.5 MCF/D Bbl Bbl
* If Producing, give date and oil/gas/water rates of recent test (within 60 days)	Date: Rates:	Date: Rates:	Date: Rates:
8. Fixed Percentage Allocation Formula - % for each zone	Oil 0 % Gas 48 %	Oil 33 % Gas 22 %	Oil 67 % Gas 30 %

9. If allocation formula is based upon something other than current or past production, or is based upon some other method, submit attachments with supporting data and/or explaining method and providing the projections or other required data.

10. Are all working, overriding, and royalty interests identical in all commingled zones? ☒ Yes ☐ No

If not, have all working, overriding, and royalty interests been notified by certified mail? ☐ Yes ☐ No

Have all offset operators been given written notice of the proposed downhole commingling? ☒ Yes ☐ No

11. Will cross-flow occur? ☒ Yes ☐ No If yes, are fluids compatible, will the formations not be damaged, will any cross-flowed production be recovered, and will the allocation formula be reliable. ☒ Yes ☐ No (If No, attach explanation)

12. Are all produced fluids from all commingled zones compatible with each other? ☒ Yes ☐ No

13. Will the value of production be decreased by commingling? ☐ Yes ☒ No (If Yes, attach explanation)

14. If this well is on, or communitized with, state or federal lands, either the Commissioner of Public Lands or the United States Bureau of Land Management has been notified in writing of this application. ☒ Yes ☐ No

15. NMOCD Reference Cases of Rule 303© Exceptions: ORDER NO(S). DHC - 1920, DHC - 659, DHC - 2032

## 16. ATTACHMENTS:

- C-102 for each zone to be commingled showing its spacing unit and acreage dedication.
- Production curve for each zone for at least one year. (If not available, attach explanation.)
- For zones with no production history, estimated production rates and supporting data.
- Data to support allocation method or formula.
- Notification list of all offset operators.
- Notification list of working, overriding, and royalty interests for uncommon interest cases.
- Any additional statements, data, or documents required to support commingling.

I hereby certify that the information above is true and complete to the best of my knowledge and belief.

SIGNATURE Robert L. Verquer TITLE SUPERINTENDENT DATE October 25, 2001

TYPE OR PRINT NAME ROBERT L. VERQUER TELEPHONE NO. (505) 632-1544

District I  
PO Box 1980, Hobbs, NM 88241-1980  
District II  
811 South First, Artesia, NM 88210  
District III  
1000 Rio Brazos Rd., Aztec, NM 87410  
District IV  
2040 South Pacheco, Santa Fe, NM 87505

State of New Mexico  
Energy, Minerals & Natural Resources Department

OIL CONSERVATION DIVISION  
2040 South Pacheco  
Santa Fe, NM 87505

Form C-102  
Revised October 18, 1994  
Instructions on back  
BLM Submit to Appropriate District Office  
State Lease - 4 Copies  
Fee Lease - 3 Copies

98 JUN 30 PM 12:25

070 FARMINGTON, NM

☐ AMENDED REPORT

# WELL LOCATION AND ACREAGE DEDICATION PLAT

<sup>1</sup> API Number 30-039-25839		<sup>2</sup> Pool Code 93235	<sup>3</sup> Pool Name ICE CANYON; GALLUP
<sup>4</sup> Property Code 2456	<sup>5</sup> Property Name BREECH "B"		<sup>6</sup> Well Number 781
<sup>7</sup> OGRID No. 003824	<sup>8</sup> Operator Name Caulkins Oil Company		<sup>9</sup> Elevation 6124 GR

## <sup>10</sup> Surface Location

UL or lot no. L	Section 14	Township 26N	Range 7W	Lot Idn	Feet from the 1800'	North/South line South	Feet from the 1150'	East/West line West	County Rio Arriba
--------------------	---------------	-----------------	-------------	---------	------------------------	---------------------------	------------------------	------------------------	----------------------

## <sup>11</sup> Bottom Hole Location If Different From Surface

UL or lot no.	Section	Township	Range	Lot Idn	Feet from the	North/South line	Feet from the	East/West line	County
<sup>12</sup> Dedicated Acres 160		<sup>13</sup> Joint or Infill	<sup>14</sup> Consolidation Code		<sup>15</sup> Order No.				

NO ALLOWABLE WILL BE ASSIGNED TO THIS COMPLETION UNTIL ALL INTERESTS HAVE BEEN CONSOLIDATED OR A NON-STANDARD UNIT HAS BEEN APPROVED BY THE DIVISION

<p><sup>16</sup></p>					<p><sup>17</sup> OPERATOR CERTIFICATION</p> <p>I hereby certify that the information contained herein is true and complete to the best of my knowledge and belief</p>	
					<p>Signature <i>Robert L. Verquer</i></p>	
					<p>Printed Name     Robert L. Verquer</p>	
					<p>Title     Superintendent</p>	
<p>Date     June 26, 1998</p>		<p><sup>18</sup> SURVEYOR CERTIFICATION</p> <p>I hereby certify that the well location shown on this plat was plotted from field notes of actual surveys made by me or under my supervision, and that the same is true and correct to the best of my knowledge and belief.</p>				
<p>Date of Survey</p>		<p>Signature and Seal of Professional Surveyor:</p>				
<p>Certificate Number</p>						

District I  
PO Box 1980, Hobbs, NM 88241-1980  
District II  
811 South First, Artesia, NM 88210  
District III  
1000 Rio Brazos Rd., Aztec, NM 87410  
District IV  
2040 South Pacheco, Santa Fe, NM 87505

State of New Mexico  
Energy, Minerals & Natural Resources Department

OIL CONSERVATION DIVISION  
2040 South Pacheco  
Santa Fe, NM 87505

Form C-102  
Revised October 18, 1994  
Instructions on back  
Submit to Appropriate District Office  
State Lease - 4 Copies  
Fee Lease - 3 Copies

RECEIVED  
BLM

98 JUN 30 PM 12:26

☐ AMENDED REPORT

070 FARMINGTON, NM

WELL LOCATION AND ACREAGE DEDICATION PLAT

<sup>1</sup> API Number 30-039-25839		<sup>2</sup> Pool Code 72319	<sup>3</sup> Pool Name BLANCO MESA VERDE
<sup>4</sup> Property Code 2456	<sup>5</sup> Property Name BREECH "B"		<sup>6</sup> Well Number 781
<sup>7</sup> OGRID No. 003824	<sup>8</sup> Operator Name Caulkins Oil Company		<sup>9</sup> Elevation 6124 GR

<sup>10</sup> Surface Location

UL or lot no.	Section	Township	Range	Lot Idn	Feet from the	North/South line	Feet from the	East/West line	County
L	14	26N	7W		1800'	South	1150'	West	Rio Arriba

<sup>11</sup> Bottom Hole Location If Different From Surface

UL or lot no.	Section	Township	Range	Lot Idn	Feet from the	North/South line	Feet from the	East/West line	County

<sup>12</sup> Dedicated Acres 160	<sup>13</sup> Joint or Infill	<sup>14</sup> Consolidation Code	<sup>15</sup> Order No.
--------------------------------------	-------------------------------	----------------------------------	-------------------------

NO ALLOWABLE WILL BE ASSIGNED TO THIS COMPLETION UNTIL ALL INTERESTS HAVE BEEN CONSOLIDATED OR A NON-STANDARD UNIT HAS BEEN APPROVED BY THE DIVISION

<p>16</p>	<p><sup>17</sup> OPERATOR CERTIFICATION</p> <p>I hereby certify that the information contained herein is true and complete to the best of my knowledge and belief</p> <p><i>Robert L. Verquer</i></p> <p>Signature</p> <p>Printed Name Robert L. Verquer</p> <p>Title Superintendent</p> <p>Date June 26, 1998</p> <p><sup>18</sup> SURVEYOR CERTIFICATION</p> <p>I hereby certify that the well location shown on this plat was plotted from field notes of actual surveys made by me or under my supervision, and that the same is true and correct to the best of my knowledge and belief.</p> <p>Date of Survey</p> <p>Signature and Seal of Professional Surveyor:</p> <p>Certificate Number</p>			

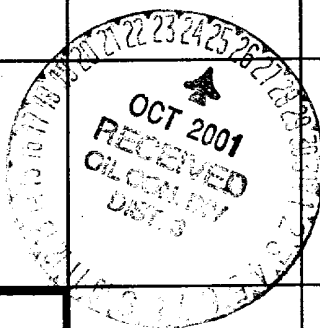

District I  
PO Box 1980, Hobbs, NM 88241-1980  
District II  
811 South First, Artesia, NM 88210  
District III  
1000 Rio Brazos Rd., Aztec, NM 87410  
District IV  
2040 South Pacheco, Santa Fe, NM 87505

State of New Mexico  
Energy, Minerals & Natural Resources Department

OIL CONSERVATION DIVISION  
2040 South Pacheco  
Santa Fe, NM 87505

Form C-10  
Revised October 18, 199  
Instructions on bac  
Submit to Appropriate District Office  
State Lease - 4 Copie  
Fee Lease - 3 Copie

☐ AMENDED REPOR

WELL LOCATION AND ACREAGE DEDICATION PLAT

<sup>1</sup> API Number 30-039-25839		<sup>1</sup> Pool Code 82329	<sup>1</sup> Pool Name OTERO CHACRA
<sup>4</sup> Property Code 2456	<sup>4</sup> Property Name BREECH "B"		<sup>4</sup> Well Number 781
<sup>1</sup> OGRID No. 003824	<sup>1</sup> Operator Name Caulkins Oil Company		<sup>1</sup> Elevation 6124 GR

<sup>10</sup> Surface Location

UL or lot no.	Section	Township	Range	Lot Idn	Feet from the	North/South line	Feet from the	East/West line	County
L	14	26N	7W		1800'	South	1150'	West	Rio Arriba

<sup>11</sup> Bottom Hole Location If Different From Surface

UL or lot no.	Section	Township	Range	Lot Idn	Feet from the	North/South line	Feet from the	East/West line	County
<sup>12</sup> Dedicated Acres 160		<sup>12</sup> Joint or Infill		<sup>12</sup> Consolidation Code		<sup>12</sup> Order No.			

NO ALLOWABLE WILL BE ASSIGNED TO THIS COMPLETION UNTIL ALL INTERESTS HAVE BEEN CONSOLIDATED OR A NON-STANDARD UNIT HAS BEEN APPROVED BY THE DIVISION

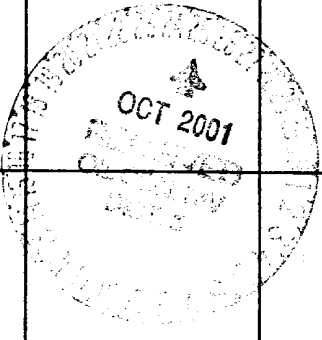
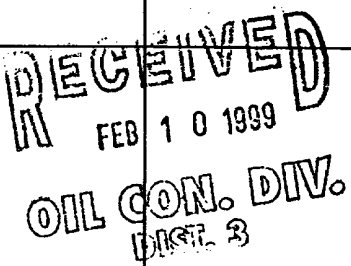
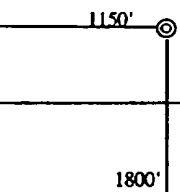
16			17 OPERATOR CERTIFICATION
			<p>I hereby certify that the information contained herein is true and complete to the best of my knowledge and belief</p> <p><i>Robert L. Verquer</i></p> <p>Signature</p> <p>Printed Name Robert L. Verquer</p> <p>Title Superintendent</p> <p>Date February 8, 1999</p>
			18 SURVEYOR CERTIFICATION
<p>I hereby certify that the well location shown on this plat was plotted from field notes of actual surveys made by me or under my supervision, and that the same is true and correct to the best of my knowledge and belief.</p> <p>Date of Survey</p> <p>Signature and Seal of Professional Surveyor:</p> <p>Certificate Number</p>			

# **CAULKINS OIL COMPANY**

**P. O. BOX 340**

**BLOOMFIELD, NEW MEXICO 87413**

**PHONE: 505-632-1544**

**FAX 505-632-1471**

October 25, 2001

The following list is all the offset operators to Caulkins Oil Company well Breech "B" 781, section 14, township 26N, range 7W

Central Resources, Inc.  
1776 Lincoln St. Suite 1010  
Denver, CO 80202

Chateau Oil & Gas  
5802 U. S. Highway 64  
Farmington, NM 87402

Dugan Production Corp.  
709 E. Murray Dr. Box 420  
Farmington, NM 87401

Louis Dreyfus Natural Gas  
1400 Quail Springs Corporate Park  
Suite 600  
Oklahoma City, OK 73134

Union Oil & Gas of CA  
1004 Big Spring  
Midland, TX 79702

CAULKINS OIL COMPANY  
VICINITY MAP  
BREECH "B" 781, SEC. 14-26N-7W, UNIT LTR. L  
DAKOTA, GALLUP, MESA VERDE AND OTERO CHACRA

T-26-N

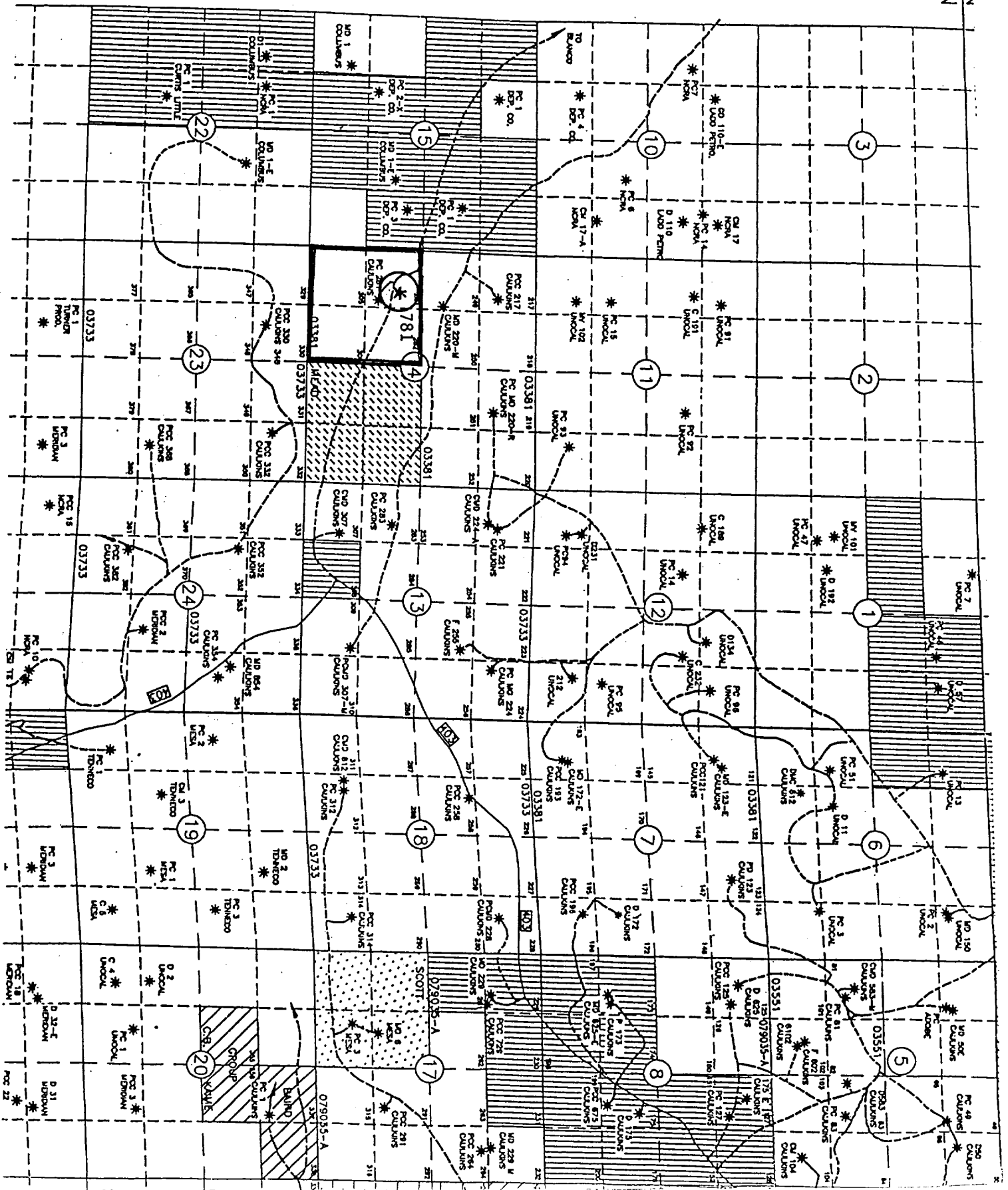

**LAST 12-MONTHS PRODUCTION  
FOR  
BREECH B 781**

**GALLUP**

MONTH	GAS	OIL	WATER	DAYS	GAS DPA	OIL DPA
07/00	1,325	12	2	31	43	0.387
08/00	1,342	11	2	31	43	0.355
09/00	1,284	13	2	30	43	0.433
10/00	1,295	9	1	31	42	0.290
11/00	1,221	9	1	28	44	0.321
12/00	1,337	12	2	31	43	0.387
01/01	1,176	10	2	31	38	0.323
02/01	1,069	8	1	28	38	0.286
03/01	1,170	10	2	31	38	0.323
04/01	1,147	8	1	30	38	0.267
05/01	1,029	8	1	31	33	0.258
06/01	1,145	7	1	30	38	0.233
	<b>14,540</b>	<b>117</b>	<b>18</b>		<b>40</b>	<b>0.322</b>

**MESA VERDE**

MONTH	GAS	OIL	WATER	DAYS	GAS DPA	OIL DPA
07/00	973	6	1	31	31	0.194
08/00	986	5	1	31	32	0.161
09/00	943	7	1	30	31	0.233
10/00	950	4	1	31	31	0.129
11/00	897	4	1	28	32	0.143
12/00	982	7	1	31	32	0.226
01/01	861	4	1	31	28	0.129
02/01	783	4	1	28	28	0.143
03/01	857	5	1	31	28	0.161
04/01	841	4	1	30	28	0.133
05/01	751	4	1	31	24	0.129
06/01	839	3	0	30	28	0.100
	<b>10,663</b>	<b>57</b>	<b>11</b>		<b>29</b>	<b>0.157</b>

**OTERO CHACRA**

MONTH	GAS	OIL	WATER	DAYS	GAS DPA	OIL DPA
07/00	2,033	0	0	31	66	0.000
08/00	2,087	0	0	31	67	0.000
09/00	2,032	0	0	30	68	0.000
10/00	1,931	0	0	31	62	0.000
11/00	1,614	0	0	26	62	0.000
12/00	2,004	0	0	31	65	0.000
01/01	2,010	0	0	31	65	0.000
02/01	1,833	0	0	28	65	0.000
03/01	2,263	0	0	31	73	0.000
04/01	1,978	0	0	30	66	0.000
05/01	1,896	0	0	31	61	0.000
06/01	1,994	0	0	30	66	0.000
	<b>23,675</b>	<b>0</b>	<b>0</b>		<b>66</b>	<b>0.000</b>



UNITED STATES  
DEPARTMENT OF THE INTERIOR  
BUREAU OF LAND MANAGEMENT

**SUNDRY NOTICES AND REPORTS ON WELLS**

(Do not use this form for proposals to drill or to deepen or plug back to a different reservoir. Use "APPLICATION FOR PERMIT--" for such proposals)

5. Lease

NMNM-03381

6. If Indian, Allottee or Tribe Name

7. Unit Agreement Name

1. Oil Well ☐ Gas Well ☐ Other ☐  
GAS WELL

8. Well Name and No.

BREECH "B" 781

2. Name of Operator:

**Caulkins Oil Company**

9. API Well No.

30-039-25839-00C2

3. Address of Operator:

**(505) 632-1544**

**P.O. Box 340, Bloomfield, NM 87413**

10. Field and Pool, Exploratory Area

GALLUP, MESA VERDE, OTERO  
CHACRA

4. Location of Well (Footage, Sec., Twp., Rge.)

1800' F/S 1150' F/W

SEC. 14-26N-7W

11. Country or Parish, State

Rio Arriba Co., New Mexico

**12. CHECK APPROPRIATE BOX(s) TO INDICATE NATURE OF NOTICE, REPORT, OR OTHER DATA**

**TYPE OF SUBMISSION**

**TYPE OF ACTION**

☒ Notice of Intent

☐ Abandonment

☐ Change of Plans

☐ Subsequent Report

☐ Recompletion

☐ New Construction

☐ Plugging Back

☐ Non-Routine Fracturing

☐ Casing Repair

☐ Water Shut-Off

☐ Final Abandonment Notice

☐ Altering Casing

☐ Conversion to Injection

☒ Other Commingle Well

☐ Dispose Water

17. Describe Proposed or Completed Operations:

10-25-01 Caulkins Oil Company has requested approval from NMOCD to downhole commingle this well.

Application and documents attached.

If there is any questions, please contact Robert L. Verquer at (505) 632-1544.

NOTE: The format is issued in lieu of U.S. BLM Form 3160-5

18. I HEREBY CERTIFY THE FOREGOING IS TRUE AND CORRECT

SIGNED:

*Robert L. Verquer*  
ROBERT L. VERQUER

TITLE: Superintendent

DATE: October 25, 2001

APPROVED BY:

TITLE: DATE:

CONDITIONS OF APPROVAL, IF ANY